

# FOR LEASE | HARBOR PLAZA

235 CAMDEN ST, ROCKLAND, ME



## PROPERTY OVERVIEW SHOPPING PLAZA

Harbor Plaza was developed in 1987 as the premier shopping center in the Midcoast. Today, the center is home to several strong national tenants, including Rent-A-Center, Olympia Sports, H&R Block, Label Shopper, and the UPS Store, and is anchored by Shaws, Staples, and TJ Maxx/HomeGoods.

Harbor Plaza is the go-to shopping mall for both local residents and the massive influx of tourists Midcoast Maine sees in the summertime. High foot traffic between stores providing excellent in-line store business.

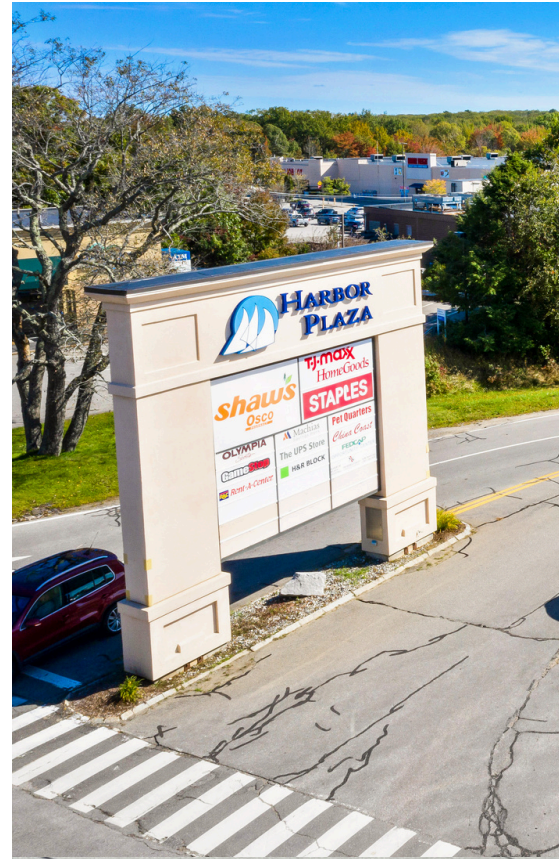

  
CoreFirms.com  
16 Casco Street  
Portland, ME 04101

Contact Charlie Hippler  
(207) 744-3084 Ext 315  
Charlie@CoreFirms.com

# FOR LEASE | HARBOR PLAZA

235 CAMDEN ST, ROCKLAND, ME



## PROPERTY DETAILS

### LEASE RATES

5,710 SF		\$14.00 PSF	
4,300 SF		\$11.00 PSF	
4,561 SF		\$11.00 PSF	
2,040 SF		\$15.00 PSF	
<del>1,750 SF</del>	Leased	<del>\$16.00 PSF</del>	Leased
<del>1,050 SF</del>	1,100 SF	\$16.00 PSF	

---

LEASE TYPE	NNN
EST. CAM	\$3.85 PSF (Includes Property Taxes)

---

LOT SIZE	17.4 ± Acres
SQ. FOOTAGE	179,969 ± SF
ROAD FRONTAGE	669' ± on Camden St
YEAR BUILT	1987
ZONING	Commercial

---

HEAT TYPE	Propane
HEAT SOURCE	Central
AIR CONDITIONING	Package Unit

---

PARKING SPACES	704 (4.17 spaces / 1,000 SF)
----------------	------------------------------

---

DEVELOPMENT	Outparcel Development Available
-------------	------------------------------------

---



CoreFirms.com  
16 Casco Street  
Portland, ME 04101

Contact Charlie Hippler  
(207) 744-3084 Ext 315  
Charlie@CoreFirms.com

# FOR LEASE | HARBOR PLAZA

235 CAMDEN ST, ROCKLAND, ME



## PLAN VIEW

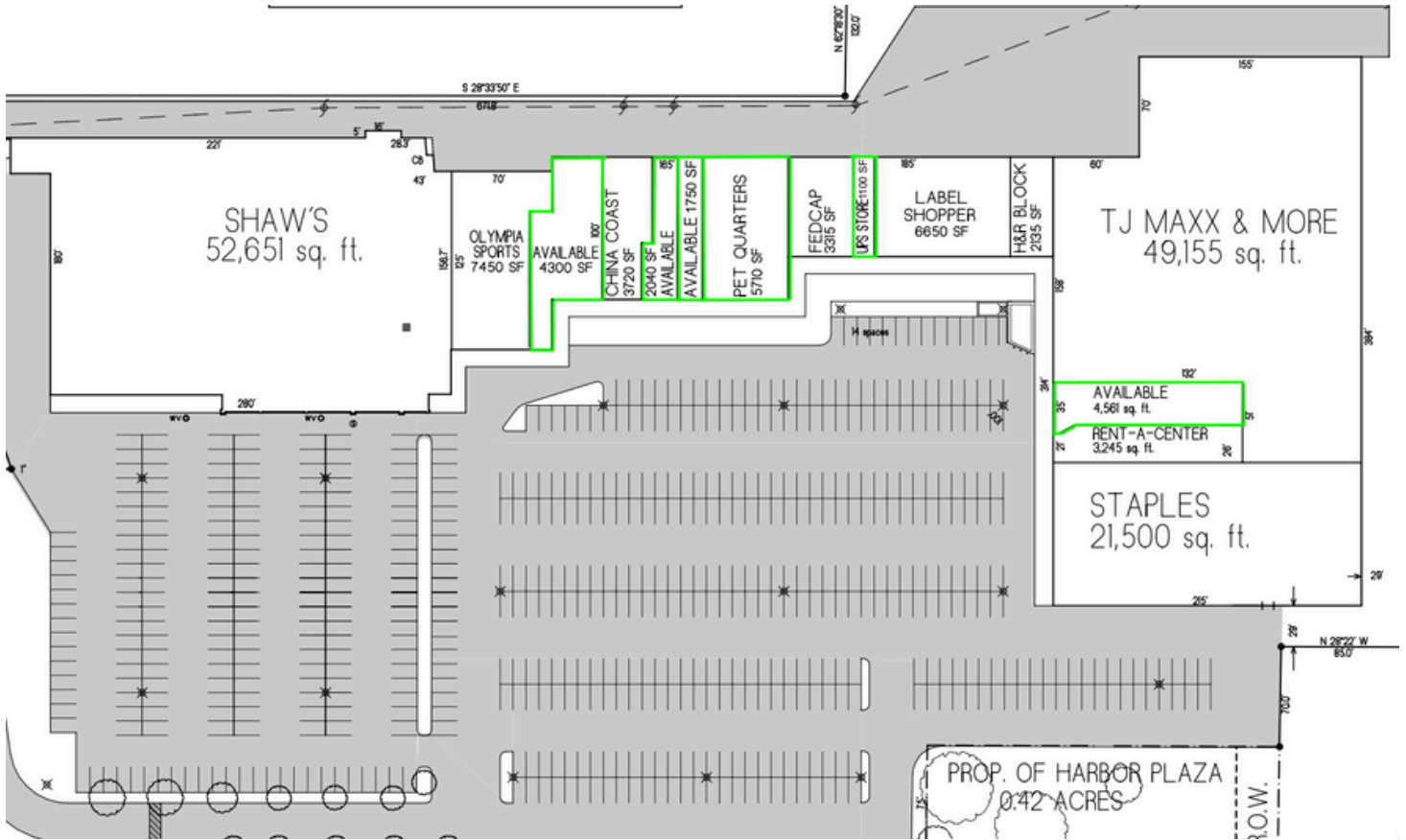

# FOR LEASE | HARBOR PLAZA

235 CAMDEN ST, ROCKLAND, ME



## MAP

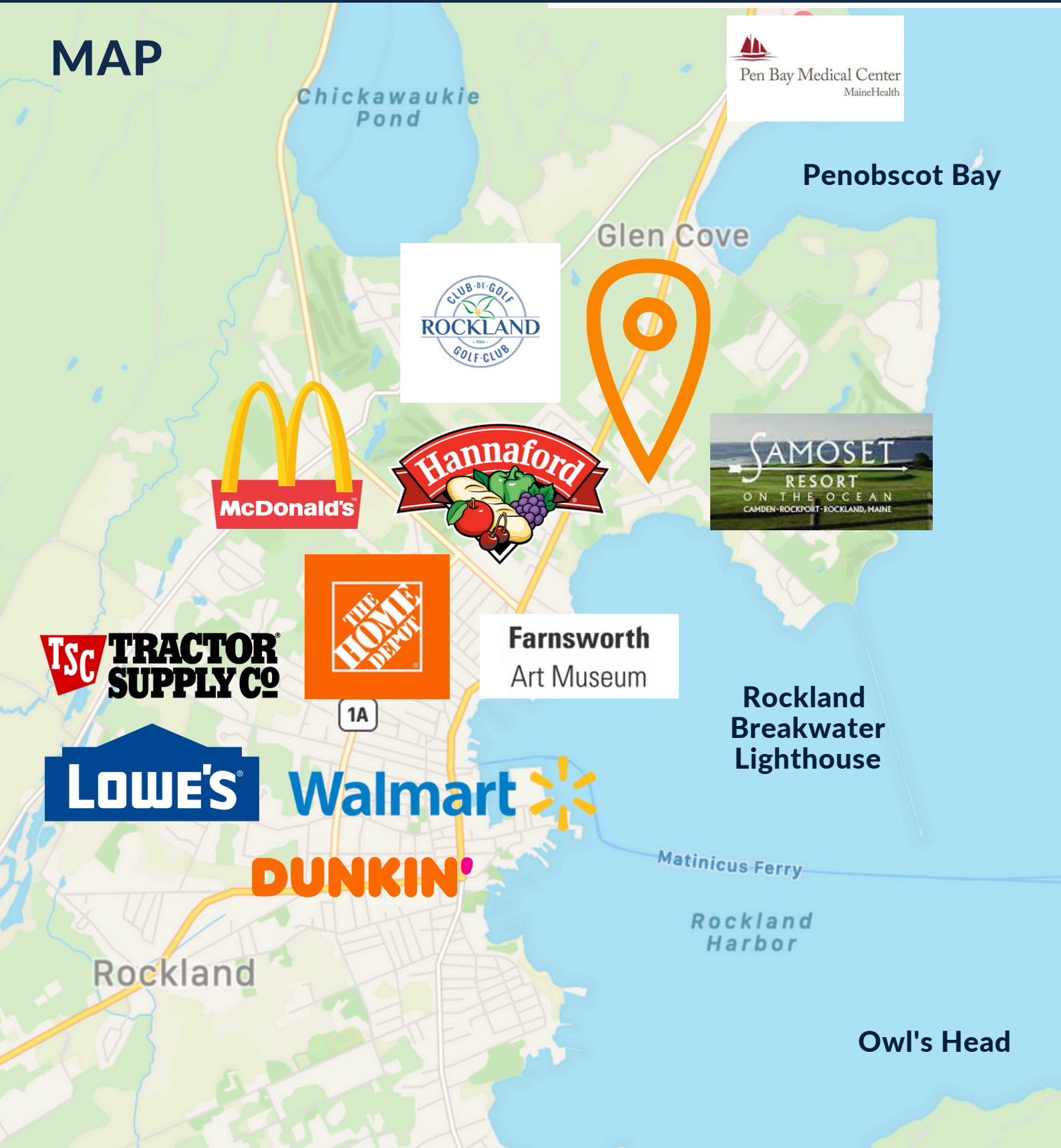

**CORE**  
CoreFirms.com  
16 Casco Street  
Portland, ME 04101

Contact **Charlie Hippler**  
(207) 744-3084 Ext 315  
Charlie@CoreFirms.com

# FOR LEASE | HARBOR PLAZA

235 CAMDEN ST, ROCKLAND, ME



## CONTACT



**Charlie Hippler**  
Associate Broker  
(207) 530-2708  
Charlie@CoreFirms.com

## KNOX COUNTY DEMOGRAPHICS

<b>POPULATION</b>	39.8k
<b>HIGHER EDUCATION</b>	34.2%
<b>MEDIAN AGE</b>	48.6
<b>MALE</b>	49.4%
<b>FEMALE</b>	50.6%
<b>MEDIAN HOUSEHOLD INCOME</b>	\$57.8k
<b>MEDIAN PROPERTY VALUE</b>	\$209.9k



**Josh Soley**  
President  
(207) 744-3084 ext 301  
Josh@CoreFirms.com