



**1670 CAPITAL STREET
BUILDING E, SUITE 500
ELGIN, IL 60124**

**MEDICAL
OFFICE
CONDOMINIUM**

**FOR
SALE**

**LIST PRICE:
\$595,500
(\$205/SF)**



ABOUT THE PROPERTY

- Medical build-out with high end finishes
- Just south of I90/Randal Road interchange
- Close proximity to Advocate Sherman Hospital
- Stoplight access to Randall Road
- Located in 5 building professional office park
- 24/7 direct access to condo unit
- Perfect for owner-user
- Owner controlled HVAC



PROFESSIONAL BUILDING DETAIL:

- Year Built: 2007
- Condo SF: +/- 2,903
- 2026 Assessments: \$1,058/Mo (\$12,696/Yr)
- 2025 Payable 2026 Taxes: \$8,799
- PIN: 03-31-277-059
- Buyer Occupancy: Upon closing
- Property is subject to applicable association documents



**FOR MORE INFORMATION,
CONTACT:**

Jeffrey Clousing
Executive Vice President
630.518.9355 x6
jeff@capitalrep.com

1670 CAPITAL STREET, SUITE E500 ELGIN, IL 60124

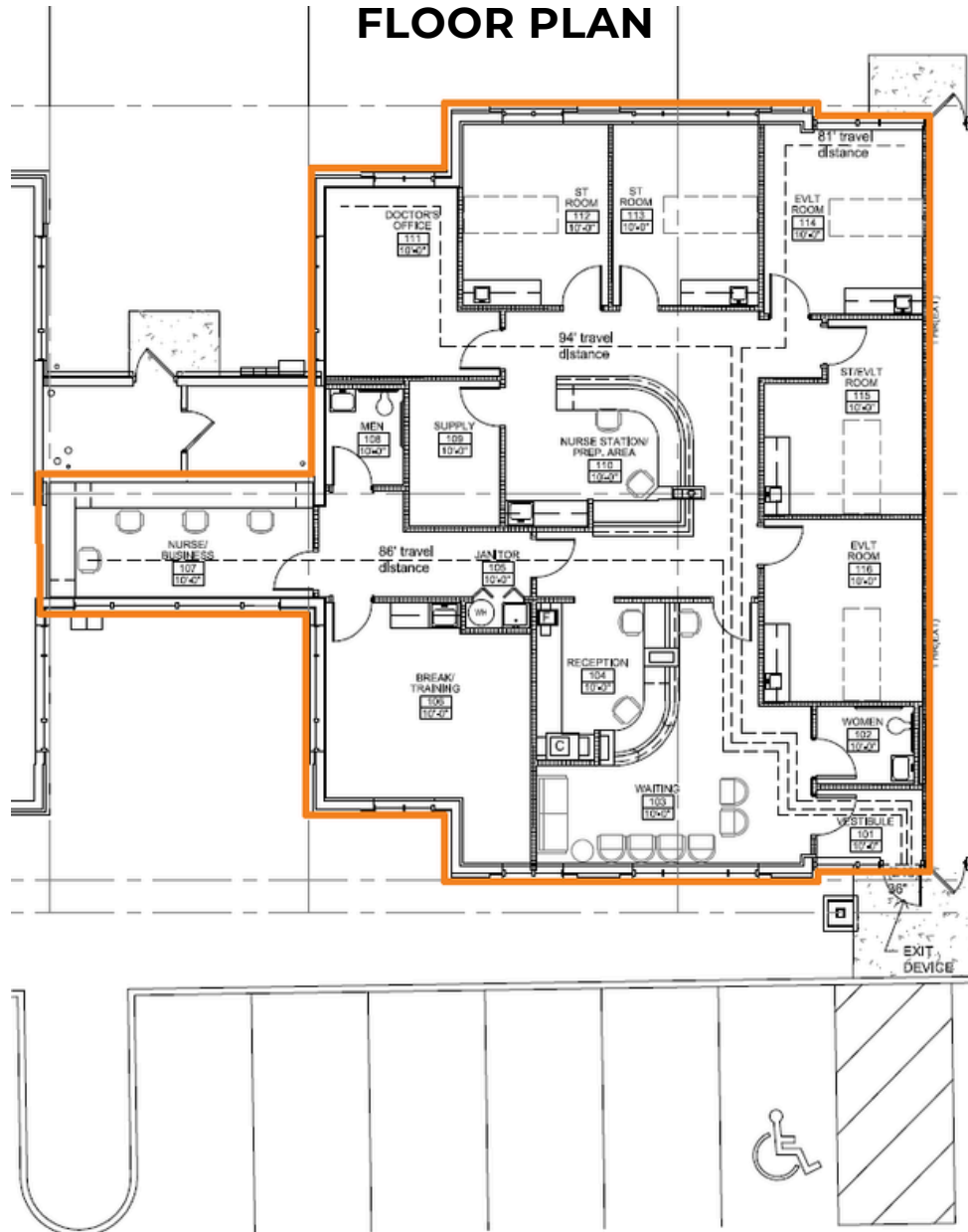

Unit Features:

- +/- 2,903 SF
- 5 Oversized exam rooms
- Waiting room
- Reception area
- Nurse station/Prep area
- Direct entrance with vestibule
- Private office
- 2 Restrooms
- Breakroom/Conference room
- Business office
- Supply storage closet



**FOR MORE INFORMATION,
CONTACT:**

Jeffrey Clousing
Executive Vice President
630.518.9355 x6
jeff@capitalrep.com

1670 CAPITAL STREET, SUITE E500 ELGIN, IL 60124



**FOR MORE INFORMATION,
CONTACT:**

Jeffrey Clousing
Executive Vice President
630.518.9355 x6
jeff@capitalrep.com

All information provided is from sources deemed reliable. No representation is made to the accuracy thereof and it is submitted subject to errors, omissions, changes, or withdrawal without notice. All measurements and boundaries are approximate and subject to buyer verification of actual legal descriptions or actual measurements.

1670 CAPITAL STREET, SUITE E500 ELGIN, IL 60124

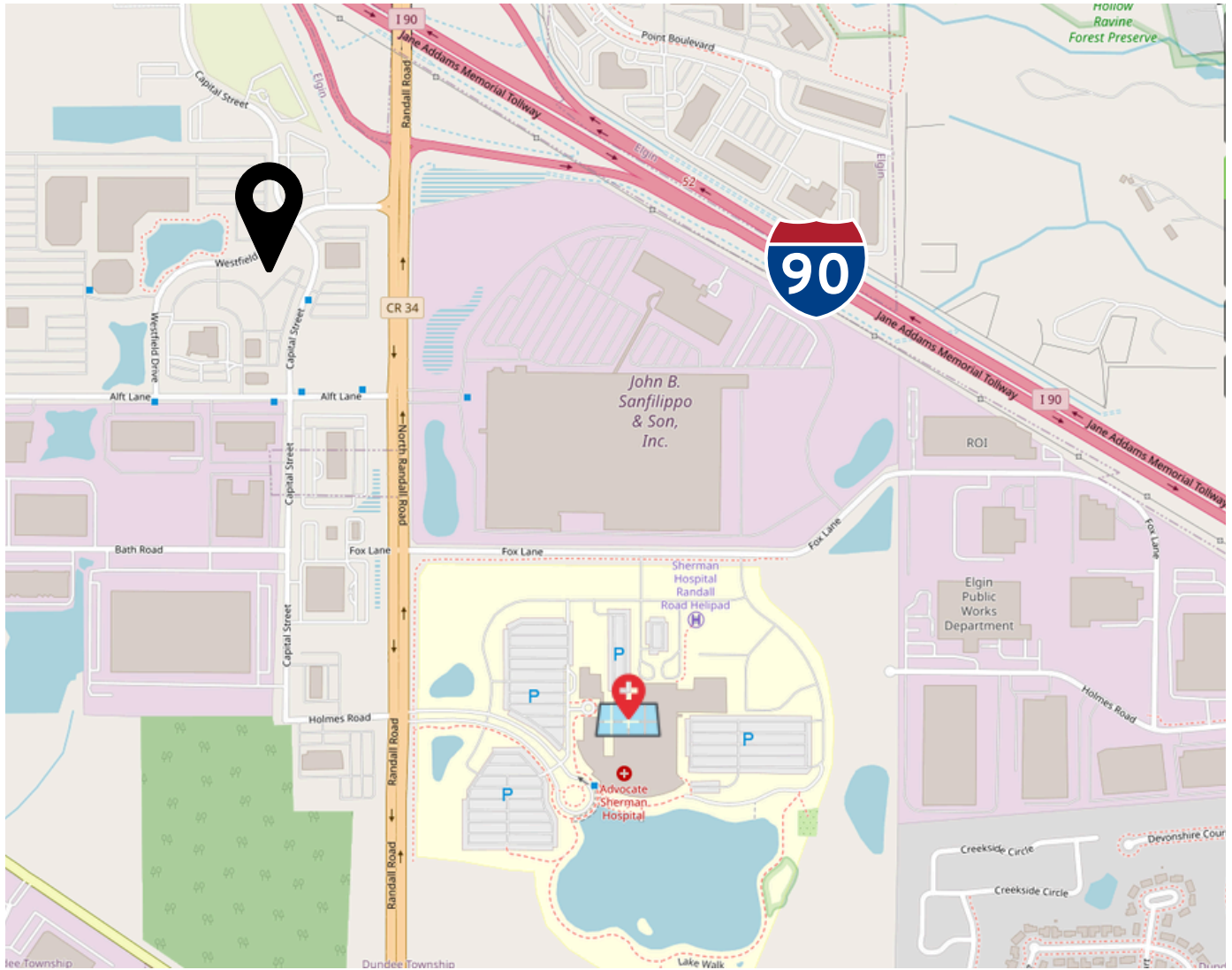

Map data © OpenStreetMap contributors
<https://www.openstreetmap.org/copyright>

Location Highlights:

670 Capital Street, Suite E500 offers convenient access to I-90 via the Randall Road interchange, providing strong connectivity to Chicago-area suburbs both east and west of Elgin. Alt Lane, located just south of the property, is signalized, allowing for safe and efficient access to both northbound and southbound Randall Road. Advocate Sherman Hospital is located nearby along Randall Road



**FOR MORE INFORMATION,
CONTACT:**

Jeffrey Clousing

Executive Vice President

630.518.9355 x6

jeff@capitalrep.com

All information provided is from sources deemed reliable. No representation is made to the accuracy thereof and it is submitted subject to errors, omissions, changes, or withdrawal without notice. All measurements and boundaries are approximate and subject to buyer verification of actual legal descriptions or actual measurements.

1670 CAPITAL STREET, SUITE E500 ELGIN, IL 60124

DISCLAIMER

This Marketing Brochure ("Brochure") is provided solely for the purpose of evaluating a potential purchase of the referenced property ("Property") and may not be copied, distributed, or used for any other purpose. Capital Real Estate Partners, LLC and its designated agent(s) (collectively, "Listing Broker") have an exclusive agreement to represent the owner of the Property ("Owner"). The designated agents listed are the sole contacts for this listing.

Recipients may not contact the Owner or visit the Property without prior written authorization from the Listing Broker. If the recipient—or the recipient's client, in the case of a buyer broker—elects not to pursue the Property, all materials, including this Brochure, must be returned or destroyed upon such election.

This Brochure was prepared using information provided by the Owner and other public sources. While the information is believed to be reliable, no representations or warranties, express or implied, are made as to its accuracy or completeness. This Brochure may include statements, projections, or estimates that are subject to change and are not guaranteed. Buyers must rely solely on their own due diligence, estimates, and projections. Any representations or warranties, if made, will only be contained in a fully executed purchase and sale agreement ("PSA") between the Owner and a qualified buyer.

This Brochure does not constitute an offer to sell, nor is it a solicitation of offers. The Owner reserves the right to accept or reject any offer, withdraw the Property, or modify offering terms at its sole discretion, without notice or obligation. No communication with the Owner or its representatives shall create any binding obligation unless and until a fully executed PSA is finalized.

By submitting an offer, the recipient acknowledges and agrees to the terms of this disclaimer. The Listing Broker is not obligated to cooperate with, or pay a commission to, any buyer broker or cooperating broker unless expressly agreed to in a separate written agreement signed by all necessary parties.

Prospective buyers are strongly encouraged to conduct—and must rely solely on—their own due diligence.



**FOR MORE INFORMATION,
CONTACT:**

Jeffrey Clousing
Executive Vice President
630.518.9355 x6
jeff@capitalrep.com

All information provided is from sources deemed reliable. No representation is made to the accuracy thereof and it is submitted subject to errors, omissions, changes, or withdrawal without notice. All measurements and boundaries are approximate and subject to buyer verification of actual legal descriptions or actual measurements.