

# 100

## FINANCIAL PARK

FRANKLIN, MA

FOR LEASE

10,000 AMPS OF POWER

### NEW RENOVATIONS

- DEMO WORK
- WHITE BOXING

±177,087 SF Advanced  
Manufacturing Facility



BERKELEY  
PARTNERS

# BUILDING SPECIFICATIONS

<b>Building Size</b>	±177,087 SF (subdividable)
<b>Building Dimensions</b>	459' x 397'
<b>Loading</b>	Four (4) loading docks One (1) drive-in door
<b>Clear Height</b>	21'
<b>Column Spacing</b>	30' x 40' (typical)
<b>Zoning</b>	Industrial
<b>Year Built/Renovated</b>	1981 / 1994
<b>Site Size</b>	32.34 acres
<b>Power</b>	10,000 amp 480V, 3-phase power
<b>Sprinklers</b>	Wet
<b>Roof</b>	EPDM
<b>Zoning</b>	Industrial
<b>Utilities</b>	Water & Sewer: Town of Franklin Gas: Eversource Electric: National Grid

# GALLERY



# SITE PLAN

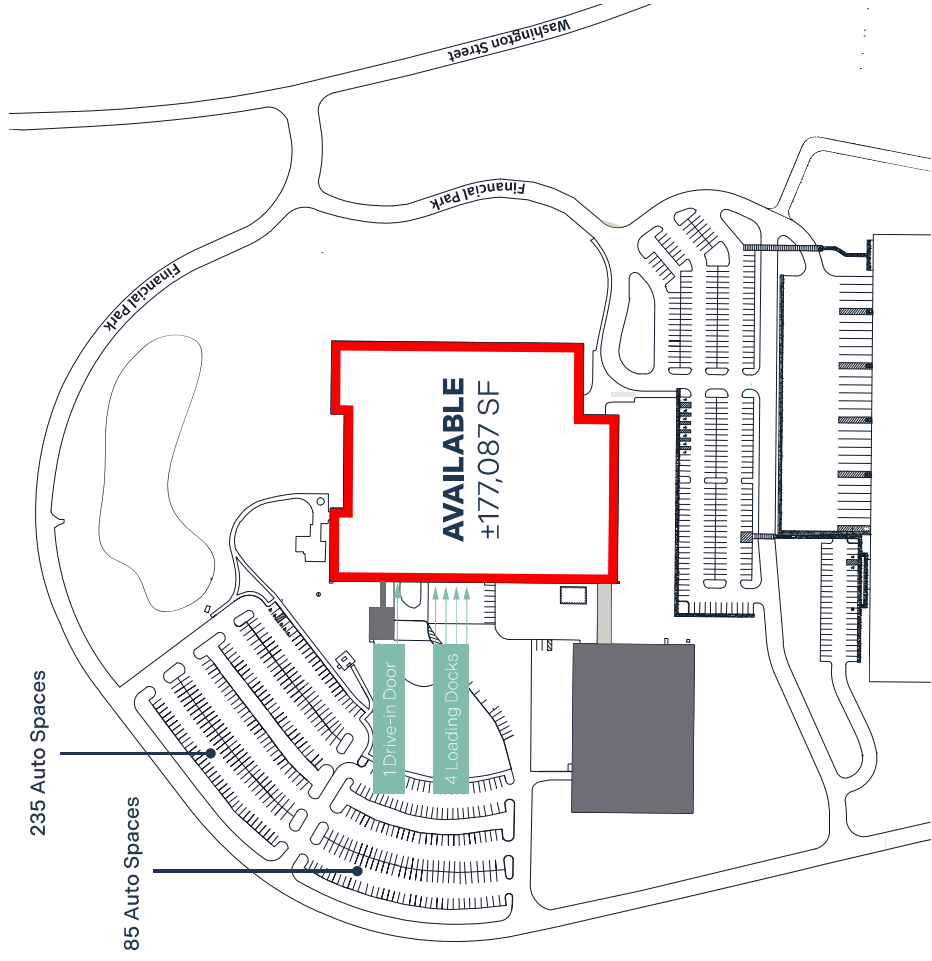

# SUBDIVISION PLAN

- TENANT 1: ±89,315 SF
- TENANT 2: ±83,966 SF
- Common Area: ±3,806 SF

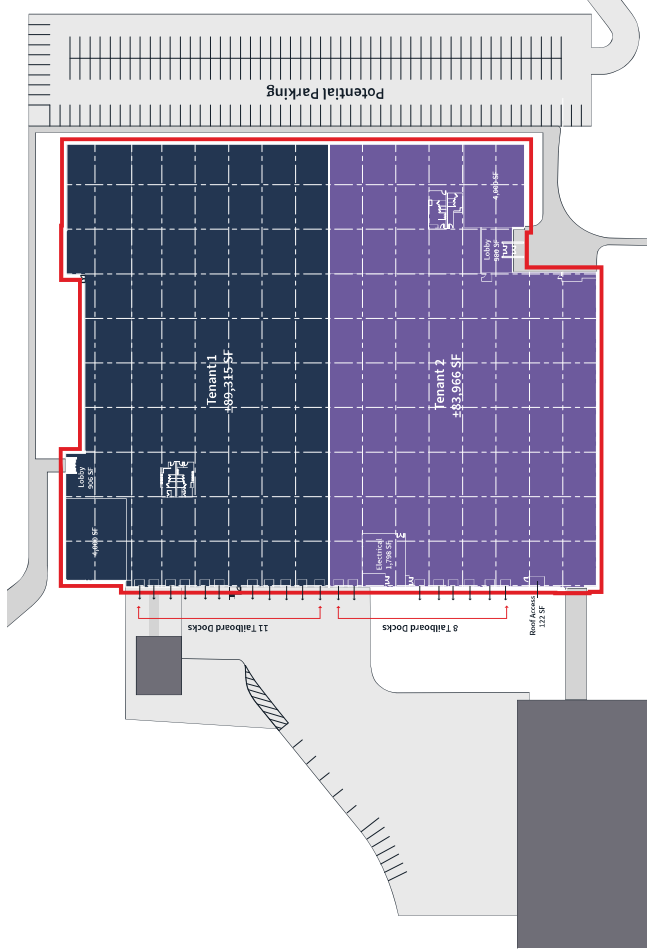

Proposed additional loading shown





## FOR MORE INFORMATION, CONTACT:

**Rachel Marks**

Rachel.Marks@jll.com  
+1 508 259 2440

**Michael Ciummei**

Michael.Ciummei@jll.com  
+1 978 621 7241

**Joe Fabiano**

Joe.Fabiano@jll.com  
+1 781 844 7893

**Chelsea Andre**

Chelsea.Andre@jll.com  
+1 508 951 7817

**Dane Caracino**

Dane.Caracino@jll.com  
+1 617 640 0316

**Kendall Sullivan**

Kendall.Sullivan@jll.com  
+1 978 882 3259

**FOR LEASE**  
+177,087 SF

**100**  
**FINANCIAL**  
**PARK**

