



The Glass Building



**624 SOUTH MILLEDGE
AVENUE, ATHENS, GA 30605**

FOR SUBLEASE or ASSIGNMENT

SUITE 101 - OFFICE

Square Footage:	2,000 SF
Lease Rate:	\$29.50/SF MG
Type:	Sublease or Assignment
Use:	Office
Zoning:	C-O
Parking:	Asphalt Surface

Establish your office at Suite 101 in The Glass Building, a premier S. Milledge Avenue address in Athens. This 2,000 SF suite features two private offices and an open, flexible layout, with rare on-site parking. Enjoy walkable convenience to UGA, Five Points, and nearby retail and dining. Available for sublease or assignment, subject to Landlord approval.

PROPERTY PHOTOS

624 SOUTH MILLEDGE AVENUE | ATHENS, GA 30605



MARKS COMMERCIAL REALTY, INC.
1865 W. Broad Street, Suite A
Athens, Georgia 30606

DANIEL MARKS, CCIM
Managing Broker
O: (762) 999-0800
C: (770) 722-9618
dmarks@markscr.com
324862, Georgia

BRETT DELOACH
VP, Associate Broker
O: (912) 614-3379
bdeLoach@markscr.com
406740, Georgia

PROPERTY PHOTOS

624 SOUTH MILLEDGE AVENUE | ATHENS, GA 30605



MARKS COMMERCIAL REALTY, INC.
1865 W. Broad Street, Suite A
Athens, Georgia 30606

DANIEL MARKS, CCIM
Managing Broker
O: (762) 999-0800
C: (770) 722-9618
dmarks@markscre.com
324862, Georgia

BRETT DELOACH
VP, Associate Broker
O: (912) 614-3379
bdeLoach@markscre.com
406740, Georgia

SUITE 101 FLOOR PLAN

624 SOUTH MILLEDGE AVENUE | ATHENS, GA 30605



The Glass Building

Suite 101

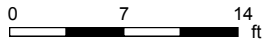
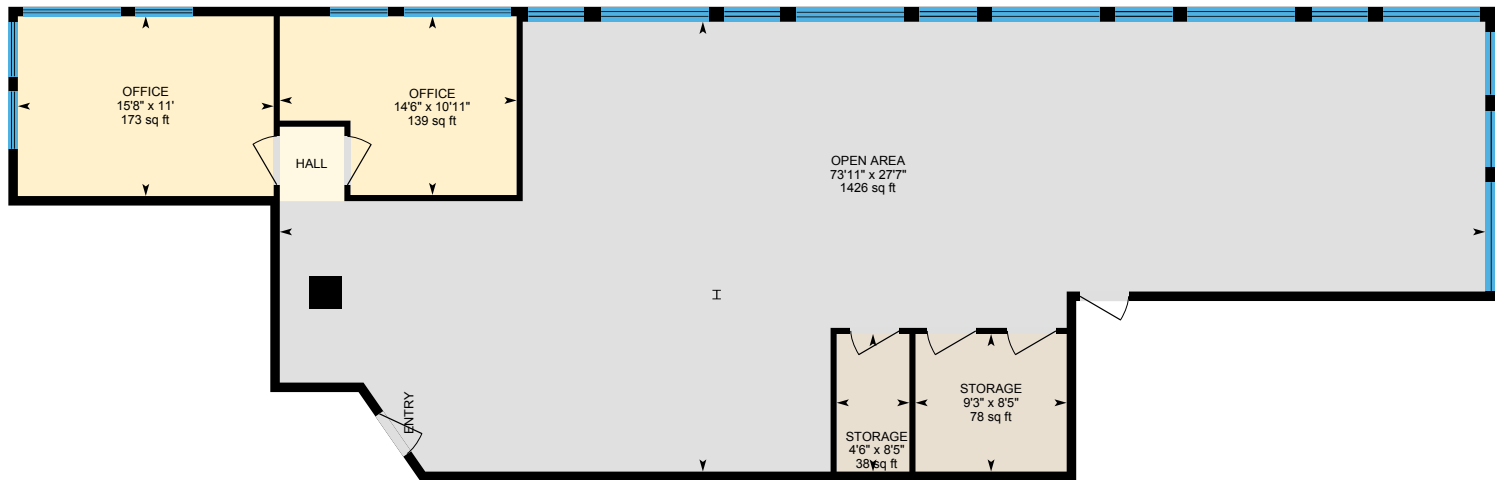

PREPARED: 2026/06/03



White regions are excluded from total floor area in iGUIDE floor plans. All room dimensions and floor areas must be considered approximate and are subject to independent verification.



MARKS COMMERCIAL REALTY, INC.
1865 W. Broad Street, Suite A
Athens, Georgia 30606

DANIEL MARKS, CCIM
Managing Broker
O: (762) 999-0800
C: (770) 722-9618
dmarks@markscr.com
324862, Georgia

BRETT DELOACH
VP, Associate Broker
O: (912) 614-3379
bdeloach@markscr.com
406740, Georgia

INTERIOR PHOTOS

624 SOUTH MILLEDGE AVENUE | ATHENS, GA 30605



MARKS COMMERCIAL REALTY, INC.
1865 W. Broad Street, Suite A
Athens, Georgia 30606

DANIEL MARKS, CCIM
Managing Broker
O: (762) 999-0800
C: (770) 722-9618
dmarks@markscre.com
324862, Georgia

BRETT DELOACH
VP, Associate Broker
O: (912) 614-3379
bdeLoach@markscre.com
406740, Georgia

INTERIOR PHOTOS

624 SOUTH MILLEDGE AVENUE | ATHENS, GA 30605



MARKS COMMERCIAL REALTY, INC.
1865 W. Broad Street, Suite A
Athens, Georgia 30606

DANIEL MARKS, CCIM
Managing Broker
O: (762) 999-0800
C: (770) 722-9618
dmarks@markscre.com
324862, Georgia

BRETT DELOACH
VP, Associate Broker
O: (912) 614-3379
bdeLoach@markscre.com
406740, Georgia

INTERIOR PHOTOS

624 SOUTH MILLEDGE AVENUE | ATHENS, GA 30605



MARKS COMMERCIAL REALTY, INC.
1865 W. Broad Street, Suite A
Athens, Georgia 30606

DANIEL MARKS, CCIM
Managing Broker
O: (762) 999-0800
C: (770) 722-9618
dmarks@markscre.com
324862, Georgia

BRETT DELOACH
VP, Associate Broker
O: (912) 614-3379
bdeLoach@markscre.com
406740, Georgia

AERIAL MAP

624 SOUTH MILLEDGE AVENUE | ATHENS, GA 30605



MARKS COMMERCIAL REALTY, INC.
1865 W. Broad Street, Suite A
Athens, Georgia 30606

DANIEL MARKS, CCIM
Managing Broker
O: (762) 999-0800
C: (770) 722-9618
dmarks@markscre.com
324862, Georgia

BRETT DELOACH
VP, Associate Broker
O: (912) 614-3379
bdeloach@markscre.com
406740, Georgia