

HOLLY HILL MALL
309 HUFFMAN MILL ROAD
BURLINGTON, NC 27215

42,639 SF FOR LEASE



Chip Lanier, MBA
clanier@lee-associates.com
O 919.576.2516
M 919.291.6282

Jenn Olevitch-Roberson
jolevitch-roberson@lee-associates.com
D: 919.576.2517
C: 919.345.1752

Loup Gajigianis
lgajigianis@lee-associates.com
D: 984.684.5008
C: 919.338.4018

 **LEE &
ASSOCIATES**
COMMERCIAL REAL ESTATE SERVICES
RALEIGH • DURHAM • WILMINGTON

PROPERTY OVERVIEW

AVAILABILITY

- 42,639 SF Built-out office
- Former call center
- Suitable for office, entertainment or medical uses

PROPERTY HIGHLIGHTS

- Located at the intersection of Huffman Mill Road and S. Church Street (Hwy 70)
- Convenient to I-40 and I-85
- Adjacent to the Church Street Commons, a Publix anchored center with MOD Pizza, My Eyelab, Aspen Dental, and Crumbl Cookies

DEMOGRAPHICS

	1 Mile	3 Miles	5 Miles
Population	6,919	46,672	97,060
Avg. HH Income	\$93,152	\$94,369	\$86,145
No. of Businesses	534	2,124	3,668
No. of Employees	6,240	29,332	46,089
Daytime Population	10,043	57,555	103,346

Source: ESRI 2025

DRIVE TIME

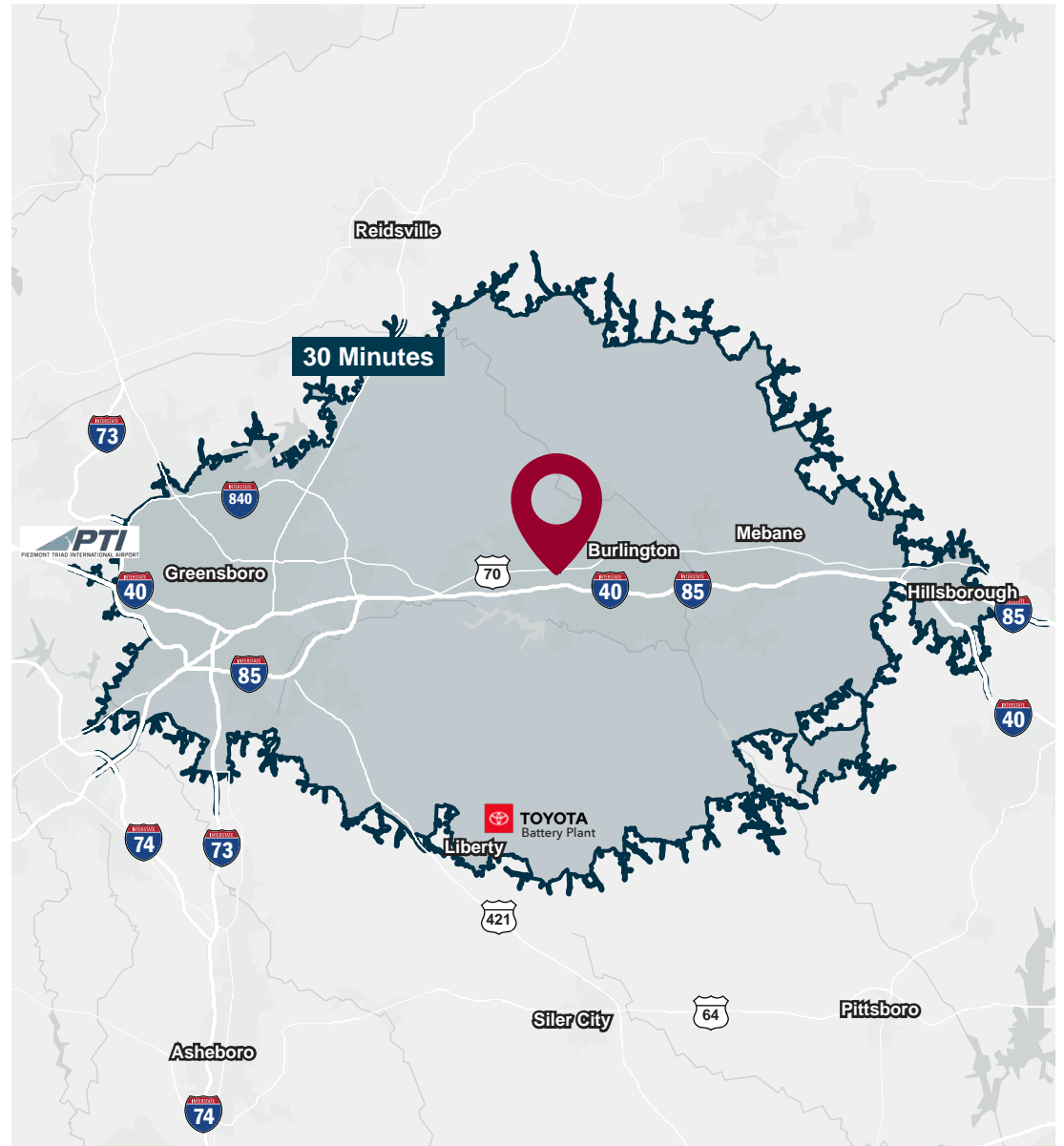

HOLLY HILL MALL • 309 HUFFMAN MILL RD • BURLINGTON, NC 27215

SITE PLAN

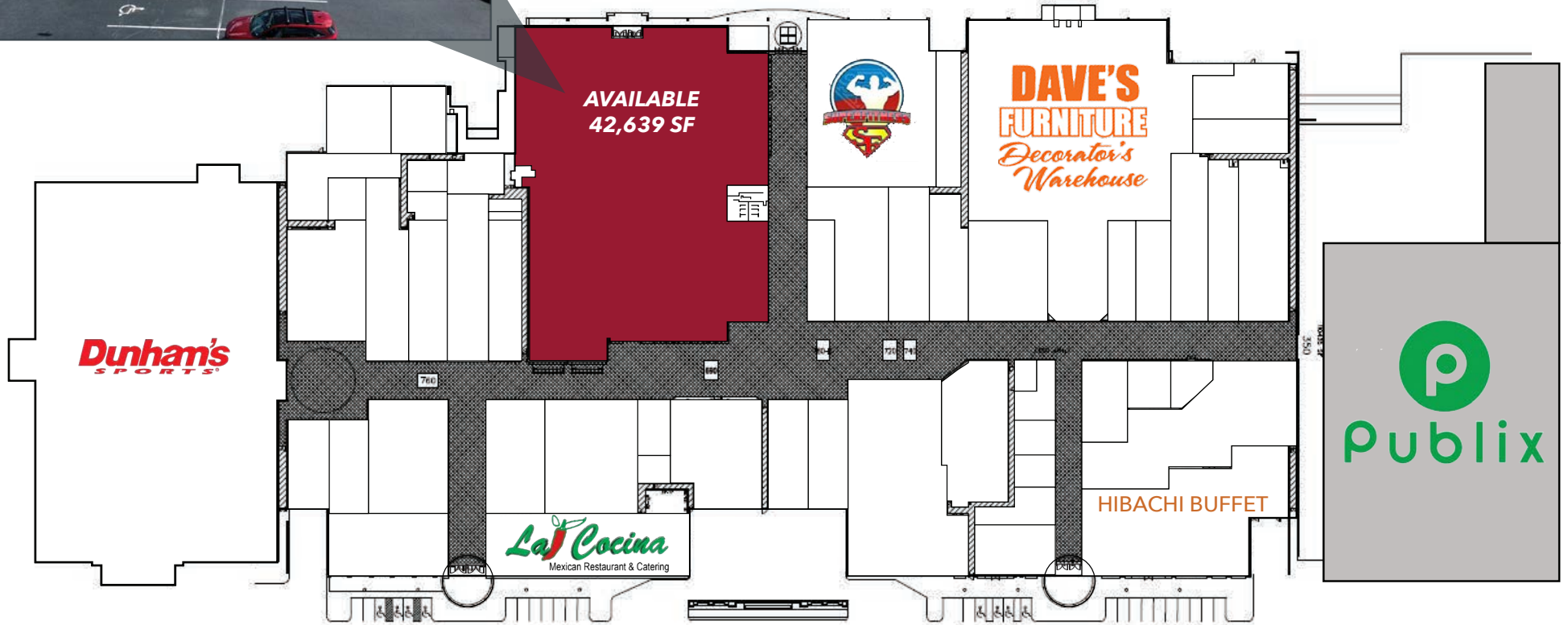

HOLLY HILL MALL • 309 HUFFMAN MILL RD • BURLINGTON, NC 27215

PHOTOS

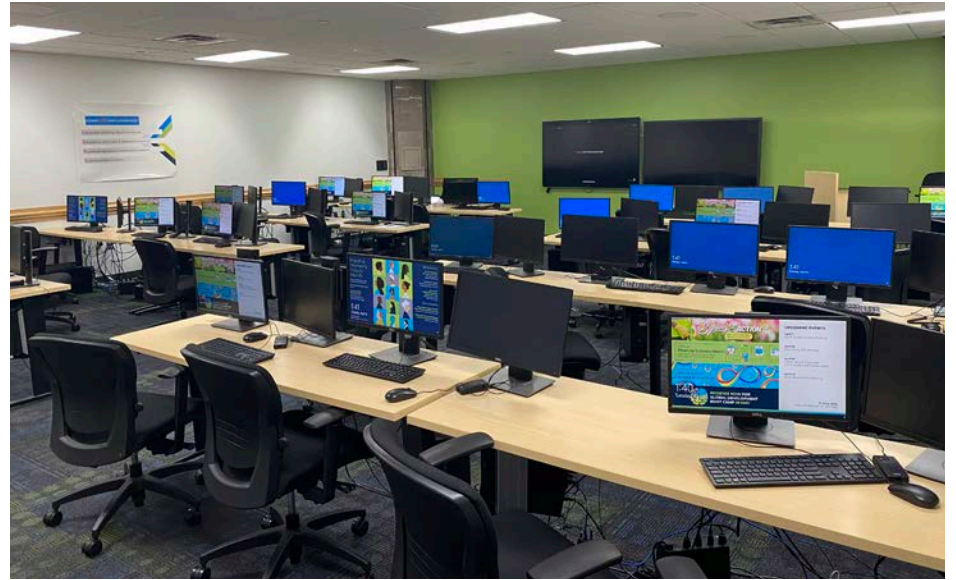
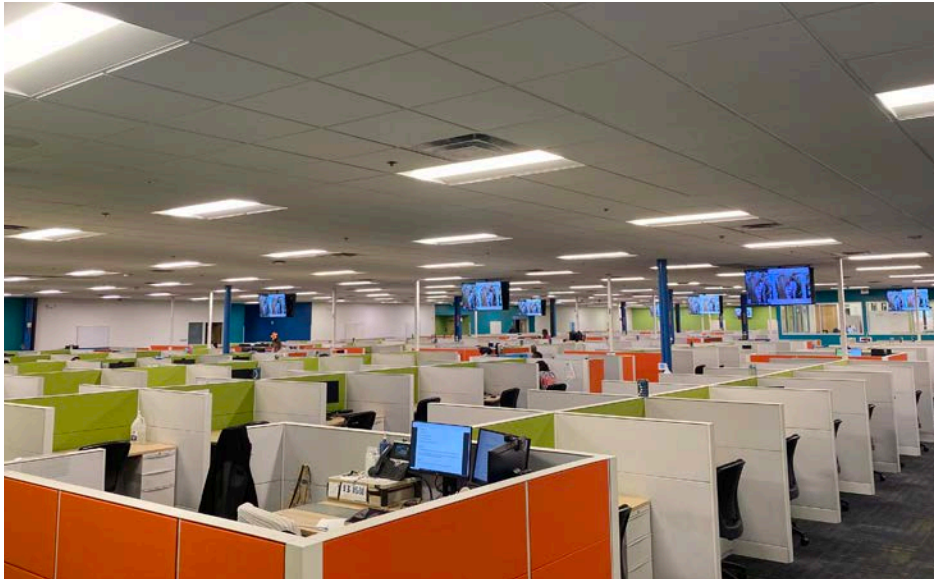

HOLLY HILL MALL • 309 HUFFMAN MILL RD • BURLINGTON, NC 27215

FLOOR PLAN

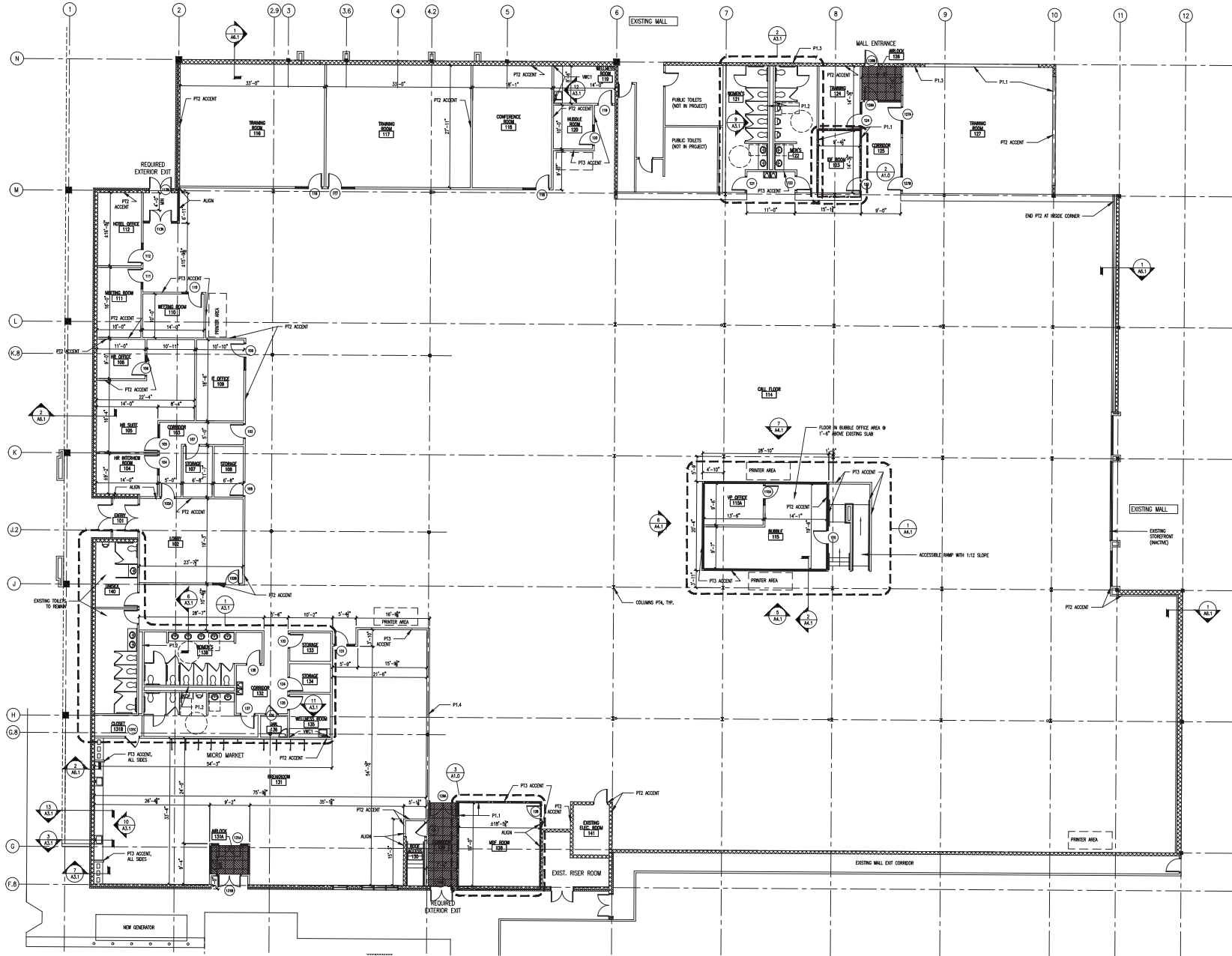

HOLLY HILL MALL • 309 HUFFMAN MILL RD • BURLINGTON, NC 27215

RETAILER MAP

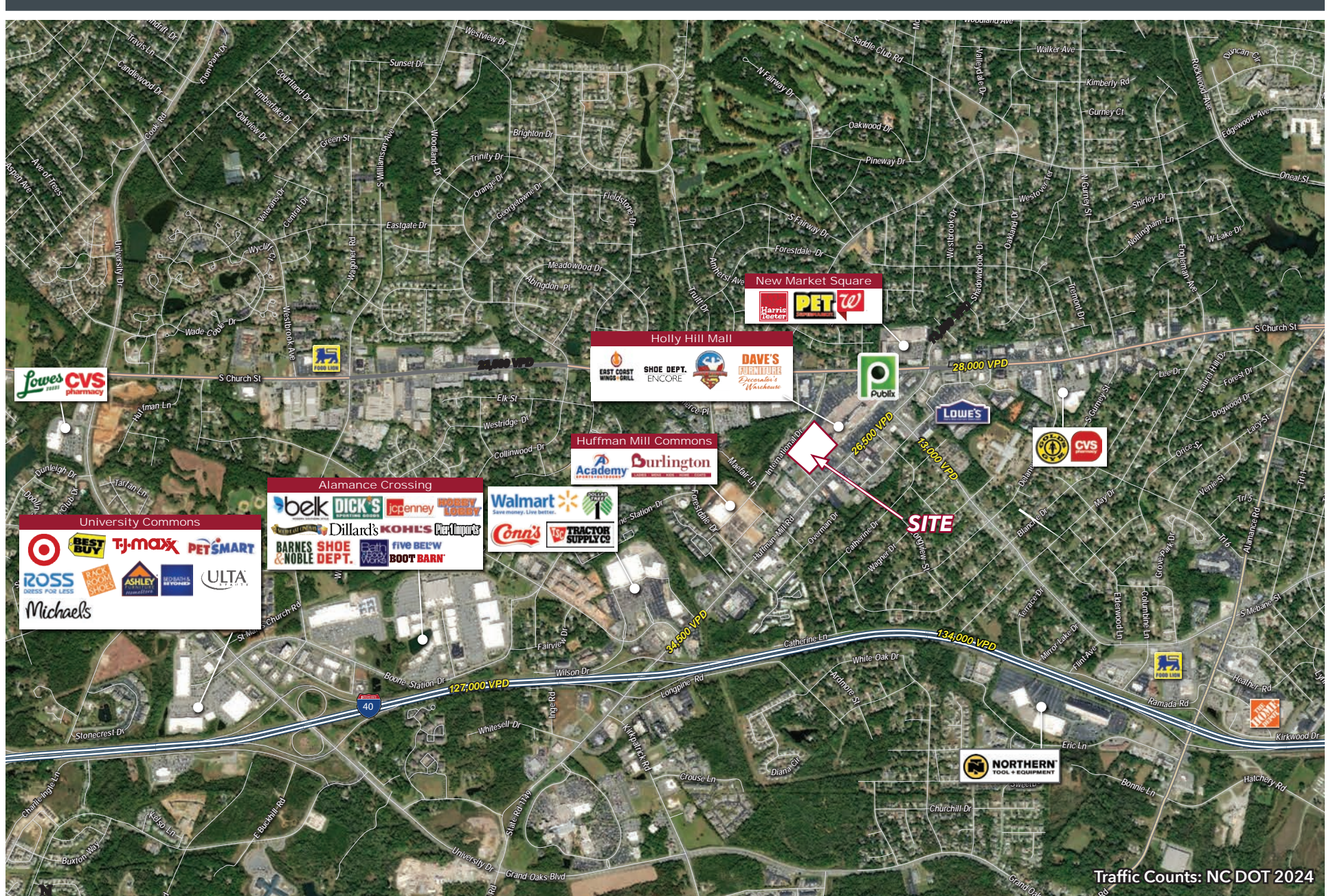

HOLLY HILL MALL • 309 HUFFMAN MILL RD • BURLINGTON, NC 27215

Presented by:

Chip Lanier
Vice President
clanier@lee-associates.com
D: 919.576.2516

Jenn Olevitch-Roberson
Vice President
jolevitch-roberson@lee-associates.com
D: 919.576.2517

Loup Gajigianis
Associate Broker
lgajigianis@lee-associates.com
D: 984.684.5008



All information furnished regarding property for sale, rental or financing is from sources deemed reliable, but no warranty or representation is made to the accuracy thereof and same is submitted to errors, omissions, change of price, rental or other conditions prior to sale, lease or financing or withdrawal without notice. No liability of any kind is to be imposed on the broker herein.

100 Walnut Street | Cary, NC 27511 | 919-576-2500 | lee-associates.com/raleigh

