

SALT LAKE OFFICE WAREHOUSE FOR LEASE

2400 SOUTH 600 WEST, SALT LAKE CITY, UTAH 84115

GREAT CENTRAL LOCATION WITH I-15 VISIBILITY



PROPERTY HIGHLIGHTS

- 10,405 SF Office/Flex Available
- Clear Height: 17' - 20'
- 5,805 SF Main Level | 4,600 SF Mezzanine
- 3 Phase Power
- 5,000 - 10,000 SF Warehouse Space Available
- Possible Signage Available
- Yard Space Available
- I-15 Visibility
- Potential Access to Shared Dock Doors
- Easy Access to I-15, S.R. 201 & I-80

LEASE RATE REDUCED! : \$0.99/SF MONTH NNN

Contact:
801.617.1715

JEREMY SIEVERTS
JEREMY.SIEVERTS@CRCNATIONWIDE.COM



SALT LAKE OFFICE WAREHOUSE FOR LEASE

2400 SOUTH 600 WEST, SALT LAKE CITY, UTAH 84115

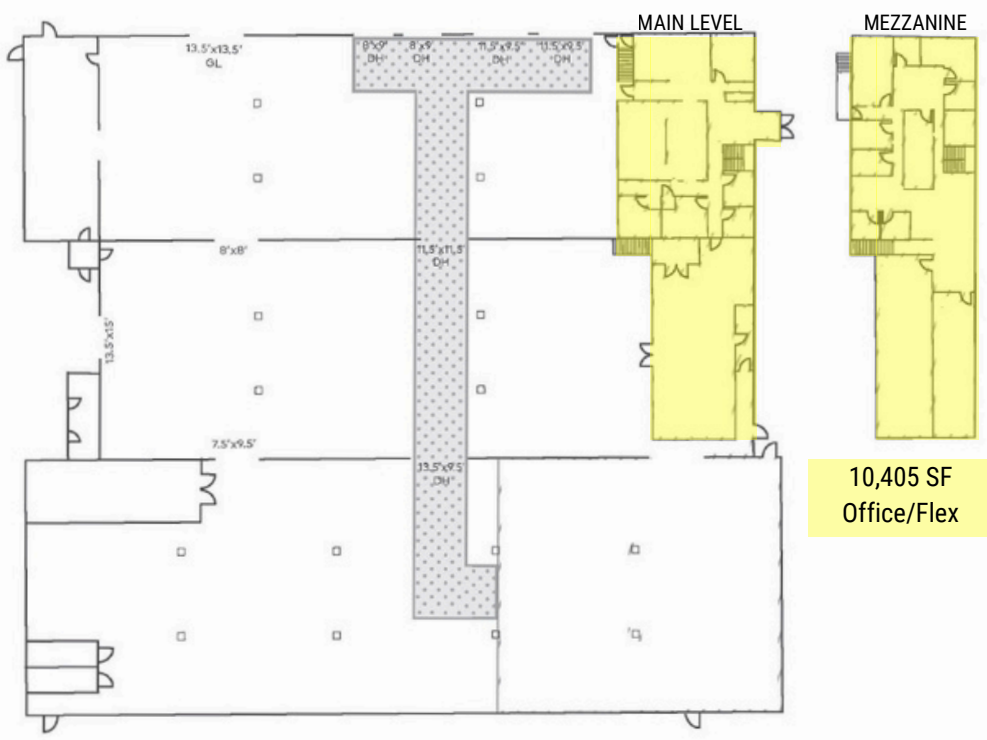

This information is given with the understanding that all negotiations and/or real estate activity related to the property described above shall be conducted through this cRc Nationwide office. The information while not guaranteed, was obtained from sources we believe to be reliable.

Contact:
801.617.1715

JEREMY SIEVERTS
JEREMY.SIEVERTS@CRCNATIONWIDE.COM