

FOR LEASE

# LANDMARK COMMERCE CENTER

1300 N Florida Mango Road, West Palm Beach, FL



## Property Features

### Suites 22-25

- 8,800 SF
- 3,150 SF Office
- 14' Clear Height
- 3 Bathrooms
- 1 Dock
- 1 Grade Door
- 100% HVAC

### Lease Rate

- \$18.95 NNN PSF
- \$6.79 OPEX

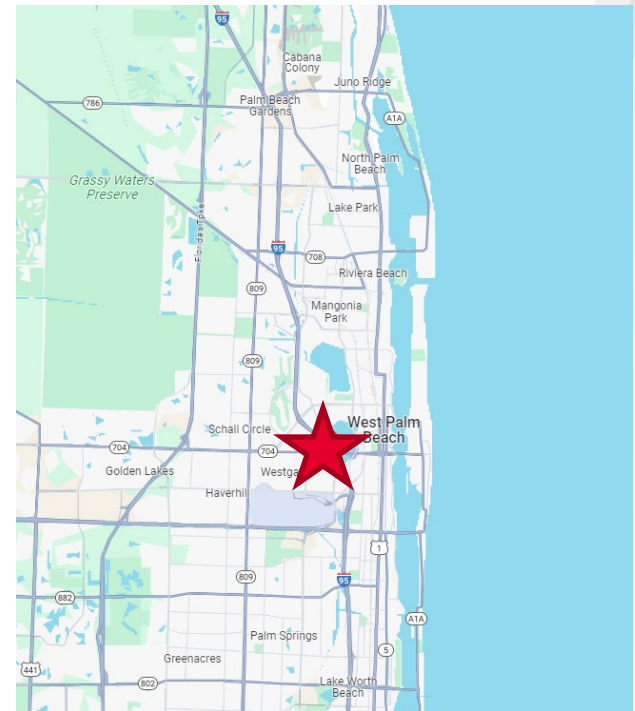

## Contact

Christopher Thomson, SIOR  
Vice Chairman  
+1 561 227 2019

[Christopher.thomson@cushwake.com](mailto:Christopher.thomson@cushwake.com)

Eric Cantor  
Senior Associate  
+1 561 227 2068

[Eric.cantor@cushwake.com](mailto:Eric.cantor@cushwake.com)

Juliana Palmisano  
Brokerage Specialist  
+1 561 729 7478

[Juliana.palmisano@cushwake.com](mailto:Juliana.palmisano@cushwake.com)

FOR LEASE

# LANDMARK COMMERCE CENTER

1300 N Florida Mango Road, West Palm Beach, FL

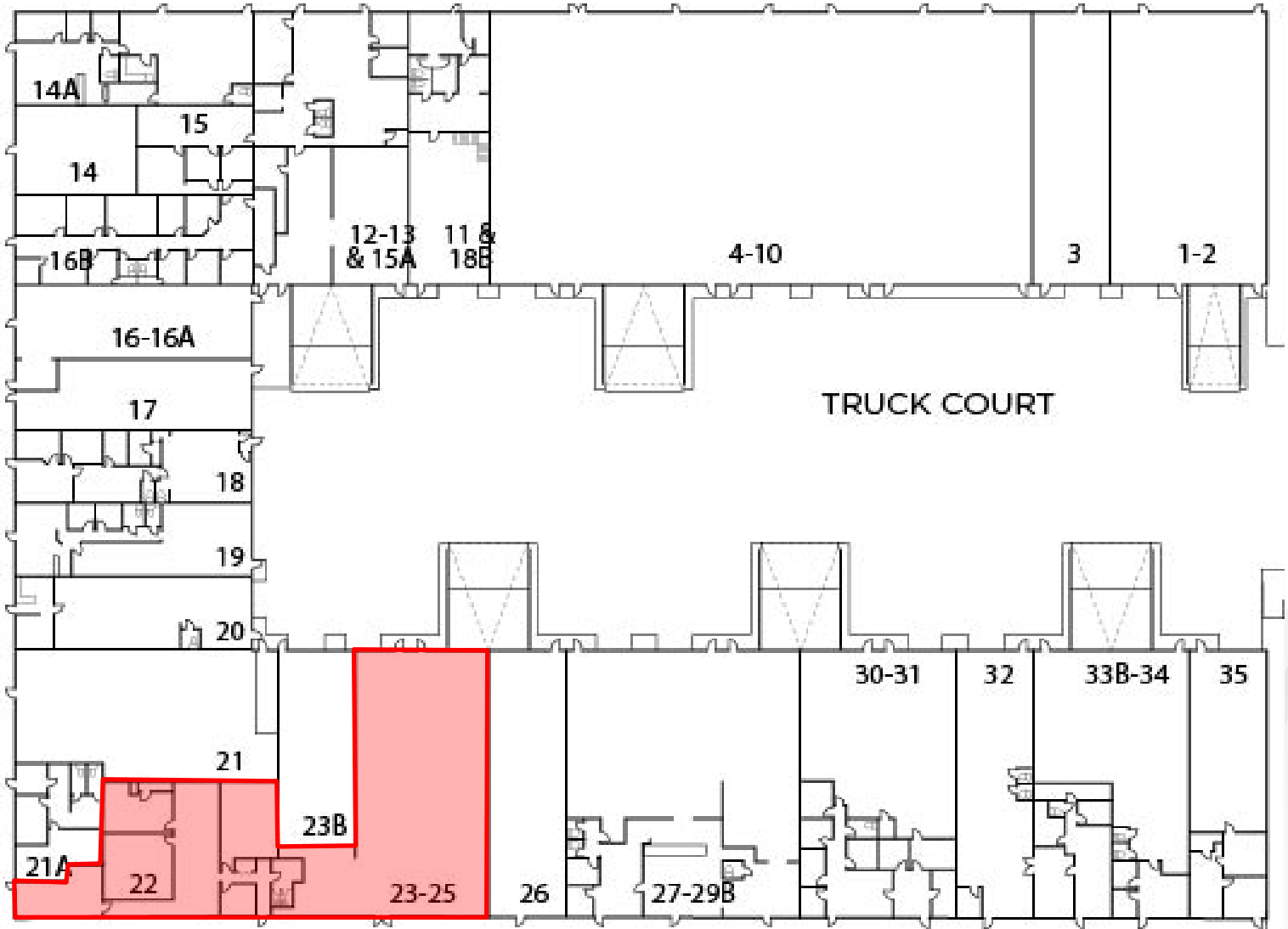

## Contact

Christopher Thomson, SIOR  
Vice Chairman  
+1 561 227 2019  
[Christopher.thomson@cushwake.com](mailto:Christopher.thomson@cushwake.com)

Eric Cantor  
Senior Associate  
+1 561 227 2068  
[Eric.cantor@cushwake.com](mailto:Eric.cantor@cushwake.com)

Juliana Palmisano  
Brokerage Specialist  
+1 561 729 7478  
[Juliana.palmisano@cushwake.com](mailto:Juliana.palmisano@cushwake.com)

Owned By:

**ARDEN** | LOGISTICS  
P A R K S