

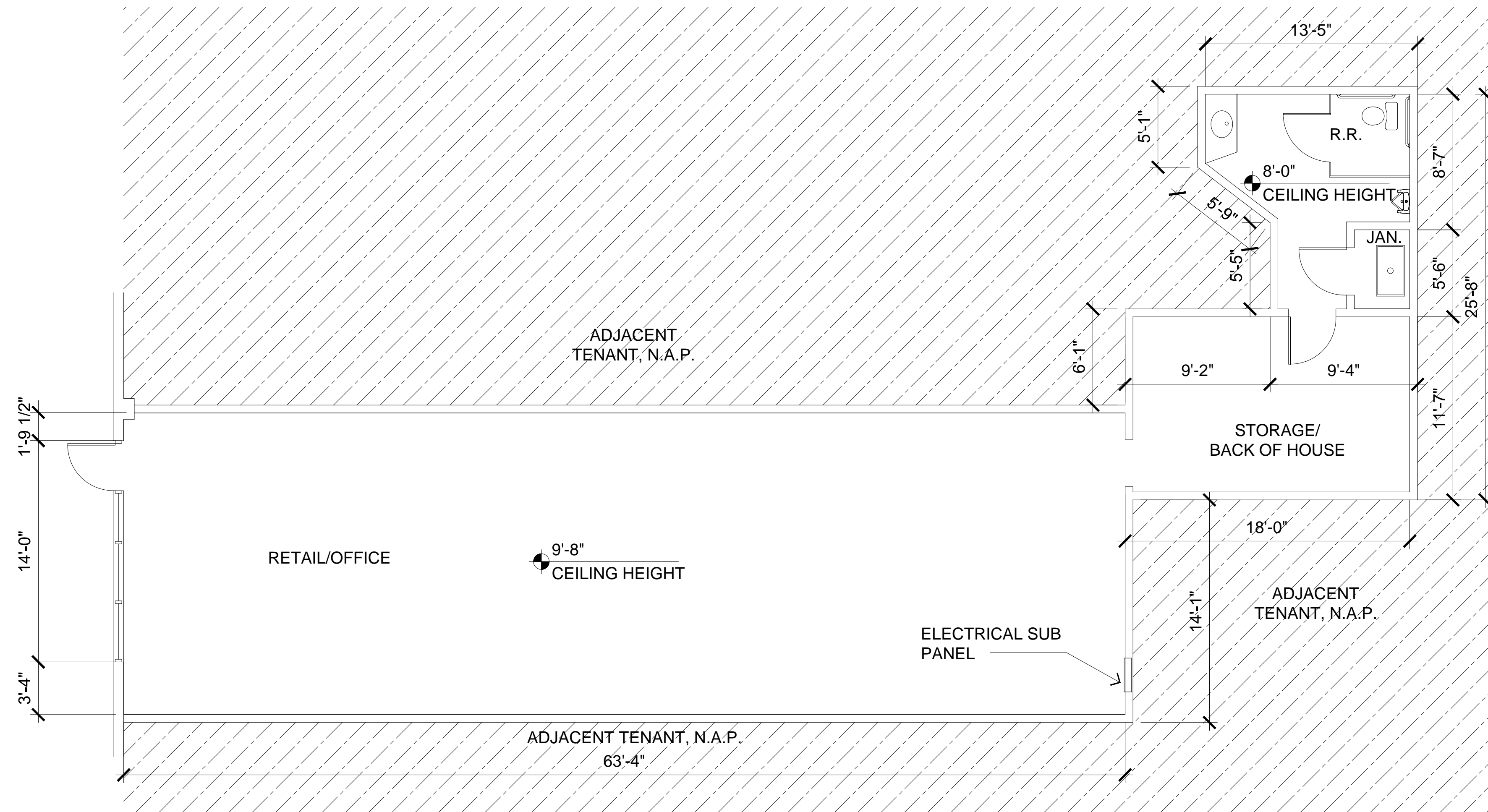



NOTICE

THESE MODIFIED OR OTHER DRAWINGS HAVE BEEN PREPARED, IN WHOLE OR IN PART, ON THE BASIS OF INFORMATION COMPILED AND FURNISHED BY OTHERS UNDER AGREEMENT WITH THE OWNER OF THE PROJECT. e3 ARCHITECTURE IS NOT RESPONSIBLE FOR ANY ERRORS OR OMISSIONS WHICH HAVE BEEN INCORPORATED INTO THIS DOCUMENT AS A RESULT. CAREFUL EXAMINATION OF ACTUAL CONSTRUCTION SHOULD BE UNDERTAKEN PRIOR TO EXCAVATION, CUTTING, MODIFICATION, OR CONNECTION OF SUBSEQUENT CONSTRUCTION.

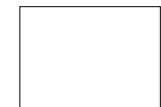
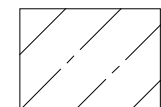

AREA LEGEND

-  RETAIL/OFFICE
-  RESTROOMS
-  WAREHOUSE/BACK OF HOUSE
-  UTILITY/COMMON AREAS
-  ADJACENT TENANT, N.A.P.

SUITE DATA

RETAIL:	1,260 SF
RESTROOM:	132 SF
WAREHOUSE	216 SF
UTILITES:	22 SF
TOTAL BUILDING AREA:	1,630 SF

1. EXTERIOR STUCCO OVER CMU BLOCK CONSTRUCTION
2. ROOFTOP MOUNTED MECHANICAL UNITS

APPROVED:

DATE:

FLOOR PLAN

0 1 4 8

3929 Spring Mountain Road
Las Vegas, NV 89102

A DEVELOPMENT BY:

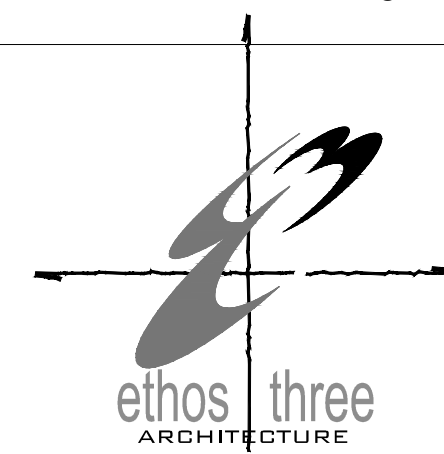

DATE:
12.27.2018
SCALE
1/4" = 1'-0"
SPACE:
3929 Spring Mtn.