

# 803 Niagara Street North | Welland

New Development Commercial Space For Lease

LEON'S ANCHORED



Leon's

CBRE

# Retail For Lease



Retail Space	Building D (Freestanding)	Building E	Building F	Building G (Drive Thru Opportunity)
Size Available	3,600 Sq. Ft.	1,300 - 5,750 Sq. Ft.	1,660 or 2,220 Sq. Ft.	1,500-4,400 Sq. Ft.
Asking Price	CONTACT LISTING AGENT (SUBJECT TO LANDLORD WORK & DEAL TERMS)			
TMI	Estimated \$13.00 Per Sq. Ft.			
Possession Date	Q2 2026			

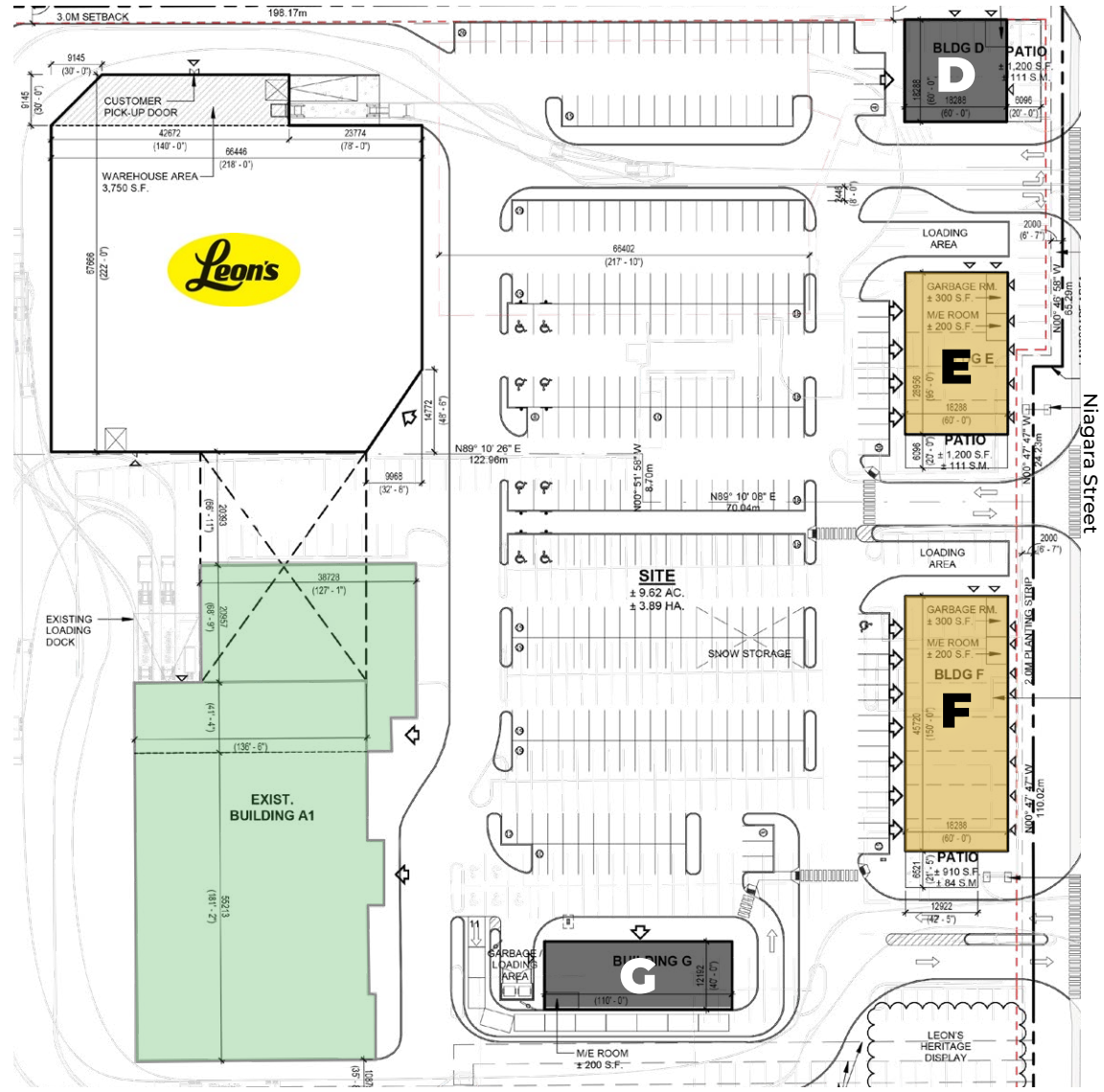

- RETAIL SPACE FOR LEASE
- EXISTING BIG BOX SPACE
- FUTURE DEVELOPMENT

# Commercial Unit Plan - Building F

Niagara Street

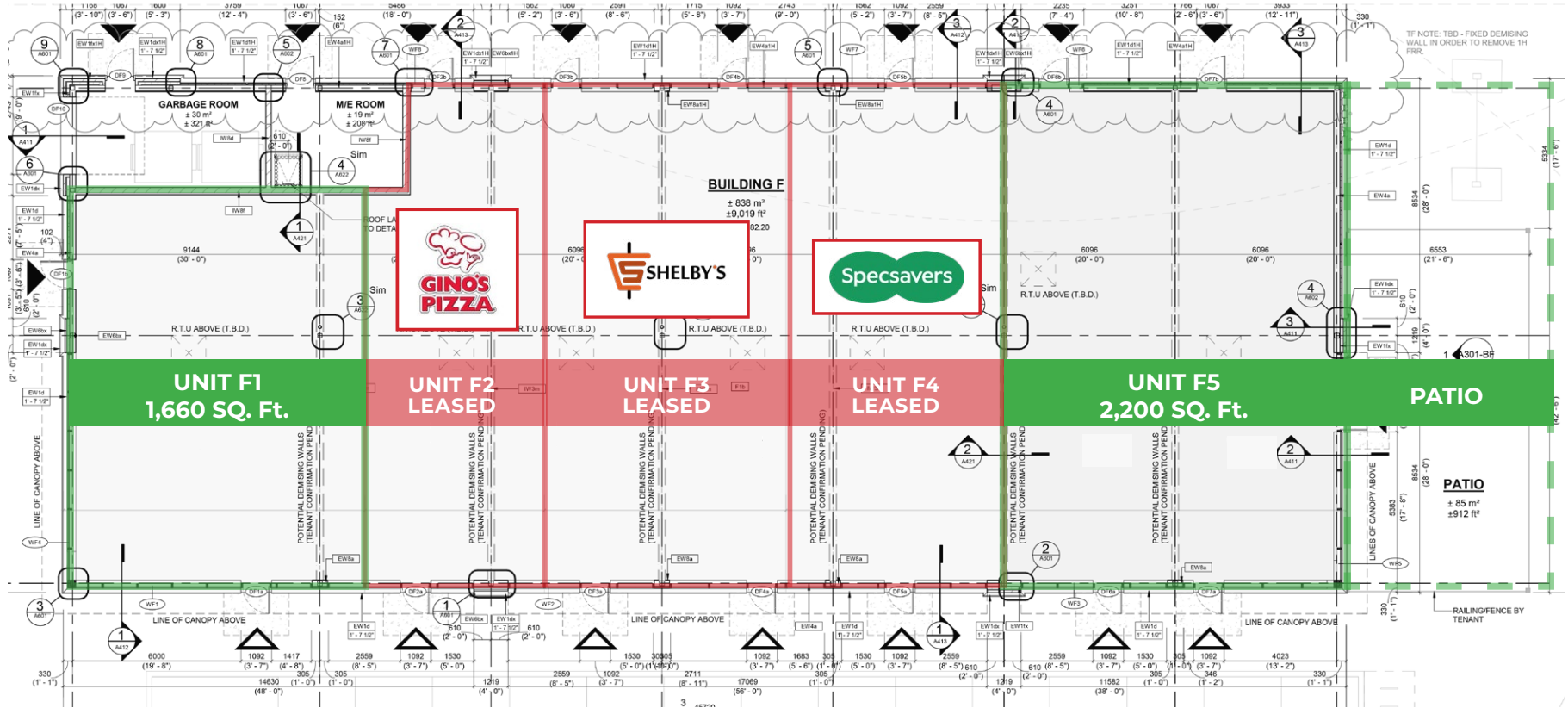

Retail Space	Unit F1	Unit F5
Size Available	1,660 Sq. Ft.	2,200 Sq. Ft.
Asking Price	CONTACT LISTING AGENT (SUBJECT TO LANDLORD WORK & DEAL TERMS)	
TMI	Estimated \$13.00 Per Sq. Ft.	
Possession Date	Q2 2026	

■ AVAILABLE UNIT  
■ LEASED UNIT

# Commercial Unit Plan - Building E

Niagara Street

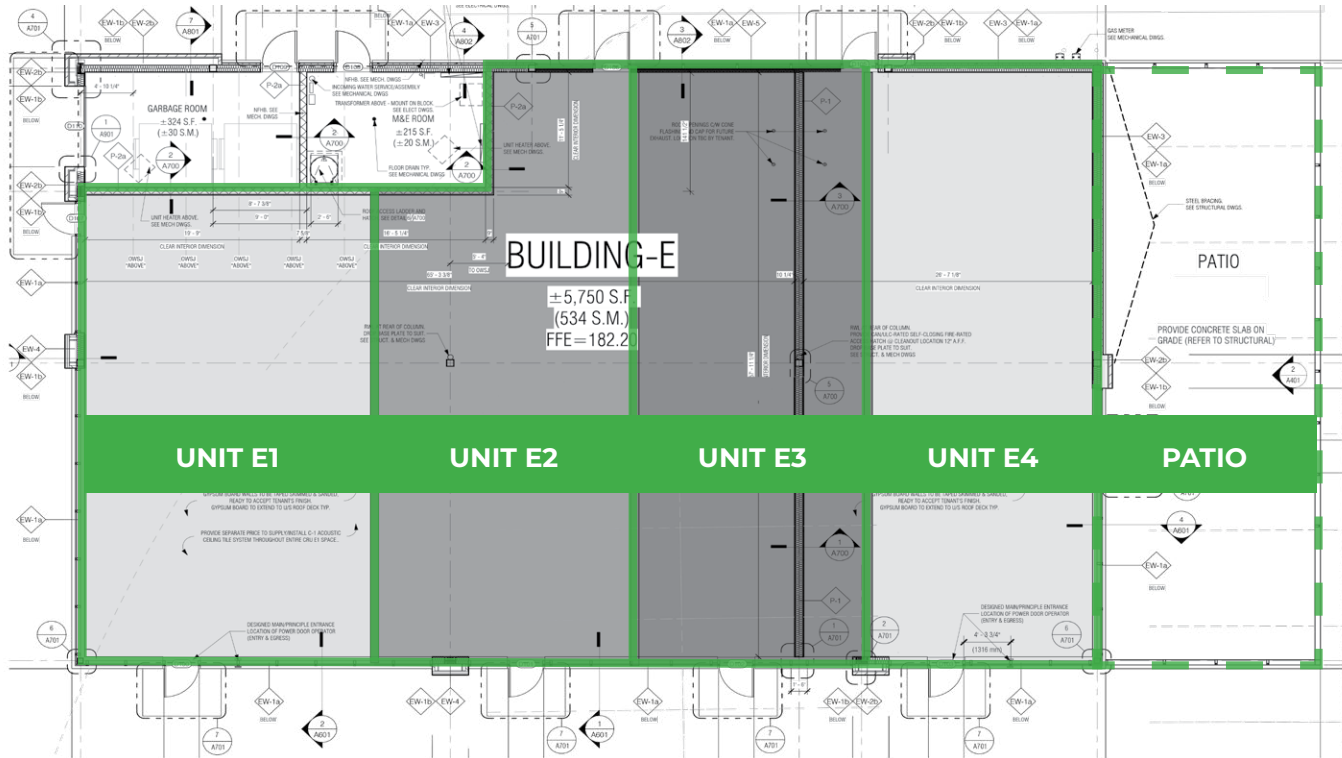

Retail Space	Building E (demisable)
Size Available	1,300 - 5,750 Sq. Ft.
Asking Price	CONTACT LISTING AGENT (SUBJECT TO LANDLORD WORK & DEAL TERMS)
TMI	Estimated \$13.00 Per Sq. Ft.
Possession Date	Q2 2026

 AVAILABLE UNIT

# Commercial Unit Plan - Building A1

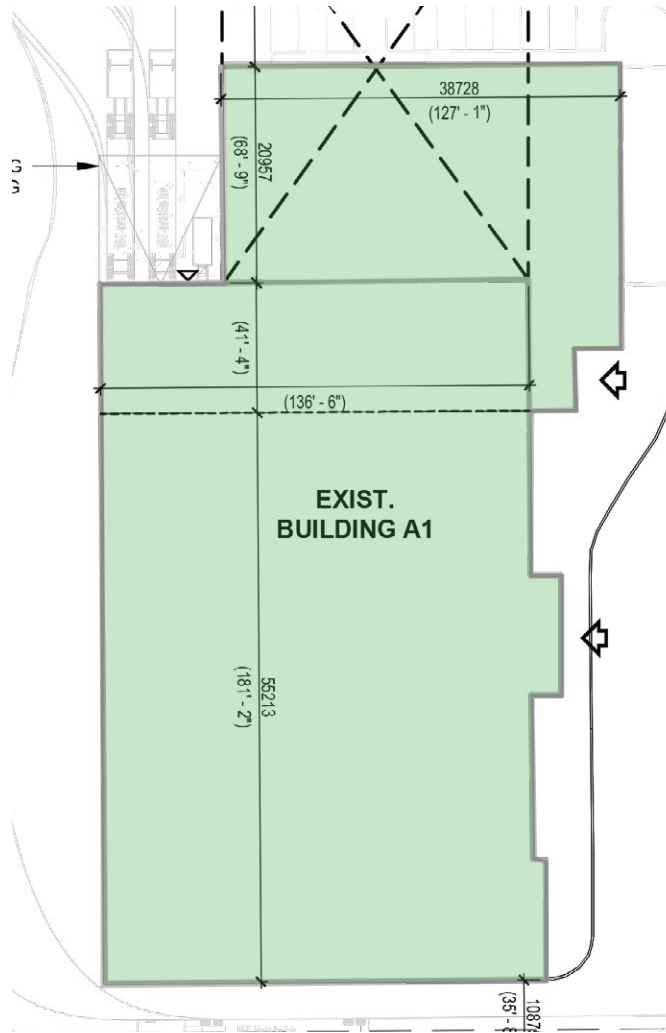

Retail Space	Building A1
Size Available	+/- 39,000 Sq. Ft.
Asking Price	CONTACT LISTING AGENT (SUBJECT TO LANDLORD WORK & DEAL TERMS)
TMI	CONTACT LISTING AGENT
Possession Date	July 1st, 2026





# PROJECT UPDATE - JAN 2026



# Location & Amenities



# Demographics

	1 KM	3 KM	5 KM
 Total Population 2025	4,654	34,139	72,949
 Daytime Population 2025	4,687	28,413	62,072
 Population Growth 2025 - 2030	2.1%	3.6%	3.3%
 Household Income 2025	\$118,598	\$111,350	\$112,877

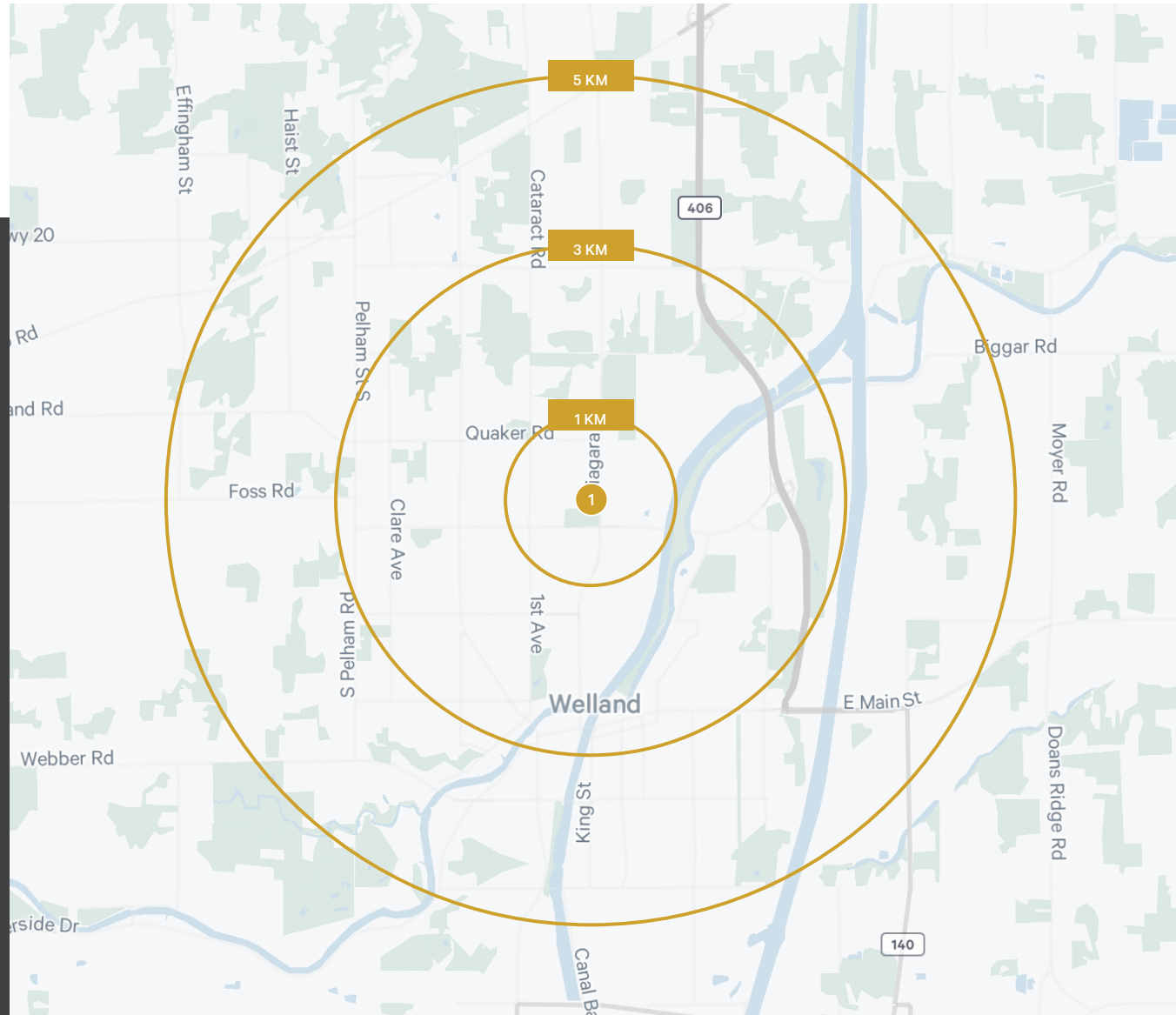

# Zoning & Permitted Uses



## CITY OF WELLAND | ZONING BY-LAW (RS-REGIONAL SHOPPING NODE)

PERMITTED USES INCLUDING BUT NOT LIMITED TO:

- Art Gallery
- Assembly Hall
- Clubs, Private
- Custom Workshop
- Day Care Centre
- Day Care, Home
- Department Store
- Drive-Through Establishment
- Educational Establishment
- Emergency Service
- Financial Establishment
- Flea Market
- Food Production
- Funeral Home
- Garden Centre
- Grocery Store
- Health Related Retail Use
- Home and Auto Sales and Supply Establishment
- Home Furnishing Establishment
- Home Improvement Establishment
- Library
- Light Equipment/Machinery Sales, Rental and Service Establishment
- Mini Storage
- Motor Vehicle Sales Dealership
- Motor Vehicle Service Station
- Motor Vehicle Repair Shop
- Motor Vehicle Washing Establishment
- Museum
- Outside Display and Sales Area
- Parking Lot
- Parking Structure or Garage
- Pet Care Establishment
- Pet Shop
- Place of Entertainment
- Place of Worship
- Repair Shop
- Research and Development Establishment
- Restaurant
- Retail Centre
- Retail Establishment
- Sample or Showroom
- Social Services Establishment
- School, Commercial
- Seasonal Outdoor Use
- Service Commercial Establishment
- Supermarket
- Veterinary Clinic

\*BUYERS/TENANTS ARE RESPONSIBLE FOR CONFIRMING ZONING AND PERMITTED USES.

[CLICK TO VIEW  
RS  
ZONING BY LAW](#)

[CLICK TO VIEW  
WELLAND  
ZONING DEFINITIONS](#)

# 803

## Niagara Street North | Welland

New Development Commercial Space For Lease

### FOR MORE INFORMATION PLEASE CONTACT:

**Nicholas Regan\***

Senior Sales Associate  
416 801 1658  
nicholas.regan@cbre.com

**Matthew Pieszchala\***

Vice President  
905 234 0376  
matthew.pieszchala@cbre.com

**Adam Occhipinti\***

Vice President  
416 798 6265  
adam.occhipinti@cbre.com

**Karlyn Knafo\***

Associate Vice President  
905 234 0381  
karlyn.knafo@cbre.com

CBRE Limited, Real Estate Brokerage | 5935 Airport Road | Suite 700 | Mississauga, ON | L4V 1W5 \*Sales Representative

This disclaimer shall apply to CBRE Limited, Real Estate Brokerage, and to all other divisions of the Corporation ("CBRE"). The information set out herein, including, without limitation, any projections, images, opinions, assumptions and estimates obtained from third parties (the "Information") has not been verified by CBRE, and CBRE does not represent, warrant or guarantee the accuracy, correctness and completeness of the Information. CBRE does not accept or assume any responsibility or liability, direct or consequential, for the Information or the recipient's reliance upon the Information. The recipient of the Information should take such steps as the recipient may deem necessary to verify the Information prior to placing any reliance upon the Information. The Information may change and any property described in the Information may be withdrawn from the market at any time without notice or obligation to the recipient from CBRE. CBRE and the CBRE logo are the service marks of CBRE Limited and/or its affiliated or related companies in other countries. All other marks displayed on this document are the property of their respective owners. All Rights Reserved. Mapping Sources: Canadian Mapping Services [canadamapping@cbre.com](mailto:canadamapping@cbre.com); DMTI Spatial, Environics Analytics, Microsoft Bing, Google Earth. All rates, measurements, plans and specifications subject to change E. & O. E

