



ENTERPRISE DISTRIBUTION CENTER | FOR LEASE

1101 ENTERPRISE AVE., SUITE 22A, OKLAHOMA CITY, OK

KARLEY HARPER, CCIM
kharper@newmarkrp.com
C: 405.371.3498

KRIS DAVIS, SIOR
kgdavis@newmarkrp.com
C: 405.202.9525

BRETT PRICE, CCIM, SIOR
bprice@newmarkrp.com
C: 405.613.8380

NEWMARK
ROBINSON PARK

1101 ENTERPRISE AVE., SUITE 22A / FOR LEASE



PROPERTY OVERVIEW

Enterprise Distribution Center is located directly south of I-40 and less than 2 miles west of I-44 which allows for convenient and quick access to Oklahoma's interstate system. The property is located in a densely populated commercial area with a multitude of restaurants and national retailers within a 3 mile radius. Will Rogers International Airport is approximately 3 miles to the south.

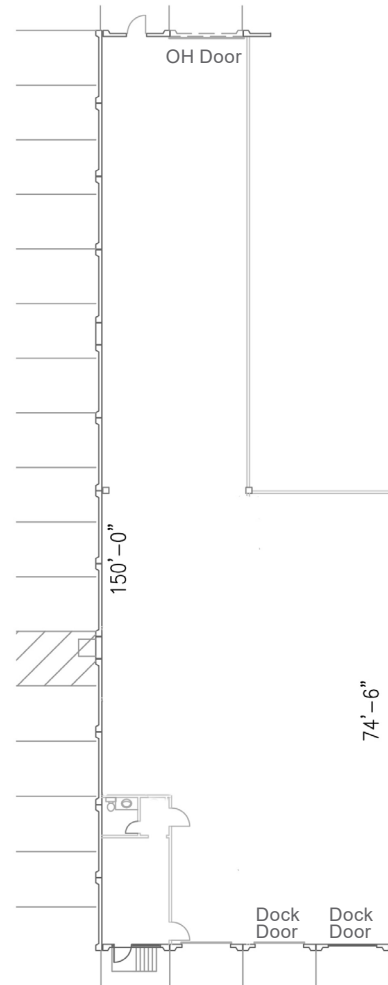

DETAILS

| | |
|----------------------|-----------------------------|
| Available SF | 5,472 SF |
| Lease Rate | Contact Broker |
| Building Size | 63,840 SF |
| Zoning | I-2 |
| Cross Streets | S Meridian & Enterprise Way |

HIGHLIGHTS

- 2 dock high doors
- 1 grade level door
- 24' column spacing
- 18' clear height
- Available now
- Can be combined with neighboring suite for a total of 10,944 SF