

AVAILABLE FOR LEASE

1147 ATLANTIC STREET | UNION CITY, CA



LISTING DATA:

- 6,850± SF Industrial Space
- 1,200± SF Office Area
- 2 Drive-In Doors
- Entire Property is Fenced & Secured

ECONOMIC DATA:

- Lease Rate: \$1.55/SF, I.G.
- Available Now

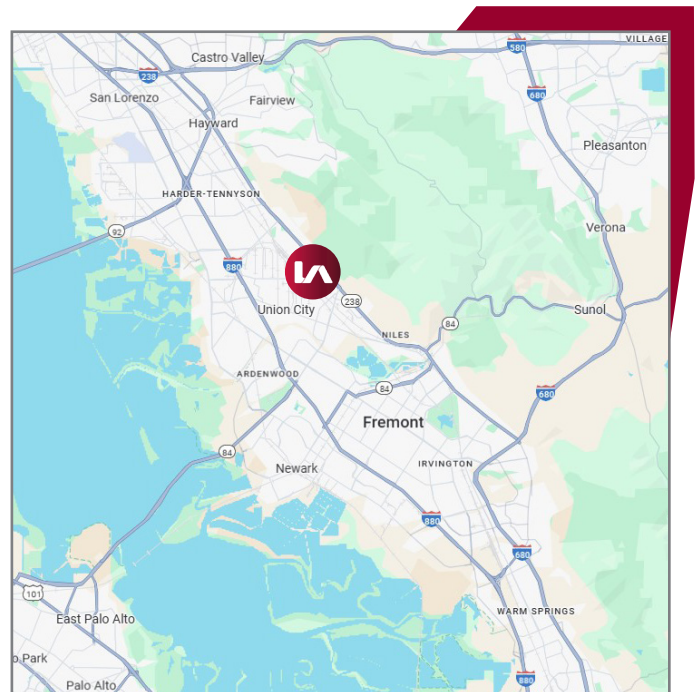

EXCLUSIVE AGENTS:

Ryan Martens, Principal
E \\ rmartens@lee-associates.com
P \\ 510.903.7605 | LIC# 01709157

Nathan Vance, Principal
E \\ nvance@lee-associates.com
P \\ 510.907.3021 | LIC# 02039163

Jesse Lucas, Principal
E \\ jlucas@lee-associates.com
P \\ 510.903.7607 | LIC# 01264756

AVAILABLE FOR LEASE

1147 ATLANTIC STREET | UNION CITY, CA



COMMERCIAL REAL ESTATE SERVICES

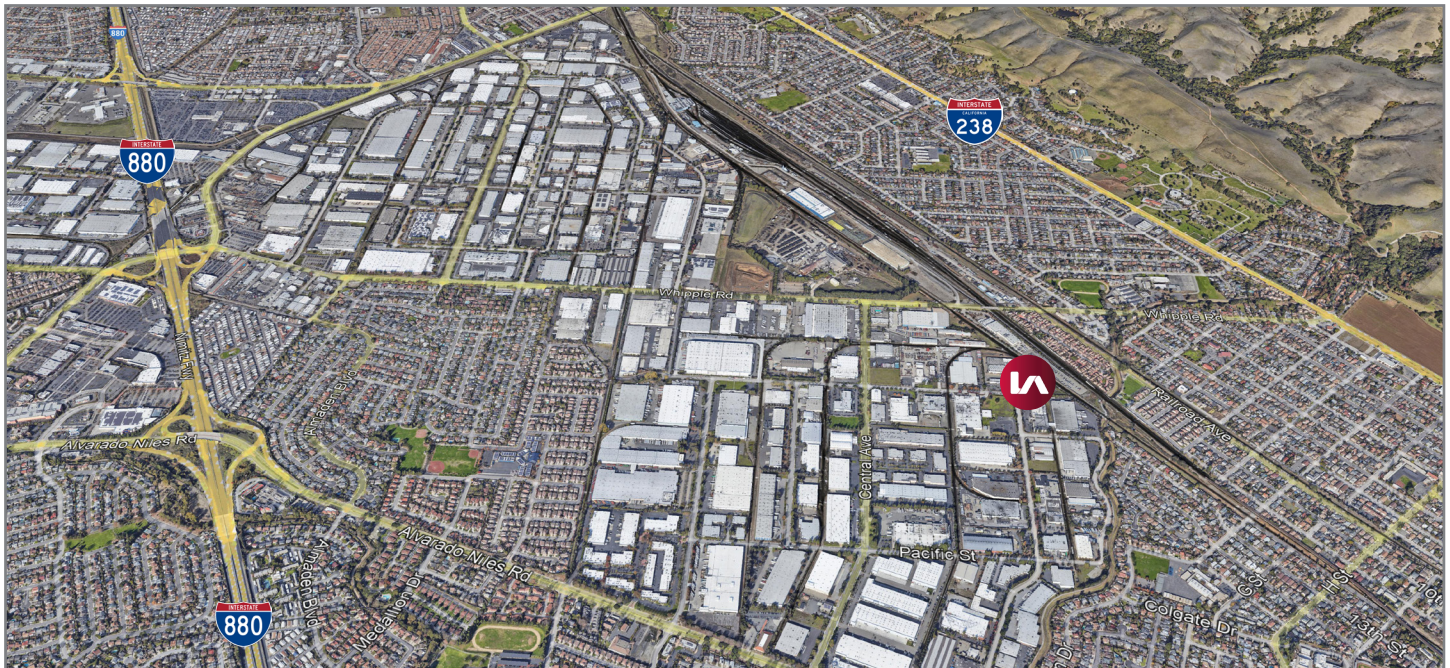
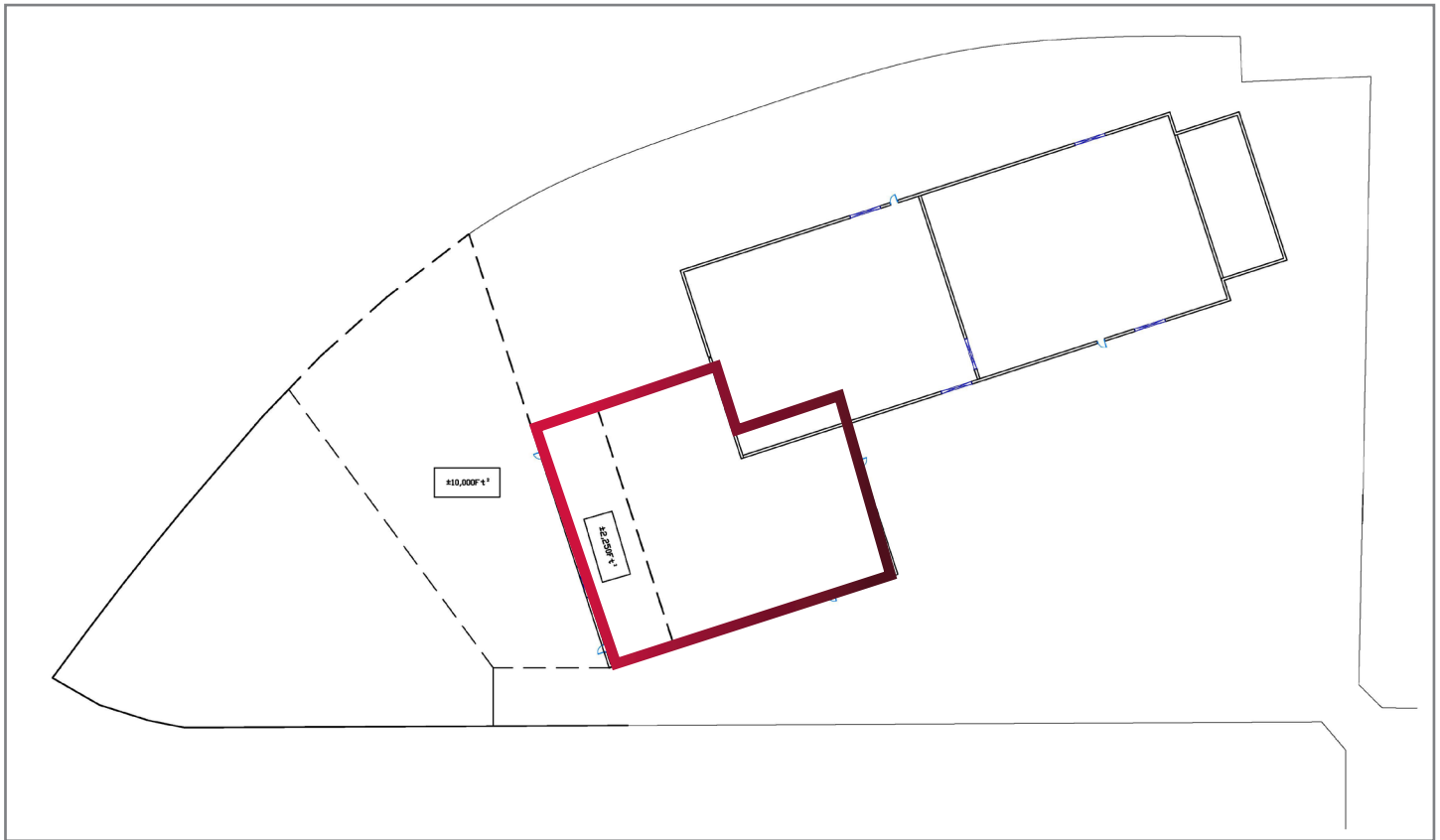

EXCLUSIVE AGENTS:

Ryan Martens, Principal

E \\ rmartens@lee-associates.com

P \\ 510.903.7605 | LIC# 01709157

Nathan Vance, Principal

E \\ nvance@lee-associates.com

P \\ 510.907.3021 | LIC# 02039163

Jesse Lucas, Principal

E \\ jlucas@lee-associates.com

P \\ 510.903.7607 | LIC# 01264756

Lee & Associates Oakland Commercial Real Estate | 555 12th Street, Suite 1725, Oakland, CA 94607 | www.lee-associates.com

All information furnished regarding property for sale, rental or financing is from sources deemed reliable, but no warranty or representation is made to the accuracy thereof and same is submitted to errors, omissions, change of price, rental or other conditions prior to sale, lease or financing or withdrawal without notice. No liability of any kind is to be imposed on the broker herein.