

**SITE KEYPLAN**

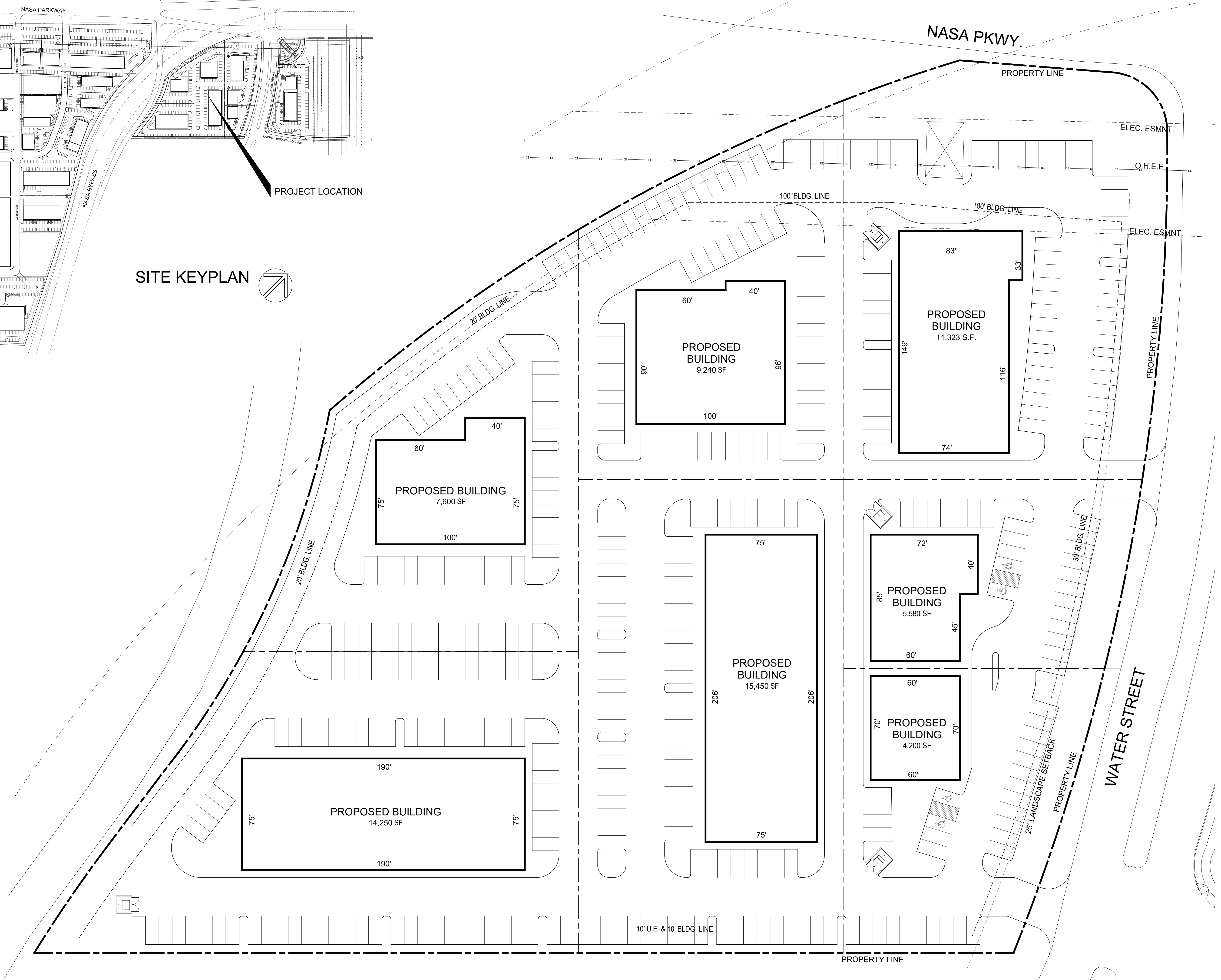

**01 SITE PLAN**  
 SCALE 1"=30'-0"

**MASTER DEVELOPMENT SITE PLAN**  
 RESERVE "A" 7.041 ACRES (306,700 S.F.)  
 NASA BYPASS BUSINESS PARK  
 WATER STREET (RESERVE A), WEBSTER TX



Written dimensions on these drawings shall have precedence over scale dimensions. Sub-Contractors shall verify and be responsible for all dimensions and conditions on the job and this office must be notified of any variation from the dimensions and conditions shown on these drawings.  
 Copyright © 2024 Wycoff Development and Construction, LLC. Drawings & Specifications as instruments of service are and shall remain the property of Wycoff Development and Construction, LLC. They are not to be used on other projects or extensions of this project except by agreement in writing and with appropriate compensation.

REVISIONS:

DATE: \_\_\_\_\_

SHEET TITLE:  
 SCHEMATIC DESIGN  
 SITE PLAN

SHEET NO:  
**V2**