

RAVALLI COUNTY ENVIRONMENTAL HEALTH
 MULTI-PURPOSE FORM: Site Evaluation/Septic Permit/Well Permit

15.26

Name: Johnny Vines Phone: (936) 875-5510 (w)
 Address: _____ Mail: PO Box 151507 Dallas, TX 75915
 Tax ID # 1103800 Geocode # 1176-11-2-03-660-0000
 General Area: Dist. 93-N of Dallas - East side of Hwy across from Sunbelt and Sp.
 Section 11 T 3 N/S R 21 W COS/AP# 294 Parcel/Lot: 8 C
 Subdivision Name: _____
 SITE EVALUATION # 9410 Date: Oct 16 2003 Sanitarian: Daniel G. Heaton R.S. File #: 4487
 Slope: 1-2% Depth to Groundwater: >105" Depth to Bedrock or Other Impermeables: 7105"
 Perc. Test: Y N Replacement Y N Nitrates: 0.59 mg/L NSA: _____ mg/L PBT: _____ years
 Soils Data: SITE: OPEN FIELD INTERSPERSED W/ PINE TREES

Site # 2 of 2
 SP#2

0-5" LOAMY SAND, LT. BROWN color, Fines to med. Roots to 10", FINE ROOTS THROUGHOUT Note,
 STRONG, FINE, GRANULAR STRUCTURE, GRAVELS to 1 1/2" dia = 7-5%, ABRUPT TRANSITION.
 5-105" SAND-COARSE (0.5 to 1.0mm) GRAY color, GRAVELS to 3" dia. >20%, COBBLES to 8" dia. = 3-5%
 PRESSURE Dosed SYSTEM AND SAND LINING REQ'D. OR PERCOLATION TEST > 3 MINUTES/IN.

PERMIT(S)

If a new well and septic system will be utilized, both permits are required at time of application. The new well should be installed prior to the septic system receiving final inspection.

SEPTIC PERMIT # 12521-EV WELL PERMIT # _____
 Permit issued by: Septic: Daniel G. Heaton R.S. Well: _____
 Date: NOV 21, 2003 Date: _____
 Expires: NOV 21, 2004 Expires: _____

Number and type of structure(s) served — Residential/Manufactured or Factory Built Home/Commercial
 Type: COMMERCIAL 1. a) State approved: Place well & septic system as shown on reverse.
 Number: 1 b) Locally approved: Place system over profile hole as shown on reverse.
 Number of Bedrooms: N/A 2. Set aside the required septic replacement area.
 Basement: Y 3. Comply with all required setbacks.

of septic tanks: _____ Size of septic tanks: 1500 pump chamber gallons Total lineal feet: As per plans and specifications
 System type (drainfield/bed/other) _____

* PRESSURIZED SAND LINED DRAINFIELD TRENCHES - DESIGNED AS PER PLANS & SPECIFICATIONS
 FROM LANDWORKS CONSULTING - NATHAN LUCKE, E.I. "AS BUILT" REQUIRED UPON COMPLETION

PLACE TANK WITHIN 50' OF STRUCTURE. IF BEDROCK, HIGH GROUNDWATER, INADEQUATE SETBACK FROM WELLS OR SURFACE WATER, OR OTHER PROBLEMS WITH REGULATION COMPLIANCE BECOME EVIDENT DURING INSTALLATION, STOP IMMEDIATELY AND CALL ENVIRONMENTAL HEALTH (375-6268).

- I will hire a Ravalli County certified septic system contractor to install the system. All pump-dosed systems must be installed by a Ravalli County certified septic system contractor.
- I have received the Regulations and Requirements for Onsite Wastewater Treatment Systems in Ravalli County and will install the system in compliance with the requirements therein.

RADON: Cancer-causing radon gas is found throughout Ravalli County. Over half of the tests in Ravalli County are elevated. Radon-resistant homes typically cost less to build than the cost of one new window. Radon Materials Received MDJ

APPLICANT'S WARRANTY: I will comply with the terms and conditions of this permit and certify that the use of this property for which this permit is issued does not violate any terms or conditions of any zoning, floodplain or restrictive covenant. I further understand that an effluent filter will be installed for which regular maintenance is required.

Applicant's signature: William S. Jackson DATE: 11/21/03

FINAL INSPECTION: For: Daniel G. Heaton R.S. DATE: 10/14/04

As Built Received 10/14/04

NOT TO SCALE



Barnhouse Rd

Hwy 93

APAC
2 STORY
Building

Slope 21-32

TEST HOLE
SP#2

2120'

IRRIGATION DITCH

Slope 20-22%

2210'

TEST HOLE
SP#2

PINE TREES

230'

DARBY CEMETARY

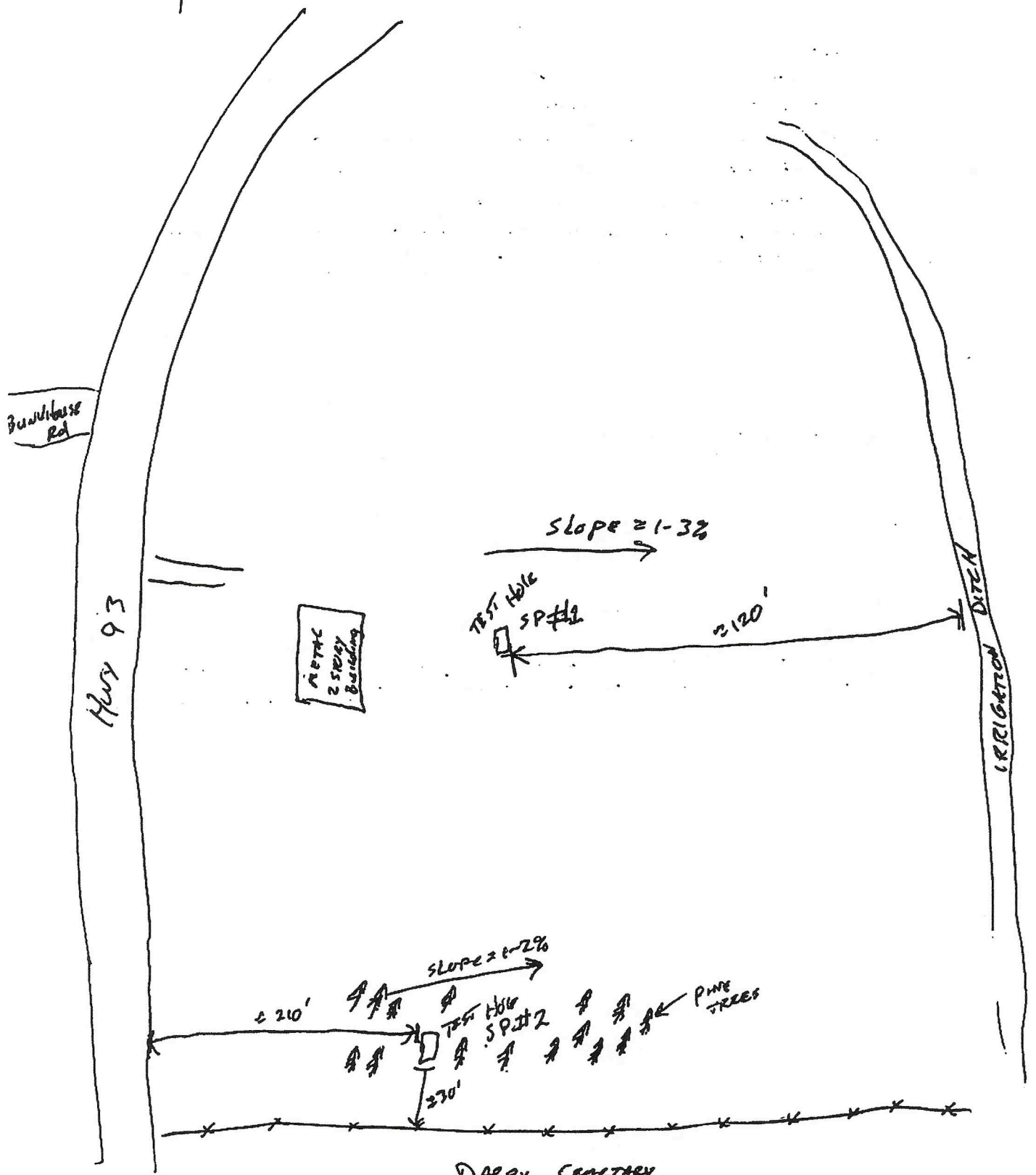

INSPECTION CHECKLIST FOR RAVALLI COUNTY SEPTIC SYSTEMS



Read your permit thoroughly. Make sure the system is in the correct location as shown on the back of the permit. Place system exactly where shown. A 100% replacement area must exist. If a slope problem or other obstacle causes you not to be able to comply with the approved site plan, you must call the Sanitarian prior to system construction. If any problems arise during construction including high groundwater, bedrock, or inadequate separation from required setbacks, stop construction immediately and phone Environmental Health at 375-6268. **THE ENVIRONMENTAL HEALTH OFFICE DOES NOT WARRANTY ANY GRADE OR SLOPE MEASUREMENTS.**

WHEN CALLING FOR A FINAL INSPECTION:

1. All lines must be 4-inch pipe and the correct ASTM. Schedule 40 is required from the house to the distribution box. ASTM 3034 (SDR 35) pipes or heavier class must be used throughout the rest of the septic system. All joints in solid lines must be glued.
2. The following lines must be uncovered: tank to foundation (10' minimum/50' maximum with an above-grade cleanout required at 25'), tank to distribution box (10' minimum), distribution box outlet lines and at least one absorption trench.
3. If used, an equal number of absorption lines are required on each side of the inlet tee on a header line. The header line must be uncovered and you must prove that your header line is level. Absorption lines must be "looped" (connected to each other) at the far ends of drainfields utilizing header lines.
4. Concrete septic tank and distribution box must be uncovered.
5. Sealed entry and exit pipes from tank and distribution box are required.
6. Approved effluent filters with a handle extending to 2" of the surface are required on all systems. Filter type: ORENCO. Alarms are required on pump systems.
7. Sanitary tee's (inlet side 12", outlet is 18" minimum or as fabricated according to the effluent filter manufacturer) must be installed in septic tanks.
8. All septic tanks must have a concrete cylindrical riser (or approved equivalent) at least 2' in diameter extending to the finished grade of the site with a tight fitting lid for tank pumping and filter maintenance. **LEAVE LIDS OFF TANK FOR INSPECTION OF SANITARY TEES AND EFFLUENT FILTER.**
9. Distribution box outlet lines must be solid for at least 5' to avoid seepage around the distribution box.
10. Distribution boxes have an inlet that is higher than the outlets; install correctly. Distribution boxes must be bedded & must be elevationally higher than the pipes exiting the distribution box. Water poured into the distribution box must flow equally down each exit pipe and **not back flush.**
11. Standard trench depth is 24" to the trench bottom. Maximum depth is 36". Check your permit.
12. Trenches must be separated by a minimum of 5' undisturbed earth: 2' trench ~ 7' on centers, 3' trench ~ 8' on centers.
13. While all trenches are not required to be at the same elevation, individual trenches must be level.
14. Absorption lines must be of equal length. (A 10-foot total variance is allowed in difficult situations.) No absorption line may exceed 100 feet in length.
15. At least two absorption trenches are required in all installations.
16. A minimum of 6" of washed rock beneath and 2" of rock over absorption lines is required. Your permit may require additional rock.
17. Approved filter fabric or 2 layers (minimum) of untreated building paper must be placed over the rock on top of the pipes. (Paper must not tear when walked on.)
18. Holes in absorption lines must be aligned at the 5 and 7 o'clock position on a clock face.
19. The ends of each absorption trench must be uncovered to check for caps.

Permit #: 12521-E Owner: Daimy Vines

Contractor/Installer: _____

I have inspected this system and found it compliant with Ravalli Co. Sewage Disposal Regulations.

Signature: [Signature]

Date Inspected: 9-24-04

REV: 6/03

SITE EVALUATION # 9410

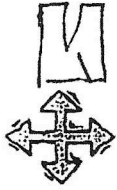

- witnessed squirt height at 72" \pm 10% variance.
- refer to engineers plans for details

HWY 93

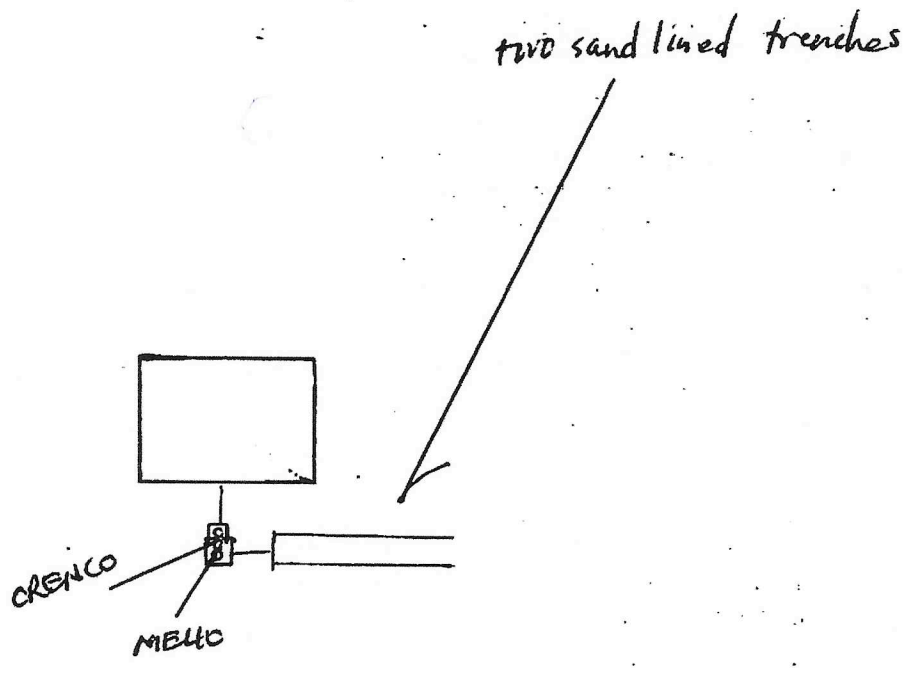

DARBY CEMETERY FENCE