

FUNERAL HOME PROPERTY // FOR SALE

PRIME OPPORTUNITY FOR COMMERCIAL OR COMMUNITY FACILITY

22401 GRAND RIVER AVE
DETROIT, MI 48219



- Funeral home with a large chapel
- Could be repurposed into a church, children/adult daycare, learning center, or business enterprise
- Multiple meeting and conference rooms
- Executive and private offices
- Upstairs living area with kitchen
- New roof and updated interior
- Spacious parking lot
- Zoned B4, allowing for a variety of potential uses



P.A. COMMERCIAL
Corporate & Investment Real Estate

26555 Evergreen Road, Suite 1500
Southfield, MI 48076
248.358.0100
pacommercial.com

We obtained the information above from sources we believe to be reliable. However, we have not verified its accuracy and make no guarantee, warranty or representation about it. It is submitted subject to the possibility of errors, omissions, change of price, rental or other conditions, prior sale, lease or financing, or withdrawal without notice. We include projections, opinions, assumptions or estimates for example only, and they may not represent current, past or future performance of the property. You and your tax and legal advisors should conduct your own investigation of the property and transaction.

EXECUTIVE SUMMARY

22401 GRAND RIVER AVE, DETROIT, MI 48219 // FOR SALE

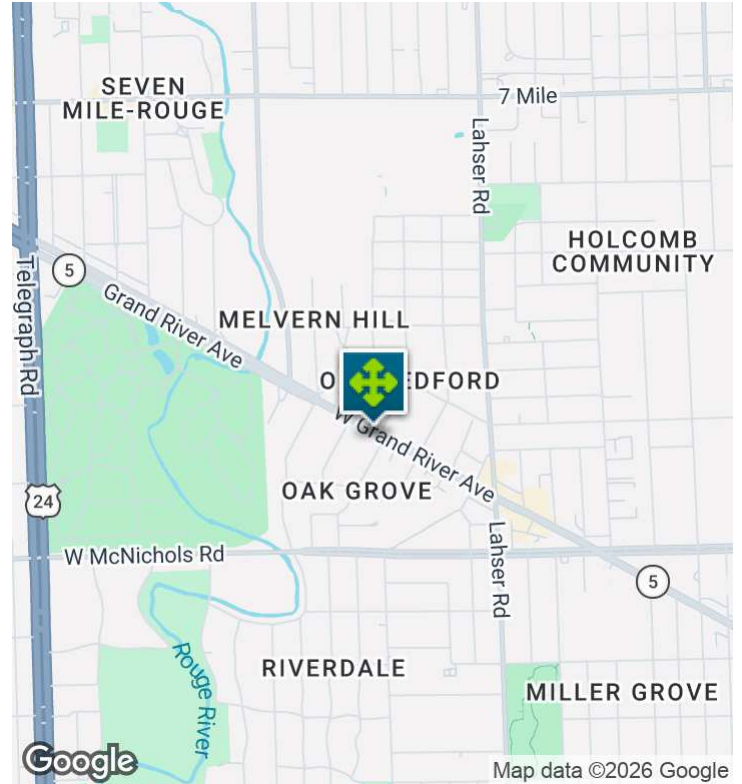

Sale Price	\$1,150,000
-------------------	--------------------

OFFERING SUMMARY

Building Size:	8,507 SF
Lot Size:	0.83 Acres
Number of Units:	1
Price / SF:	\$135.18
Cap Rate:	0.0%
NOI:	\$0
Year Built:	1941
Renovated:	2025
Zoning:	B4
Market:	Detroit
Submarket:	Detroit W of Woodward
Traffic Count:	17,952

PROPERTY OVERVIEW

This 8,507 SF property on Grand River Avenue encompasses a multi-purpose building suitable for a wide range of special purpose, educational, or business uses. The current layout features a large chapel, multiple meeting and conference rooms, private offices, a 1,200 SF basement, and an upstairs living area. There is also a spacious parking lot. Zoned B4 and boasting timeless architectural charm from its 1941 construction, this versatile property offers an ideal canvas for creating a unique and functional space tailored to specialized educational or institutional needs.

LOCATION OVERVIEW

This property is located between the Old Redford and Oak Grove neighborhoods in Detroit. Old Redford is a walkable, urban district of Detroit with tree-lined streets. It's also near a historic commercial strip with a few restaurants and a vintage movie house – the Redford Theatre, that shows Hollywood classics and independent films. Grand Lawn Cemetery, a sprawling burial ground with lush mature trees, occupies the western side of the district. It's also convenient to major highways, and there's a large strip center on Grand River Avenue.



DeVon Jackson SENIOR ASSOCIATE
D: 248.663.0508 | C: 248.568.1488
DeVon@pacommercial.com

Parker Jamieson ASSOCIATE
D: 248.847.2088 | C: 248.408.0072
parker@pacommercial.com

We obtained the information above from sources we believe to be reliable. However, we have not verified its accuracy and make no guarantee, warranty or representation about it. It is submitted subject to the possibility of errors, omissions, change of price, rental or other conditions, prior sale, lease or financing, or withdrawal without notice. We include projections, opinions, assumptions or estimates for example only, and they may not represent current, past or future performance of the property. You and your tax and legal advisors should conduct your own investigation of the property and transaction.

PROPERTY DETAILS

22401 GRAND RIVER AVE, DETROIT, MI 48219 // FOR SALE

Sale Price	\$1,150,000
------------	-------------

LOCATION INFORMATION

Building Name	Ellis Funeral Home
Street Address	22401 Grand River Ave
City, State, Zip	Detroit, MI 48219
County	Wayne
Market	Detroit
Sub-market	Detroit W of Woodward
Cross-Streets	Northrop Street
Side of the Street	South
Signal Intersection	Yes
Road Type	Paved
Market Type	Large
Nearest Highway	I-96 and Southfield Freeway
Nearest Airport	Detroit Metro Airport

BUILDING INFORMATION

Building Size	8,507 SF
NOI	\$0.00
Cap Rate	0.0
Occupancy %	100.0%
Tenancy	Single
Number of Floors	2
Average Floor Size	8,507 SF
Year Built	1941
Year Last Renovated	2025
Construction Status	Existing
Condition	Good
Number of Buildings	1

PROPERTY INFORMATION

Property Type	Funeral Home
Property Subtype	Other
Zoning	B4
Lot Size	0.83 Acres
APN #	22-0075001
Corner Property	Yes
Traffic Count	17952
Waterfront	No
Power	Yes

PARKING & TRANSPORTATION

Street Parking	Yes
Parking Type	Surface
Number of Parking Spaces	35

UTILITIES & AMENITIES

Security Guard	No
Handicap Access	Yes
Number of Elevators	1
Gas / Propane	Yes

ADDITIONAL PHOTOS

22401 GRAND RIVER AVE, DETROIT, MI 48219 // FOR SALE



P.A. COMMERCIAL
Corporate & Investment Real Estate

DeVon Jackson SENIOR ASSOCIATE
D: 248.663.0508 | C: 248.568.1488
DeVon@pacommercial.com

Parker Jamieson ASSOCIATE
D: 248.847.2088 | C: 248.408.0072
parker@pacommercial.com

We obtained the information above from sources we believe to be reliable. However, we have not verified its accuracy and make no guarantee, warranty or representation about it. It is submitted subject to the possibility of errors, omissions, change of price, rental or other conditions, prior sale, lease or financing, or withdrawal without notice. We include projections, opinions, assumptions or estimates for example only, and they may not represent current, past or future performance of the property. You and your tax and legal advisors should conduct your own investigation of the property and transaction.

ADDITIONAL PHOTOS

22401 GRAND RIVER AVE, DETROIT, MI 48219 // FOR SALE



FLOOR PLANS

22401 GRAND RIVER AVE, DETROIT, MI 48219 // FOR SALE

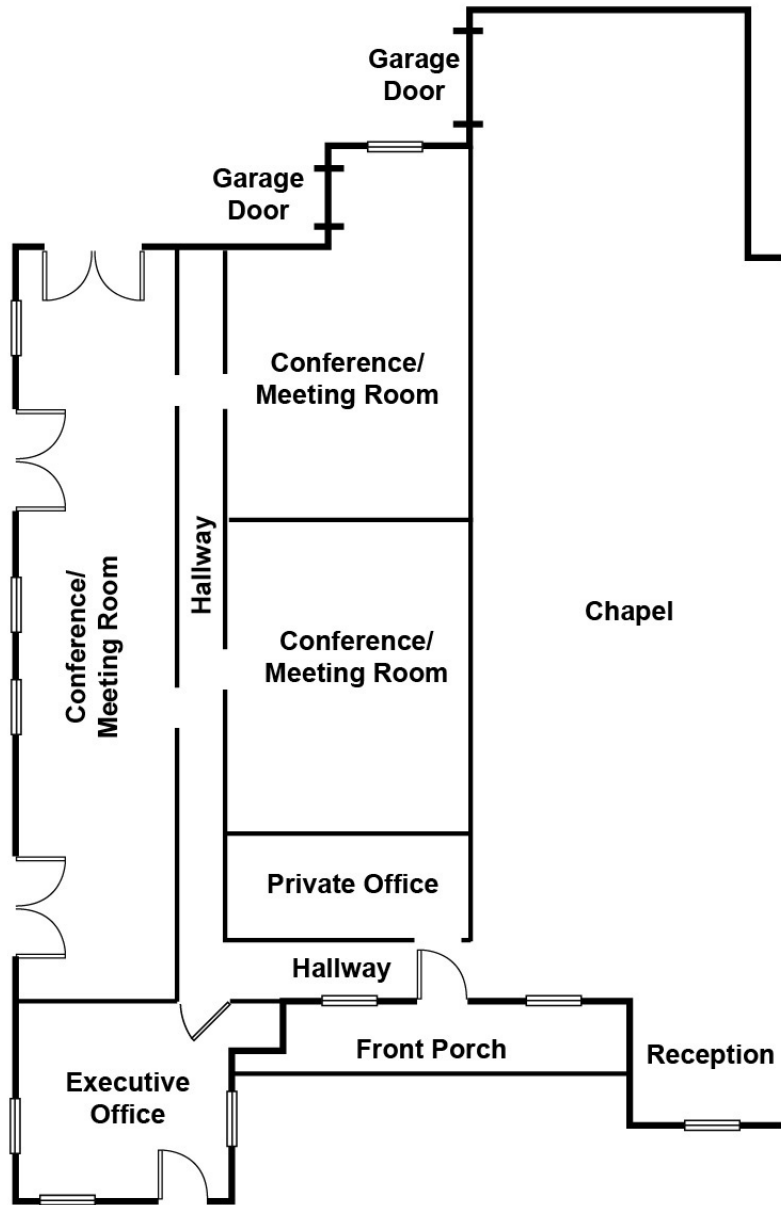

AERIAL MAP

22401 GRAND RIVER AVE, DETROIT, MI 48219 // FOR SALE

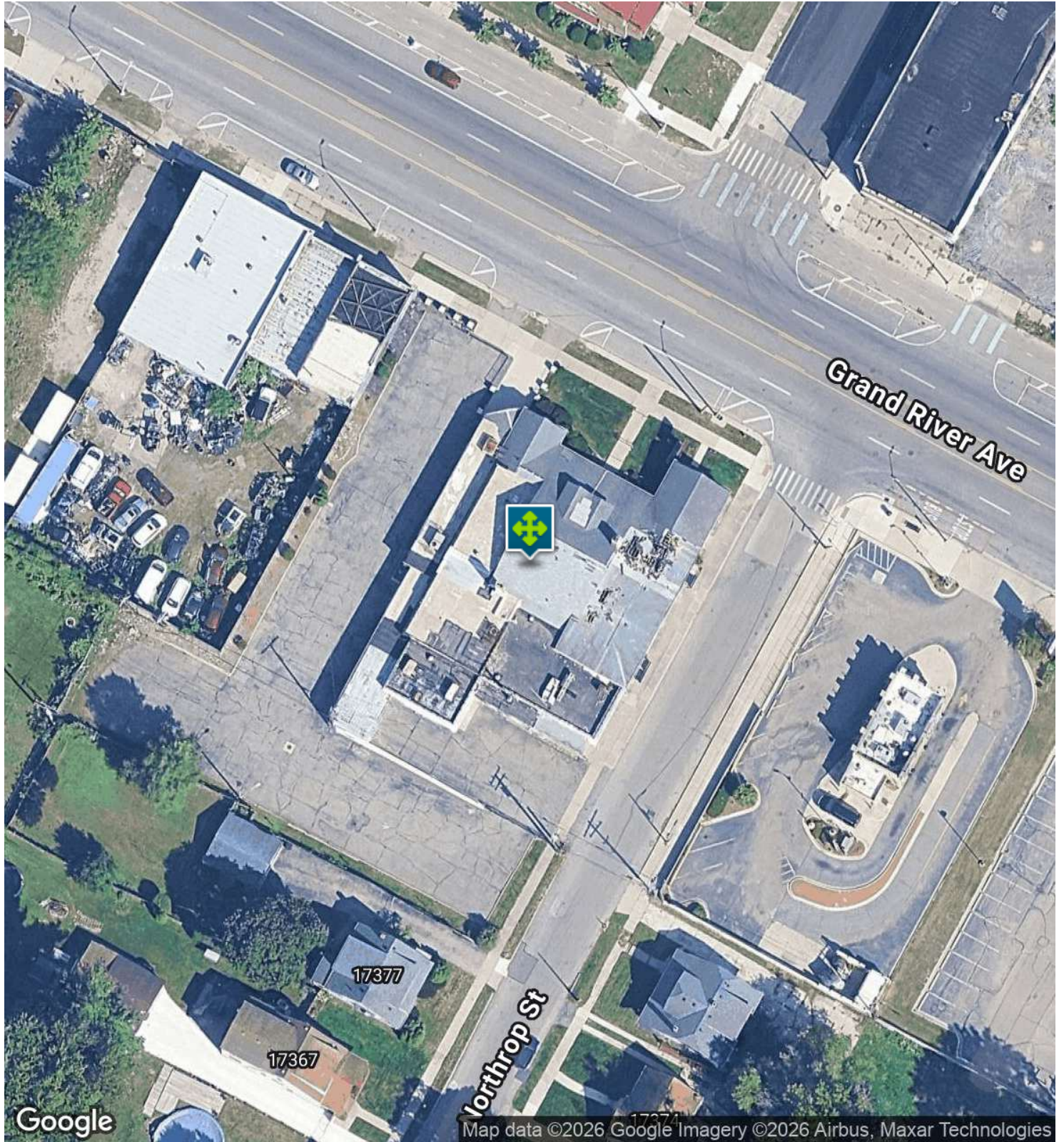

DeVon Jackson SENIOR ASSOCIATE
D: 248.663.0508 | C: 248.568.1488
DeVon@pacommercial.com

Parker Jamieson ASSOCIATE
D: 248.847.2088 | C: 248.408.0072
parker@pacommercial.com

We obtained the information above from sources we believe to be reliable. However, we have not verified its accuracy and make no guarantee, warranty or representation about it. It is submitted subject to the possibility of errors, omissions, change of price, rental or other conditions, prior sale, lease or financing, or withdrawal without notice. We include projections, opinions, assumptions or estimates for example only, and they may not represent current, past or future performance of the property. You and your tax and legal advisors should conduct your own investigation of the property and transaction.

LOCATION MAP

22401 GRAND RIVER AVE, DETROIT, MI 48219 // FOR SALE

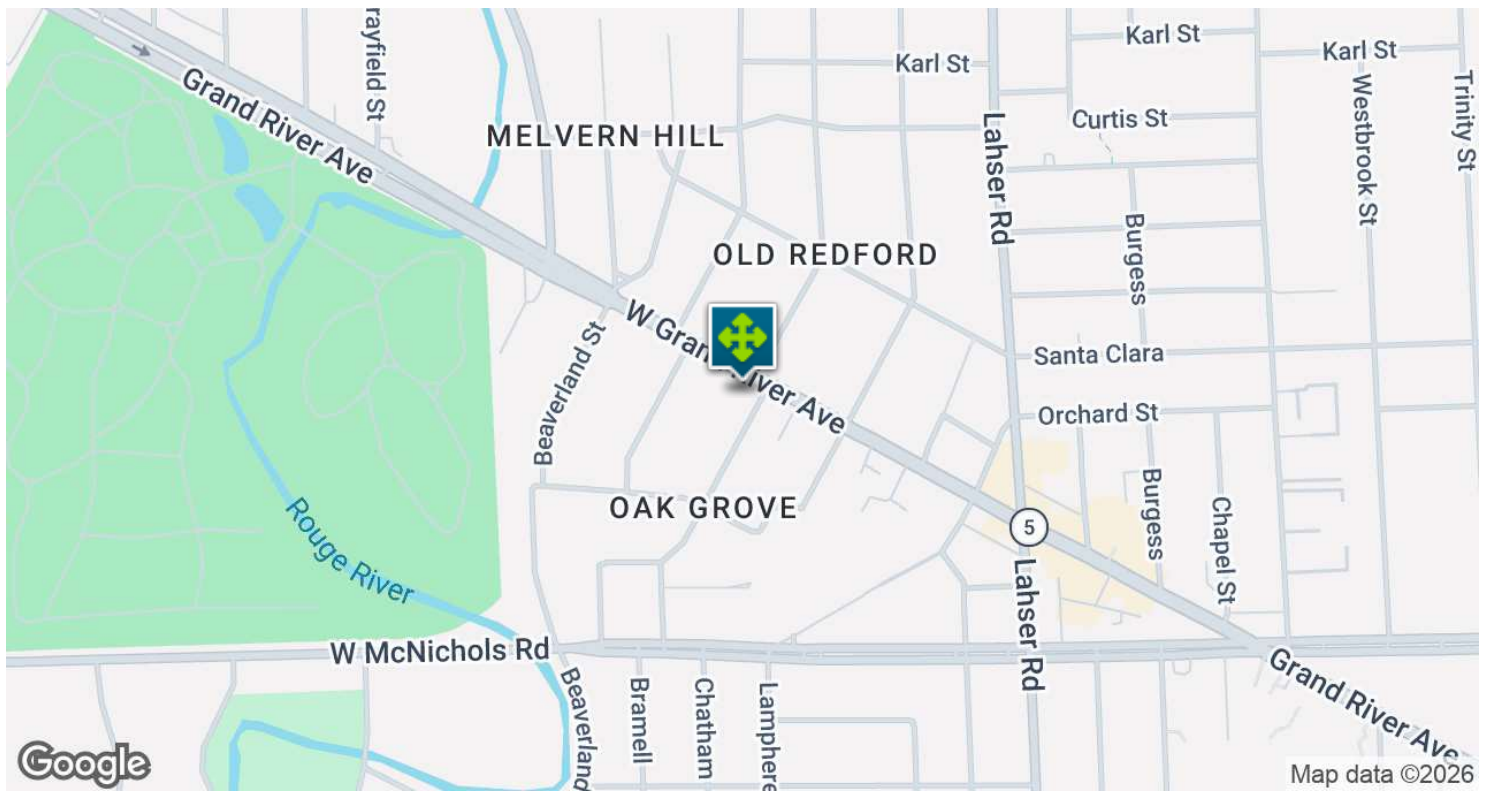
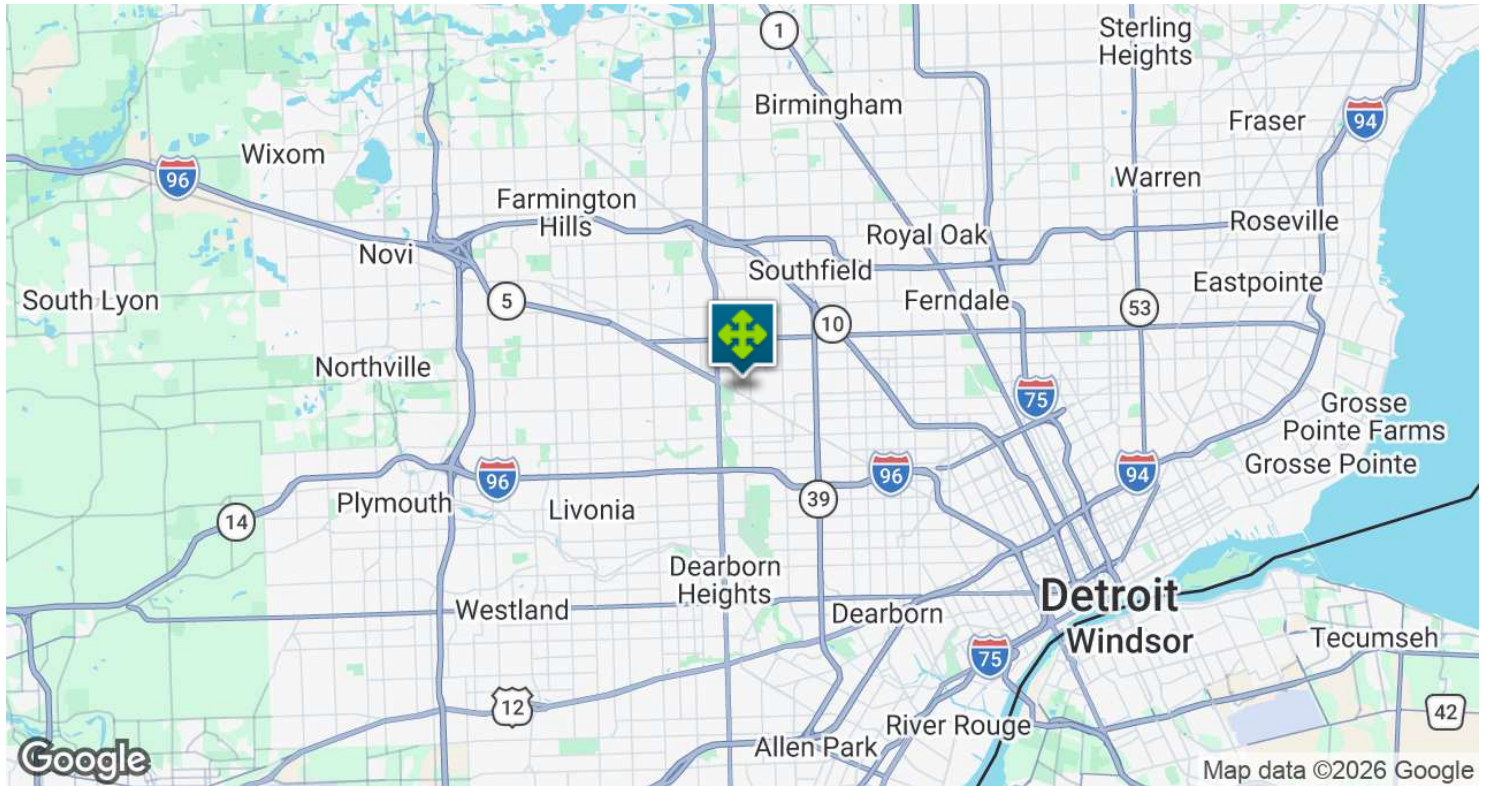

DeVon Jackson SENIOR ASSOCIATE
D: 248.663.0508 | C: 248.568.1488
Devon@pacommercial.com

Parker Jamieson ASSOCIATE
D: 248.847.2088 | C: 248.408.0072
parker@pacommercial.com

We obtained the information above from sources we believe to be reliable. However, we have not verified its accuracy and make no guarantee, warranty or representation about it. It is submitted subject to the possibility of errors, omissions, change of price, rental or other conditions, prior sale, lease or financing, or withdrawal without notice. We include projections, opinions, assumptions or estimates for example only, and they may not represent current, past or future performance of the property. You and your tax and legal advisors should conduct your own investigation of the property and transaction.

DEMOGRAPHICS MAP & REPORT

22401 GRAND RIVER AVE, DETROIT, MI 48219 // FOR SALE

POPULATION	1 MILE	3 MILES	5 MILES
Total Population	12,329	122,199	297,499
Average Age	38	40	40
Average Age (Male)	37	38	39
Average Age (Female)	39	41	42

HOUSEHOLDS & INCOME	1 MILE	3 MILES	5 MILES
Total Households	5,223	49,949	121,042
# of Persons per HH	2.4	2.4	2.5
Average HH Income	\$48,704	\$63,017	\$68,587
Average House Value	\$92,313	\$123,519	\$145,089

2020 American Community Survey (ACS)

CONTACT US

22401 GRAND RIVER AVE, DETROIT, MI 48219 // FOR SALE



FOR MORE INFORMATION, PLEASE CONTACT:



DeVon Jackson
SENIOR ASSOCIATE

D: 248.663.0508

C: 248.568.1488

DeVon@pacommercial.com



Parker Jamieson
ASSOCIATE

D: 248.847.2088

C: 248.408.0072

parker@pacommercial.com

P.A. Commercial

26555 Evergreen Road, Suite 1500
Southfield, MI 48076

P: 248.358.0100

F: 248.358.5300

pacommercial.com

Follow Us!

