

1,400 Square Foot

INDUSTRIAL UNIT

FOR LEASE

921 Calle Amanecer, Unit M
San Clemente, CA

**Small
Industrial Unit!**



JOHNSTON PACIFIC
COMMERCIAL REAL ESTATE, INC.



WWW.JOHNSTON-PACIFIC.COM
949-366-2020

- 1,400 sf. Small Industrial Unit
- Reception Area, Restroom and Warehouse
- 1 Ground Level Loading Door
- 100 Amps of Power (Verify)
- 13' Warehouse Clearance
- Part of a professionally managed business park
- Minutes from I-5 Freeway
- Located in the RSC Business Park
- Close to numerous dining & shopping amenities
- Available in approx. 30-60 days

Rob Johnston

Rob@Johnston-Pacific.com
License# 01121630

Louis Johnston

Louis@johnston-pacific.com
License# 02054162



The information obtained above has been obtained from sources believed to be reliable. While we do not doubt its accuracy, we have not verified it, make no guarantee, warranty or representation about it. It is your responsibility to independently confirm its accuracy and completeness. All information is subject to change without notice.

**1,400
Square Foot**

INDUSTRIAL UNIT

FOR LEASE

921 Calle Amanecer, Unit M
San Clemente, CA

APPROXIMATE FLOOR PLAN

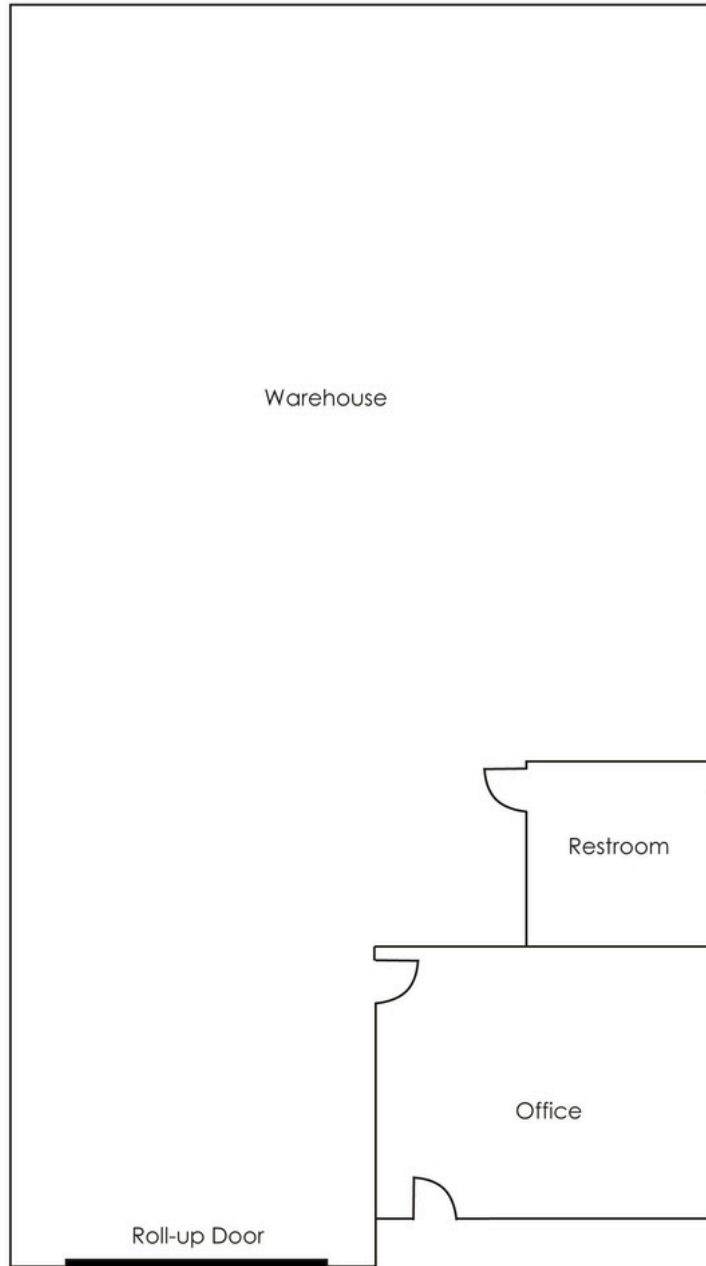

JOHNSTON PACIFIC

COMMERCIAL REAL ESTATE, INC.

Rob Johnston
Rob@Johnston-Pacific.com
License# 01121630

Louis Johnston
Louis@johnston-pacific.com
License# 02054162

949-366-2020

1305 Calle Avanzado, San Clemente, CA 92673
26240 Enterprise Court, Lake Forest, CA 92630
www.Johnston-Pacific.com

