

# 27,200 SF

Industrial Space For Lease



## Prologis Central Green 2



1606 Greens Road, Suites 100  
Houston, TX 77032 USA

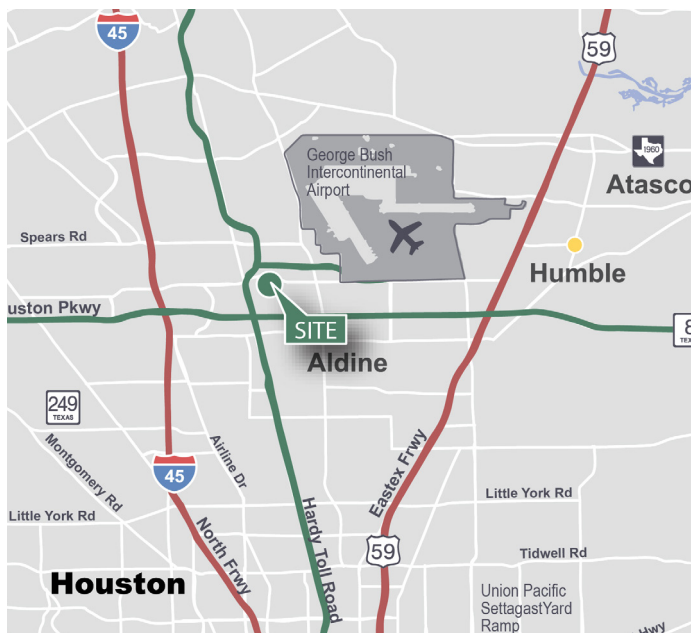

### LOCATION

- Minutes to Bush IAH via Airport Connector
- Located immediately off of Hardy Toll Rd. with easy access to Beltway 8 and I-45
- Convenient to Hwy 59 and FM 1960
- Unincorporated Harris County
- FTZ and Freeport Tax Exemption for qualified user

### FACILITY

- 27,200 SF available
- Can be combined with Suite 190 for a total of 59,200 SF
- 2,753 SF of total office
- 24' clear height
- 6 dock-high doors / 1 drive-in ramp / 1 ground-level door
- 40' x 40' column spacing

### ADVANTAGES AND AMENITIES

- Front-load space configuration
- ESFR sprinklers
- LED lighting
- 1 pit leveler
- 188' shared truck court

**Prologis Essentials: your single-source service for efficient move-in and operations at [prologisessentials.com](https://www.prologisessentials.com)**

# 27,200 SF

Industrial Space For Lease



## Prologis Central Green 2

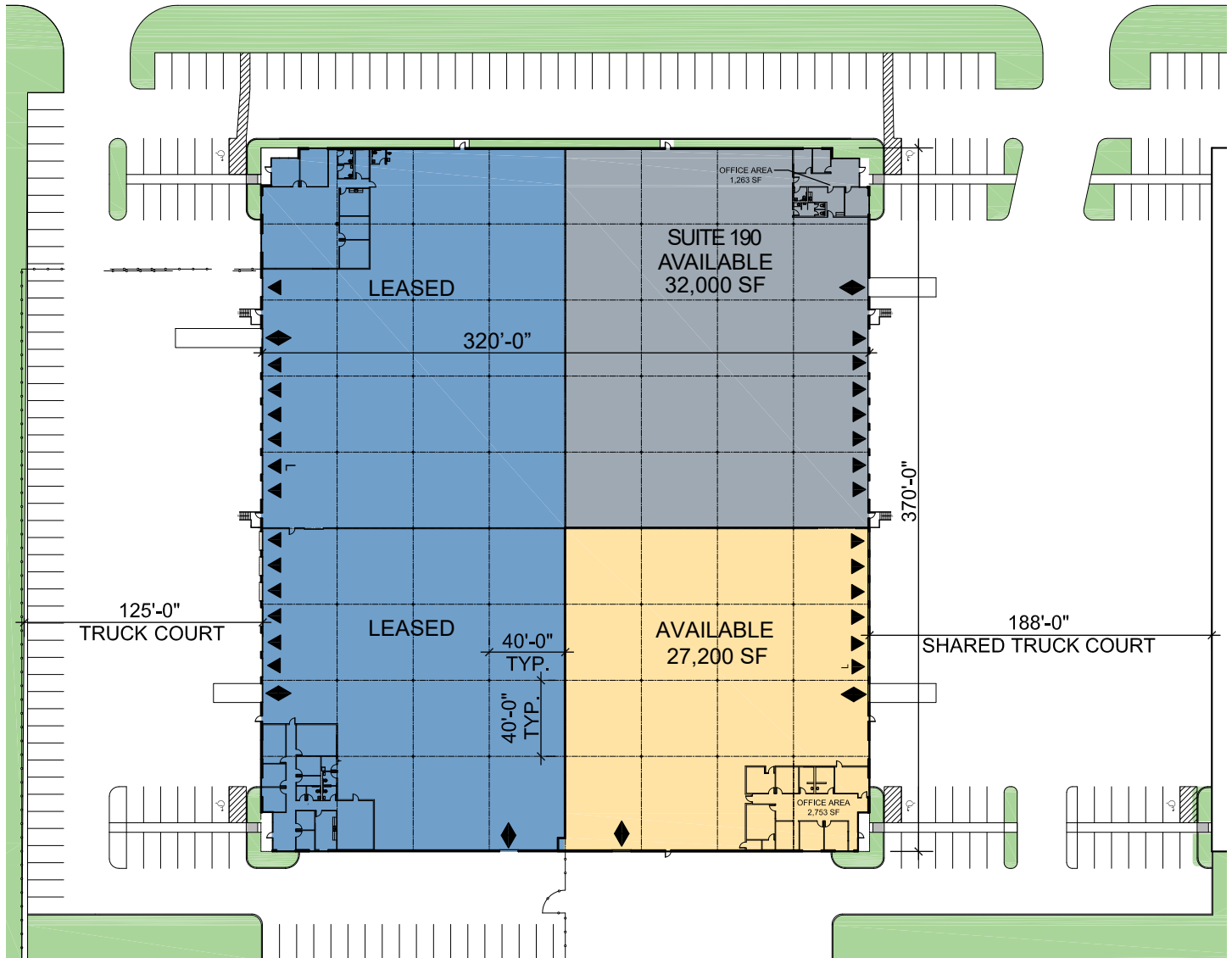

**JLL**  
Richard Quarles  
richard.quarles@am.jll.com  
ph +1 713 888 4019  
4200 Westheimer Rd, Ste. 1400  
Houston, TX 77027 USA

**JLL**  
Joe Berwick  
joseph.berwick@am.jll.com  
ph +1 713 425 5842  
4200 Westheimer Rd, Ste. 1400  
Houston, TX 77027 USA

**JLL**  
David Holland  
david.holland@am.jll.com  
ph +1 713 888 4095  
4200 Westheimer Rd, Ste. 1400  
Houston, TX 77027 USA

**Prologis**  
Ryan Patronella  
rpatronella@prologis.com  
ph +1 713 613 6966  
cell +1 832 671 1550  
9655 Katy Freeway, Suite 400  
Houston, TX 77024 USA

**Prologis Essentials: your single-source service for efficient move-in and operations at [prologisessentials.com](http://prologisessentials.com)**

No warranty or representation, expressed or implied, is made as to the accuracy of the information contained herein, and same is submitted subject to error and omissions.