



3433-3435 STEVENS CREEK BLVD SANTA CLARA, CALIFORNIA

Serena Fuchs

Associate Director of Commercial Real estate
Intero Commercial

408.416.6469

sfuchs@intero-commercial.com

DRE# 01995043

Scott Bishop

Director of Commercial Real Estate
Intero Commercial

408-206-8877

sbishop@intero-commercial.com

DRE# 01251839

INTERO

COMMERCIAL REAL ESTATE



PROPERTY OVERVIEW

3433-3435 STEVENS CREEK BLVD, SANTA CLARA, CA

INTERO

COMMERCIAL REAL ESTATE

3435 STEVENS CREEK BLVD

LAND	2,614 SF
ZONING	CR
CLASSIFICATION	H-1 & H-3
PARKING	4 Parking Spaces
FIRE PROTECTION	Sprinklers in H-2 Room
FLOORING	Epoxy Coated Floors
CEILING HEIGHT	11'4" Ceiling Height
ELECTRICAL	200 Amps
APN	303-20-070

3433 STEVENS CREEK BLVD

LAND	7,841
ZONING	CN
CLASSIFICATION	H-1
PARKING	3 Parking Spaces
FLOORING	Epoxy Coated Floors
CEILING HEIGHT	10'4" Ceiling Height
ELECTRICAL	200 Amps
APN	303-20-069

ASKING PRICE BOTH PARCELS **\$1,750,000**



Serena Fuchs

Associate Director of Commercial Real estate
Intero Commercial

408.416.6469
sfuchs@intero-commercial.com
DRE# 01995043

Scott Bishop

Director of Commercial Real Estate
Intero Commercial

408-206-8877
sbishop@intero-commercial.com
DRE# 01251839

FLOOR PLAN

3433-3435 STEVENS CREEK BLVD, SANTA CLARA, CA

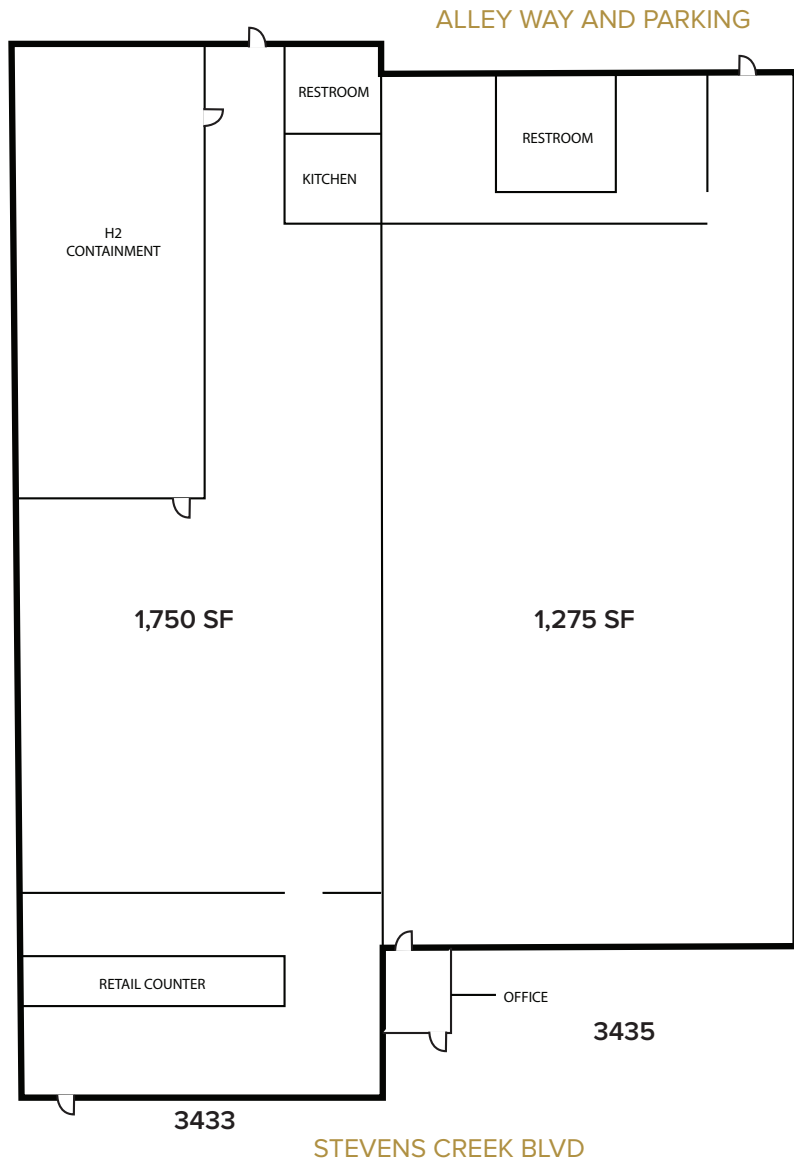

SPACE BREAKDOWN

3435 Stevens Creek H-2 Classified	1,275 SF
H2 Containment Room Sprinklered	Included
Retail Counter Street-facing	Included
3433 Stevens Creek H-1 Classified	~900 SF
Office Rear suite	Included
Restrooms 2 total	Both units
Kitchen Shared	Included

Serena Fuchs

Associate Director of Commercial Real estate
Intero Commercial

408.416.6469
sfuchs@intero-commercial.com
DRE# 01995043

Scott Bishop

Director of Commercial Real Estate
Intero Commercial

408-206-8877
sbishop@intero-commercial.com
DRE# 01251839

LOCATION PIN

3433-3435 STEVENS CREEK BLVD, SANTA CLARA, CA

INTERO
COMMERCIAL REAL ESTATE



VALLEY FAIR MALL

SANTANA ROW

3433-3435
STEVENS CREEK BLVD.

TRAFFIC COUNT STEVENS CREEK BLVD 31,268

Serena Fuchs

Associate Director of Commercial Real estate
Intero Commercial

408.416.6469

sfuchs@intero-commercial.com
DRE# 01995043

Scott Bishop

Director of Commercial Real Estate
Intero Commercial

408-206-8877

sbishop@intero-commercial.com
DRE# 01251839

PROPERTY PHOTOS

3433-3435 STEVENS CREEK BLVD, SANTA CLARA, CA

INTERO
COMMERCIAL REAL ESTATE



Serena Fuchs

Associate Director of Commercial Real estate
Intero Commercial

408.416.6469

sfuchs@intero-commercial.com
DRE# 01995043

Scott Bishop

Director of Commercial Real Estate
Intero Commercial

408-206-8877

sbishop@intero-commercial.com
DRE# 01251839

AERIAL MAP

3433-3435 STEVENS CREEK BLVD, SANTA CLARA, CA

INTERO
COMMERCIAL REAL ESTATE



**Subject
Property**

Serena Fuchs

Associate Director of Commercial Real estate
Intero Commercial

408.416.6469

sfuchs@intero-commercial.com

DRE# 01995043

Scott Bishop

Director of Commercial Real Estate
Intero Commercial

408-206-8877

sbishop@intero-commercial.com

DRE# 01251839