

FOR SUBLEASE

±14,400 - ±36,000 SF
MULTIPLE OPTIONS - WAREHOUSE,
OFFICE, LAB, SPACE, FREEZER/COOLER

7272 CHAPMAN AVE | GARDEN GROVE, CA



PROPERTY FEATURES

- Sublease Until May 31, 2030
- Part of a Larger 70,000 SF Building
- Numerous and Flexible Floorplans:
 - ±14,400 SF Warehouse
 - ±15,000 SF Lab Space/Office
 - ±1,500 SF Office
- 50 Parking Spaces
- Heavy Power
- Excellent Access to 22 and 405 Freeway

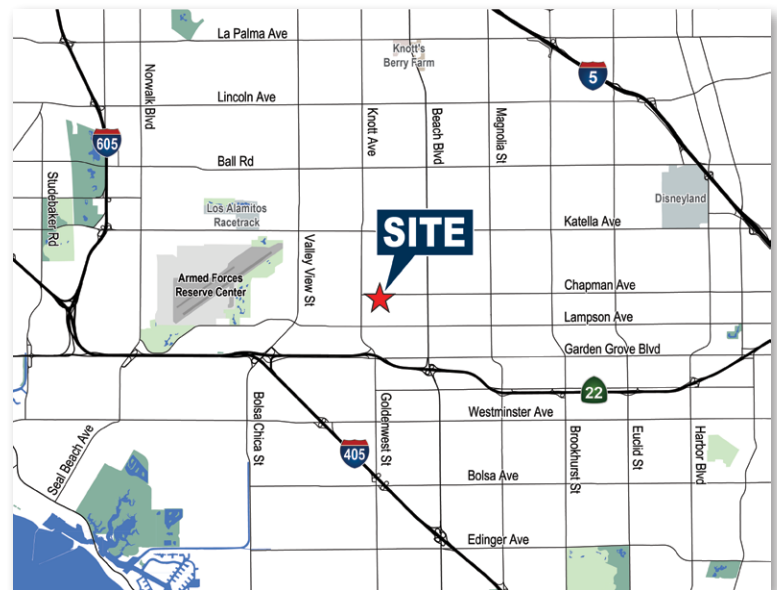

ERIC SMITH, SIOR
Senior Vice President | Partner
License #01940591
(714) 935-2310
Esmith@voitco.com



ERIK SIKES
Senior Associate
License #02103320
(949) 309-6410
Esikes@voitco.com

Voit

REAL ESTATE SERVICES

2020 Main Street, Suite 100 | Irvine, CA 92614 | www.voitco.com



SITE PLAN

MONARCH ST

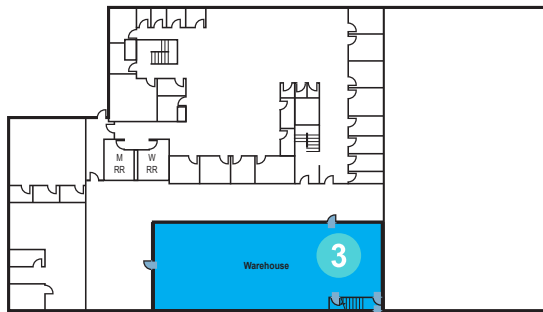
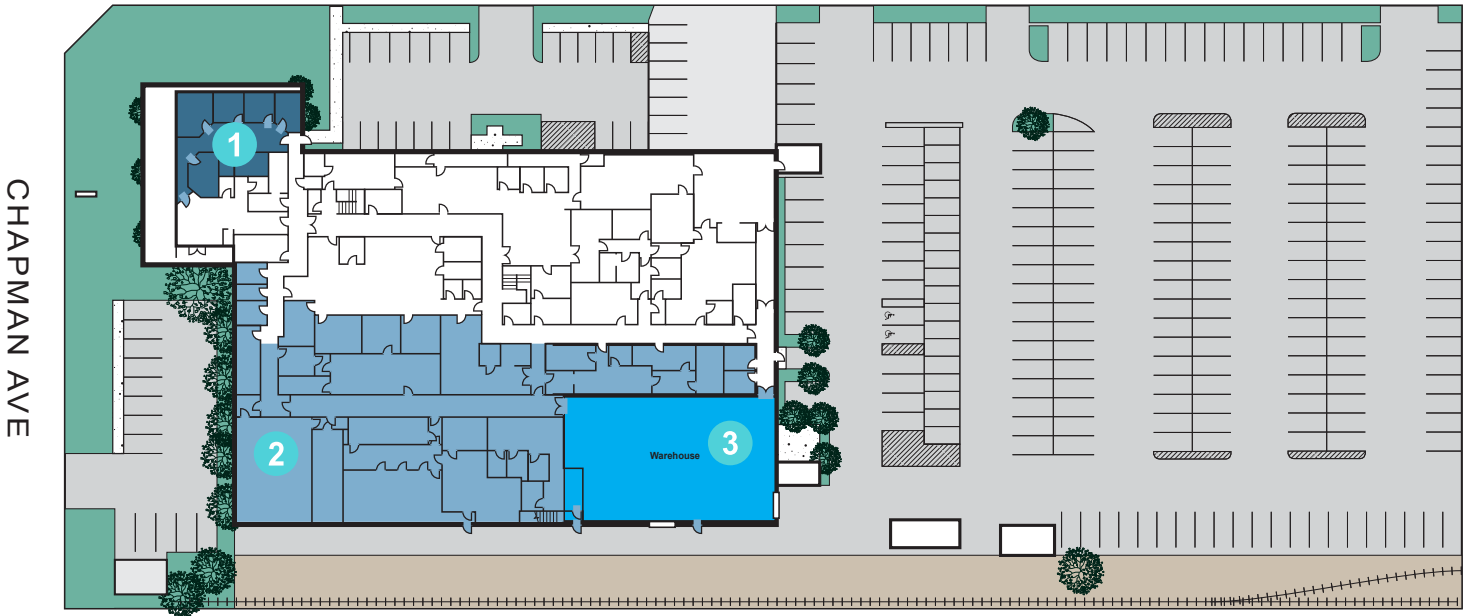

Second Floor

■ *Subleasing the portion highlighted in blue(s) only.*

1) $\pm 1,500$ SF Office Component

2) $\pm 15,000$ SF Lab/Office Space

3) $\pm 5,160$ SF Warehouse with One GL Door

* $\pm 9,240$ SF permitted second-floor warehouse space served by a freight elevator

**Site Plan Not to Scale*



ERIC SMITH, SIOR

Senior Vice President | Partner
License #01940591
(714) 935-2310
Esmith@voitco.com



ERIK SIKES

Senior Associate
License #02103320
(949) 309-6410
Esikes@voitco.com

Voit

REAL ESTATE SERVICES

2020 Main Street, Suite 100 | Irvine, CA 92614 | www.voitco.com

