



1900 5th Ave River Grove, IL

- Available Size: Up to 50,000 SF (divisible)
- Building Size: 268,107 SF
- Ceiling Height: 18' clear
- Loading: 4 interior docks, 1 drive-in door
- Sprinklers: Wet
- Overflow slow moving storage
- Zoning: Industrial
- Excellent proximity to O'Hare Airport, the city of Chicago and major expressways
- Lease Rate: \$6.95/SF Gross

FOR SUBLEASE

Up to 50,000 SF

Contact us:

Thomas Rodeno

Vice Chair
+1 847 698 8231
thomas.rodeno@colliers.com

Steve Ostrowski

Vice Chair
+1 847 444 5733
steve.ostrowski@colliers.com

Patrick Turner

Executive Vice President
+1 847 698 8277
patrick.turner@colliers.com

Colliers

6250 N. River Rd., Suite 11-100
Rosemont, IL 60018

Floor Plan

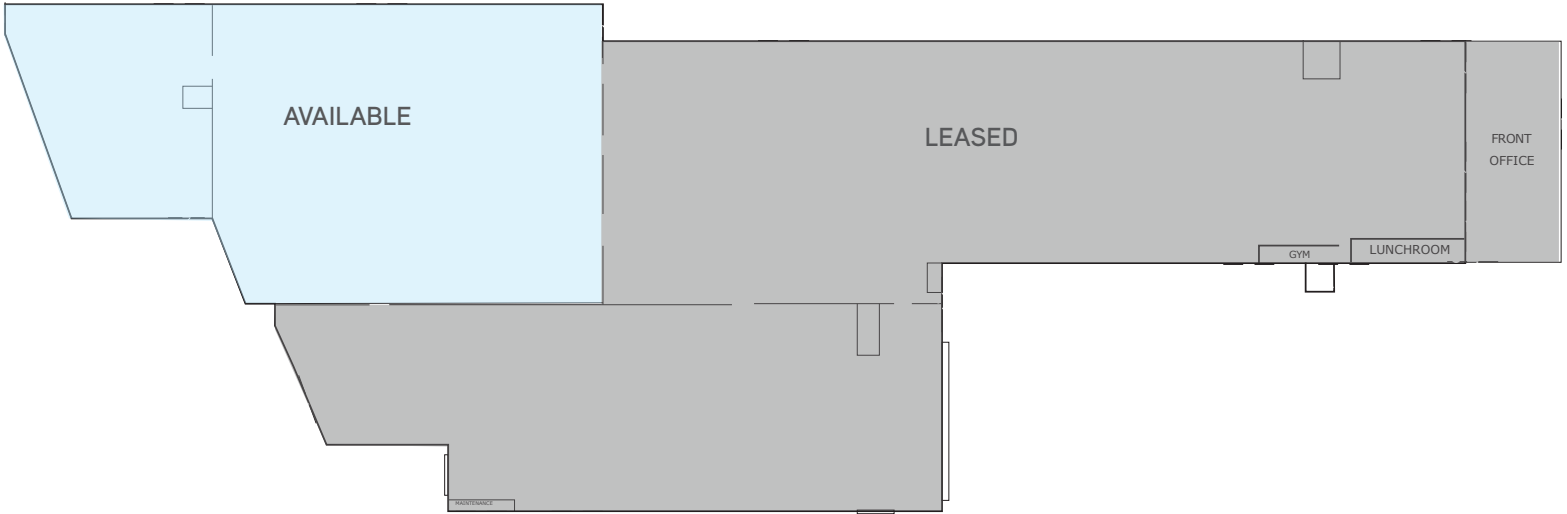

Thomas Rodeno
Vice Chair
+1 847 698 8231
thomas.rodno@colliers.com

Steve Ostrowski
Vice Chair
+1 847 444 5733
steve.ostrowski@colliers.com

Patrick Turner
Executive Vice President
+1 847 698 8277
patrick.turner@colliers.com



Location

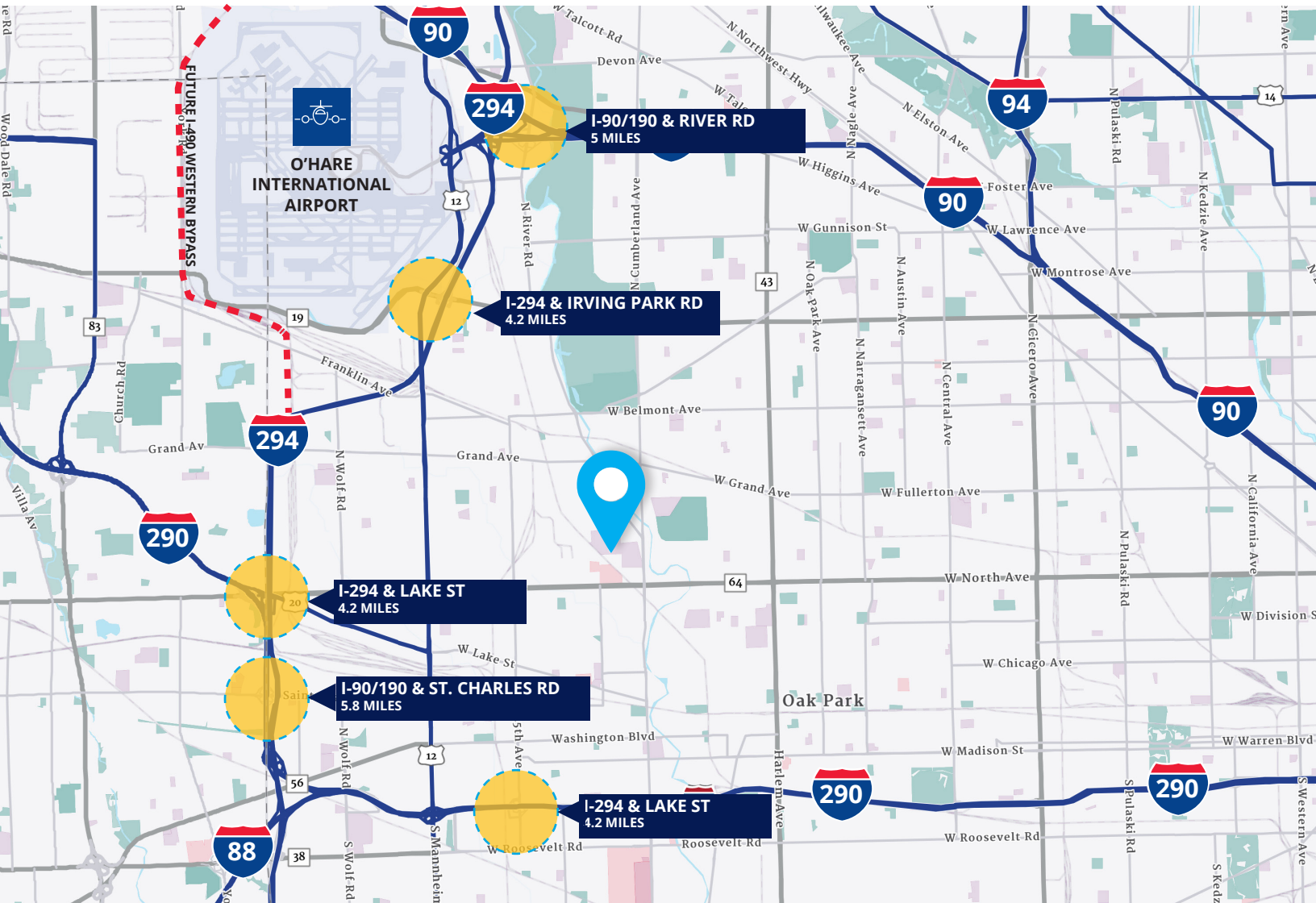

Thomas Rodeno
Vice Chair
+1 847 698 8231
thomas.rodno@colliers.com

Steve Ostrowski
Vice Chair
+1 847 444 5733
steve.ostrowski@colliers.com

Patrick Turner
Executive Vice President
+1 847 698 8277
patrick.turner@colliers.com

