

RETAIL PROPERTY FOR LEASE

Yadkin Park Plaza

5447 Yadkin Rd, Fayetteville, NC 28303



for more information

NEIL GRANT

Principal / Broker

O: 910.829.1617 x206

C: 910.818.3252

neil@grantmurrayre.com

VISHAL NANDWANI

Broker

O: 910.829.1617

C: 910.578.4797

vishal@grantmurrayre.com



Grant - Murray

REAL ESTATE, LLC

COMMERCIAL AND INVESTMENT BROKERAGE

150 N. McPherson Church Rd | Fayetteville, NC 28303 | www.grantmurrayre.com



PROPERTY OVERVIEW

Available SF:	1,109 SF
Lease Rate:	\$18 SF/yr (MG)
Lot Size:	1.28 Acres
Year Built:	2018
Building Size:	11,632 SF
Zoning:	CC
Market:	Fayetteville

property description

This established shopping center along the northbound side of Yadkin Road offers a rare 1,100-square-foot availability in a corridor known for consistent retail performance. Suite 110 features a large open floor plan complemented by a private restroom, providing flexibility for a range of retail, service, or office users. The layout allows for efficient buildout and strong merchandising visibility, making it well-suited for boutique retail, personal services, or specialty concepts. With direct frontage on Yadkin Road and exposure to 21,000 vehicles per day, tenants benefit from sustained consumer visibility throughout the day. Surrounded by a lineup of successful neighboring businesses, this center supports both destination-driven and impulse visits.

5447 YADKIN RD, FAYETTEVILLE, NC 28303

PROPERTY DETAILS & HIGHLIGHTS

Building Name	Yadkin Park
Property Type	Retail
Property Subtype	Strip Center
APN	0408-66-1537-
Building Size	11,632 SF
Lot Size	1.28 Acres
Year Built	2018
Number of Floors	1

This established shopping center along the northbound side of Yadkin Road offers a rare 1,100-square-foot availability in a corridor known for consistent retail performance. Suite 110 features a large open floor plan complemented by a private restroom, providing flexibility for a range of retail, service, or office users. The layout allows for efficient buildout and strong merchandising visibility, making it well-suited for boutique retail, personal services, or specialty concepts. With direct frontage on Yadkin Road and exposure to 21,000 vehicles per day, tenants benefit from sustained consumer visibility throughout the day. Surrounded by a lineup of successful neighboring businesses, this center supports both destination-driven and impulse visits.



- One Space Available
- 1,100 SF available retail suite
- Open floor plan with restroom
- 21,000 VPD on Yadkin Rd
- Near Fort Bragg Yadkin Gate
- 59,000+ daytime population (3-mile)
- Minutes from Cross Creek Mall

for more information

NEIL GRANT

Principal / Broker

O: 910.829.1617 x206

C: 910.818.3252

neil@grantmurrayre.com

VISHAL NANDWANI

Broker

O: 910.829.1617

C: 910.578.4797

vishal@grantmurrayre.com



Grant - Murray
REAL ESTATE, LLC

COMMERCIAL AND INVESTMENT BROKERAGE

5447 YADKIN RD, FAYETTEVILLE, NC 28303

ADDITIONAL PHOTOS

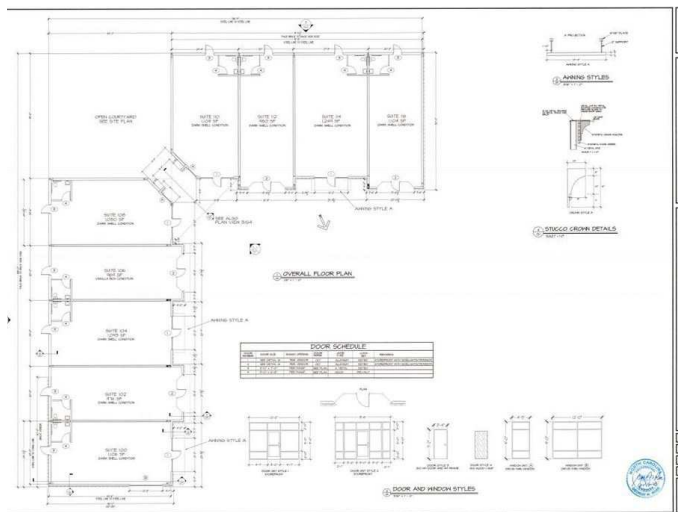

for more information

NEIL GRANT

Principal / Broker

O: 910.829.1617 x206

C: 910.818.3252

neil@grantmurrayre.com

VISHAL NANDWANI

Broker

O: 910.829.1617

C: 910.578.4797

vishal@grantmurrayre.com



Grant - Murray

REAL ESTATE, LLC

COMMERCIAL AND INVESTMENT BROKERAGE

Yadkin Park

5447 YADKIN RD, FAYETTEVILLE, NC 28303

ADDITIONAL PHOTOS

Population Median Age	32.7	32.7	31.2	31.8
% Any College (13+)	68.2%	68.2%	68.9%	68.7%



for more information

NEIL GRANT
Principal / Broker
O: 910.829.1617 x206
C: 910.818.3252
neil@grantmurrayre.com

VISHAL NANDWANI
Broker
O: 910.829.1617
C: 910.578.4797
vishal@grantmurrayre.com



Grant - Murray
REAL ESTATE, LLC
COMMERCIAL AND INVESTMENT BROKERAGE