

# LEASED INDUSTRIAL INVESTMENT OPPORTUNITY

18,945 SF > NORTHEAST ATLANTA, GEORGIA



# 4300 Business Park Court



## Building Features

### > Building A - 12,000 SF (2,000 SF Office) - FOR LEASE

- 1 Dock High Door
- 2 Drive-in Doors
- Built in 1987

### > Building B - 6,945 SF (905 SF Office) - LEASED

- 2 Drive-in Doors
- Built in 1998

## Current Occupancy

- > Building A is available for lease. The tenant in Building B recently renewed for a five year term. Details of the Building B lease are available upon execution of the attached confidentiality agreement and approval of Buyer prospect by Seller.



RYAN SAWYER  
404 877 9274 DIRECT  
ryan.sawyer@colliers.com

DENNIS MITCHELL  
404 877 9280 DIRECT  
dennis.mitchell@colliers.com

COLLIERS INTERNATIONAL  
Two Midtown Plaza, Suite 1100  
1349 West Peachtree Street NE  
Atlanta, Georgia 30309-2956  
www.colliers.com

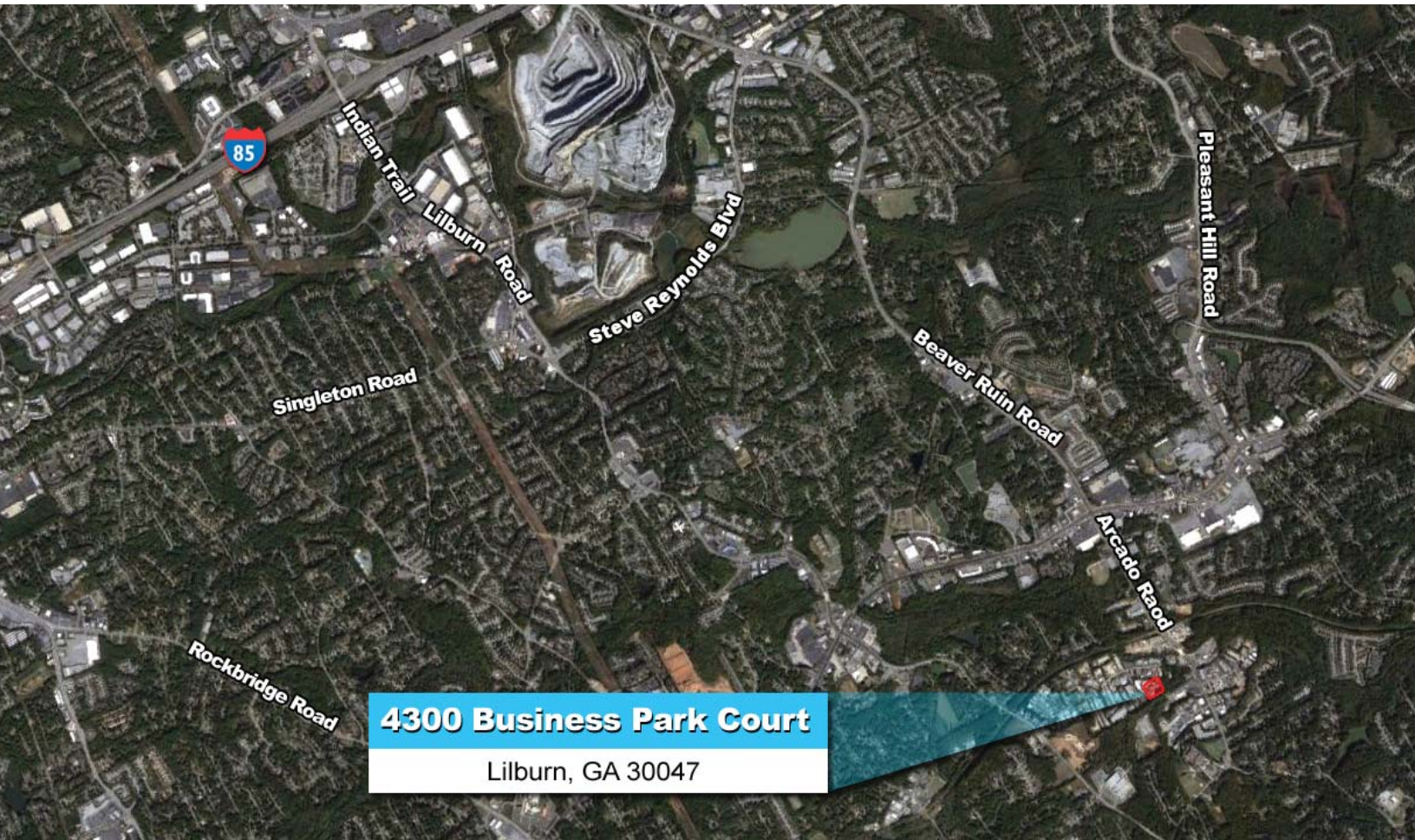

**4300 Business Park Court**

Lilburn, GA 30047

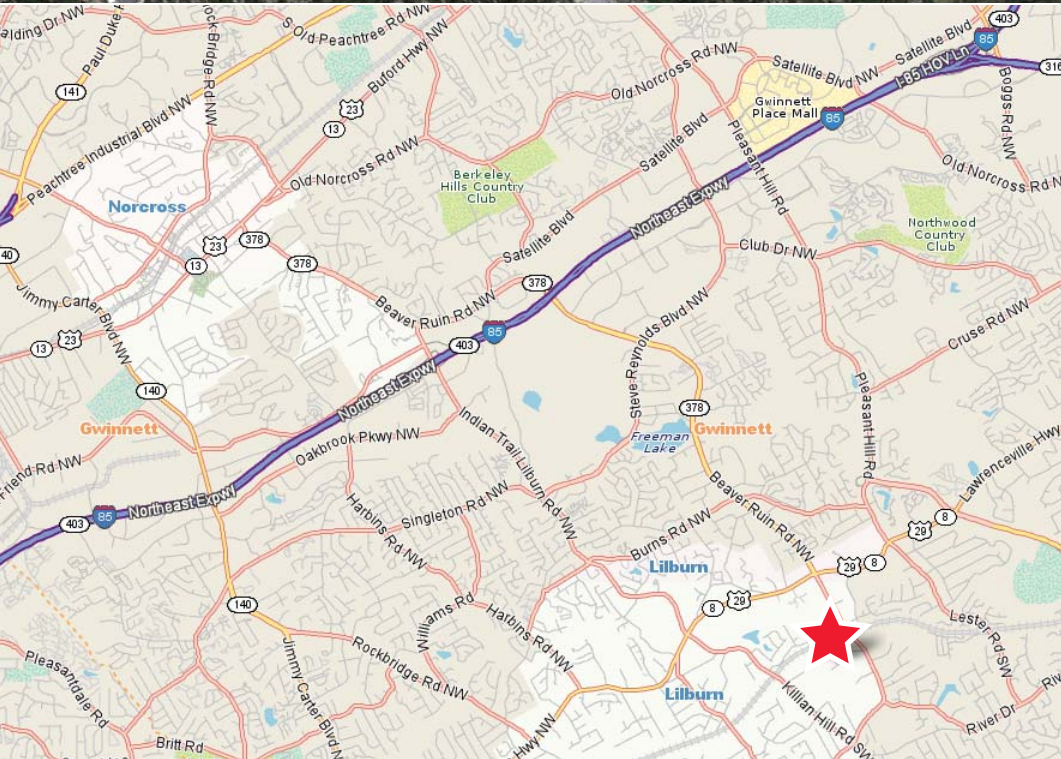

## Contact Us

RYAN SAWYER

404 877 9274 DIRECT

[ryan.sawyer@colliers.com](mailto:ryan.sawyer@colliers.com)

DENNIS MITCHELL

404 877 9280 DIRECT

[dennis.mitchell@colliers.com](mailto:dennis.mitchell@colliers.com)

COLLIERS INTERNATIONAL  
Two Midtown Plaza, Suite 1100  
1349 West Peachtree Street NE  
Atlanta, Georgia 30309-2956

[www.colliers.com](http://www.colliers.com)