

EXECUTIVE PLACE I

777 Oakmont Lane
Westmont, IL

Suites 1400 - 2000
2,370 - 27,278 RSF

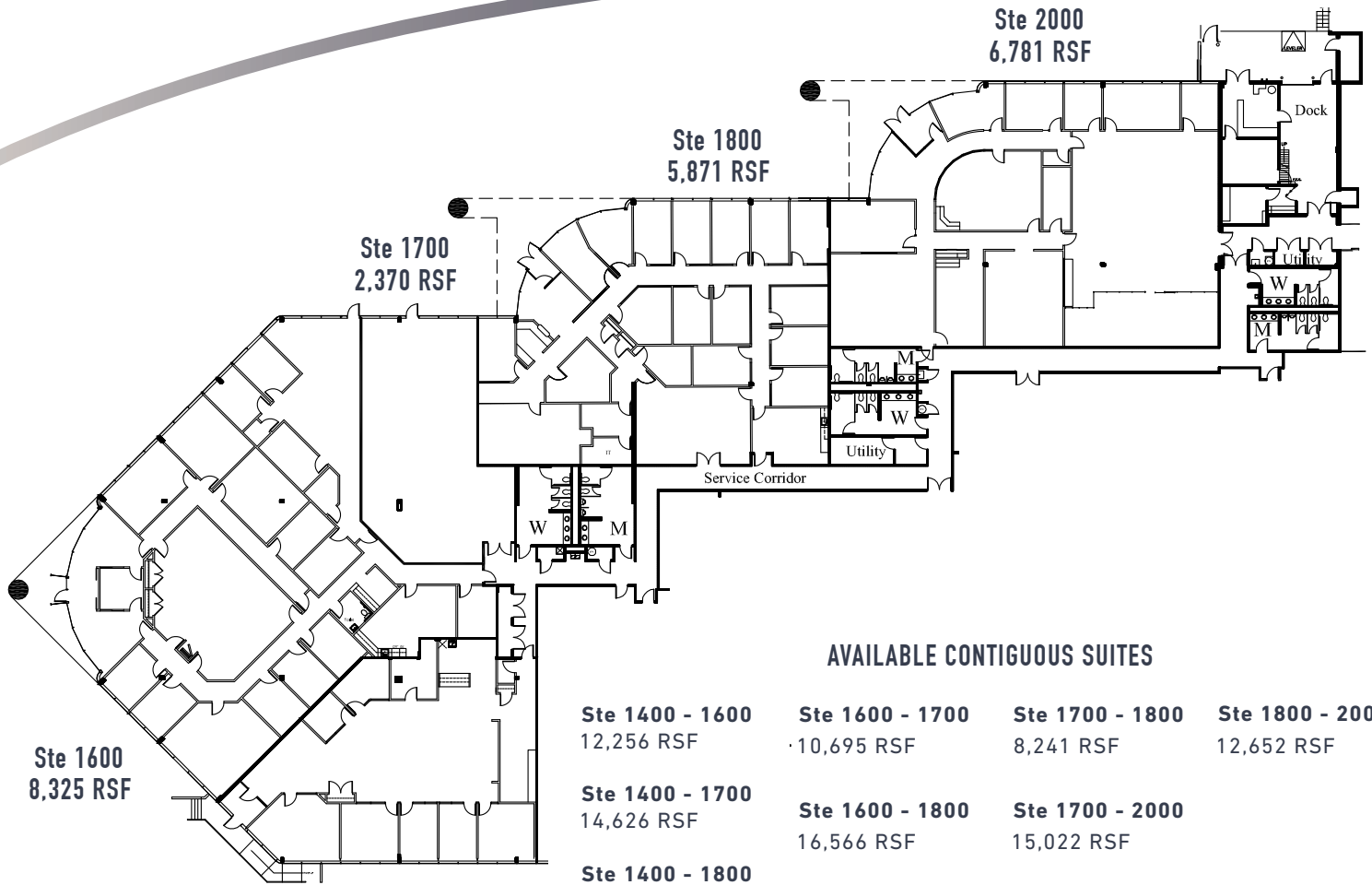

AVAILABLE CONTIGUOUS SUITES

Ste 1400 - 1600 12,256 RSF	Ste 1600 - 1700 10,695 RSF	Ste 1700 - 1800 8,241 RSF	Ste 1800 - 2000 12,652 RSF
Ste 1400 - 1700 14,626 RSF	Ste 1600 - 1800 16,566 RSF	Ste 1700 - 2000 15,022 RSF	
Ste 1400 - 1800 19,497 RSF	Ste 1600 - 2000 23,347 RSF		
Ste 1400 - 2000 27,278 RSF			

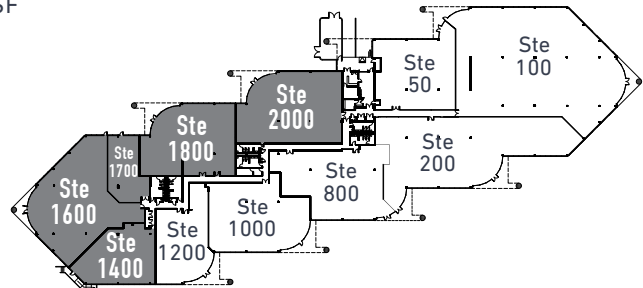

CONTACT

JIM ADLER

630 691 0605

jadler@hiffman.com

DAN O'NEILL

630 691 0610

doneill@hiffman.com

COURTNEY SWEISS

630 317 0748

csweiss@hiffman.com

GROUP RMC

NAL Hiffman
Commercial Real Estate Services, Worldwide