

# FOR LEASE OR SALE



## 7071 SOUTHWEST FREEWAY

**Houston, Texas 77074**

42,922 SF on 2.53 Acres Available

# 7071 SOUTHWEST FREEWAY

Houston, Texas 77074

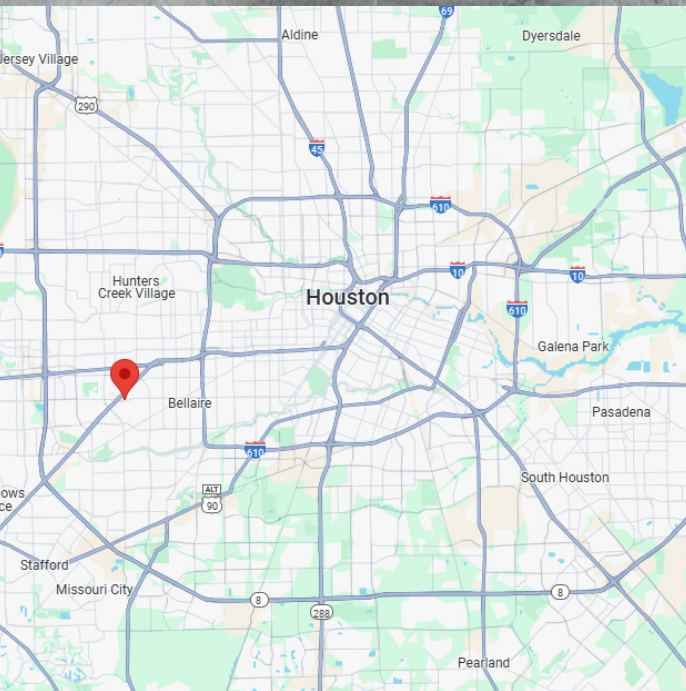
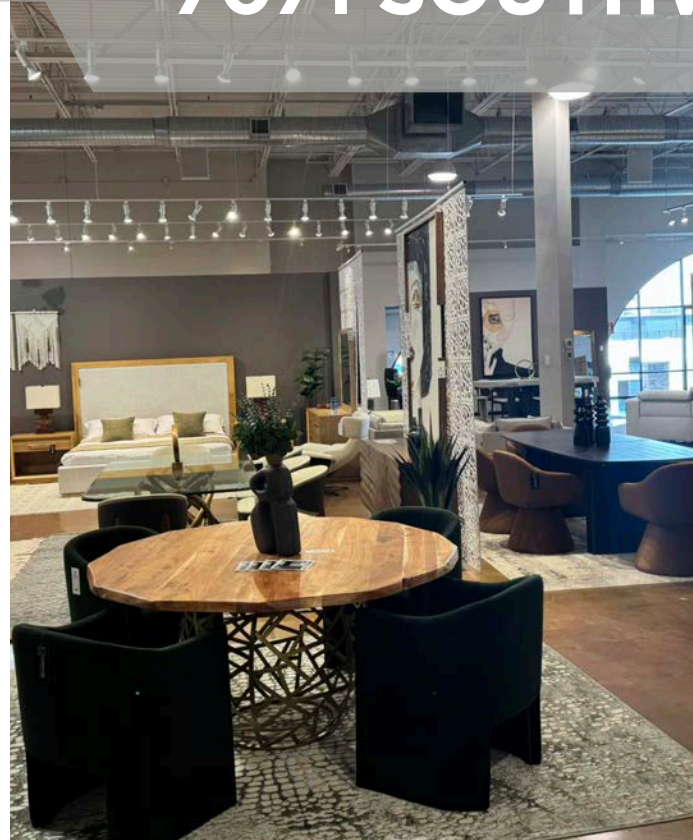

## Property Highlights

- 42,922 SF of Total Building
  - First Floor: 39,209 SF
  - Second Floor: 3,713 SF
- 114,771 SF Site
- 22' Clear Height
- 2 Dock Doors with Levelers
- 2 Grade Access Doors
- Large HVAC Showroom
- Sprinklered
- Back-up Generator
- 800 Amp, 3 Phase 480V
- Pricing: Contact Broker
- Tenant In Place - Do Not Disturb

# 7071 SOUTHWEST FREEWAY

Houston, Texas 77074

## FLOOR 1 39,209 SF



## FLOOR 2 3,713 SF

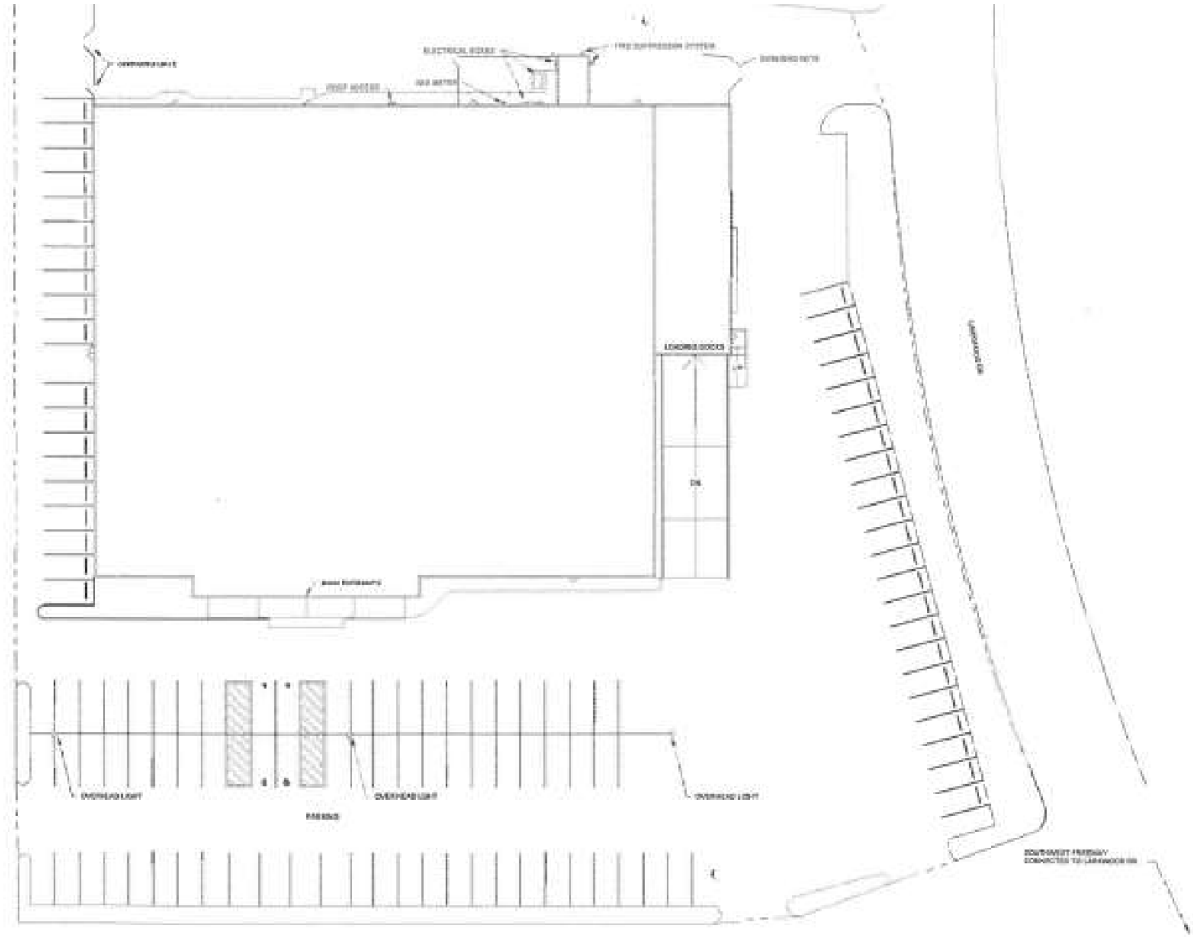
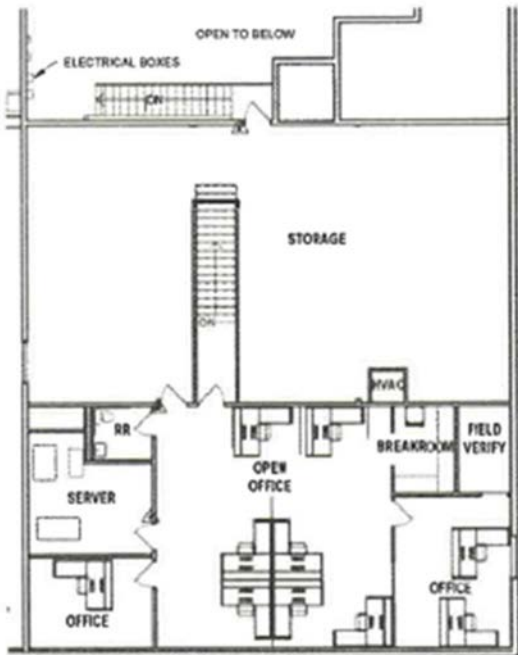

### Building Area:

1st Floor:  
39,209 SF

2nd Floor:  
3,713 SF

### Approx Total:

Site Area:  
114,146 SF

Total:  
42,922 SF

Yard Area:  
71,224 SF

# FLOOR PLAN

# 7071 SOUTHWEST FREEWAY

Houston, Texas 77074



Bintliff Dr

Larkwood Dr

7071 SOUTHWEST FREEWAY

AERIAL  
MAP

# 7071 SOUTHWEST FREEWAY

Houston, Texas 77074



## CONTACT:

**KELLEY PARKER III, SIOR**  
Vice Chair  
+1 713 963 2896  
kelley.parker@cushwake.com

**COE PARKER, SIOR**  
Senior Director  
+1 713 963 2825  
coe.parker@cushwake.com

**JOHN F. LITTMAN, SIOR**  
Executive Managing Director  
+1 713 963 2862  
john.littman@cushwake.com



©2025 Cushman & Wakefield. All rights reserved. The information contained in this communication is strictly confidential. This information has been obtained from sources believed to be reliable but has not been verified. NO WARRANTY OR REPRESENTATION, EXPRESS OR IMPLIED, IS MADE AS TO THE CONDITION OF THE PROPERTY (OR PROPERTIES) REFERENCED HEREIN OR AS TO THE ACCURACY OR COMPLETENESS OF THE INFORMATION CONTAINED HEREIN, AND SAME IS SUBMITTED SUBJECT TO ERRORS, OMISSIONS, CHANGE OF PRICE, RENTAL OR OTHER CONDITIONS, WITHDRAWAL WITHOUT NOTICE, AND TO ANY SPECIAL LISTING CONDITIONS IMPOSED BY THE PROPERTY OWNER(S). ANY PROJECTIONS, OPINIONS OR ESTIMATES ARE SUBJECT TO UNCERTAINTY AND DO NOT SIGNIFY CURRENT OR FUTURE PROPERTY PERFORMANCE.