

# Willow Commons

Retail Space For Lease

305-341 W 75th Street | Willowbrook, Illinois 60527



Retail

## Property Information

- 2,004 SF & 4,024 SF Available
- Located on busy 75th Street
- Immediately across from Hinsdale South High School
- Over 22,000 VPS at this intersection
- Good population density and incomes
- Multiple access points with plenty of parking
- Good visibility to 75th Street

Darien Sportsplex  
& Ice Arena

Hinsdale South  
High School

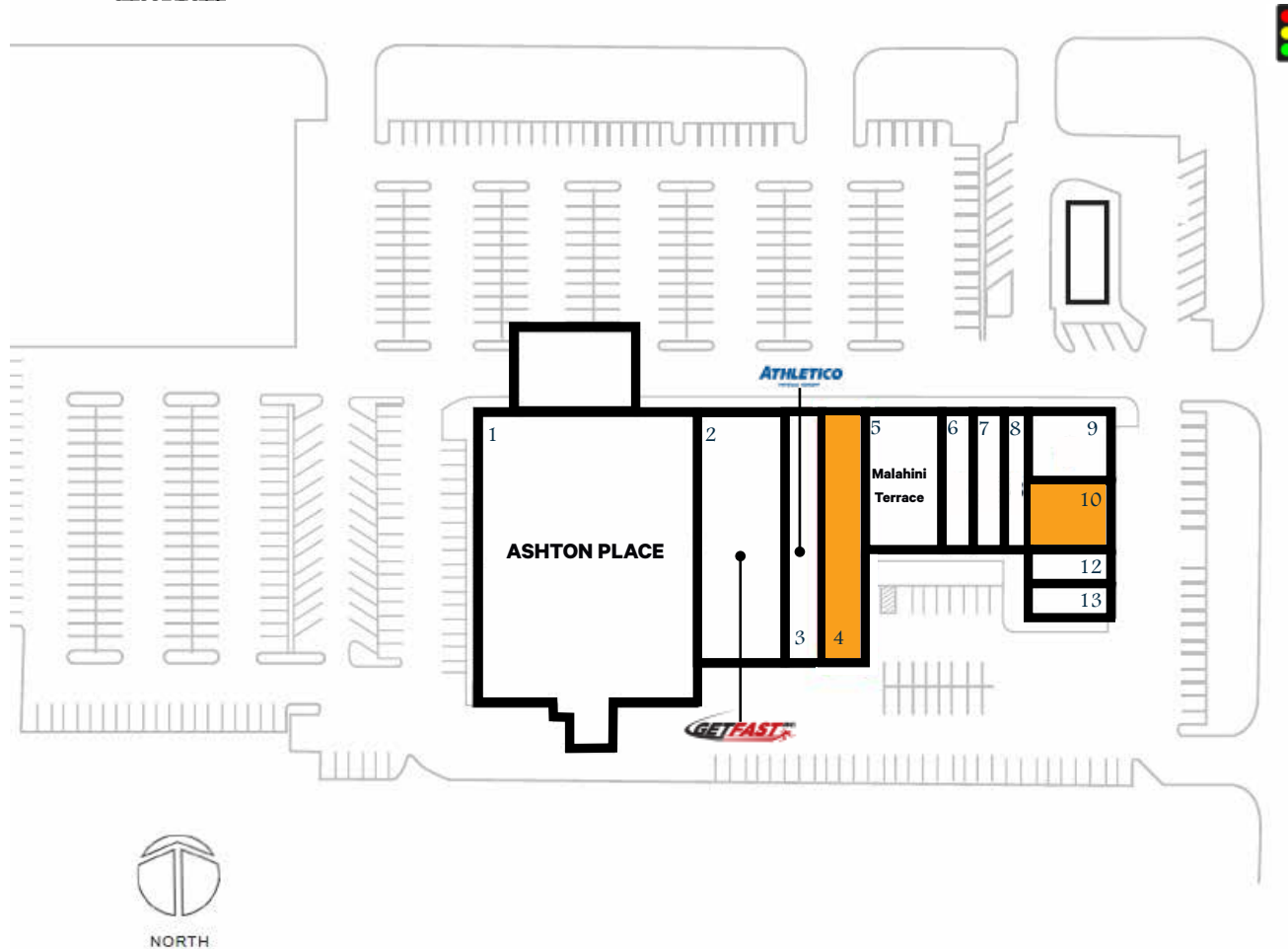

Unit #	Sq. Ft.	Tenant
1	26,873	Ashton Place
2	8,580	Get Fast
3	3,953	Athletico
4	4,024	COMING AVAILABLE
5	3,895	Malahini Terrace
6	1,640	Periodontics & Dental Implant Center
7	1,640	Rosie's Gaming
8	1,560	Yu Nails
9	2,202	Othodontics Experts Management LLC
10	2,004	AVAILABLE
12	1,034	Center Cleaners
13	1,092	Dairy Queen/Orange Julius

## Contact Us

**Les Kristof**  
Vice President  
+1 630 573 1282  
Les.Kristof@cbre.com

# Willow Commons

305-341 W 75th Street | Willowbrook, Illinois 60527

# For Lease



Demographics	1 Mile	3 Mile	5 Mile
Population	4,366	67,429	181,123
Average HH Income	\$224,884	\$180,874	\$182,842
Daytime Population	16,817	70,466	182,578
Employees	14,157	40,367	100,154

Traffic Counts	
Plainfield Road	15,800 VPD
75th Street (Rt 33)	14,700 VPD

## Contact Us

**Les Kristof**  
 Vice President  
 +1 630 573 1282  
 Les.Kristof@cbre.com

© 2026 CBRE, Inc. All rights reserved. This information has been obtained from sources believed reliable but has not been verified for accuracy or completeness. CBRE, Inc. makes no guarantee, representation or warranty and accepts no responsibility or liability as to the accuracy, completeness, or reliability of the information contained herein. You should conduct a careful, independent investigation of the property and verify all information. Any reliance on this information is solely at your own risk. CBRE and the CBRE logo are service marks of CBRE, Inc. All other marks displayed on this document are the property of their respective owners, and the use of such marks does not imply any affiliation with or endorsement of CBRE. Photos herein are the property of their respective owners. Use of these images without the express written consent of the owner is prohibited.