



**MT. JULIET
LOGISTICS**

1271 E Division Street, Mt. Juliet, TN

DELIVERY DATE

Q2 2027

SQUARE FEET

183,651

AVAILABLE FOR SALE OR LEASE

CBRE

PROPERTY OVERVIEW

| | | | |
|--------------------------|---|-----------------------|--|
| TOTAL SF | 183,651 SF | ROOF | R-20, 60mil TPO roof, 20yr warranty |
| WAREHOUSE SF | 181,451 SF | POWER | 2,000 amps |
| OFFICE SF | 1,918 SF spec office | COLUMN SPACING | 44'-6" x 52'-4" (60' Speed Bay) |
| CONFIGURATION | Rear-load | SPRINKLER | ESFR sprinkler system |
| CLEAR HEIGHT | 32' | DRIVE IN DOORS | 2 (12'x14') and ramps |
| BUILDING DEPTH | 195' | DOCK DOORS | 50 Total - 26 dock doors with bumpers (24 knock-outs) |
| TRUCK COURT DEPTH | 130' | PARKING | TBD |
| CONSTRUCTION TYPE | 8.5" - 9.25" thick concrete tilt panels | SLAB | 6" concrete slab |



E DIVISION STREET

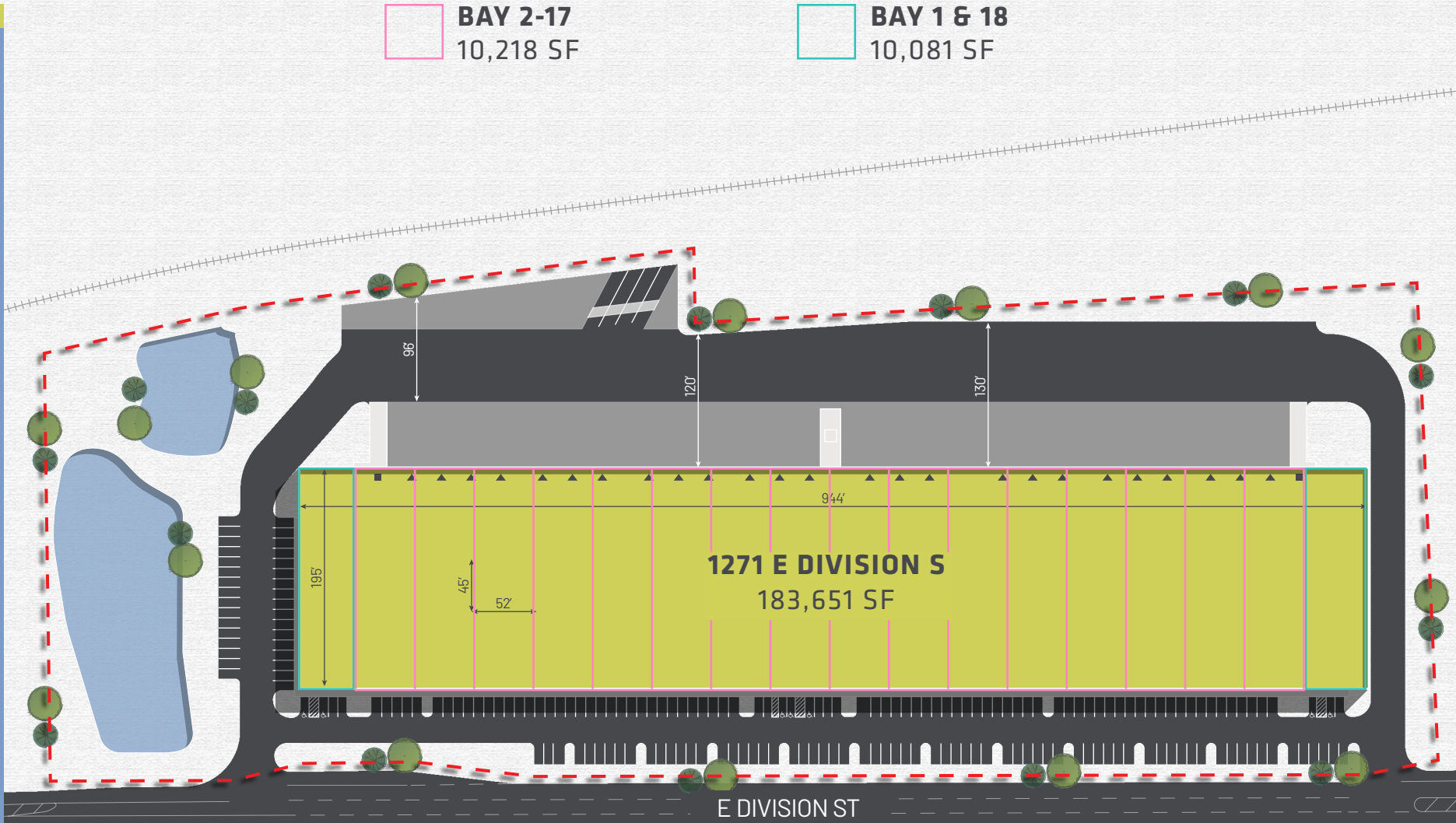

- ▲ Dock Door
- Drive-In Door





Manheim
by Cox Automotive

FedEx

GOLDEN BEAR GATEWAY

amazon

COSTCO
WHOLESALE

Airtron
HEAVY & SPECIALIZED

ceVA
LOGISTICS

randstad

MEDLINE

Hollister

ceVA
LOGISTICS

KHS Amerlca

ceVA
LOGISTICS

amazon

UNDER ARMOUR

40

JONES
BROS

ROAD TO BE WIDENED TO 29'
WITH 4' SHOULDERS

R.-J. CORMAN RAIL ROAD

EAST DIVISION STREET



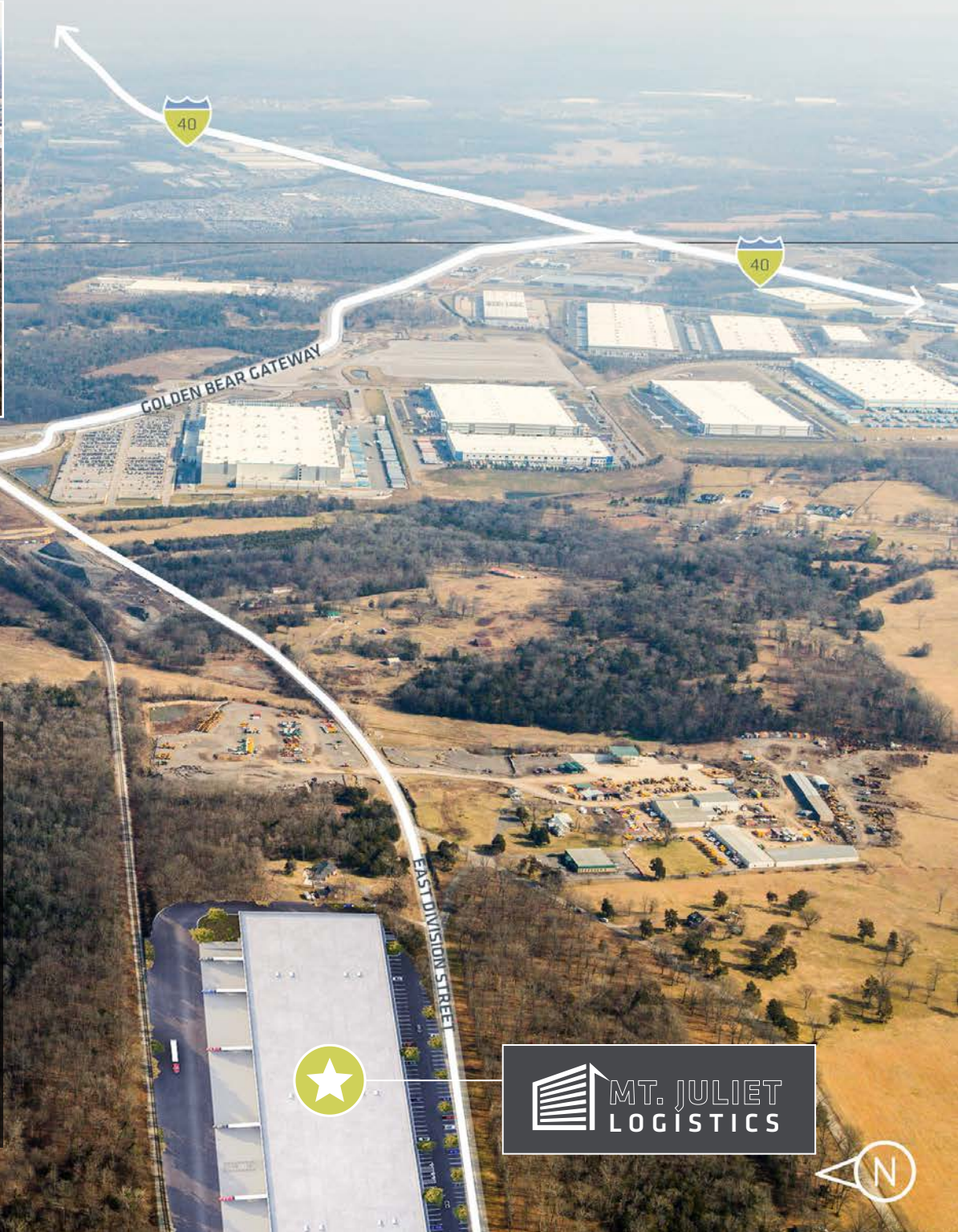

| DRIVE TIMES | |
|------------------------|------------|
| I-40 | >5 Minutes |
| 1-840 | 10 Minutes |
| HIGHWAY 109 | 10 Minutes |
| NASHVILLE INT. AIRPORT | 20 Minutes |
| DT NASHVILLE | 25 Minutes |
| 1-24 | 30 Minutes |
| 1-65 | 30 Minutes |





GATEWAY TO THE SOUTHEAST
FROM THE WEST COAST

FROM NASHVILLE, 72% OF THE
US POPULATION IS REACHED
WITH FEDEX'S ONE AND TWO-DAY
GROUND DELIVERY

75%

OF MAJOR US MARKETS ARE
WITHIN A 2 HOUR FLIGHT

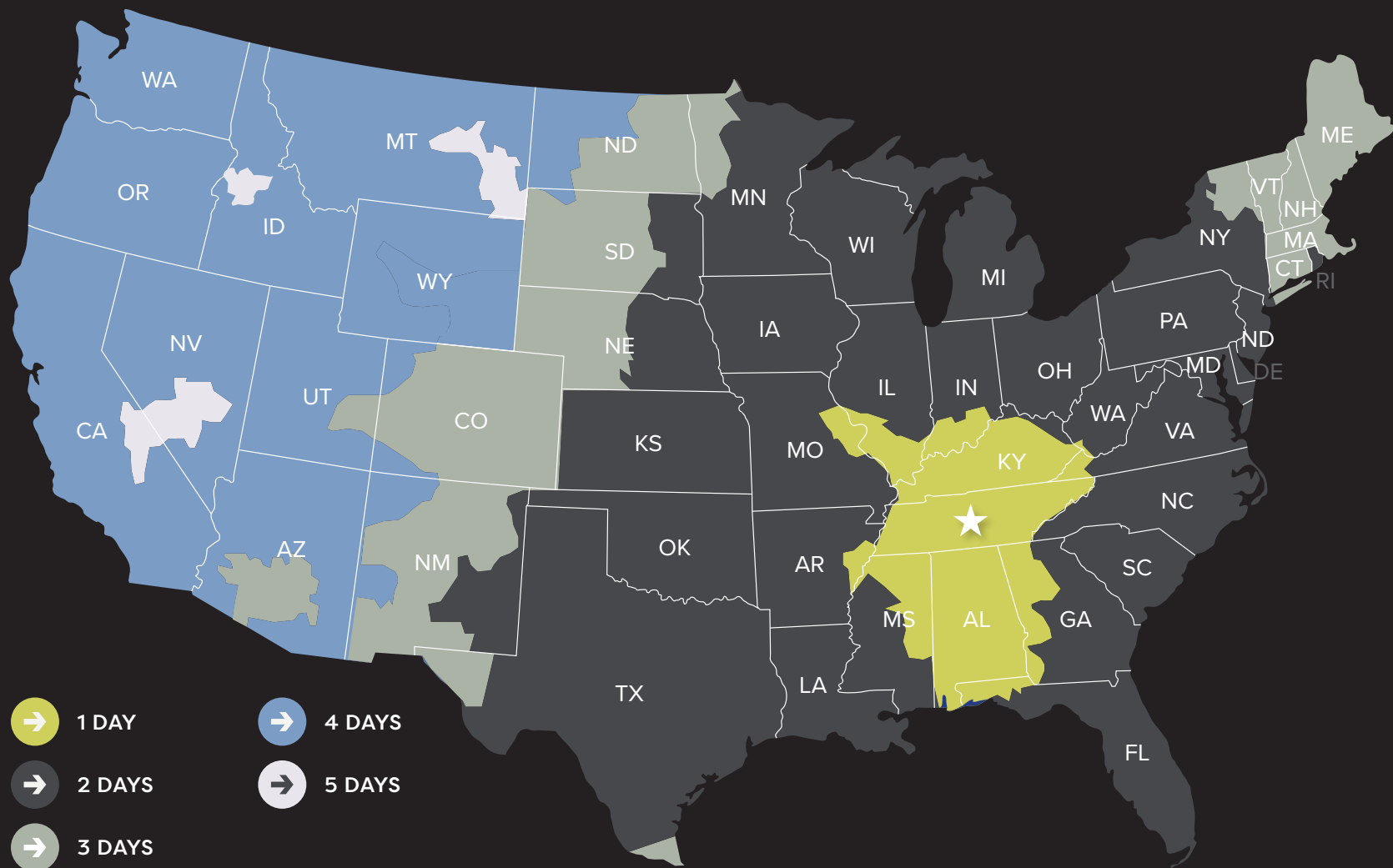



MT. JULIET LOGISTICS



CONTACT

JACK ARMSTRONG

Senior Vice President

jack.armstrong@cbre.com

+1 615 248 3500

+1 561 339 9071

WILL GOODMAN

Senior Vice President

will.goodman@cbre.com

+1 615 248 3500

+1 321 230 1522

DAVIS GOODMAN

Senior Associate

davis.goodman@cbre.com

+1 615 248 3500

+1 407 361 7474

© 2026 CBRE, Inc. All rights reserved. This information has been obtained from sources believed reliable but has not been verified for accuracy or completeness. You should conduct a careful, independent investigation of the property and verify all information. Any reliance on this information is solely at your own risk. CBRE and the CBRE logo are service marks of CBRE, Inc. All other marks displayed on this document are the property of their respective owners, and the use of such logos does not imply any affiliation with or endorsement of CBRE. Photos herein are the property of their respective owners. Use of these images without the express written consent of the owner is prohibited.

CBRE