

2251 Picadilly Drive - Building C

Austin, TX

Key Facts

Property type Industrial space

Building size 450,015 SF

Space available 64,847 SF



Contact Us

Learn more about this property or schedule a tour by reaching out to our local investment and leasing officer.

Barney Sinclair

+1 (214) 476-6554

barney.sinclair@eqtpartners.com

2251 Picadilly Drive - Building C

Austin, TX

BUILDING SPECIFICATIONS

Class A industrial building totaling 450,015 SF
64,847 SF available
3,932 SF office area
28' clear height
50' x 50' column spacing w/ 60' staging bay
ESFR sprinkler system
14 dock-high loading doors
1 grade-level loading door
Low operating expenses
Trailer parking spaces available
Highly visible location with easy access to I-25, SH-45, SH-130, and Loop 1

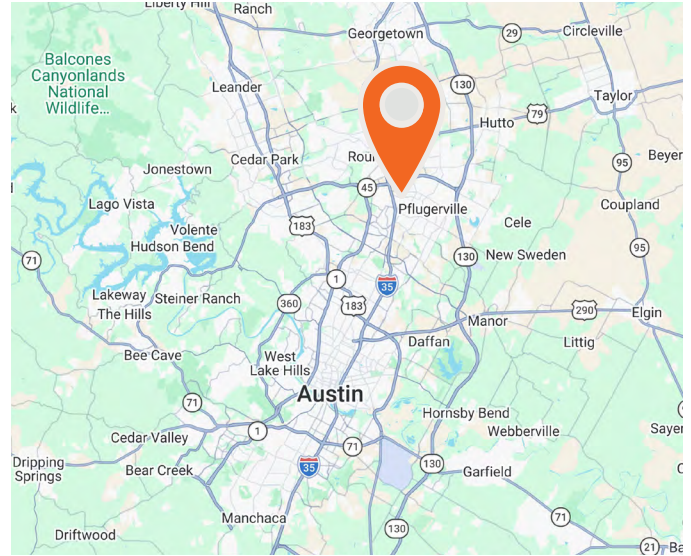

Contact Us

Learn more about this property or schedule a tour by reaching out to our local investment and leasing officer.

Barney Sinclair

+1 (214) 476-6554

barney.sinclair@eqtpartners.com

2251 Picadilly Drive - Building C

Austin, TX

SITE PLAN

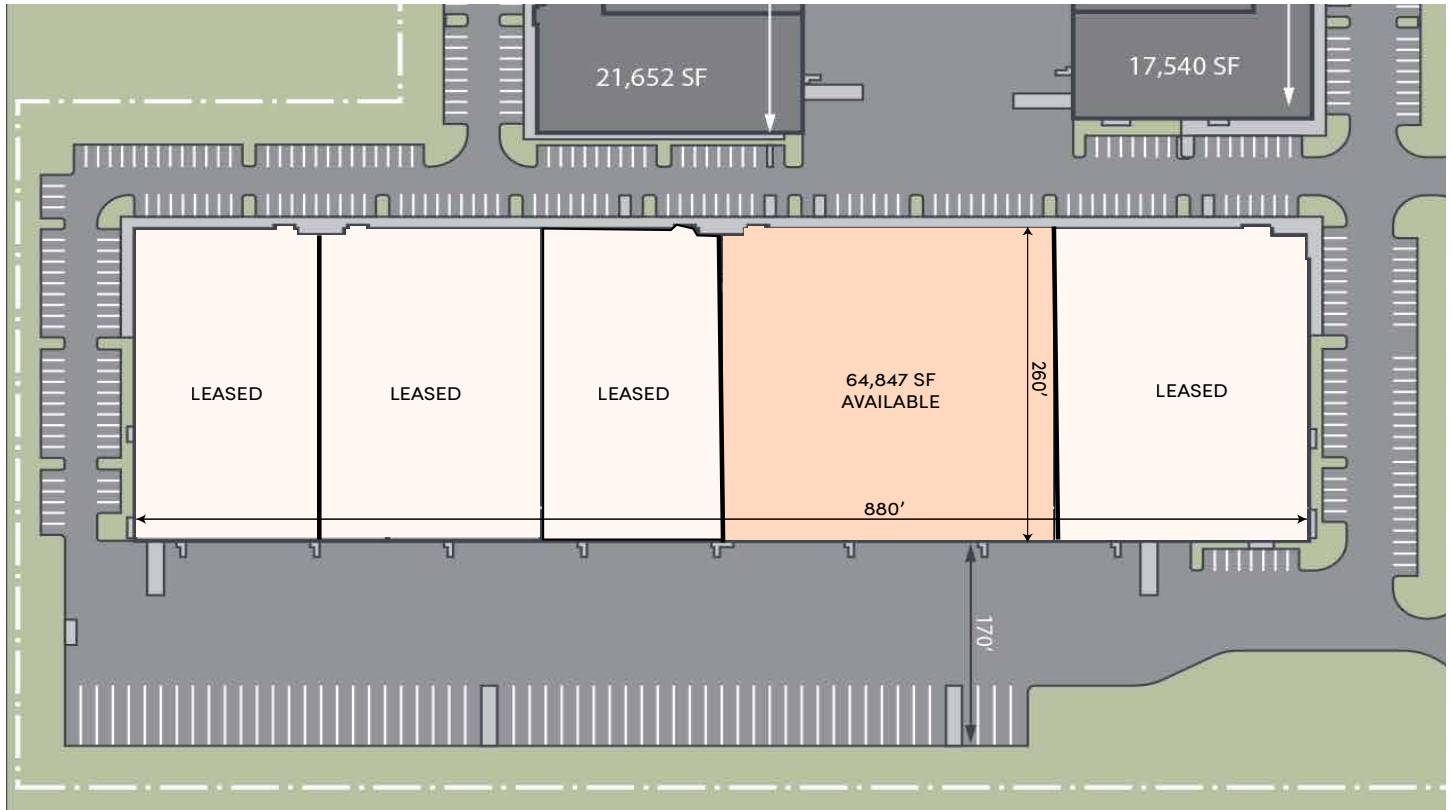

OFFICE PLAN

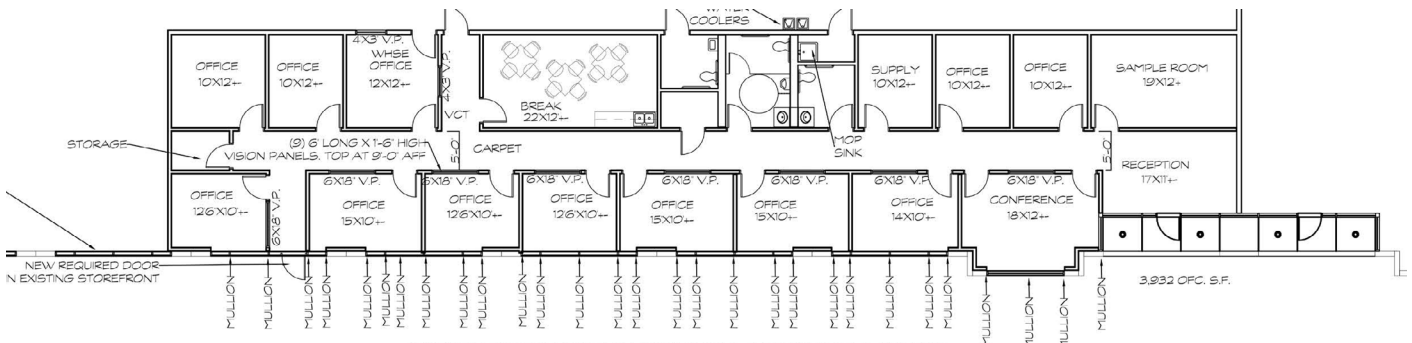

Contact Us

Learn more about this property or schedule a tour by reaching out to our local investment and leasing officer.

Barney Sinclair

+1 (214) 476-6554

barney.sinclair@eqtpartners.com