



Space Profile for

Unit: #130

Area: 1495 sq ft

Address

398 US-51, Ste. 45A

Ridgeland, MS 39157



400 N. Tampa St., Suite 2210

Tampa, FL, 33602

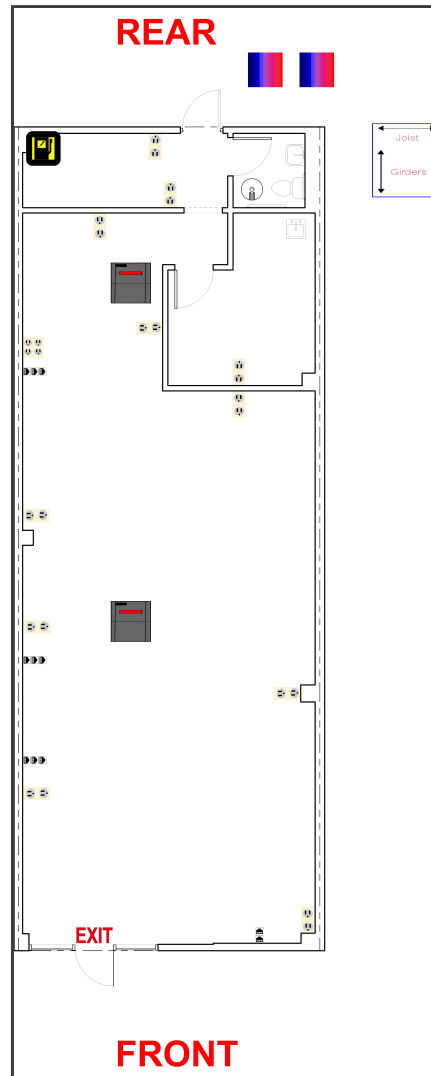

Legend

	Breaker Panel		Fire Extinguisher		Ceiling Fan w/ Light		Fire Sprinkler
	Circular Column		Fire Alarm Pulldown		Rectangular Column		Pocket Door
	Appliance Outlet		Glass Door		Refrigerator		Track Lighting
	Fire Alarm		Handicap Handrail		Roll-Up Door		2-Bulb Fluorescent Lighting
	Drinking Fountain		Roof Hatch		Sink		3-Bulb Fluorescent Lighting
	Door		HVAC Unit		Swing Door		4-Bulb Fluorescent Lighting
	Double Hung Door		Recessed Light		Toilet		Ceiling Air Vent
	Electrical Outlet		Staircase		Can Light		Air Diffuser
	Emergency Light		Water Heater		Urinal		Ceiling Fan w/o Light
	Exit Light		Telephone Panel		Thermostat		Air Handler
	Tankless Water Heater		Window Wall Opening		RJ 45		Fire Alarm Control Panel
	Step Down Transformer		Maintenance Sink		Window		Tenant Water Meter
	Disconnect		Sub Water Meter		House Gas Meter		Sub Gas Meter
	House Water Meter		Air Handler		House Electric Meter		Tenant Electric Meter
	Tenant Gas Meter						
	Sub Electric Meter						

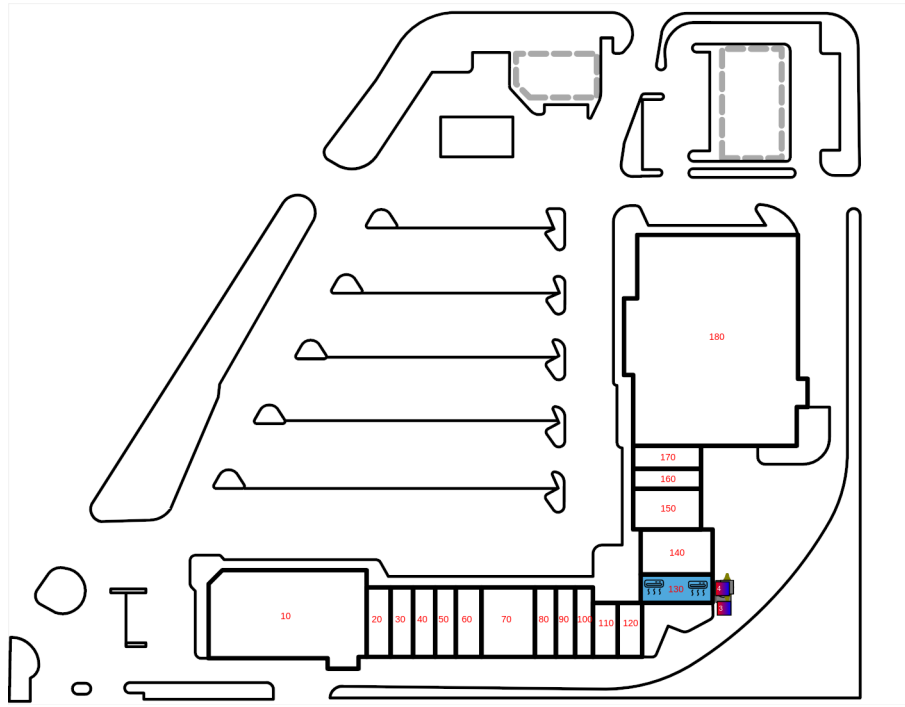

Space Overview

Overview	Actual Square Footage	Measured Depth of Space	Has Stepdown Transformer
	1495 SQFT	64' 6"	No

Thickness	Front Wall	Rear Wall	Left Wall	Right Wall
	0' 6"	0' 6"	0' 8"	0' 9"

Flooring	Concrete	Carpet	Tile	Other	Unit	Total
				1410.51 SQFT	1495 SQFT	1410.51 SQFT

Ceiling Information	Height From Floor To Ceiling	Height From Floor To Bottom Of Deck	Height From Floor To Bottom Of Joist
	Front: 9' 11" Back: 9' 11"	Front: 18' 10" Back: 17' 5"	Front: 17' 8" Back: 16' 3"

Ceiling Information Cont.	Clear Ceiling Height
	9' 8"

Mechanical

Air Handler	Reference	Manufacturer	Model	Serial	Tonnage	Year	Notes
	6	AMERICAN STANDARD (AHU)	INACCESSIBLE	INACCESSIBLE			
	5	AMERICAN STANDARD (AHU)	INACCESSIBLE	INACCESSIBLE			

HVAC	Reference	Manufacturer	Model	Serial	Tonnage	Year	Notes
	3	TRANE	4TTB3048A1000BA	9251RF44F	4	2008	
	4	GOODMAN	GSX130241BA	1101633630	2	2011	

Electric

Disconnect	Reference	Amps	Location	UL Number	Manufacturer	Handle or Breaker	Notes
	1	0	Rear Exterior	Not Listed	Not Listed	Breaker	No Label

Electric Meter	Reference	Meter #	Location	Meter Reading	Read On	Voltage	Notes
	2	11083608	Rear Exterior				

Service Panel	Reference	Amps	Service Type	Panel Type	Panel UL Number	Manufacturer	Location	Notes
	1	200	120/208	Not Listed	Not Listed	Cutler Hammer	Storage Room	

IDPlans does not provide an Ampacity Report

Plumbing

Water Heater	Reference	Manufacturer	Model	Serial	Gallons	Tank	Tankless	Water Line (in)	Location	Notes
	1	Rheem	B1VP20S	0294304559	20	Yes	No	3/4	Above Unisex Restroom	

Water Meter	Reference	Meter #	Location	Size	Notes
	2		86740579	Rear Exterior	3/4 inch

Waste

No assets available for this section.

Fire

Sprinkler Heads	Sprinkler Heads Present	Sprinkler Head Type	Riser Located in Space	Riser Location	Additional Information
	15	N/A	No	N/A	

Gas

No assets available for this section.

Room

Restroom	Unit	Description
	Restroom 1	Unisex Restroom

Reflective Ceiling Plan 1

REAR

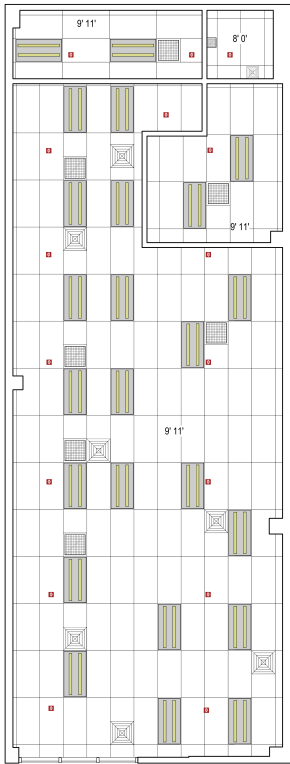

FRONT