



4355 COUNTY LINE ROAD
CHALFONT, PA

INDUSTRIAL / WAREHOUSE SPACE
AVAILABLE FOR LEASE

| 26,615 SF

4355 COUNTY LINE ROAD HIGHLIGHTS

- **BUILDING SF:**
94,706 SF
- **AVAILABLE SF:**
26,615 SF for lease
- **COLUMN SPACING:**
44'6" x 39'
- **CEILING HEIGHTS:**
15'-18'6"
- **DRIVE-INS:**
1 Drive-In (12'w x 14'h)
- **LOADING DOCKS:**
3 Loading Docks with levelers
(2: 8'w x 8'h, 1: 8'w x 10'h)
- **ZONING:**
Industrial Zoning (New Britain Township)
- **FIRE PROTECTION:**
Full Wet Sprinkler System
- **HEATING/COOLING:**
Gas heat throughout and AC
in 6,900 SF
- **BATHROOMS:**
1 bathroom
- **POWER:**
3 phase 200a power
- **PARKING:**
20-25 Spaces with 1 Handicap
- **UTILITIES**
Natural gas
Public sewer
Public water
Verizon available on site



ADDITIONAL PHOTOS



FLOOR PLANS

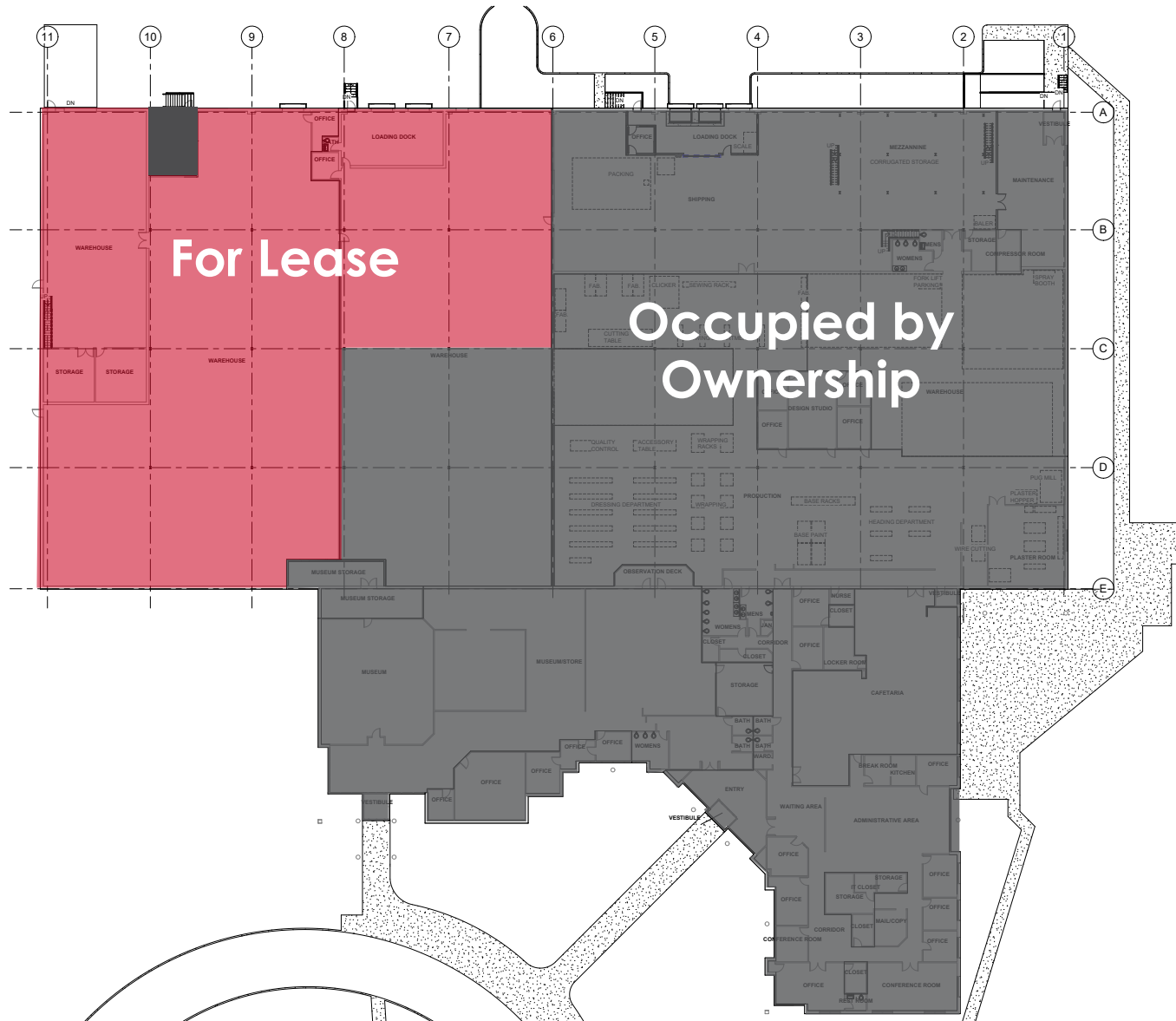



4355 COUNTY LINE ROAD



LOCATION

This property is located in Chalfont, Bucks County, Pennsylvania and is in close proximity to Routes 309, 202 and I-476 and I-276.

DEMOGRAPHICS

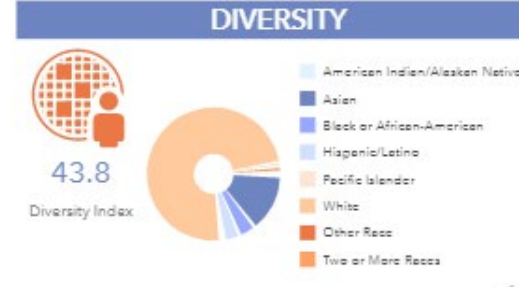
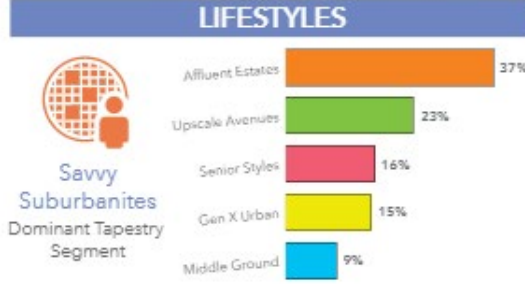
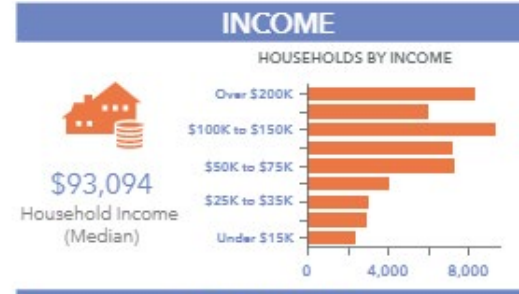
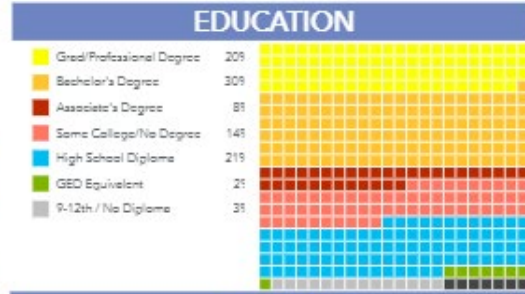
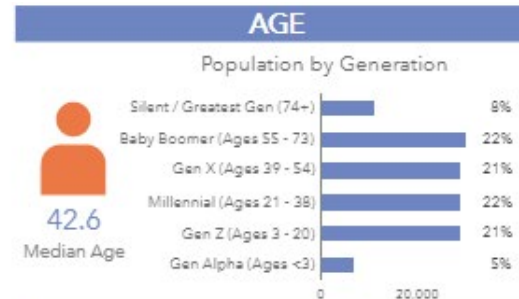
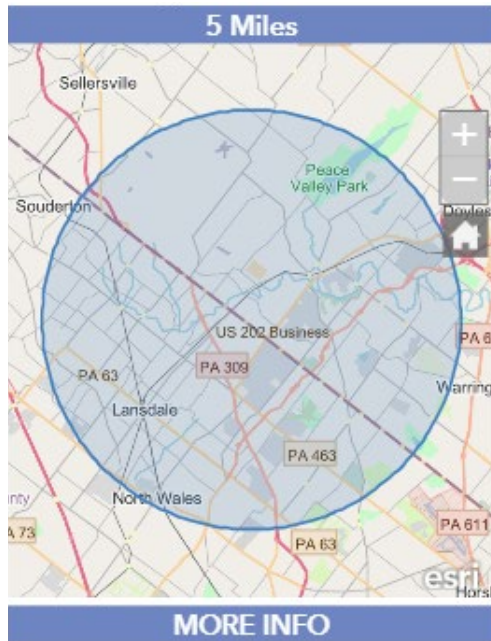

Want access to thousands of datasets about future trends, psychographics, consumer behavior, business, and analytics?

Contact Datastory via info@datastoryconsulting.com or 443.266.6216



v1.0

CONTACT



Matt Corrigan
Vice President
215.448.6018
mcorrigan@binswanger.com



Tim Pennington
Partner & Senior Vice President
215.407.1272
tpennington@binswanger.com



Three Logan Square
1717 Arch Street, Suite 5100
Philadelphia, PA, 19103
Phone: 215.448.6000
binswanger.com

The information contained herein is from sources deemed reliable, but no warranty or representation is made as to the accuracy thereof and no liability may be imposed.