

# 95

## SECOND AVENUE EAST VILLAGE, NYC

Between East 5<sup>th</sup> & 6<sup>th</sup> Streets

RESTAURANT FOR LEASE



CONCEPTUAL RENDERING

PROPERTY INFORMATION

### APPROXIMATE SIZE

1,650 SF + Lower Level

### ASKING RENT

\$19,500/Month

### POSSESSION

Immediate

### TERM

Negotiable

### FRONTAGE

20 FT

### COMMENTS

- Previously "Sinsa" wine bar/restaurant
- Move-in ready
- Fully vented with gas kitchen in lower level
- Previous full liquor license
- No key-money

### NEIGHBORS

Frank • Sushi by M • Doko Demo • Via Della Pace • Ella Funt • Topsy Shanghai • Van Leeuwen • Justin's Salt Bread • San Marzano • Elsewhere Espresso • Sauced

### TRANSPORTATION



### NOAM AZIZ

Senior Director  
212.468.5984  
naziz@meridiancapital.com

### MAX FREUDENBERGER

Senior Associate  
212.468.5951  
mfreudenberg@meridiancapital.com

### CARSON SHAHRABANI

Senior Associate  
212.468.5927  
cshahrabani@meridiancapital.com



**MERIDIAN**  
RETAIL LEASING

All information supplied is from sources deemed reliable and is furnished subject to errors, omissions, modifications, removal of the listing from sale or lease, and to any listing conditions, including the rates and manner of payment of commissions for particular offerings imposed by Meridian Capital Group. This information may include estimates and projections prepared by Meridian Capital Group with respect to future events, and these future events may or may not actually occur. Such estimates and projections reflect various assumptions concerning anticipated results. While Meridian Capital Group believes these assumptions are reasonable, there can be no assurance that any of these estimates and projections will be correct. Therefore, actual results may vary materially from these estimates and projections. Any square footage dimensions set forth are approximate.

# 95 SECOND AVENUE

EAST VILLAGE, NYC | Between East 5<sup>th</sup> and 6<sup>th</sup> Streets

RESTAURANT FOR LEASE



INTERIOR

## NOAM AZIZ

Senior Director  
212.468.5984  
naziz@meridiancapital.com

## MAX FREUDENBERGER

Senior Associate  
212.468.5951  
mfreudenberger@meridiancapital.com

## CARSON SHAHRABANI

Senior Associate  
212.468.5927  
cshahrabani@meridiancapital.com



**MERIDIAN**  
RETAIL LEASING

All information supplied is from sources deemed reliable and is furnished subject to errors, omissions, modifications, removal of the listing from sale or lease, and to any listing conditions, including the rates and manner of payment of commissions for particular offerings imposed by Meridian Capital Group. This information may include estimates and projections prepared by Meridian Capital Group with respect to future events, and these future events may or may not actually occur. Such estimates and projections reflect various assumptions concerning anticipated results. While Meridian Capital Group believes these assumptions are reasonable, there can be no assurance that any of these estimates and projections will be correct. Therefore, actual results may vary materially from these estimates and projections. Any square footage dimensions set forth are approximate.

# 95 SECOND AVENUE

EAST VILLAGE, NYC | Between East 5<sup>th</sup> and 6<sup>th</sup> Streets

RESTAURANT FOR LEASE

FLOOR PLAN

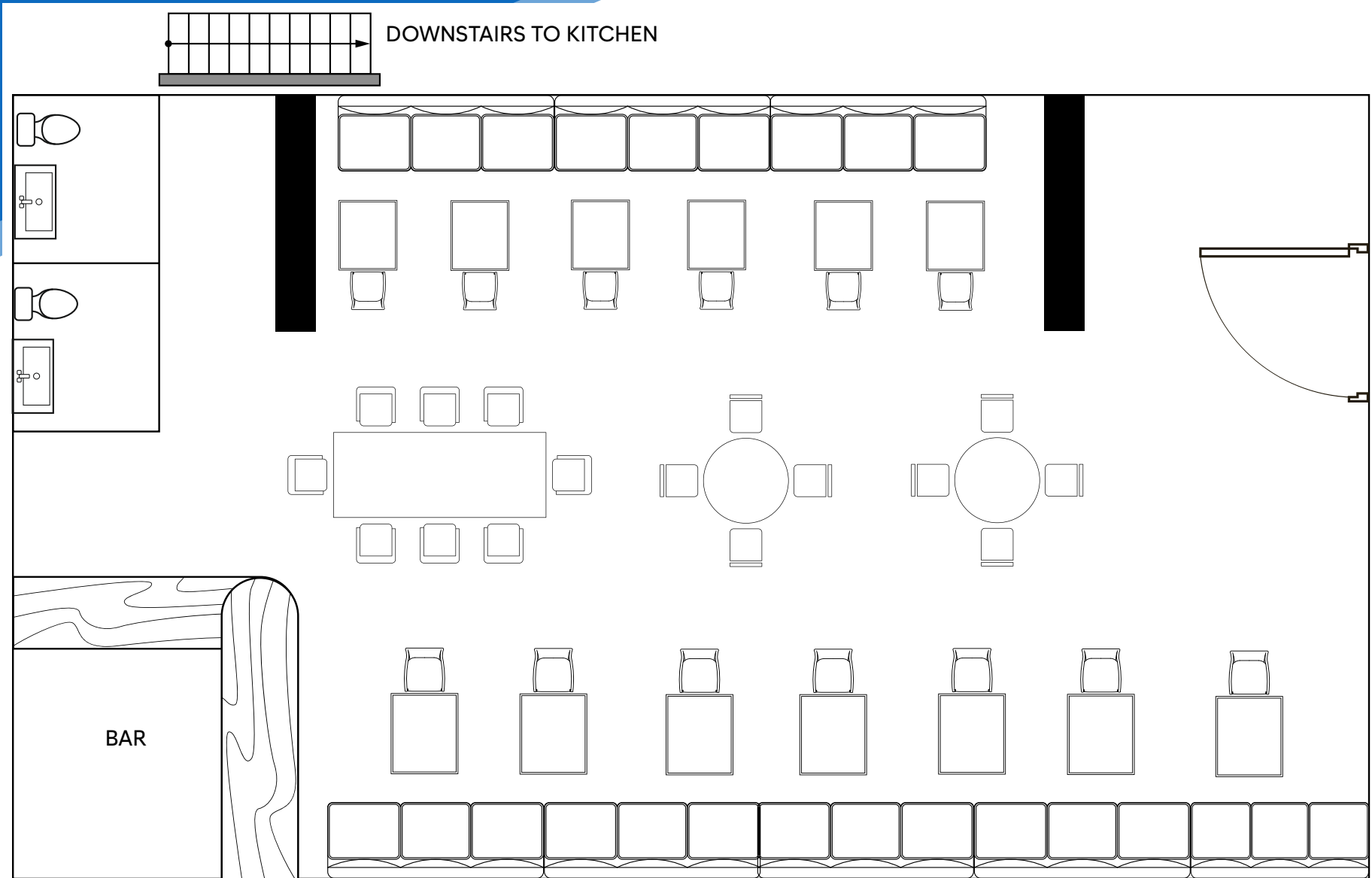

**NOAM AZIZ**  
Senior Director  
212.468.5984  
naziz@meridiancapital.com

**MAX FREUDENBERGER**  
Senior Associate  
212.468.5951  
mfreudenberg@meridiancapital.com

**CARSON SHAHRABANI**  
Senior Associate  
212.468.5927  
cshahrabani@meridiancapital.com



**MERIDIAN**  
RETAIL LEASING

All information supplied is from sources deemed reliable and is furnished subject to errors, omissions, modifications, removal of the listing from sale or lease, and to any listing conditions, including the rates and manner of payment of commissions for particular offerings imposed by Meridian Capital Group. This information may include estimates and projections prepared by Meridian Capital Group with respect to future events, and these future events may or may not actually occur. Such estimates and projections reflect various assumptions concerning anticipated results. While Meridian Capital Group believes these assumptions are reasonable, there can be no assurance that any of these estimates and projections will be correct. Therefore, actual results may vary materially from these estimates and projections. Any square footage dimensions set forth are approximate.

# 95 SECOND AVENUE

EAST VILLAGE, NYC | Between East 5<sup>th</sup> and 6<sup>th</sup> Streets

# RESTAURANT FOR LEASE



**95  
SECOND  
AVENUE**

NEIGHBORS

**NOAM AZIZ**  
Senior Director  
212.468.5984  
naziz@meridiancapital.com

**MAX FREUDENBERGER**  
Senior Associate  
212.468.5951  
mfreudenberger@meridiancapital.com

**CARSON SHAHRABANI**  
Senior Associate  
212.468.5927  
cshahrabani@meridiancapital.com



**MERIDIAN  
RETAIL LEASING**

All information supplied is from sources deemed reliable and is furnished subject to errors, omissions, modifications, removal of the listing from sale or lease, and to any listing conditions, including the rates and manner of payment of commissions for particular offerings imposed by Meridian Capital Group. This information may include estimates and projections prepared by Meridian Capital Group with respect to future events, and these future events may or may not actually occur. Such estimates and projections reflect various assumptions concerning anticipated results. While Meridian Capital Group believes these assumptions are reasonable, there can be no assurance that any of these estimates and projections will be correct. Therefore, actual results may vary materially from these estimates and projections. Any square footage dimensions set forth are approximate.