



900 E 75TH

INDUSTRIAL LAND FOR SALE • BUILD-TO-SUIT • BUILD-TO-OWN

DENVER



70TH AVE INTERCHANGE

WASHINGTON ST

SITE

900 East 75th Avenue,
Denver, CO 80229



Jordon Perlmutter & Co.



INDUSTRIAL LAND FOR SALE • BUILD-TO-SUIT • BUILD-TO-OWN

Property Highlights

- 46,810 – 73,620 SF available
- Up to 1.52 Acres of Outdoor Storage Possible
- Site size: 4.39 AC
- Building signage available
- Adams County Enterprise Zone
- I-1 zoning
- Clear heights up to 32'
- Immediate access to I-25, I-76, US-36 and I-270

Three Flexible Paths Forward

900 E 75th offers flexible solutions tailored to industrial users, investors and owner/occupiers. Opportunities include industrial land for sale, build-to-suit configurations and build-to-own options with scalable site planning and outdoor storage capability.



INDUSTRIAL LAND FOR SALE • BUILD-TO-SUIT • BUILD-TO-OWN

Option 1 - 46,810 SF with 0.933 Acres of Outdoor Storage

- 0.933 AC Outside Storage
- 14 Dock-High Doors
- 4 Grade-Level Doors
- 32' Clear Height
- Sprinkler: ESFR
- Parking: 28 Spaces

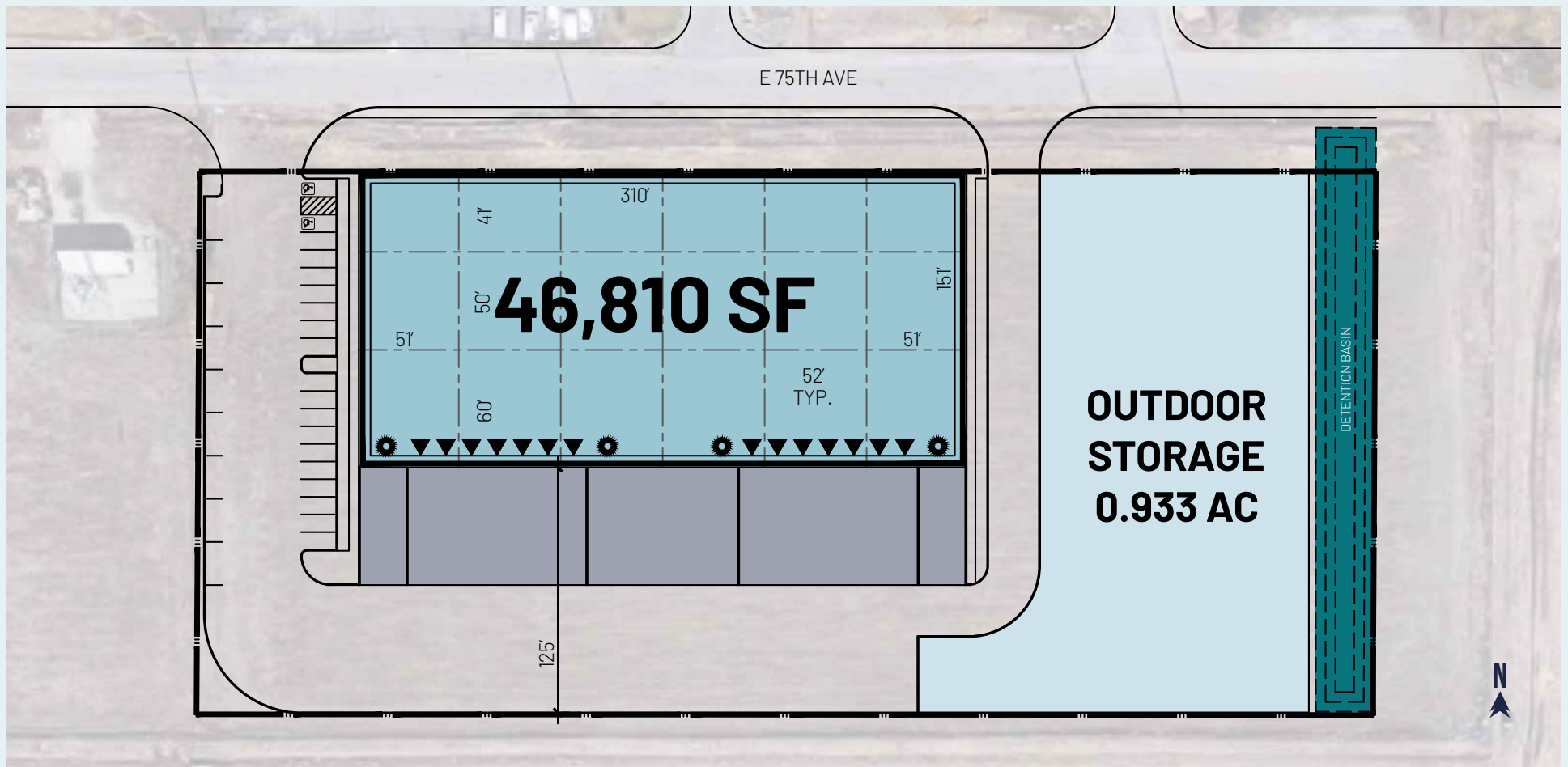

INDUSTRIAL LAND FOR SALE • BUILD-TO-SUIT • BUILD-TO-OWN

Option 2 - 49,400 SF with 1.52 Acres of Outdoor Storage

- 66,000 SF (1.52 Acres) Outside Storage/Truck Court
- 10 Dock-High Doors
- 2 Grade-Level Doors
- 32' Clear Height
- Sprinkler: ESFR
- Parking: 1.0:1,000 SF

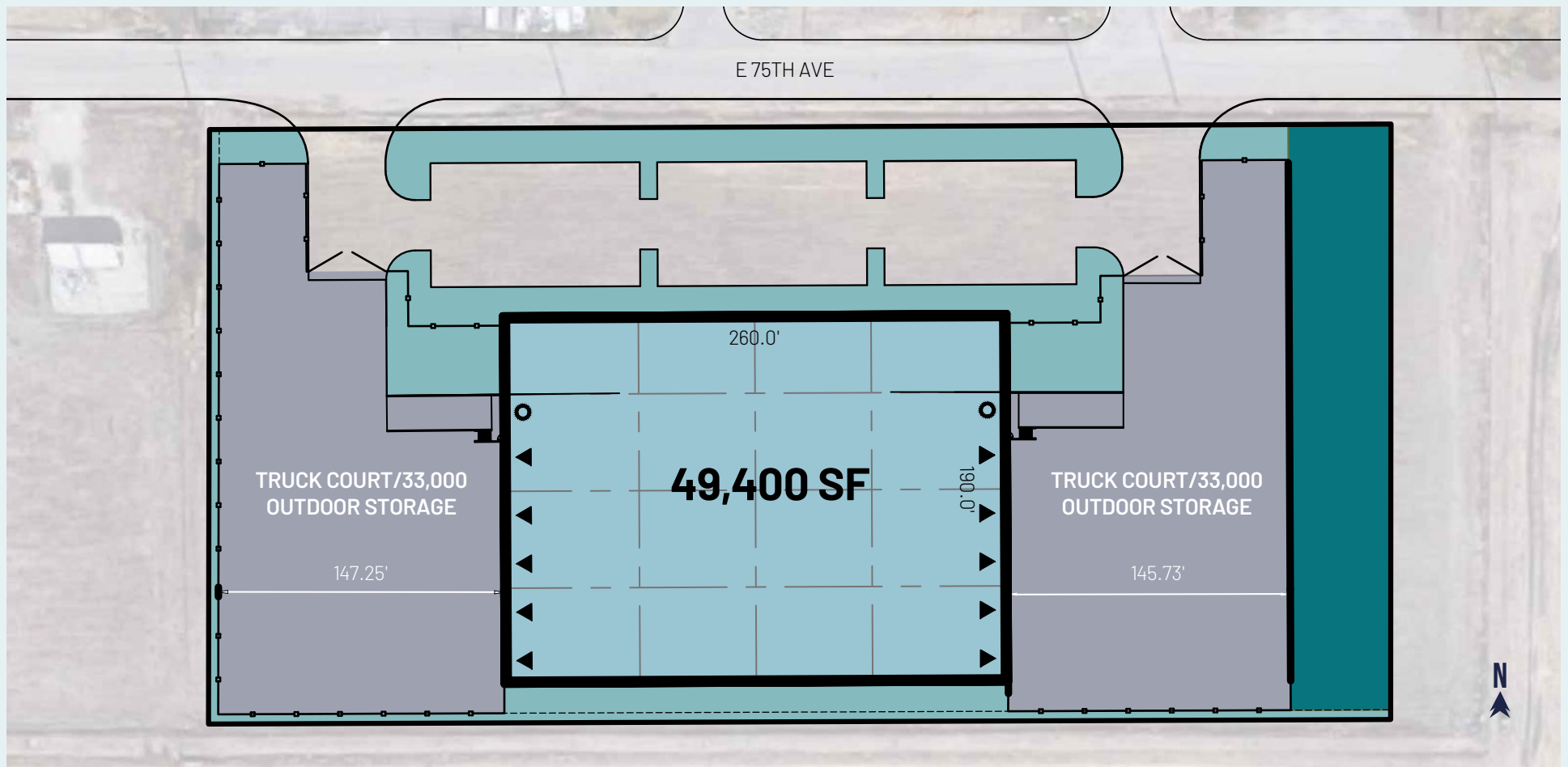

INDUSTRIAL LAND FOR SALE • BUILD-TO-SUIT • BUILD-TO-OWN

Option 3 - 73,620 SF

- 11 Dock-High Doors
- 2 Grade-Level Doors
- 32' Clear Height
- Sprinkler: ESFR
- 81 Car Parking, 3 Trailers

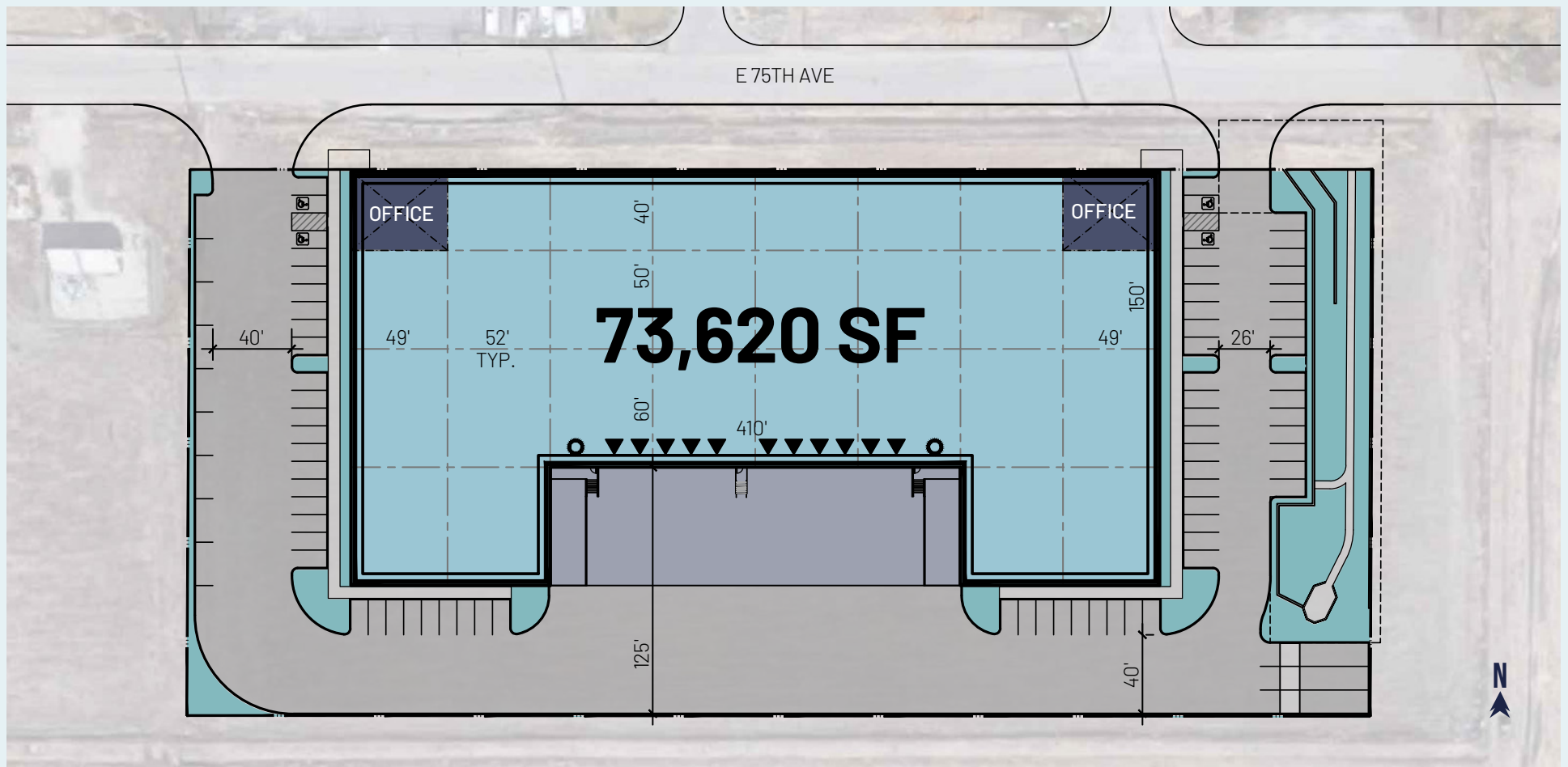

STRATEGIC ACCESS

Located within Denver's north-central industrial corridor, 900 E 75th provides immediate access to I-25, I-76, I-270 and US-36, connecting users efficiently across the Denver metro and Front Range region.

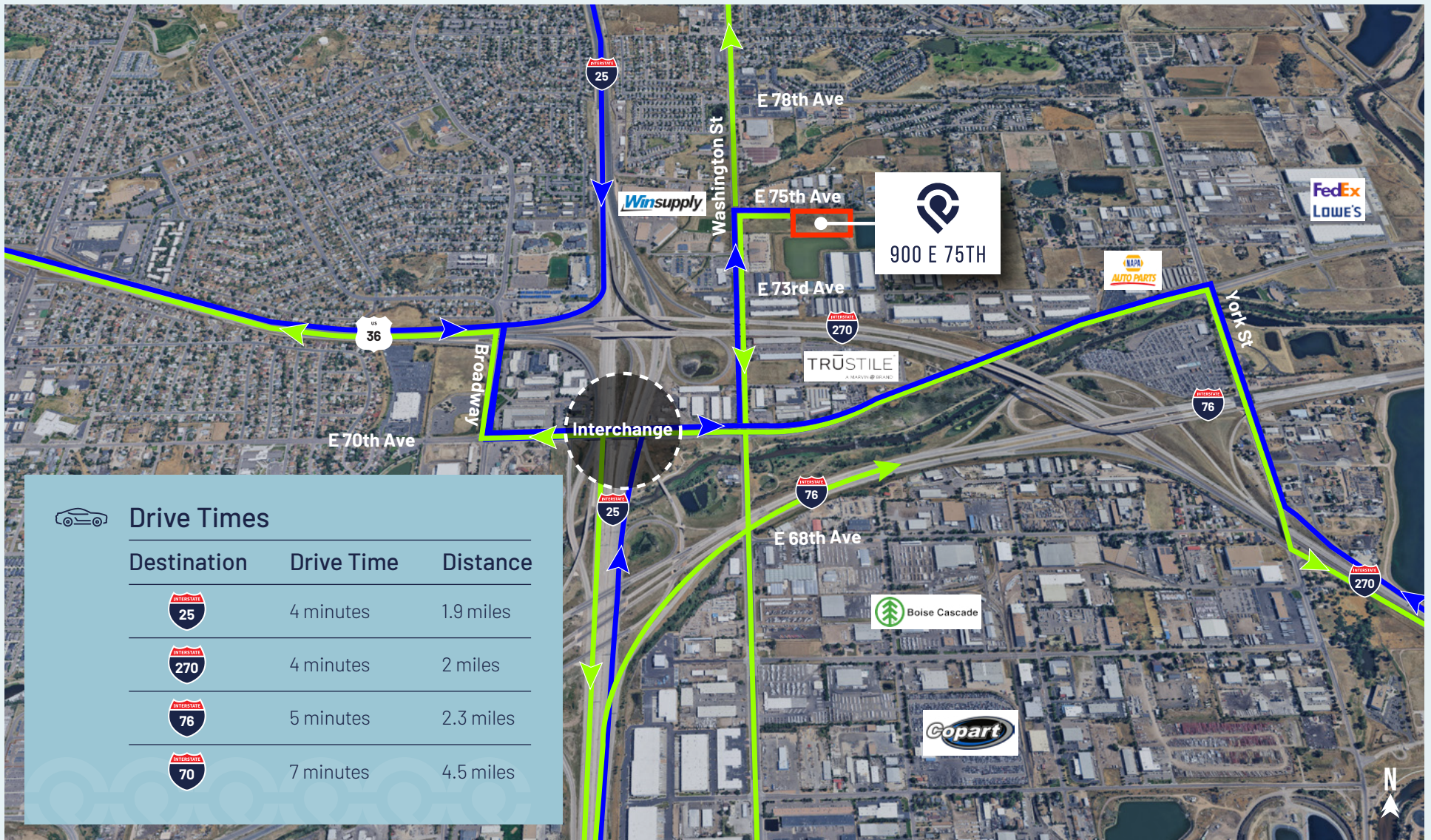

CONNECTED TO EVERYTHING

900 E 75th is centrally located in the metro, offering exceptional connectivity to workforce populations, major highways and the region's key business hubs.

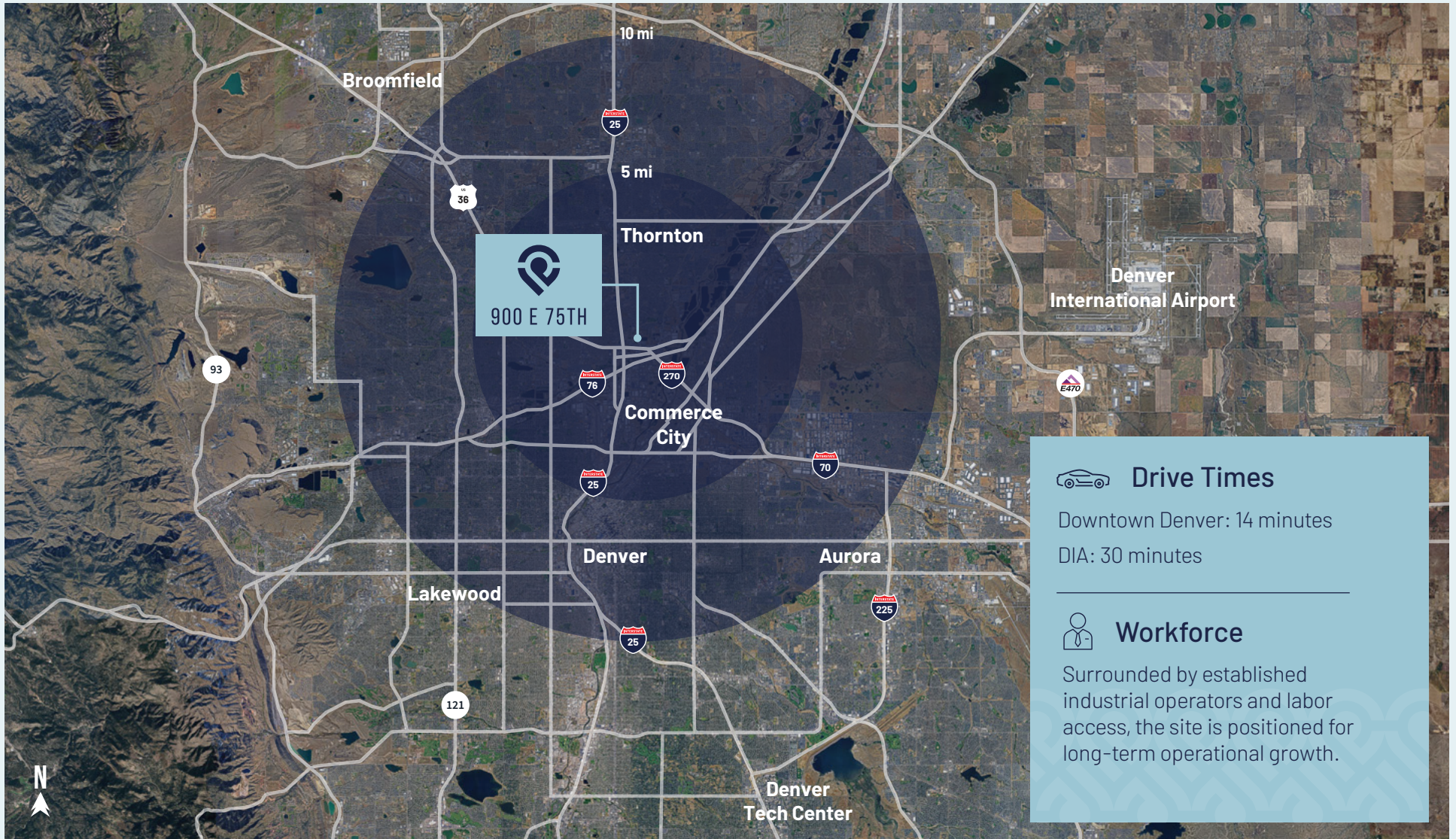

DENVER



For more information, please contact:

Jason Addlesperger
+1 720-217-3403
jason.addlesperger@jll.com

David Lee
+1 720-217-7223
david.lee1@jll.com

Philip Lee
+1 303-257-5915
philip.lee1@jll.com



Jordan Perlmutter & Co.



Although information has been obtained from sources deemed reliable, neither Owner nor JLL makes any guarantees, warranties or representations, express or implied, as to the completeness or accuracy as to the information contained herein. Any projections, opinions, assumptions or estimates used are for example only. There may be differences between projected and actual results, and those differences may be material. The Property may be withdrawn without notice. Neither Owner nor JLL accepts any liability for any loss or damage suffered by any party resulting from reliance on this information. If the recipient of this information has signed a confidentiality agreement regarding this matter, this information is subject to the terms of that agreement. ©2026. Jones Lang LaSalle IP, Inc. All rights reserved.