

~ Prominent Retail Opportunity on McPhillips Street ~



FOR LEASE

2501 McPhillips Street

WINNIPEG, MB

BRETT CHARTIER, Associate Vice President, Sales & Leasing
(204) 985-1366

brett.chartier@capitalgrp.ca

Services provided by Brett Chartier Personal Real Estate Corporation

PRESLEY BORDIAN, Vice President, Sales & Leasing
(204) 985-1356

presley.bordian@capitalgrp.ca

Capital
COMMERCIAL REAL ESTATE
SERVICES INC.

capitalgrp.ca

Property Details

AREA AVAILABLE (+/-)	Unit 301: 1,409 sq. ft. Leased Unit 401: 1,409 sq. ft. Leased Unit 501: 1,428 sq. ft.
NET RENTAL RATE	Starting at \$34.00 per sq. ft.
ADDITIONAL RENT	\$6.99 per sq. ft. plus 5% mgmt. fee (est. 2026)
PYLON SIGN RENTAL	\$125-\$250/month (subject to availability)
AVAILABILITY	Immediately

PROPERTY HIGHLIGHTS

- End cap unit facing McPhillips Street
- Ready for Tenant fixturing
- Excellent exposure on McPhillips Street
- Pylon Signage Available
- Ample on-site Parking



Site Plan

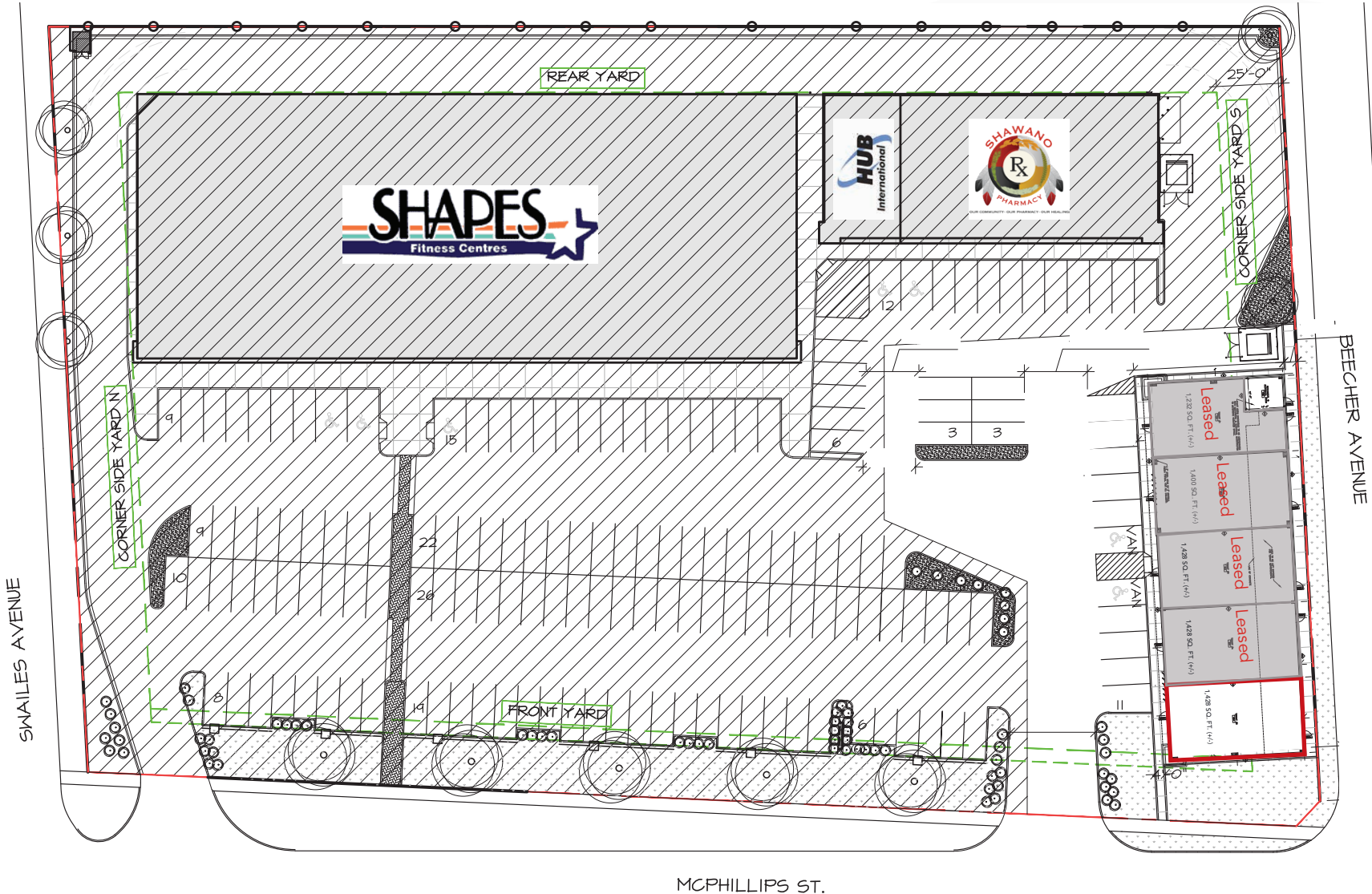

MCPHILLIPS ST.

Floor Plan

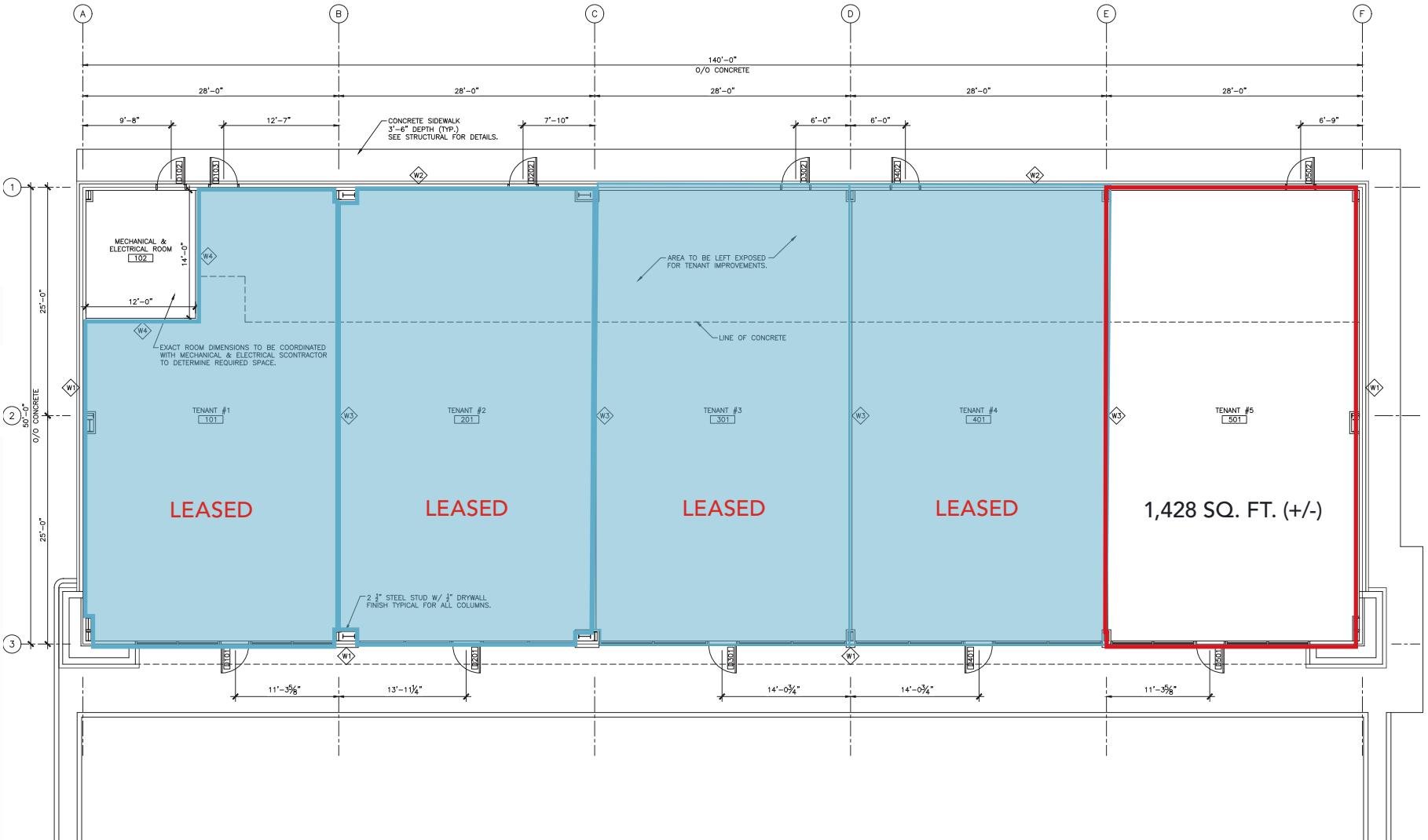

Retail Aerial

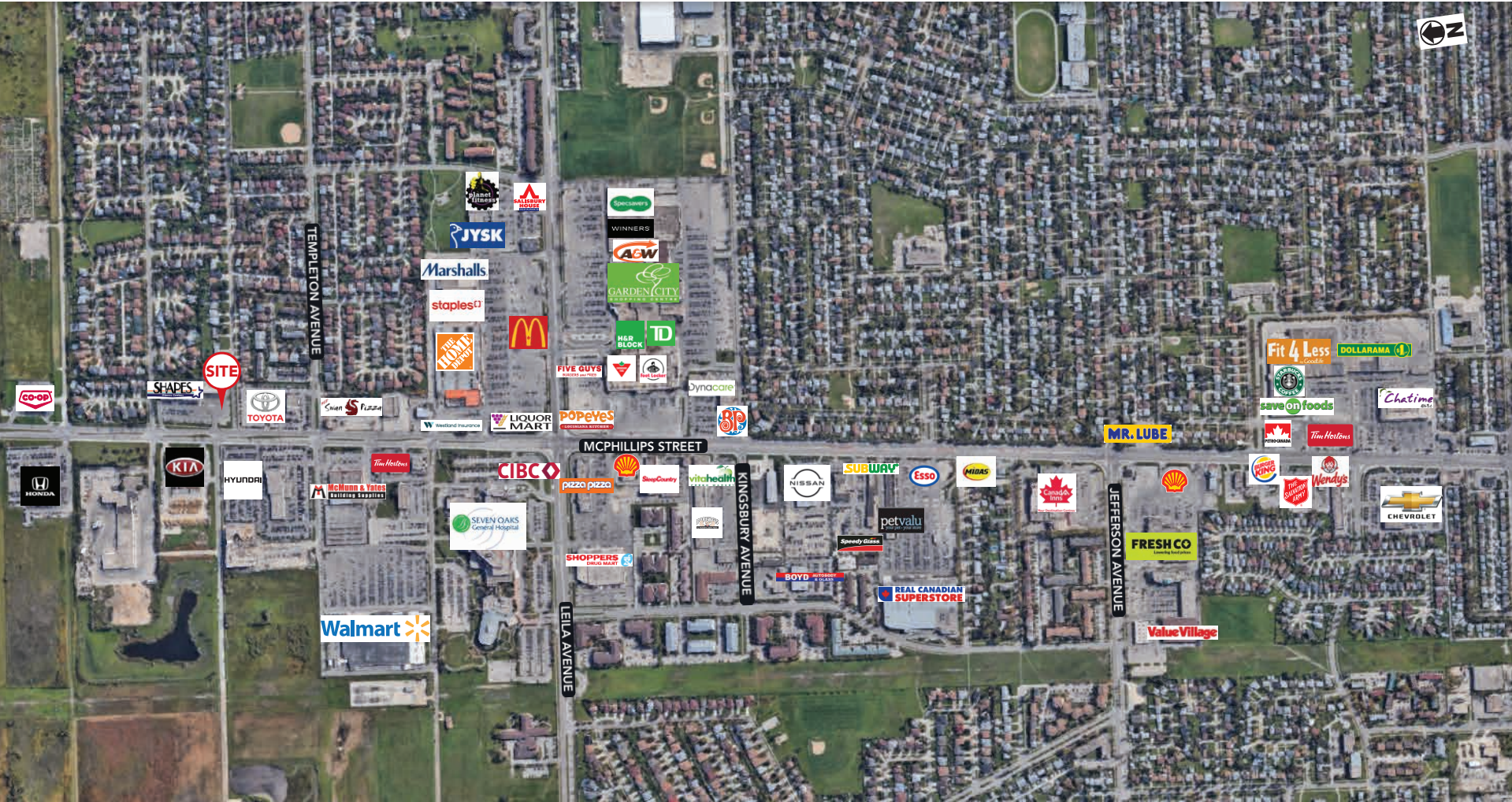

Demographic Analysis



POPULATION

TOTAL POPULATION

1 km	3 km	5 km
7,022	66,027	164,594

PROJECTED POPULATION (2029)

8,587	71,517	173,740
-------	--------	---------



MEDIAN AGE

MEDIAN AGE

1 km	3 km	5 km
33.7	35.6	36.6



HOUSEHOLD INCOME

AVG. HOUSEHOLD INCOME

1 km	3 km	5 km
\$98,826	\$106,986	\$100,383

PROJ. HOUSEHOLD INCOME (2029)

\$117,362	\$125,792	\$117,998
-----------	-----------	-----------



HOUSEHOLDS

TOTAL HOUSEHOLDS

1 km	3 km	5 km
2,572	22,435	59,232

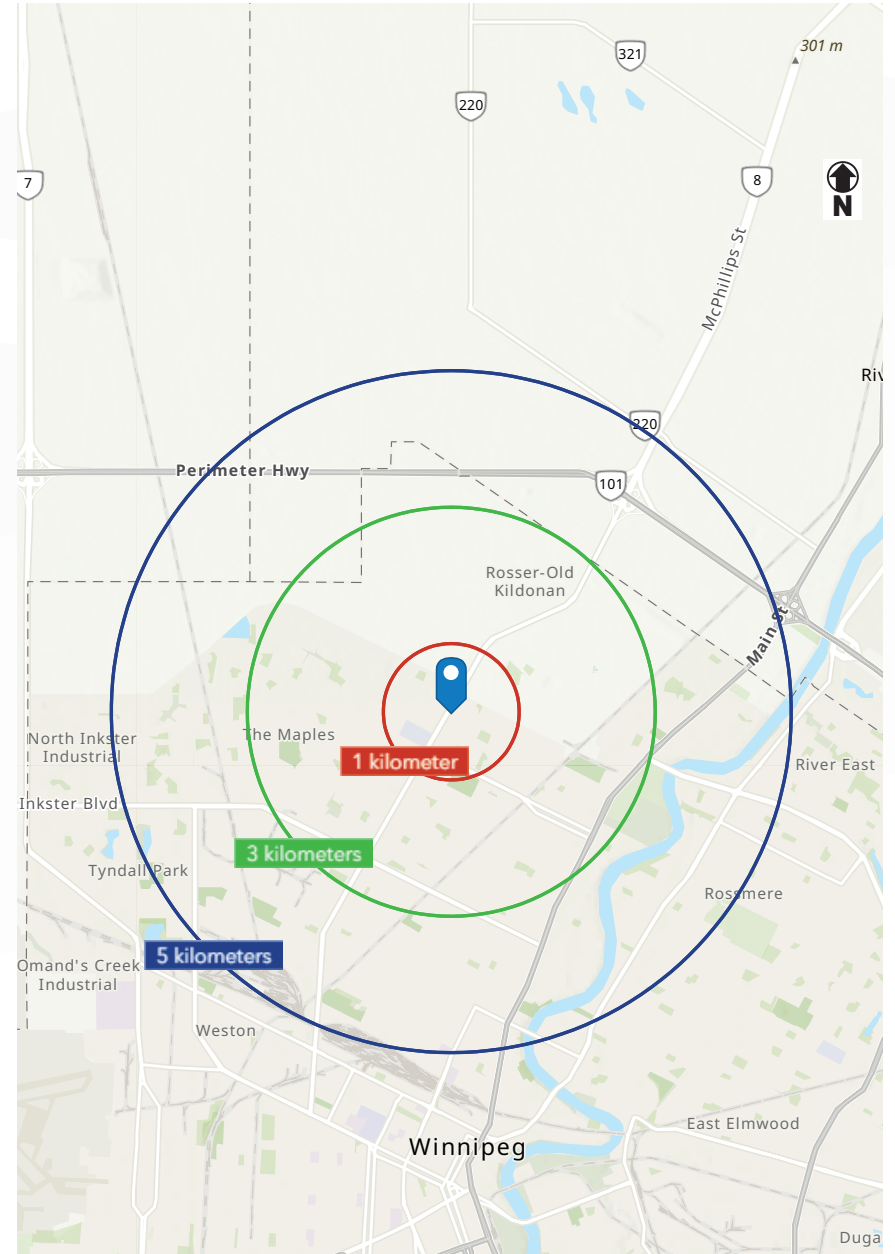



COMMERCIAL REAL ESTATE
SERVICES INC.

Contact

BRETT CHARTIER, Associate Vice President, Sales & Leasing

(204) 985-1366

brett.charteir@capitalgrp.ca

Services provided by Brett Chartier Personal Real Estate Corporation

PRESLEY BORDIAN, Vice President, Sales & Leasing

(204) 985-1356

presley.bordian@capitalgrp.ca

CAPITAL COMMERCIAL REAL ESTATE SERVICES INC.

300-570 Portage Avenue, Winnipeg, MB R3C 0G4 | T (204) 943-5700 | F (204) 956-2783 | capitalgrp.ca

Disclaimer: Capital Commercial Real Estate Services Inc. ("Capital") does not accept or assume any responsibility or liability, direct or consequential, for the information set out herein, including, without limitation, any projections, images, opinions, assumptions and estimates obtained from third parties. This information has not been verified by Capital, and Capital does not guarantee the accuracy, correctness and completeness of this information. The recipient of this information should take such steps as the recipient may deem necessary to verify the information in this document prior to placing any reliance upon it. The information may change and any property described in this document may be withdrawn from the market at any time without notice or obligation to the recipient from Capital.