

NEW CONSTRUCTION DOWNTOWN NAMPA OFFICE/RETAIL SPACE FOR LEASE

ALLIANCE TITLE BUILDING | 216 13TH AVE S | NAMPA, ID 83651

SITE



**ON-SITE
PARKING**

**OFFICE/RETAIL PAD
READY FOR BTS**

READY FOR OCCUPANCY!

SEAN EDWARDS
208.412.7763
sean@tokcommercial.com

HIGHLIGHTS

- Brand new, rare, Downtown Nampa office/retail space.
- High quality open floorplans.
- Easy access to services.
- Ample on-site parking.
- Tenant improvement allowance available.
- Ready to occupy!**
- ±5,000 SF office/retail pad can support a potential ±13,400 SF building.**

DETAILS

SPACE	SIZE	LEASE RATE
Basement	±2,909 SF	Contact Agent
Office/Retail Pad	±13,400 SF	Contact Agent

AVAILABLE:	Immediately	LEASE TERM:	3+ Years
BLDG. TYPE:	Office/Retail	LEASE TYPE:	FSEJ
PARKING:	Ample	ZONING:	DH

CONTACT



UPDATED: 3.19.2026

THIS PROPERTY IS EXCLUSIVELY MARKETED BY TOK BOISE LLC DBA TOK COMMERCIAL
This information was obtained from sources believed reliable but cannot be guaranteed. Any opinions or estimates are used for example only.

FLOOR PLAN

OPEN BASEMENT

**BASEMENT TO BE FINISHED TO A HIGH QUALITY,
PROFESSIONAL STANDARD**

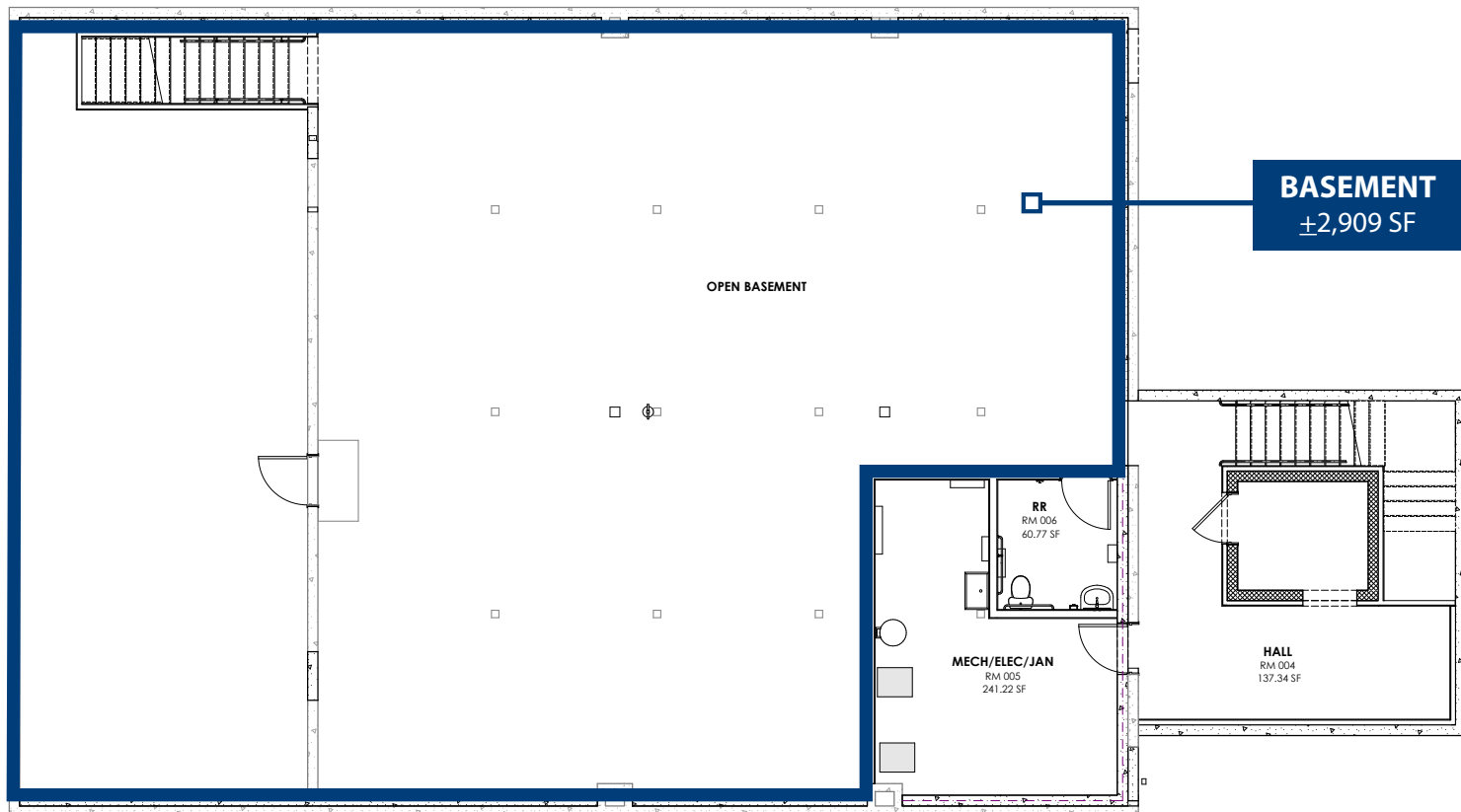

UPDATED: 3.19.2026

THIS PROPERTY IS EXCLUSIVELY MARKETED BY TOK BOISE LLC DBA TOK COMMERCIAL

This information was obtained from sources believed reliable but cannot be guaranteed. Any opinions or estimates are used for example only.

PROPOSED BUILDING
FOOTPRINT CAN BE EXPANDED



PROPOSED BUILD-TO-SUIT RENDERING

UPDATED: 3.19.2026

THIS PROPERTY IS EXCLUSIVELY MARKETED BY TOK BOISE LLC DBA TOK COMMERCIAL

This information was obtained from sources believed reliable but cannot be guaranteed. Any opinions or estimates are used for example only.

TOKCOMMERCIAL.COM



NAMPA-CALDWELL BLVD

NAMPA-CALDWELL BLVD

2ND ST S

4,503 VPD

216-224 13TH AVE

13TH AVE S

4,333 VPD

3RD ST S

GREAT ACCESSIBILITY FROM MAIN ARTERIALS

STRATEGICALLY LOCATED IN DOWNTOWN CORE



POPULATION	TOTAL HOUSEHOLD EXP.	AVG. HOUSEHOLD INC.
94,327	\$3.31B	\$92,566
3 MI. RADIUS	3 MI. RADIUS	3 MI. RADIUS

TOK
COMMERCIAL

UPDATED: 3.19.2026

THIS PROPERTY IS EXCLUSIVELY MARKETED BY TOK BOISE LLC DBA TOK COMMERCIAL
This information was obtained from sources believed reliable but cannot be guaranteed. Any opinions or estimates are used for example only.

TOKCOMMERCIAL.COM



SITE

NORTHSIDE & CALDWELL BLVD

- Best Western PLUS
- Best Buy
- AT&T
- LES SCHWAB
- Orca boost
- Shell
- Sinclair
- BURGER KING
- SUBWAY
- Great Clips
- McDonald's
- Fred Meyer
- Los Berrys
- CHASE

LAKE LOWELL AVE & 12TH

- True Value
- Jiffy Lube
- Bi-MART
- Walmart
- GameStop
- Supercuts
- Walmart
- GameStop
- Supercuts
- Walmart
- GameStop
- Supercuts

GREENHURST & 12TH

- Walmart
- GameStop
- Supercuts
- Walmart
- GameStop
- Supercuts
- Walmart
- GameStop
- Supercuts

NORTH 12TH CORRIDOR

- US Bank
- cricket
- FAMILY DOLLAR
- Walmart
- Walmart
- Walmart
- Walmart
- Walmart
- Walmart
- Walmart
- Walmart

IOWA & 12TH

- BLIMPIE
- SONIC
- DQ
- McDonald's
- AutoZone
- Carls Jr.
- Starbucks
- ROLAGIER BANK
- DOLLAR TREE
- Starbucks
- Starbucks

CONNECTION POINT TO MAJOR CORRIDORS

TOK
COMMERCIAL

UPDATED: 3.19.2026
THIS PROPERTY IS EXCLUSIVELY MARKETED BY TOK BOISE LLC DBA TOK COMMERCIAL
This information was obtained from sources believed reliable but cannot be guaranteed. Any opinions or estimates are used for example only.