

MEDICAL | PROFESSIONAL OFFICE SUITE

SUBLEASE





OFFERING SUMMARY

Available SF for Lease	1,551 - 4,927 SF
Lease Rate	\$17.95 per SF/year
Lease Type	NNN
CAM	\$3.60 per SF
Zoning	Economic Development
Municipality	Straban Township
County	Adams County



PROPERTY OVERVIEW

Located conveniently off Route 30 in Gettysburg, PA, this well-established medical/office center offers an ideal spot for your business. Surrounded by prominent businesses such as Battlefield Harley-Davidson, Renn Kirby Kia, Tractor Supply Co, Wyndham of Gettysburg, Panera Bread, and Sheetz, all within a mile radius, this property ensures high visibility and accessibility. Home to a community of reputable medical and professional tenants, the center provides modern facilities with state-of-the-art infrastructure ideal for medical practices and office use. Situated on a major thoroughfare, it offers easy access for clients and employees, ample parking, and benefits from high foot traffic.

PROPERTY HIGHLIGHTS

- Class A Medical/Office Space
- Furniture available with lease
- Highly trafficked medical office

NEIGHBORING TENANTS INCLUDE:



**PENNSYLVANIA
CANCER SPECIALISTS**
Research Institute



20 EXPEDITION TRAIL, GETTYSBURG, PA 17325

MEDICAL | PROFESSIONAL OFFICE

SUBLEASE



PROPERTY DETAILS

Building Size	57,930 SF
Lot Size	5.61 AC
Building Class	A
Tenancy	Multi
Number of Floors	2
Restrooms	In-Suite
Parking	In-Common 160 Spaces
Year Built	2007

BUILDING SPECIFICATIONS

Construction	Masonry
Roof Type	Flat / Rubber
Power	N/A
HVAC	N/A
Sprinklers	Yes
Security	Yes
Signage	Yes

MARKET DETAILS

Cross Streets	Expedition Trl & V-Twin Dr.
Traffic Count at Intersection	9,291 ADT (Route 30/Route 15 Exit)
Municipality	Straban Township
County	Adams County
Zoning	Economic Development

LANDMARK COMMERCIAL REALTY
425 N 21ST STREET, SUITE 302
CAMP HILL, PA 17011
P : 717.731.1990

SEAN FITZSIMMONS
DIRECTOR, SALES & LEASING
SEAN@LandmarkCR.com
C: 717.421.6031

MICHAEL CURRAN, SIOR
PRES. & EXEC. MANAGING PRINCIPAL
MCURRAN@LandmarkCR.com
C: 717.805.9277

TREY BRAKEFIELD
ASSOCIATE
TBRAKEFIELD@LandmarkCR.com
C: 717.524.9852

LANDMARKCR.COM



20 EXPEDITION TRAIL, GETTYSBURG, PA 17325

MEDICAL | PROFESSIONAL OFFICE

SUBLEASE



ADDITIONAL PHOTOS

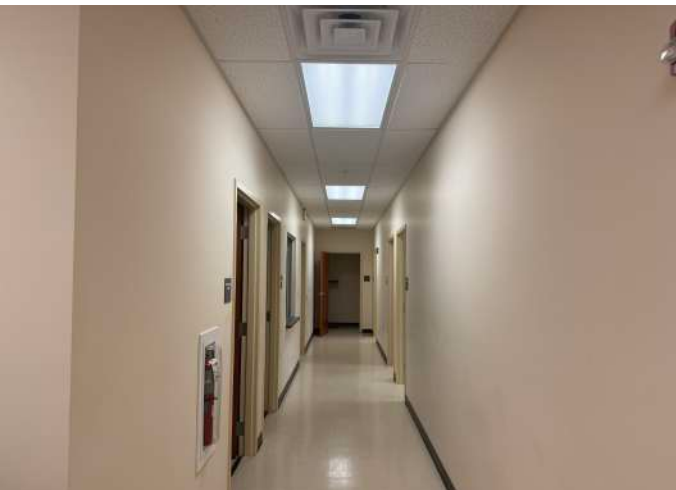

LANDMARK COMMERCIAL REALTY

SEAN FITZSIMMONS
DIRECTOR, SALES & LEASING
SEAN@LandmarkCR.com
C: 717.421.6031

MICHAEL CURRAN, SIOR
PRES. & EXEC. MANAGING PRINCIPAL
MCURRAN@LandmarkCR.com
C: 717.805.9277

TREY BRAKEFIELD
ASSOCIATE
TBRAKEFIELD@LandmarkCR.com
C: 717.524.9852





SUITE 105

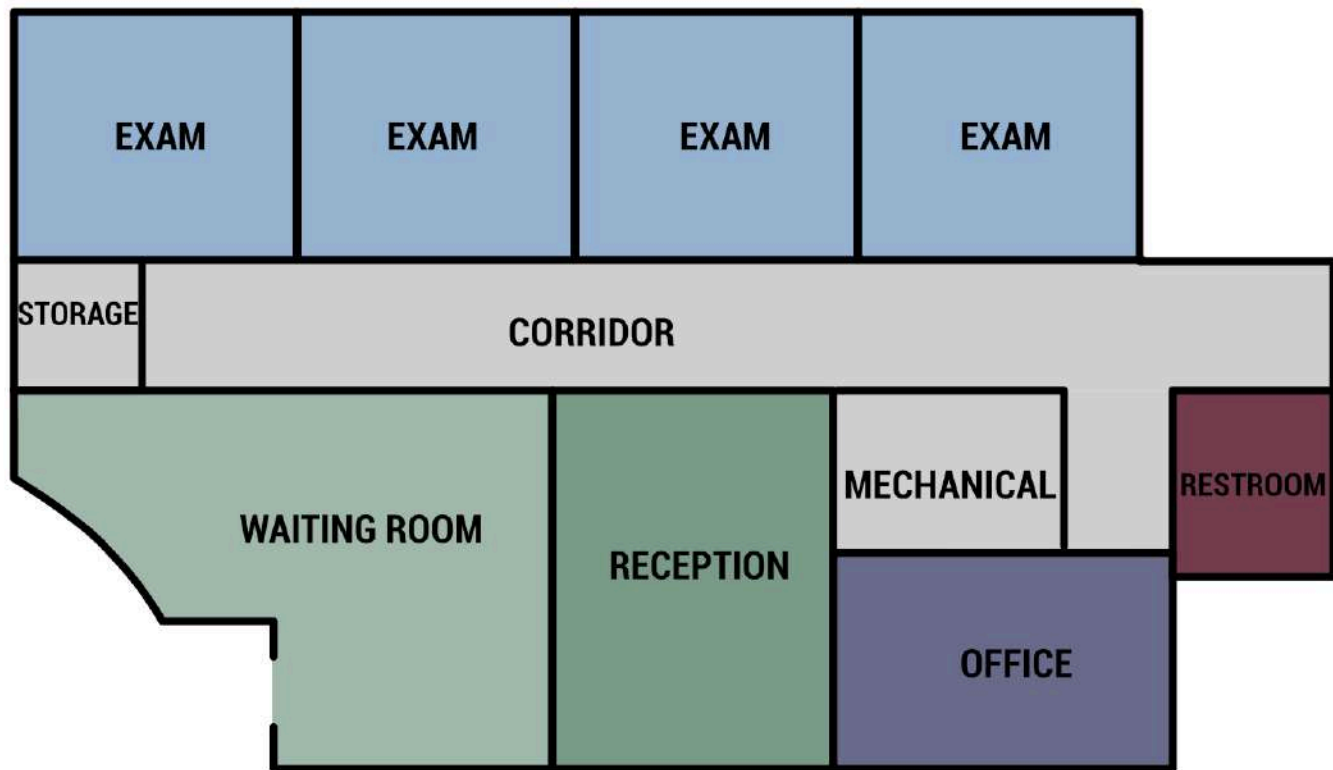
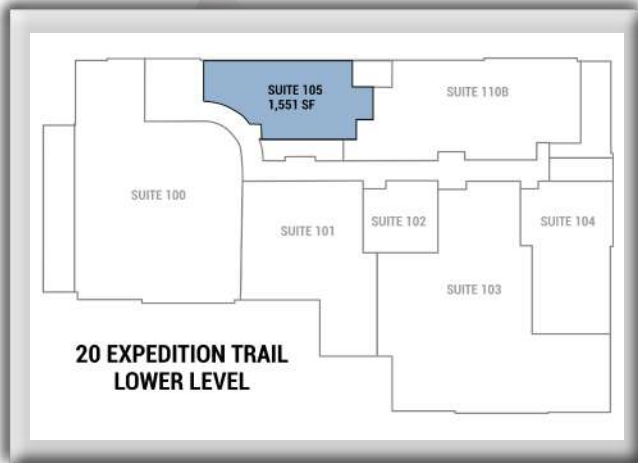

SUITE	AVAILABLE SF	LEASE RATE	LEASE TYPE	CAM	DESCRIPTION
105	1,551 SF	\$17.95 per SF/Yr	NNN Lease	\$3.60 per SF	Private office, in-suite restroom, multiple exam rooms, waiting area and reception area.



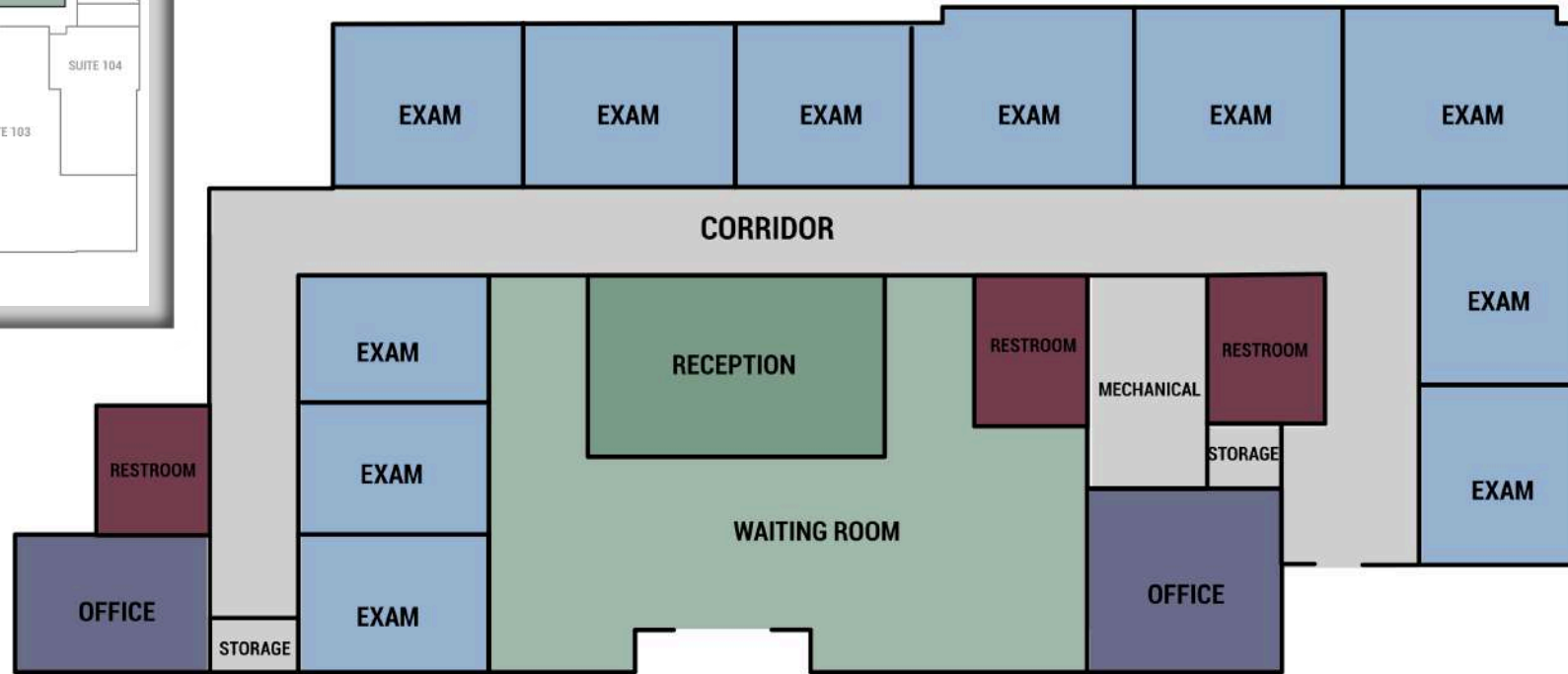
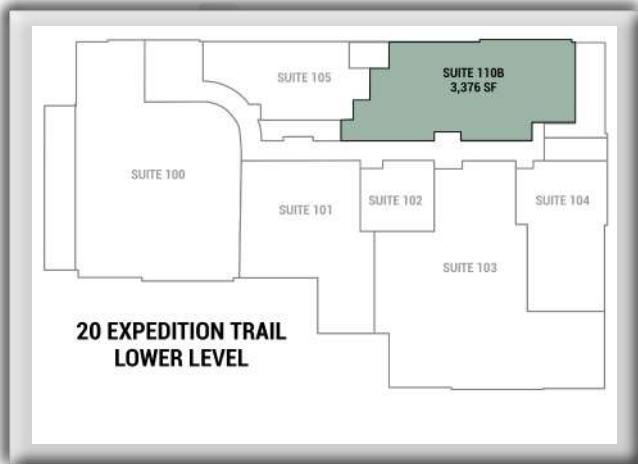

SUITE	AVAILBLE SF	LEASE RATE	LEASE TYPE	CAM	DESCRIPTION
110B	3,376 SF	\$17.95 per SF/Yr	NNN Lease	\$3.60 per SF	Reception & Waiting Area, 2 private offices, 3 in-suite restrooms, multiple exam rooms, storage

LANDMARK COMMERCIAL REALTY
425 N 21ST STREET, SUITE 302
CAMP HILL, PA 17011
P : 717.731.1990

SEAN FITZSIMMONS
DIRECTOR, SALES & LEASING
SEAN@LandmarkCR.com
C: 717.421.6031

MICHAEL CURRAN, SIOR
PRES. & EXEC. MANAGING PRINCIPAL
MCURRAN@LandmarkCR.com
C: 717.805.9277

TREY BRAKEFIELD
ASSOCIATE
TBRAKEFIELD@LandmarkCR.com
C: 717.524.9852



20 EXPEDITION TRAIL, GETTYSBURG, PA 17325

MEDICAL | PROFESSIONAL OFFICE

SUBLEASE

LOCATION



LANDMARK COMMERCIAL REALTY

SEAN FITZSIMMONS

MICHAEL CURRAN, SIOR

TREY BRAKEFIELD

425 N 21ST STREET, SUITE 302
CAMP HILL, PA 17011

DIRECTOR, SALES & LEASING

PRES. & EXEC. MANAGING PRINCIPAL

ASSOCIATE

P : 717.731.1990

SEAN@LandmarkCR.com

MCURRAN@LandmarkCR.com

TBRAKEFIELD@LandmarkCR.com

C : 717.421.6031

C : 717.805.9277

C : 717.524.9852



20 EXPEDITION TRAIL, GETTYSBURG, PA 17325

MEDICAL | PROFESSIONAL OFFICE

SUBLEASE

AREA

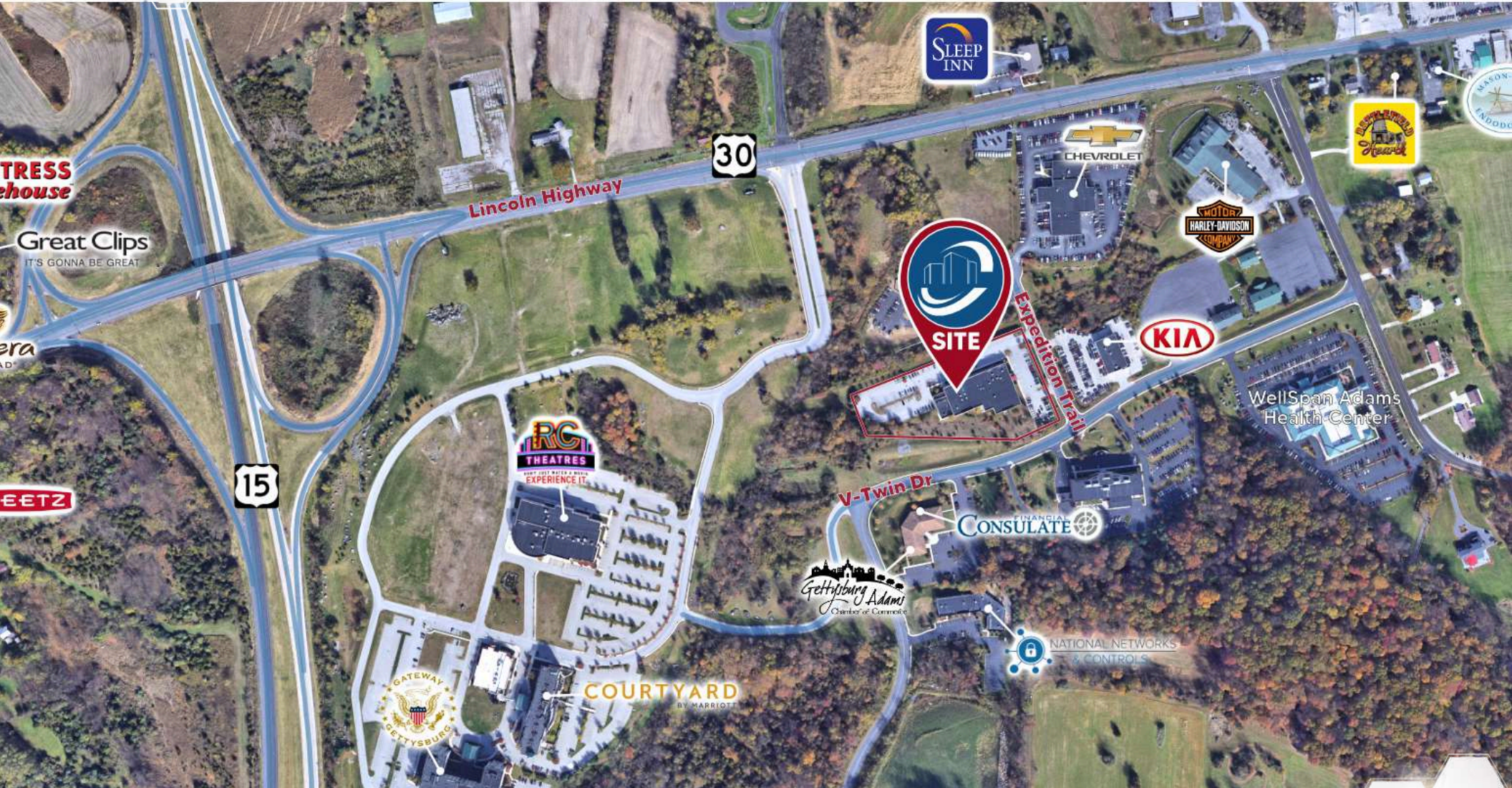

LANDMARK COMMERCIAL REALTY
425 N 21ST STREET, SUITE 302
CAMP HILL, PA 17011
P : 717.731.1990

SEAN FITZSIMMONS
DIRECTOR, SALES & LEASING
SEAN@LandmarkCR.com
C: 717.421.6031

MICHAEL CURRAN, SIOR
PRES. & EXEC. MANAGING PRINCIPAL
MCURRAN@LandmarkCR.com
C: 717.805.9277

TREY BRAKEFIELD
ASSOCIATE
TBRAKEFIELD@LandmarkCR.com
C: 717.524.9852



LANDMARKCR.COM



POPULATION

1 MILE	313
2 MILE	13,398
3 MILE	25,175

HOUSEHOLDS

1 MILE	113
2 MILE	4,358
3 MILE	9,237

AVERAGE HOUSEHOLD INCOME

1 MILE	\$110,580
2 MILE	\$98,961
3 MILE	\$107,632

TOTAL BUSINESSES

1 MILE	64
2 MILE	800
3 MILE	1,173

TOTAL EMPLOYEES (DAYTIME POPULATION)

1 MILE	664
2 MILE	8,000
3 MILE	11,400

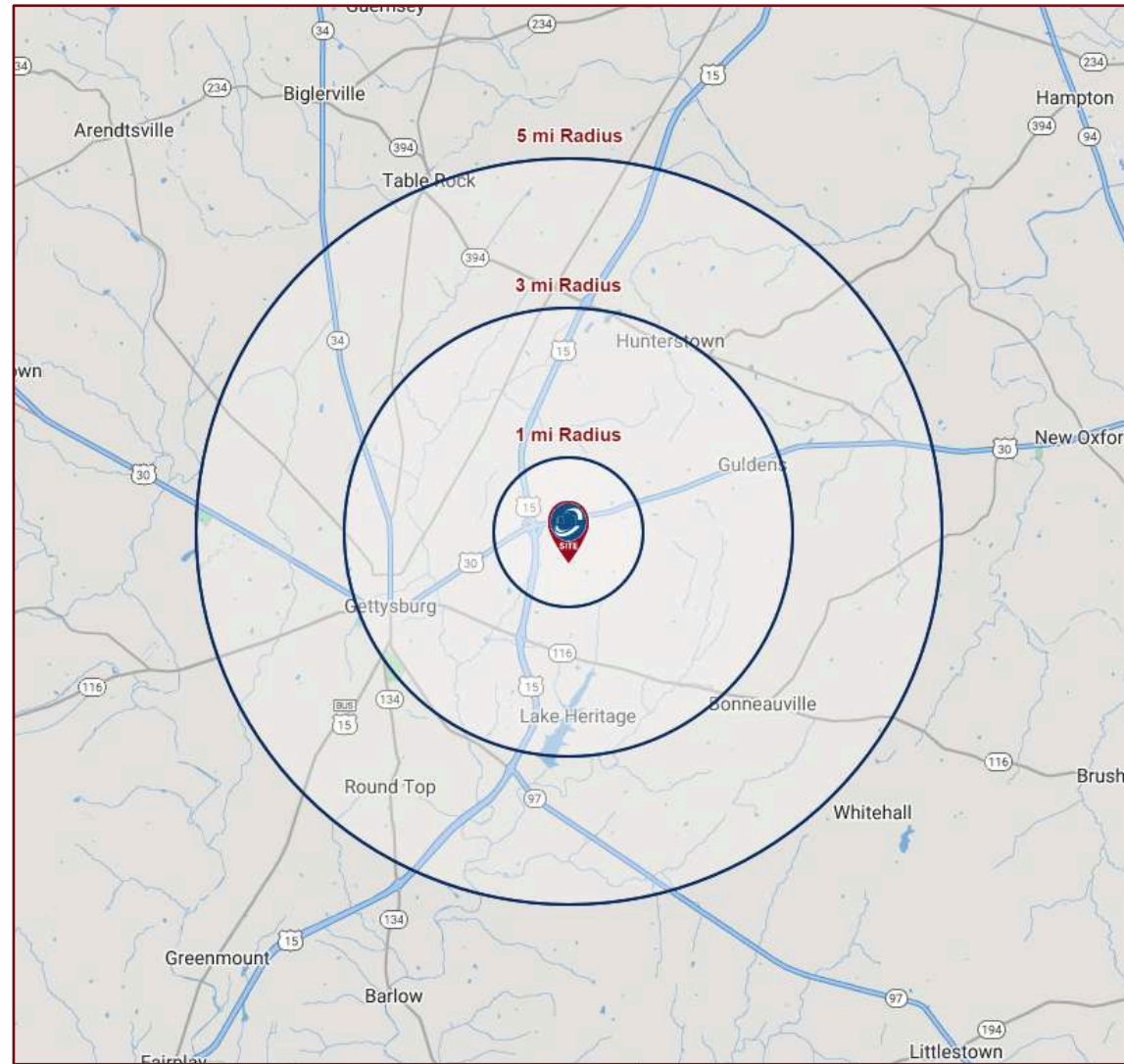



AREA OVERVIEW

ADAMS COUNTY is a county in the Commonwealth of Pennsylvania. As of the 2020 census, the population was 103,852. Its county seat is Gettysburg. The county was created on January 22, 1800, from part of York County, and was named for the second President of the United States, John Adams. On July 1–3, 1863, a crucial battle of the American Civil War was fought near Gettysburg; as a result is a center of Civil War tourism. Adams County comprises the Gettysburg metropolitan statistical area, which is also included in the Harrisburg–York–Lebanon combined statistical area.

The county has a total area of 522 square miles with the Borough of Gettysburg located at the center of Adams County. This county seat community is surrounded on three sides by the Gettysburg National Military Park (GNMP). The Eisenhower National Historic Site adjoins GNMP on its southwest edge. Most of Adams County's rural landscapes and its mid-19th century roadway pattern remain intact today. Thirteen historic roadways converge at or near Gettysburg Borough. Two circular rings of towns surround Gettysburg; the first is typically found at a distance of about 7 miles (11 km) from Gettysburg. The second ring is found at a distance of 12 to 15 miles (24 km) from the County Seat. This "spokes and wheel" pattern is one of the few examples of Central Place Theory in the Eastern United States. The county is in the watershed of the Chesapeake Bay and is drained by the Susquehanna and Potomac Rivers.

Gettysburg is a borough and the county seat of Adams County in the U.S. state of Pennsylvania. The Battle of Gettysburg (1863) and President Abraham Lincoln's Gettysburg Address are named for this town. Gettysburg is home to the Gettysburg National Military Park, where the Battle of Gettysburg was largely fought; the Battle of Gettysburg had the most casualties of any Civil War battle but was also considered the turning point in the war, leading to the Union's ultimate victory.



LANDMARK COMMERCIAL REALTY

425 N 21ST STREET, SUITE 302
CAMP HILL, PA 17011

P : 717.731.1990

SEAN FITZSIMMONS

DIRECTOR, SALES & LEASING

SEAN@LandmarkCR.com

C: 717.421.6031

MICHAEL CURRAN, SIOR

PRES. & EXEC. MANAGING PRINCIPAL

MCURRAN@LandmarkCR.com

C: 717.805.9277

TREY BRAKEFIELD

ASSOCIATE

TBRAKEFIELD@LandmarkCR.com

C: 717.524.9852



LANDMARKCR.COM



CONFIDENTIALITY & DISCLAIMER

All materials and information received or derived from Landmark Commercial its directors, officers, agents, advisors, affiliates and/or any third party sources are provided without representation or warranty as to completeness, veracity, or accuracy, condition of the property, compliance or lack of compliance with applicable governmental requirements, developability or suitability, financial performance of the property, projected financial performance of the property for any party's intended use or any and all other matters.

Neither Landmark Commercial its directors, officers, agents, advisors, or affiliates makes any representation or warranty, express or implied, as to accuracy or completeness of the any materials or information provided, derived, or received. materials and information from any source, whether written or verbal, that may be furnished for review are not a substitute for a party's active conduct of its own due diligence to determine these and other matters of significance to such party. Landmark Commercial will not investigate or verify any such matters or conduct due diligence for a party unless otherwise agreed in writing.

EACH PARTY SHALL CONDUCT ITS OWN INDEPENDENT INVESTIGATION AND DUE DILIGENCE.

Any party contemplating or under contract or in escrow for a transaction is urged to verify all information and to conduct their own inspections and Investigations including through appropriate third party independent professionals selected by such party. All financial data should be verified by the party including by obtaining and reading applicable documents and reports and consulting appropriate independent professionals. Landmark Commercial makes no warranties and/or representations regarding the veracity, completeness, or relevance of any financial data or assumptions. Landmark Commercial does not serve as a financial advisor to any party regarding any proposed transaction. All data and assumptions regarding financial performance, including that used for financial modeling purposes, may differ from actual data or performance. Any estimates of market rents and/or projected rents that may be provided to a party do not necessarily mean that rents can be established at or increased to that level. Parties must have evaluate any applicable contractual and governmental limitations as well as market conditions, vacancy factors and other issues in order to determine rents from or for the property.

Legal questions should be discussed by the party with an attorney. Tax questions should be discussed by the party with a certified public accountant or tax attorney. Title questions should be discussed by the party with a title officer or attorney. Questions regarding the condition of the property and whether the property complies with applicable governmental requirements should be discussed by the party with appropriate engineers, architects, contractors, other consultants and governmental agencies. All properties and services are marketed by Landmark Commercial in compliance with all applicable fair housing and equal opportunity laws.