

NOTE: THIS PLAT IS SUBJECT TO THE REQUIREMENTS ESTABLISHED ON THE WAIVER. WV. 9155 JULY, 1988

FRUIT

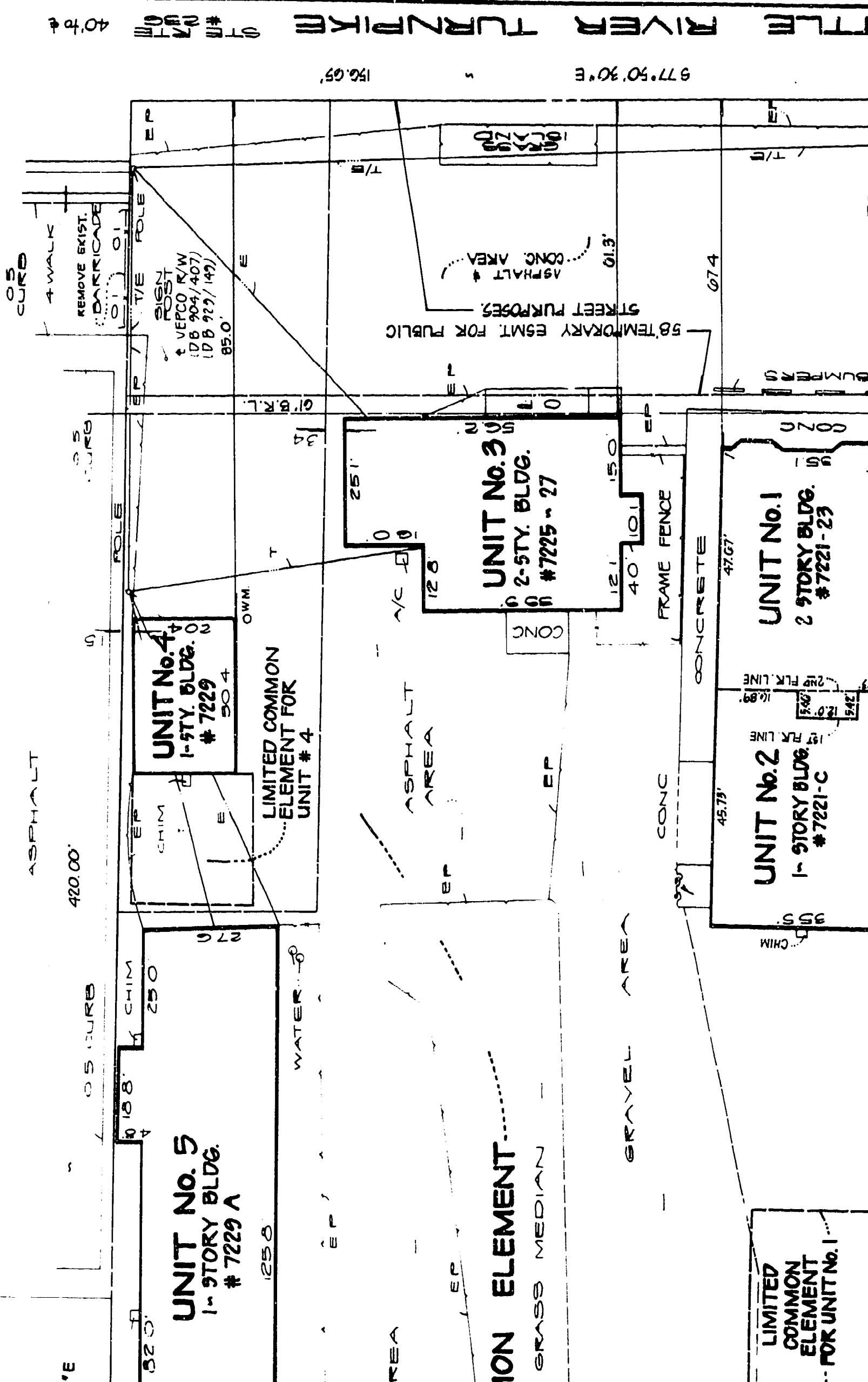

97.7° 50' 30" E
156.65'

58' TEMPORARY ESMT. FOR PUBLIC STREET PURPOSES.
ASPHALT & CONG. AREA
01.3'
67.4
67.4
VEPCO R/W (DB 904/407) (DB 929/149)
85.0'
SIGN POST
REMOVE EXIST. BARRICADE
WALK
CURB

UNIT No. 3
2-STY. BLDG.
7225 - 27
12.1' 40' 10.1' 15.0'
FRAME FENCE
CONC
LIMITED COMMON ELEMENT FOR UNIT # 4
OWM.
25.1' 12.8'

UNIT No. 4
1.5-STY. BLDG.
7229
30.4' 27.6'
CHIM
LIMITED COMMON ELEMENT FOR UNIT # 4
ASPHALT AREA
EP
CONC
CONCRETE
UNIT No. 1
1-STORY BLDG.
7221-C
45.73' 30.5' CHIM
UNIT No. 2
1-STORY BLDG.
7221-B
47.67' 16.89' CHIM
28' FLR. LINE
17' FLR. LINE

UNIT No. 5
1-STORY BLDG.
7229 A
125.8' 10.18' 4' 25.0'
CHIM
WATER
GRASS MEDIAN
GRAVEL AREA
CONC
LIMITED COMMON ELEMENT FOR UNIT No. 1

THE RIVER TURNPIKE

40' to E