

OVERALL SITE PLAN - OPTION_01

SITE AREA : +/- 23AC (1,000,307 SF)

BUILDING AREA : 180,000 SF

COVERAGE : 18.0%

PARKING : 408 SPACES @2.3/1000 SF

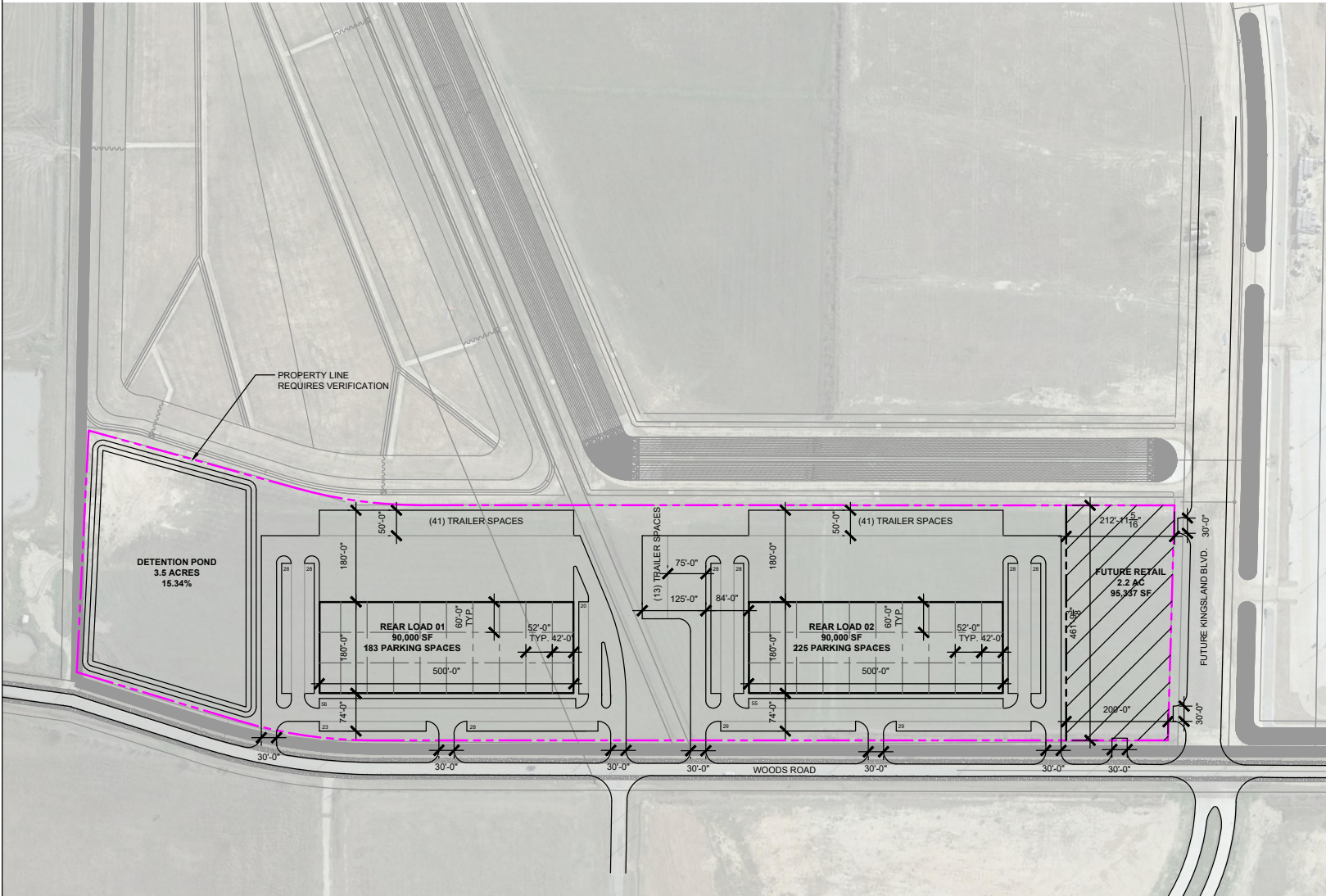

* PRELIMINARY NOT FOR CONSTRUCTION, PERMIT, OR REGULATORY APPROVAL. * BOUNDARY LINES AND EASEMENTS ARE PRELIMINARY & REQUIRE VERIFICATION - SURVEY NOT PROVIDED. * ALL BUILDING AREAS ARE APPROXIMATE UNTIL BUILDING FOOTPRINT/ ENTRY DESIGNS ARE FINALIZED.
 * RENDERING IS REPRESENTATIVE OF DESIGN INTENT ONLY. IT IS NOT A PHOTOREALISTIC REPRESENTATION OF ACTUAL MATERIALS PROPOSED AND SHOULD BE CONSIDERED PRELIMINARY AT ALL STAGES. * PRELIMINARY DETENTION CALCULATIONS. CALCULATIONS ARE SUBJECT TO CHANGE AND NEED TO BE CONFIRMED BY A LICENSED ENGINEER.

PREPARED FOR
 TRANSACTION REAL ESTATE, LLC
 281.334.9370 | BRIAN@TRXRE.COM

WOODS RD
 a project for
TRXRE

HOUSTON

22 NOVEMBER 2021

TEXAS

211438

Copyright © 2021 POWERS BROWN ARCHITECTURE. This drawing and the architectural work depicted hereon are the sole property of Powers Brown Architecture. No portion of this drawing may be copied without the express written consent of the Architect.

OVERALL SITE PLAN - OPTION_02

SITE AREA : +/- 23AC (1,000,307 SF)

BUILDING AREA : 219,960 SF

COVERAGE : 22.0%

PARKING : 265 SPACES @.83/1000 SF

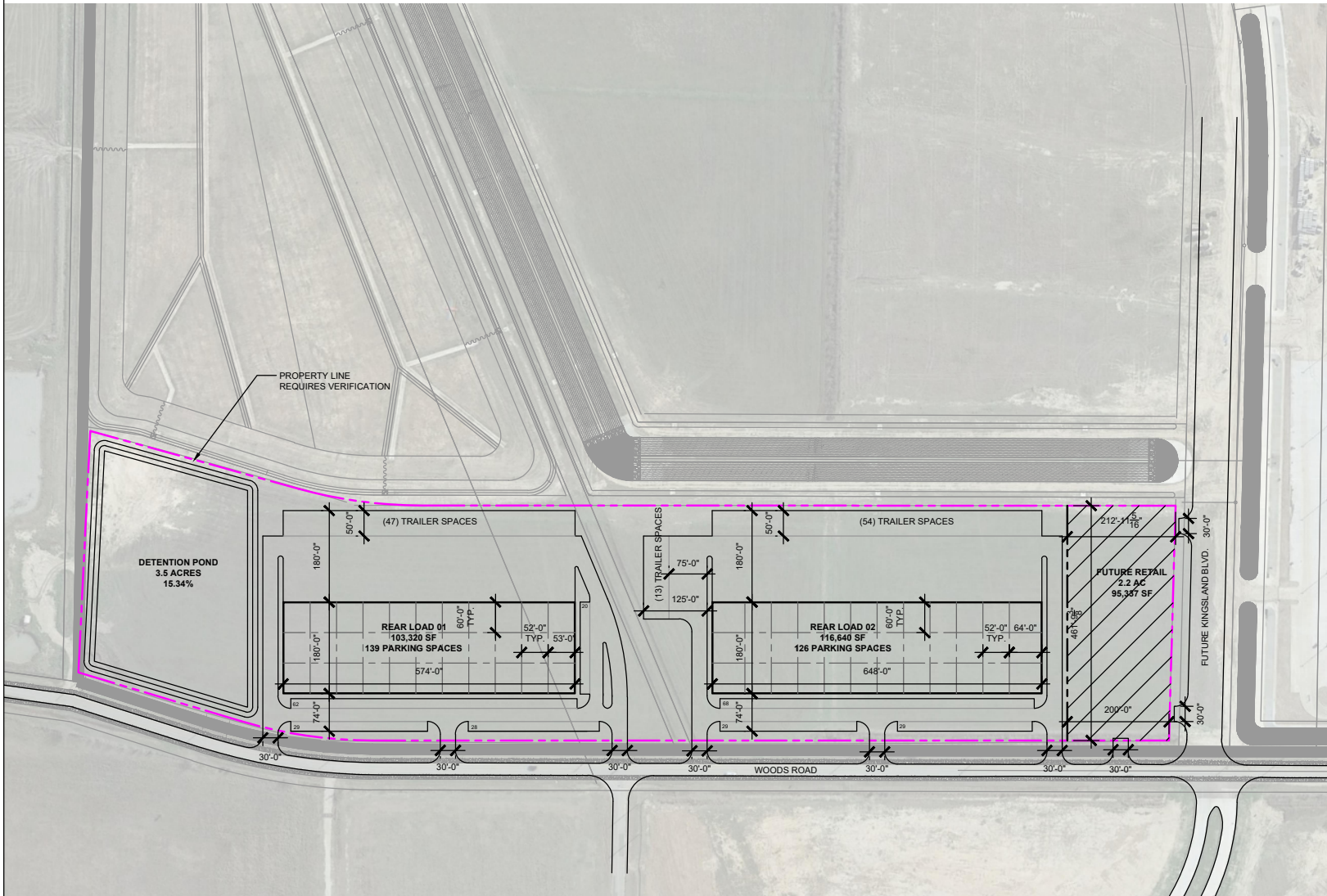

PREPARED FOR
TRANSACTION REAL ESTATE, LLC
281.394.0070 | BRIAN@TRXRE.COM



* PRELIMINARY NOT FOR CONSTRUCTION, PERMIT, OR REGULATORY APPROVAL. * BOUNDARY LINES AND EASEMENTS ARE PRELIMINARY & REQUIRE VERIFICATION - SURVEY NOT PROVIDED. * ALL BUILDING AREAS ARE APPROXIMATE UNTIL BUILDING FOOTPRINT/ ENTRY DESIGNS ARE FINALIZED.
 * RENDERING IS REPRESENTATIVE OF DESIGN INTENT ONLY. IT IS NOT A PHOTOREALISTIC REPRESENTATION OF ACTUAL MATERIALS PROPOSED AND SHOULD BE CONSIDERED PRELIMINARY AT ALL STAGES. * PRELIMINARY DETENTION CALCULATIONS. CALCULATIONS ARE SUBJECT TO CHANGE AND NEED TO BE CONFIRMED BY A LICENSED ENGINEER.

WOODS RD
a project for
TRXRE



Copyright © 2021 POWERS BROWN ARCHITECTURE. This drawing and the architectural work depicted herein are the sole property of Powers Brown Architecture. No portion of this drawing may be copied without the express written consent of the Architect.