

For Lease

Colliers

2541 N. Stokesberry Place
Meridian, Idaho 83646



Highlights

- Great location on Eagle Rd.
- Across from the Village at Meridian
- Functional layout with abundant natural light

Karl Maier

+1 208 809 3969

karl.maier@colliers.com

Lew Manglos, MBA, CCIM, SIOR

+1 208 484 9833

lew.manglos@colliers.com

Accelerating success.

For Lease

PROPERTY DETAILS

Property Type	Office
Total Building Size	5,530 SF
Lease Type	FSEJ
Parking	Surface
Property Access	Call Agent

SPACE AVAILABLE

Suite	Size	Rate
300	2,073 SF	\$22.50/SF/YR

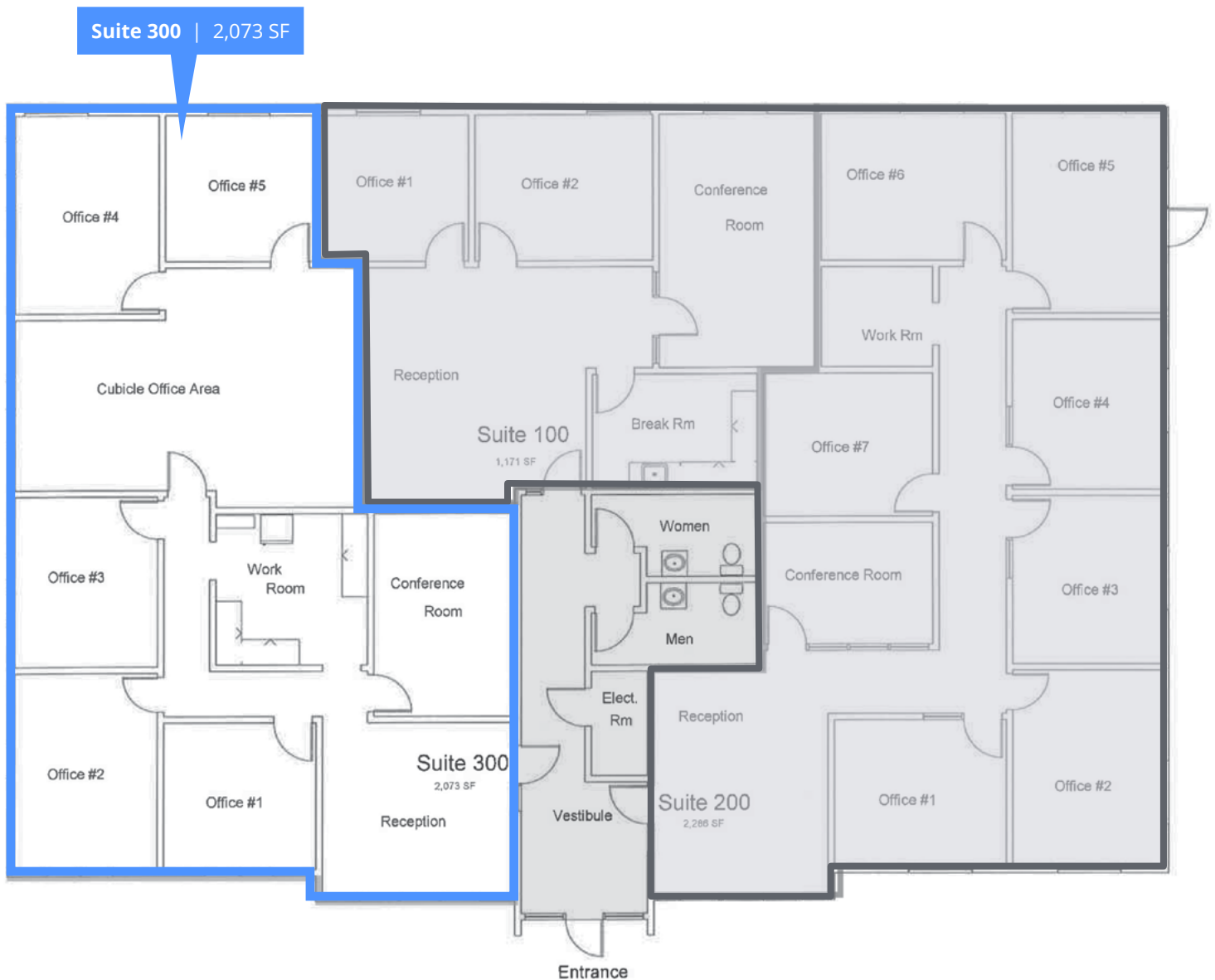

Photos

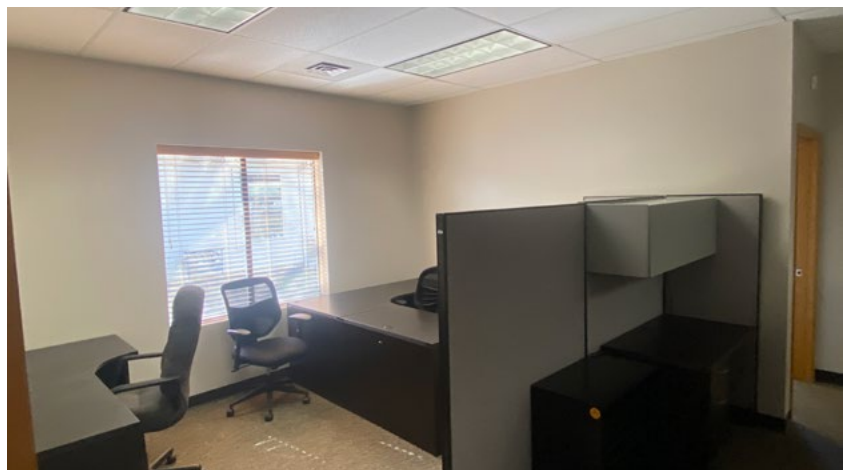
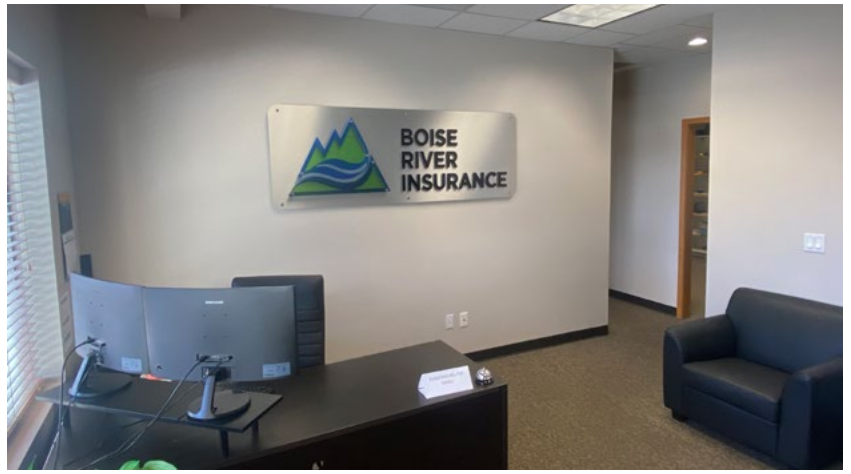

Location

 Google Map

 Street View



Demos

2025	1 Miles	3 Miles	5 Miles
Population	11,195	106,422	255,232
Households	4,333	40,590	97,898
Avg. HH Income	\$124,457	\$122,359	\$129,227



755 West Front Street, Suite 300
 Boise, Idaho 83702
 +1 208 345 9000
colliers.com/idaho

This document has been prepared by Colliers for advertising and general information only. Colliers makes no guarantees, representations or warranties of any kind, expressed or implied, regarding the information including, but not limited to, warranties of content, accuracy and reliability. Any interested party should undertake their own inquiries as to the accuracy of the information. Colliers excludes unequivocally all inferred or implied terms, conditions and warranties arising out of this document and excludes all liability for loss and damages arising there from. This publication is the copyrighted property of Colliers and/or its licensor(s). © 2026. All rights reserved. This communication is not intended to cause or induce breach of an existing listing agreement. Colliers Treasure Valley, LLC.