



# SHADY OAK ACRES

Located 10 miles from the Interstate 10 off the Banning Idyllwild Panoramic Highway to Poppet Flats.

A one of kind property in the area!



*PRIVATE ENTRY OFF CRYER ROAD*

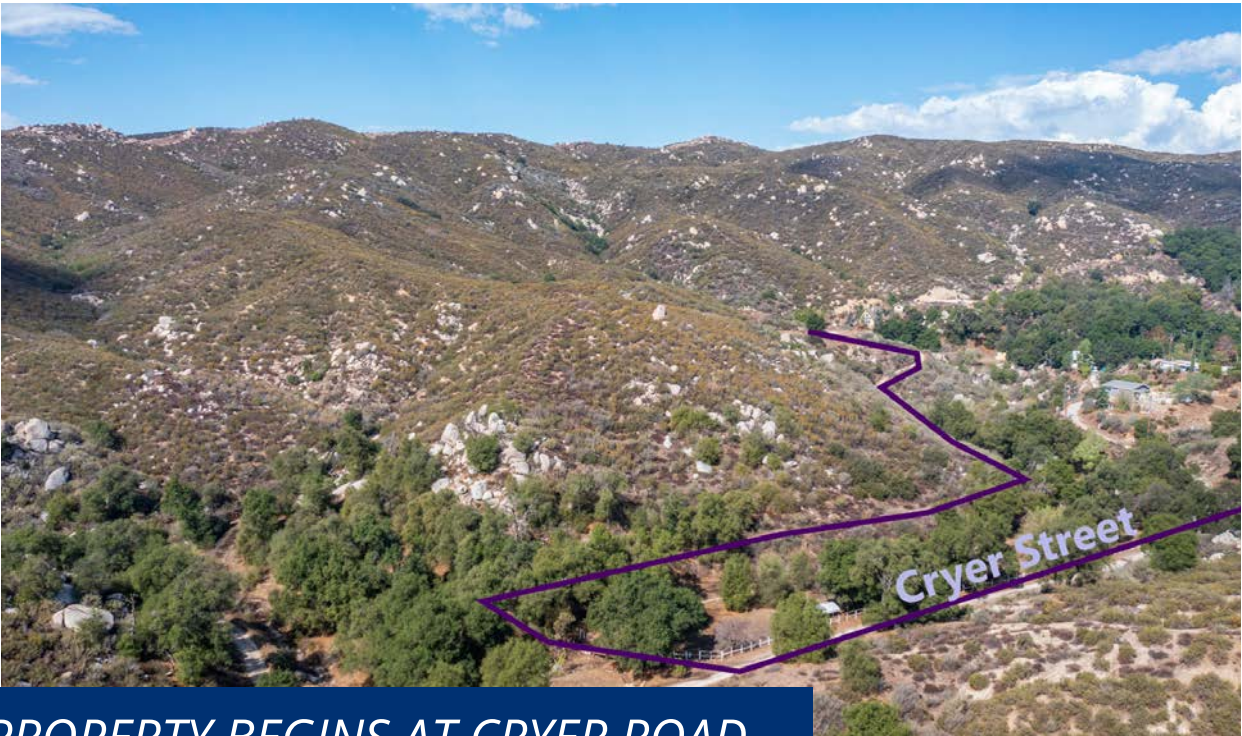

*PROPERTY BEGINS AT CRYER ROAD*

A 44-acre ranch style property featuring shady oak groves and abundant wildlife. Consists of 2 main lots, one of 5 acres and one of 49 acres that can be purchased and developed together or separately.

A gentleman's ranch featuring home site building pads with spectacular panoramic views.

Previous use was an equestrian property.

---

Existing usable structures include a small barn, horse stables, and several storage sheds

Potential for various developments



Secluded, yet close to amenities: Silent Valley Club Resort 3 miles Restaurant and Convenience Store  
<https://www.silentvalleyclub.com/>

---



© We're Focused



© We're Focused

**Water:**

Property has meters. More meters are available from the High Valley Water District. Can drill private wells. Several well sites have been located on the property.

---



Approximation Of The Property's Perimeter Boundary Lines

### Property consists of 2 main lots

Lot 1 is 5 acres and lot 2 is 49 acres,  
that can be purchased together or separately. Lots are comprised of various parcels  
Lot 1 is priced to sell at \$150,000  
Lot 2 is priced to sell at \$130,000  
Please call for description, maps, and details.

### Proximity to:

- City of Banning, 12 miles
- Idyllwild Community Center, Pine Cove, 20 miles
- Morongo Casino Resort and Spa, 20 miles
- Palm Springs, 36 miles

DARRELL PHILLIPS  
760.898.0240  
DPHILLIPS@KWCOMMERCIAL.COM



COMMERCIAL™

Darrell Phillips Realtor® 760.898.0240  
CalDre:#02012975  
dphillips@kwcommercial.com