

KENWOOD CROSSING

2212-2232 HENNEPIN AVE, MINNEAPOLIS, MN



KRAUS-ANDERSON®
Realty Company

SPACE AVAILABLE

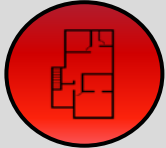

2,000 SF Available

SHOPPING CENTER



14,754 sf Retail Strip Center

LOCATION



Retail Strip Center along the vibrant Hennepin Ave corridor – gateway to the Uptown Business District

TRAFFIC COUNT



31,500/VPD on Hennepin Ave
17,200/VPD on Lyndale Ave



	1 Mile	3 Miles	5 Miles
POPULATION	39,765	227,795	487,879
DAYTIME POP	26,737	333,258	609,153
HOUSEHOLDS	22,909	104,654	210,316
HOUSEHOLD INCOME	84,597	87,767	95,167



Retail Aerial

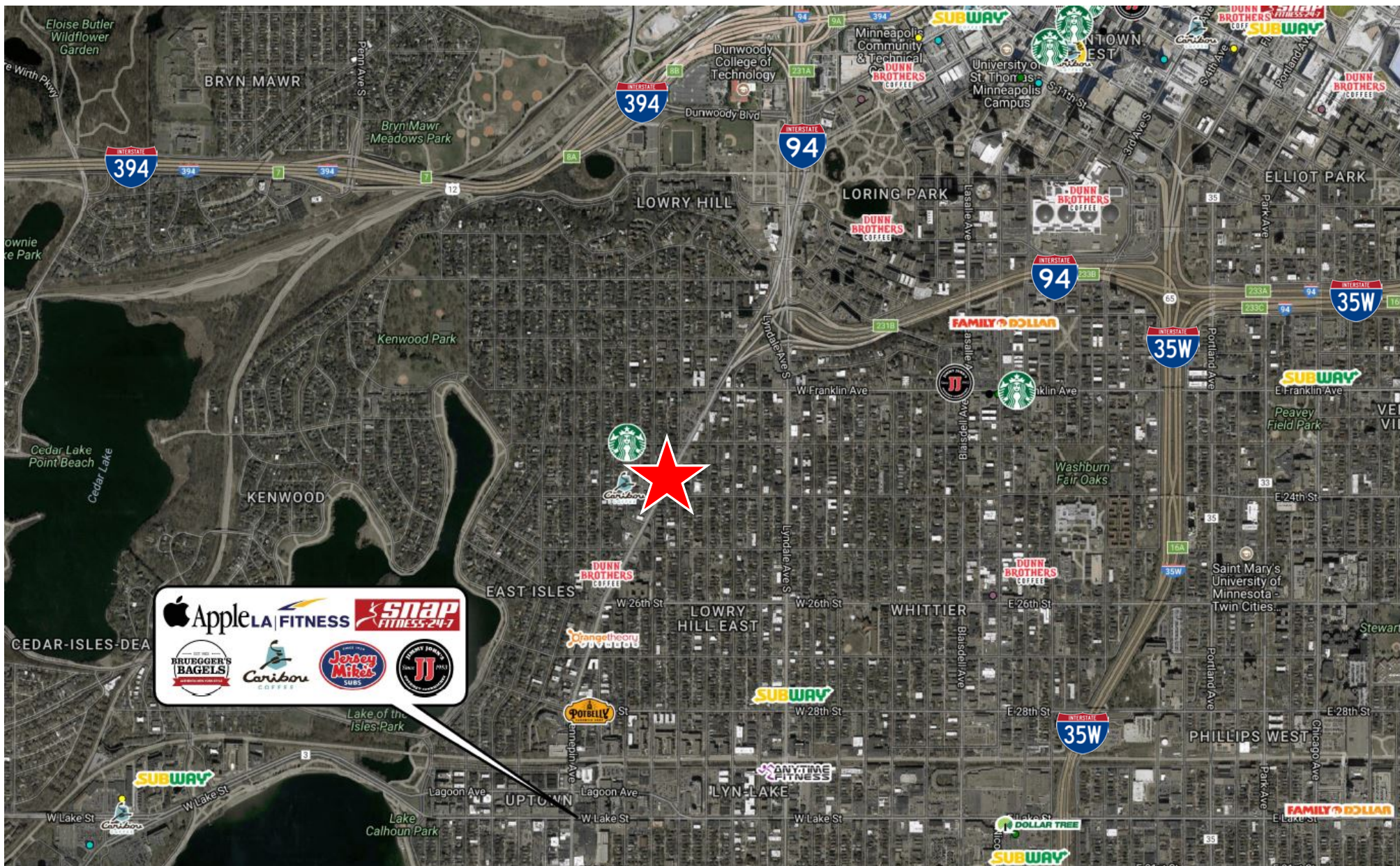

KENWOOD CROSSING
MINNEAPOLIS, MN





Aerial View



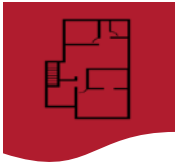

Site Plan

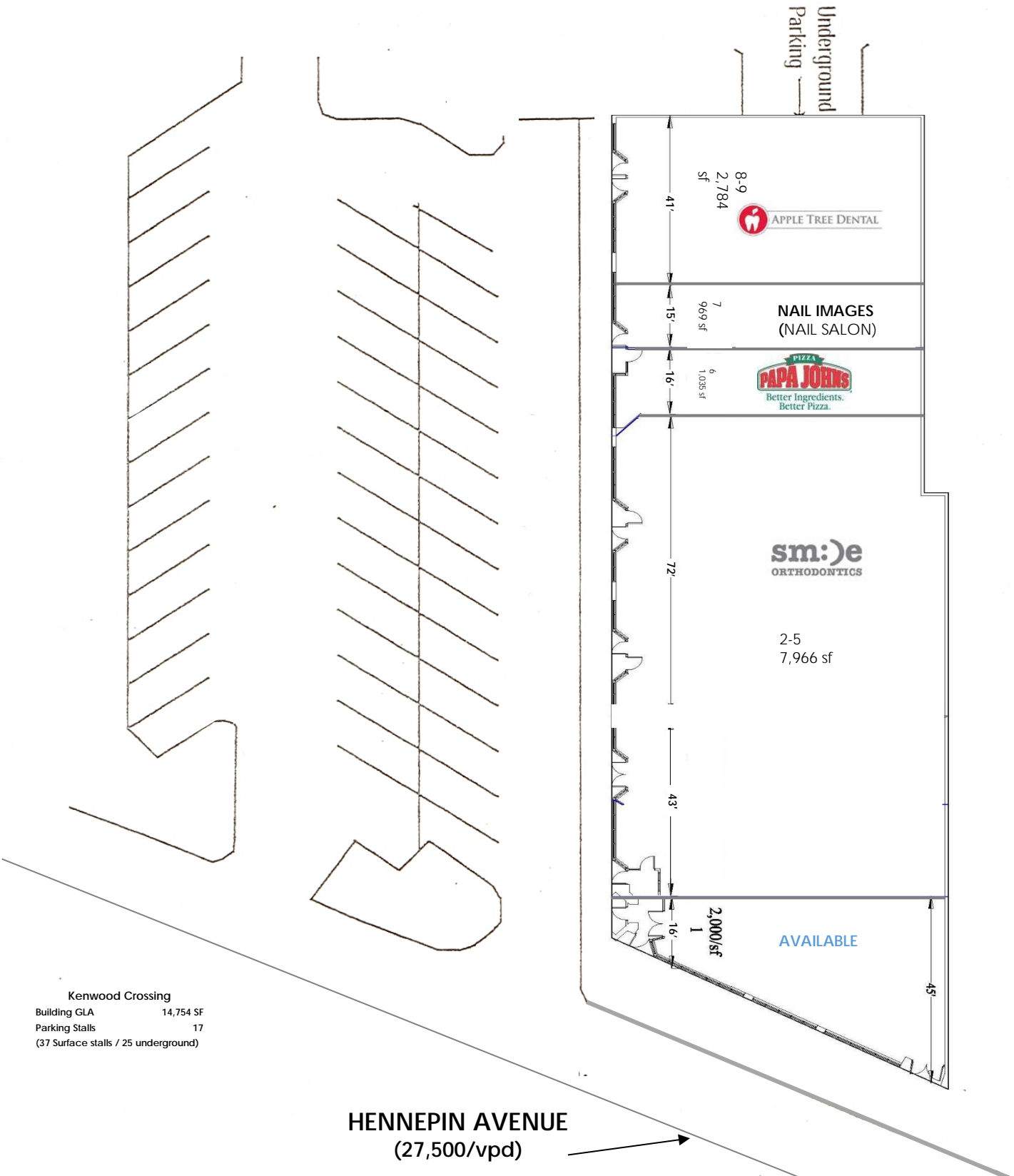

Kenwood Crossing
 Building GLA 14,754 SF
 Parking Stalls 17
 (37 Surface stalls / 25 underground)

HENNEPIN AVENUE
 (27,500/vpd)

KENWOOD CROSSING
 2212-2232 HENNEPIN AVENUE SOUTH, MINNEAPOLIS, MN





Contact

Kraus-Anderson

501 South Eighth Street
Minneapolis, MN 55404

www.krausanderson.com

Main 612-332-7281
Fax 952-881-8114



Dan Mossey



O: 612-255-2420

C: 763-438-4751



dan.mossey@krausanderson.com