

OFFERING MEMORANDUM

Multi-Tenant Flex Industrial

410 W J St, Tehachapi, CA 93561

APN: 415-110-12-00-1, County of Kern

ASKING PRICE:
\$1,895,000.00 (\$136/sf)



OLIVIERI COMMERCIAL GROUP

9810 Brimhall Road
Bakersfield, CA 93312
www.oliviericommercial.com

For additional information please contact:

J-P Masuda
Senior Vice President
LIC. #01947962
(661) 619-7151
jpmasuda@oliviericommercial.com

PROPERTY SUMMARY

410 W J St, Tehachapi, CA 93561

- **ASKING PRICE: \$1,895,000.00 (\$136/SF)**
- **BUILDING SIZE: +/- 13,888 sq ft**
 - 50% Occupied with existing in-place income stream
 - Owner-User Opportunity for up to 6,338 sq ft in Suite A
 - Suite A in turn-key general office condition
- **LOT SIZE: +/- 3.27 acres**
 - +/- 1.75 acre storage yard OR future development opportunity
- **LOCATION**
 - SWC of W J Street & N Mill Street
 - Located 0.3 miles from Hwy 58 on/off ramps
 - Located within close proximity to The Home Depot & Tractor Supply Co.
- **PARKING: 37 dedicated parking spaces**
 - Ample street parking available
- **CONSTRUCTION: Built in 1990**
- **ZONING**
 - M-1 (Light Industrial), City of Tehachapi
- **APN: 415-110-12-00-1, County of Kern**



The information above has been obtained from sources believed reliable. While we do not doubt its accuracy we have not verified it and make no guarantee, warranty or representation about it. It is your responsibility to independently confirm its accuracy and completeness. Any projections, opinions, assumptions or estimates used are for example only and do not represent the current or future performance of the property. The value of this transaction to you depends on tax and other factors which should be evaluated by your tax, financial and legal advisors. You and your advisors should conduct a careful, independent investigation of the property to determine to your satisfaction the suitability of the property for your needs. Logos are for identification purposes only and may be trademarks of their respective companies.



THE BENEFITS OF TEHACHAPI

Growing Economy: One of California's fastest-growing small towns, with expanding residential and commercial development.

Business-Friendly Community: Strong support and resources to help small businesses and entrepreneurs succeed.

Prime Location: Easy access via CA Hwy 58 to major markets like Los Angeles, Bakersfield, the Central Valley, and east to Las Vegas.

Quality of Life: Four seasons, scenic views, and a close-knit community offer excellent work-life balance.

- **City Trade Area:** Serves +200,000 consumers across Greater Tehachapi and Eastern Kern
- **Trade Corridor:** Over 20,000 vehicles daily along Highway 58
- **Industries:** Diverse sectors including education, public administration, construction, mining, retail, and manufacturing
- **Local Economy:** Average household discretionary income - \$61,000 (AFTER taxes, food, housing, utilities, etc.)
- **Safety:** Fully-staffed, 24-hour Police Department & Dispatch Center serving the Greater Tehachapi area



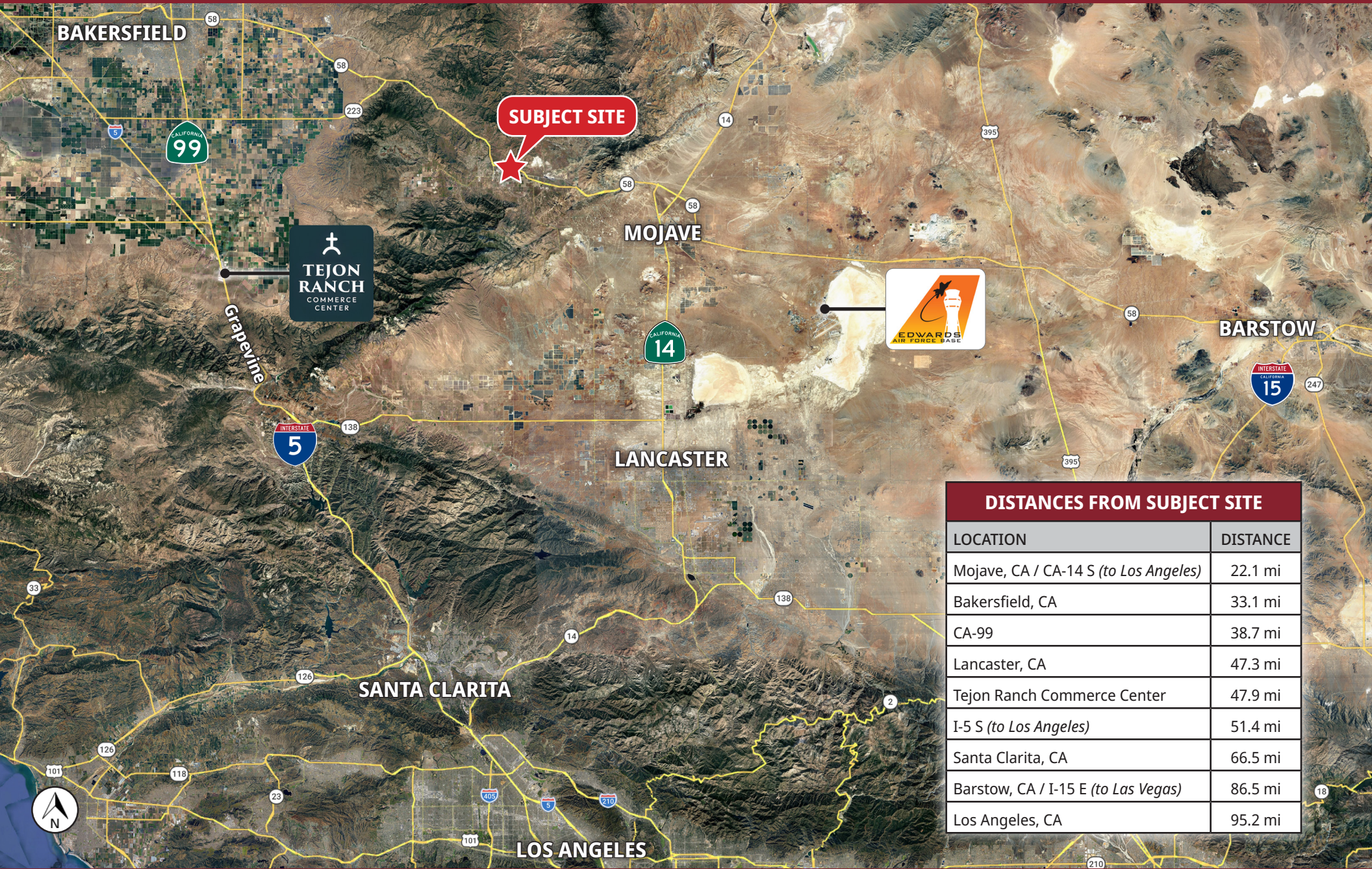

DISTANCES FROM SUBJECT SITE	
LOCATION	DISTANCE
Mojave, CA / CA-14 S (to Los Angeles)	22.1 mi
Bakersfield, CA	33.1 mi
CA-99	38.7 mi
Lancaster, CA	47.3 mi
Tejon Ranch Commerce Center	47.9 mi
I-5 S (to Los Angeles)	51.4 mi
Santa Clarita, CA	66.5 mi
Barstow, CA / I-15 E (to Las Vegas)	86.5 mi
Los Angeles, CA	95.2 mi



The information above has been obtained from sources believed reliable. While we do not doubt its accuracy we have not verified it and make no guarantee, warranty or representation about it. It is your responsibility to independently confirm its accuracy and completeness. Any projections, opinions, assumptions or estimates used are for example only and do not represent the current or future performance of the property. The value of this transaction to you depends on tax and other factors which should be evaluated by your tax, financial and legal advisors. You and your advisors should conduct a careful, independent investigation of the property to determine to your satisfaction the suitability of the property for your needs. Logos are for identification purposes only and may be trademarks of their respective companies.

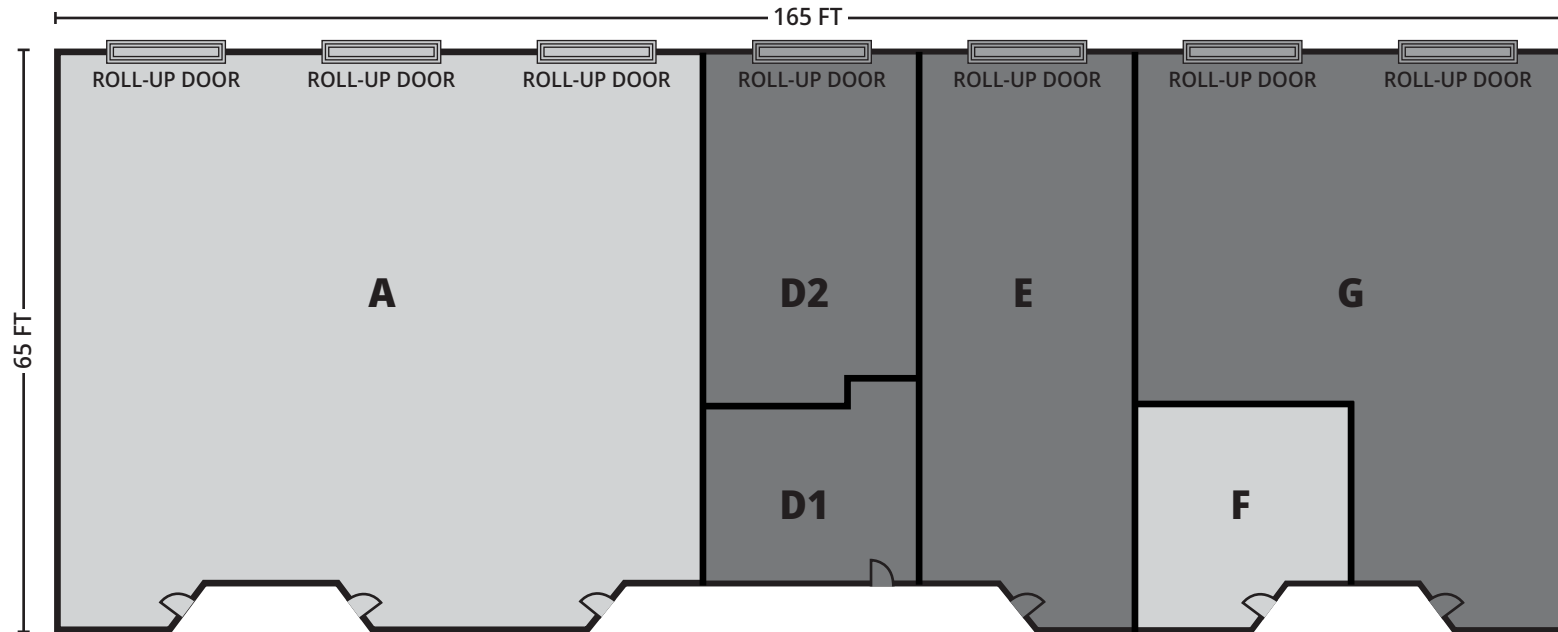

*Site Plan not to scale

SUITE SQUARE FOOTAGE					
Suite A + 2nd floor	Suite D1	Suite D2 + mezzanine	Suite E + mezzanine	Suite F	Suite G
(VACANT) +/- 6,383 SF	A1 Driving School	Chris Kirk		(VACANT) +/- 664 SF	Protech Auto Service





The information above has been obtained from sources believed reliable. While we do not doubt its accuracy we have not verified it and make no guarantee, warranty or representation about it. It is your responsibility to independently confirm its accuracy and completeness. Any projections, opinions, assumptions or estimates used are for example only and do not represent the current or future performance of the property. The value of this transaction to you depends on tax and other factors which should be evaluated by your tax, financial and legal advisors. You and your advisors should conduct a careful, independent investigation of the property to determine to your satisfaction the suitability of the property for your needs. Logos are for identification purposes only and may be trademarks of their respective companies.



The information above has been obtained from sources believed reliable. While we do not doubt its accuracy we have not verified it and make no guarantee, warranty or representation about it. It is your responsibility to independently confirm its accuracy and completeness. Any projections, opinions, assumptions or estimates used are for example only and do not represent the current or future performance of the property. The value of this transaction to you depends on tax and other factors which should be evaluated by your tax, financial and legal advisors. You and your advisors should conduct a careful, independent investigation of the property to determine to your satisfaction the suitability of the property for your needs. Logos are for identification purposes only and may be trademarks of their respective companies.

1-Mile Radius

KEY FACTS

5,139

Population

38.0

Median Age



Average Household Size

\$60,786

Median Household Income

BUSINESS



333

Total Businesses



2,843

Total Employees

INCOME



\$60,786

Median Household Income



\$28,500

Per Capita Income



\$70,982

Median Net Worth

3-Mile Radius

KEY FACTS

17,176

Population

37.7

Median Age



Average Household Size

\$74,597

Median Household Income

BUSINESS



786

Total Businesses



5,663

Total Employees

INCOME



\$74,597

Median Household Income



\$36,798

Per Capita Income



\$147,953

Median Net Worth

5-Mile Radius

KEY FACTS

20,842

Population

39.2

Median Age



Average Household Size

\$81,078

Median Household Income

BUSINESS



835

Total Businesses



5,892

Total Employees

INCOME



\$81,078

Median Household Income



\$39,466

Per Capita Income



\$195,396

Median Net Worth





Exclusively Offered by:

J-P Masuda - Senior Vice President
LIC. #01947962
(661) 619-7151
jpmasuda@oliviericommercial.com



Olivieri Commercial Group
9810 Brimhall Road
Bakersfield, CA 93312
www.oliviericommercial.com

The information contained in this Marketing Brochure is proprietary and strictly confidential. It is intended to be reviewed only by the party receiving it from Olivieri Commercial Group, Inc. ("OCG") and should not be made available to any other person or entity without the written consent of OCG. This Marketing Brochure has been prepared to provide summary, unverified information to prospective purchasers, and to establish only a preliminary level of interest in the subject property.

The information contained herein is not a substitute for a thorough due diligence investigation. Olivieri Commercial Group, Inc., has not made any investigation, and makes no warranty or representation, with respect to the income or expenses for the subject property, the future projected financial performance of the property, the size and square footage of the property and improvements, the presence or absence of contaminating substances, PCB's or asbestos, the compliance with State and Federal regulations, the physical condition of the improvements thereon, or the financial condition or business prospects of any tenant, or any tenant's plans or intentions to continue its occupancy of the subject property.

The information contained in this Marketing Brochure has been obtained from sources believed to be reliable; however, Olivieri Commercial Group, Inc., has not verified, and will not verify, any of the information contained herein, nor has Olivieri Commercial Group, Inc., conducted any investigation regarding these matters and makes no warranty or representation whatsoever regarding the accuracy or completeness of the information provided. All potential buyers must take appropriate measures to verify all of the information set forth herein.