



# 1824 S. Broadway

Denver, Colorado 80210

## Property Overview

- Great exposure on South Broadway with over 36,000 vehicles per day.
- Located within the beautifully revitalized portion of South Broadway with attractive new infrastructure in place.
- Surrounded by numerous retail shops, neighborhood taverns, art galleries, antique shops and everything else you'd expect to find within the urban heartbeat of Denver.
- Approximately 70 feet of storefront exposure on Broadway!



Availability	6,400 SF
Bldg Size	10,976 SF
Lot Size	12,197 SF
Parking	2 dedicated spaces and ample street parking
Year Built	1950
Zoning	U-MS-3

## Lease Rate: \$22.00/SF MG

**Operating Expenses: \$4.69 SF (includes Taxes, Insurance and Utilities)**

**Cory Dulberg**

303 565 3039

[cdulberg@shamesmakovsky.com](mailto:cdulberg@shamesmakovsky.com)

**Robert Hudgins**

303 565 3033

[rhudgins@shamesmakovsky.com](mailto:rhudgins@shamesmakovsky.com)



Open, spacious layout with potential for beautiful concrete floors throughout.



ALLEY

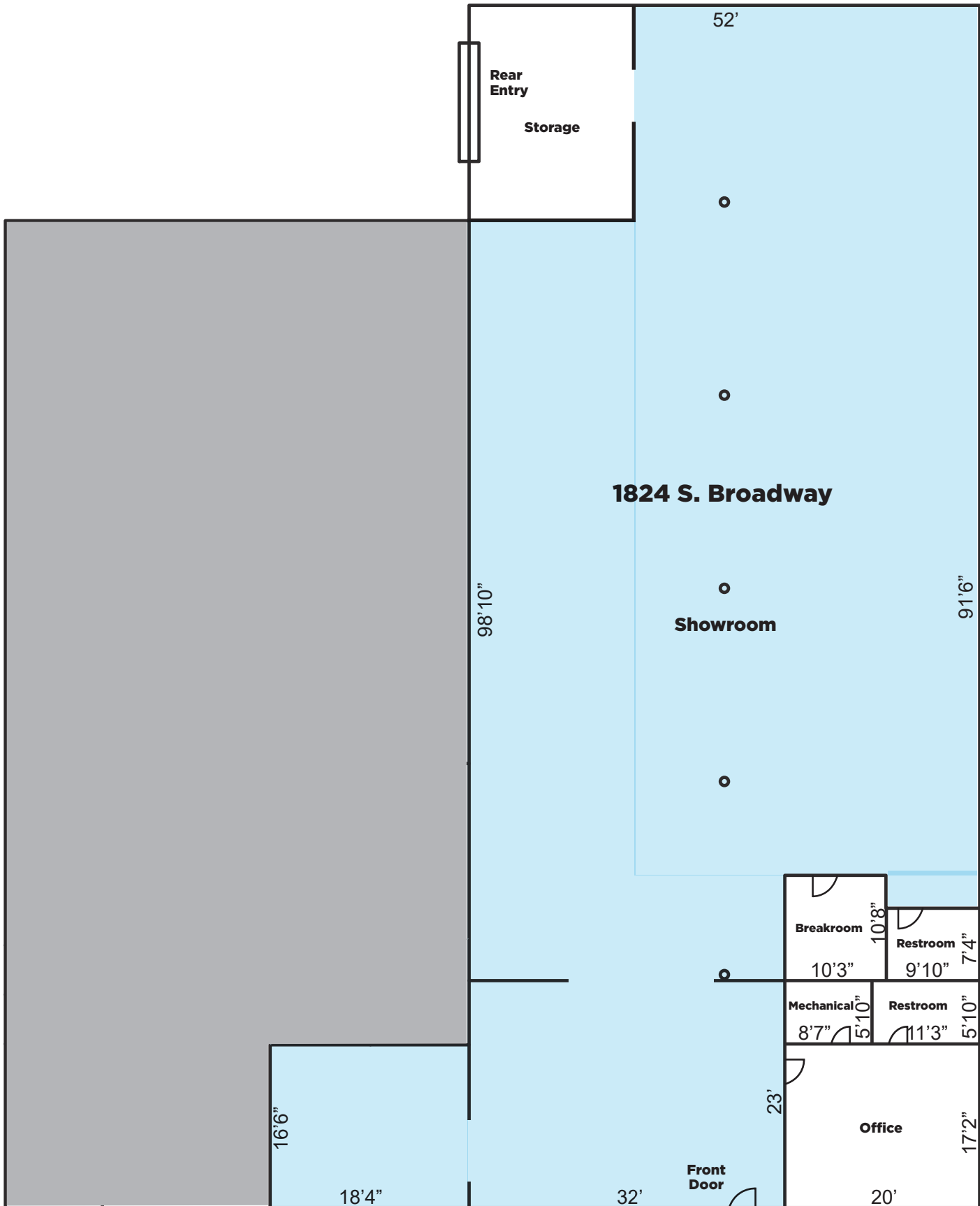

BROADWAY

RETAIL FOR LEASE  
**1824 S. Broadway**  
 Denver, CO 80210



**Demographics**

	1 Mile	3 Mile	5 Mile
Population	13,527	163,667	480,870
Avg. Household Income	\$141,807	\$108,338	\$101,656

\*Source: CoStar

**Traffic Counts**

	Vehicles/Day
Broadway @ Jewell Ave	36,743

\*Source: CoStar

**NAI** Shames Makovsky

**Cory Dulberg**

303 565 3039

[cdulberg@shamesmakovsky.com](mailto:cdulberg@shamesmakovsky.com)

**Robert Hudgins**

303 565 3033

[rhudgins@shamesmakovsky.com](mailto:rhudgins@shamesmakovsky.com)

NO WARRANTY OR REPRESENTATION, EXPRESS OR IMPLIED, IS MADE AS TO THE ACCURACY OF THE INFORMATION CONTAINED HEREIN, AND THE SAME IS SUBMITTED SUBJECT TO ERRORS, OMISSIONS, CHANGE OF PRICE, RENTAL OR OTHER CONDITIONS, PRIOR SALE, LEASE OR FINANCING, OR WITHDRAWAL WITHOUT NOTICE, AND OF ANY SPECIAL LISTING CONDITIONS IMPOSED BY OUR PRINCIPALS NO WARRANTIES OR REPRESENTATIONS ARE MADE AS TO THE CONDITION OF THE PROPERTY OR ANY HAZARDS CONTAINED THEREIN ARE ANY TO BE IMPLIED.