

GE PROPERTY

佳富地產

# THE PROVINCE



398 W Valley Blvd | San Gabriel

**CONTACT US: (626) 458-9000**

GE PROPERTY

佳富地產

# PROPERTY FACTS



Address:

**398 W Valley Blvd**  
**| San Gabriel**

Building Size: 150,476 SF

Residential Units: 133

Commercial Space: 50,476 SF

No. of Story: Five

Parking Spaces: 172

The information contained herein is obtained from sources believed to be reliable. However, we have not verified it and make no guarantees, warranties or representations as to the completeness or accuracy thereof. The presentation of this property is used for example and is submitted subject to errors, omissions, change of price or conditions, and is subject to prior sale, lease or withdrawal without notice.

# COMMERCIAL MAP

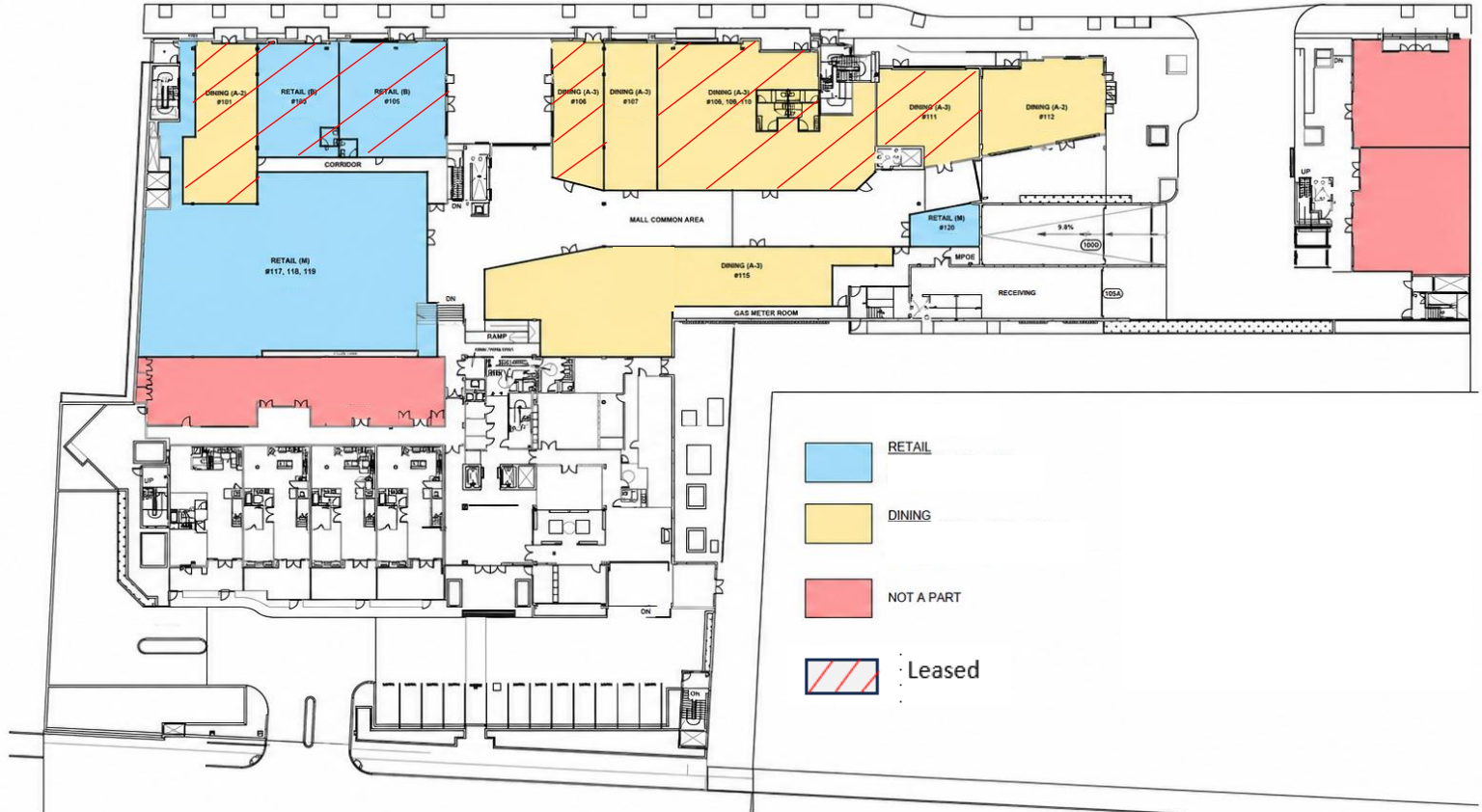

# RETAIL FOR LEASE

UNIT	SIZE	\$/SF
UNIT 107 Dining	1,301 SF	Upon Request
UNIT 112 Dining	1,825 SF	Upon Request
UNIT 115 Dining	4,816 SF	Upon Request
UNIT 117,118,119 Retail	9,155 SF	Upon Request
UNIT 120 Retail	444 SF	Upon Request

GE PROPERTY

佳富地產

# AREA MAP



398-420 W Valley Blvd | San Gabriel

# OUR COMPANY

For over 3 decades, GE Property Development, Inc. has provided real estate services for our clients in Los Angeles as well as our clients around the world. We provide a full array of real estate services in the areas of brokerage, development, leasing and management.

Our model is, "Let our results speak for themselves". We feel that our extensive portfolio speaks volumes about our experience and abilities.

Regardless of the real estate need, our firm can provide excellent service with one objective in mind; to meet our client's goals, expectations, and complete satisfaction. In doing so, we are able to increase revenues and decrease cost, demonstrating our unmatched reputation, professionalism, experience, and knowledge in the real estate industry.

GE Property Management, Inc. and its predecessor, Sun West Management, have served its investment clients as a full-service real estate company since 1983. Stephen Chan, the President and Founder of the firm, has been an active broker in the real estate field since 1977. The firm has acted as an acquisition consultant and broker for many local investors, foreign investors, and publicly-traded companies.



**Stephen Chan**  
**President and Founder**  
DRE# 00676562  
Stephen@geproperty.com



**Raymond Ho**  
**Vice President**  
DRE# 01868322  
raymond@geproperty.com

## CORPORATE HEADQUARTERS

407 West Valley Boulevard, Suite 4, Alhambra, California 91803

Telephone: 626-458-9000  
Fax: 626-282-9777  
Website: [www.geproperty.com](http://www.geproperty.com)  
DRE# 01841262