

FOR LEASE

**CBRE**

# 7005 Luther Drive

SACRAMENTO, CA

Unit 11 ±2,880 SF Industrial Unit



## Contact Us

**Zac Sweet, SIOR**  
Senior Vice President  
C: 916 717 4768  
zac.sweet@cbre.com  
Lic. 01352800

**Tyler Howell**  
Senior Associate  
T: 916 781 4835  
tyler.howell1@cbre.com  
Lic. 02100245

**Courtney Lee**  
Associate  
C: 916 906 5544  
courtney.lee@cbre.com  
Lic. 02031694



# PROPERTY INFORMATION

7005 LUTHER DRIVE  
SACRAMENTO, CA 95823

BUILDING SIZE: ±15,842 SF

- GOOD ACCESS TO HIGHWAY 99
- CONCRETE TILT-UP CONSTRUCTION

UNIT 11: ±2,880 SF

- ±880 SF OFFICE
- 12'x12' GRADE LEVEL DOOR
- 16' CLEAR HEIGHT
- ASKING RATE: \$0.85/SF PLUS NNN
- NNN EXPENSES: \$0.31/SF

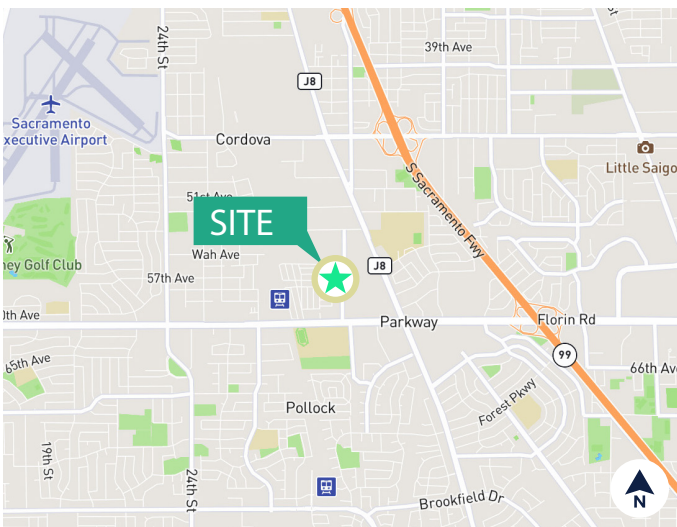

## Contact Us

**Zac Sweet, SIOR**  
Senior Vice President  
C: 916 717 4768  
zac.sweet@cbre.com  
Lic. 01352800

**Tyler Howell**  
Senior Associate  
T: 916 781 4835  
tyler.howell1@cbre.com  
Lic. 02100245

**Courtney Lee**  
Associate  
C: 916 906 5544  
courtney.lee@cbre.com  
Lic. 02031694



# FLOOR PLAN - UNIT 11 | ±2,880 SF

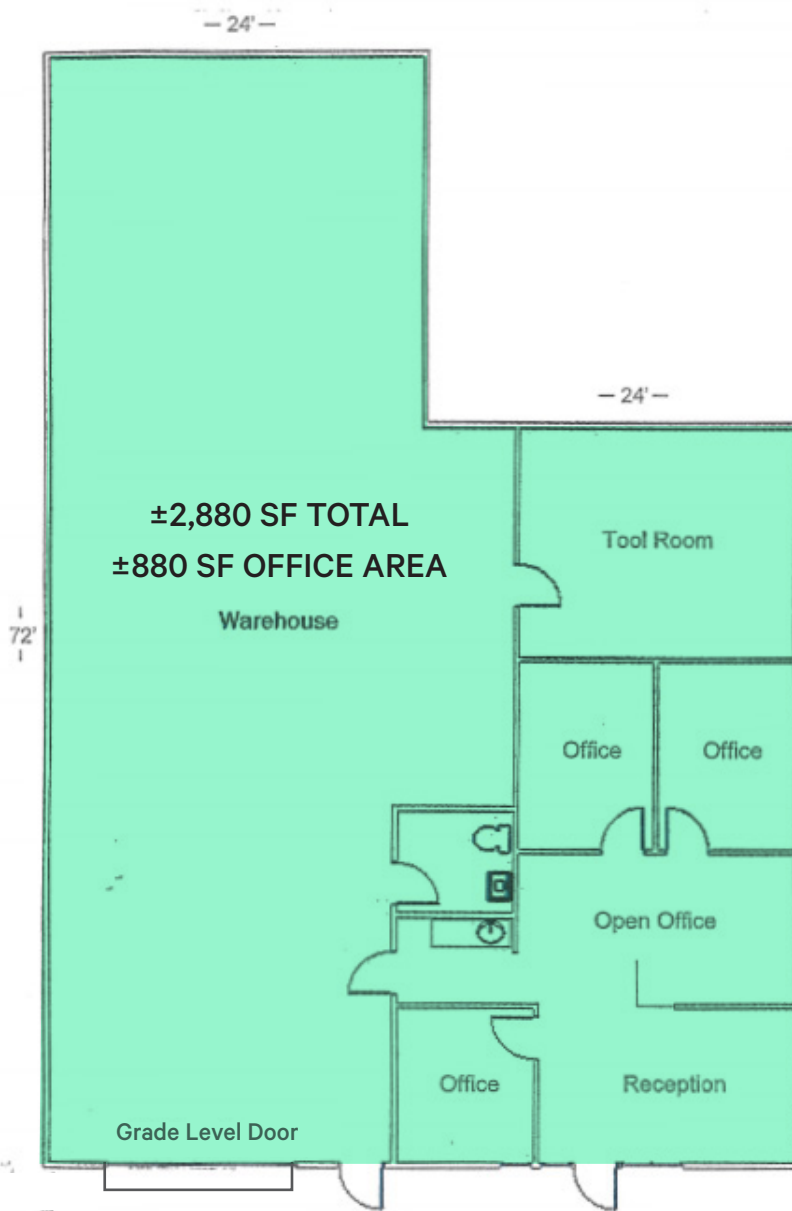

\*Floor plan not to scale, dimensions approximate



## Contact Us

**Zac Sweet, SIOR**  
Senior Vice President  
C: 916 717 4768  
zac.sweet@cbre.com  
Lic. 01352800

**Tyler Howell**  
Senior Associate  
T: 916 781 4835  
tyler.howell1@cbre.com  
Lic. 02100245

**Courtney Lee**  
Associate  
C: 916 906 5544  
courtney.lee@cbre.com  
Lic. 02031694