

NATIONAL FLOOR PLANS
 398 COLUMBUS AVENUE, SUITE 100
 BOSTON, MA 02116 (800) 328-0217

| REVISIONS | | | |
|-----------|----|-----|-------------|
| DATE | BY | NO. | DESCRIPTION |
| | | | |
| | | | |

**28 HASTINGS STREET
 BUILDING A**
 MENDON, MA

| | |
|-----------------|--------------|
| PROJECT NUMBER: | |
| DATE: | NOV 2024 |
| SCALE: | AS NOTED |
| DRAWN BY: | APPROVED BY: |

SHEET TITLE:
FLOOR PLANS

SHEET NUMBER:
A-2

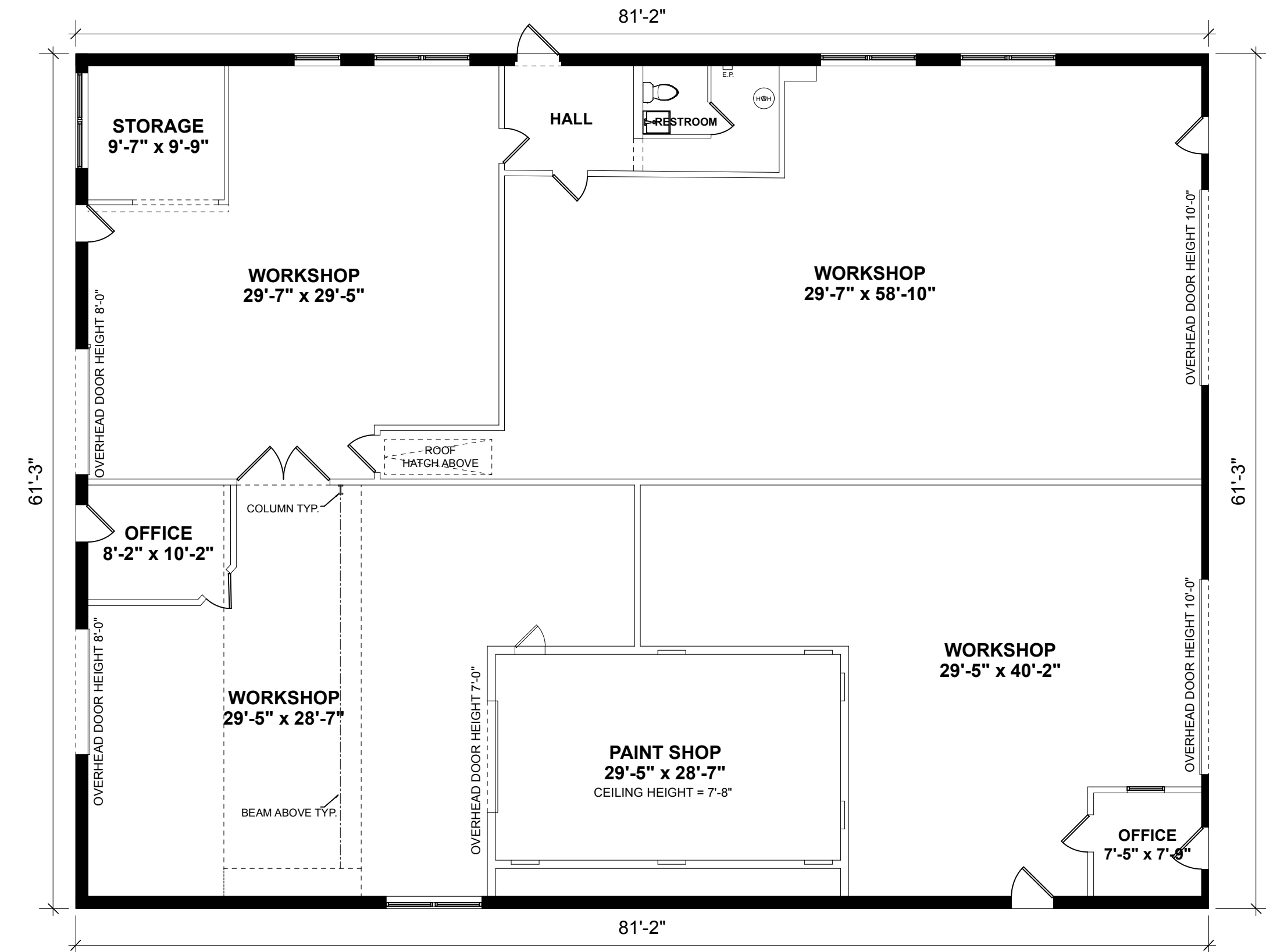

BUILDING AREA CALCULATIONS - BUILDING A
 FIRST FLOOR = 4,971 SF
 TOTAL GROSS BUILDING AREA = 4,971 SF

FIRST FLOOR PLAN
 Ceiling Height = 13'-2"

