

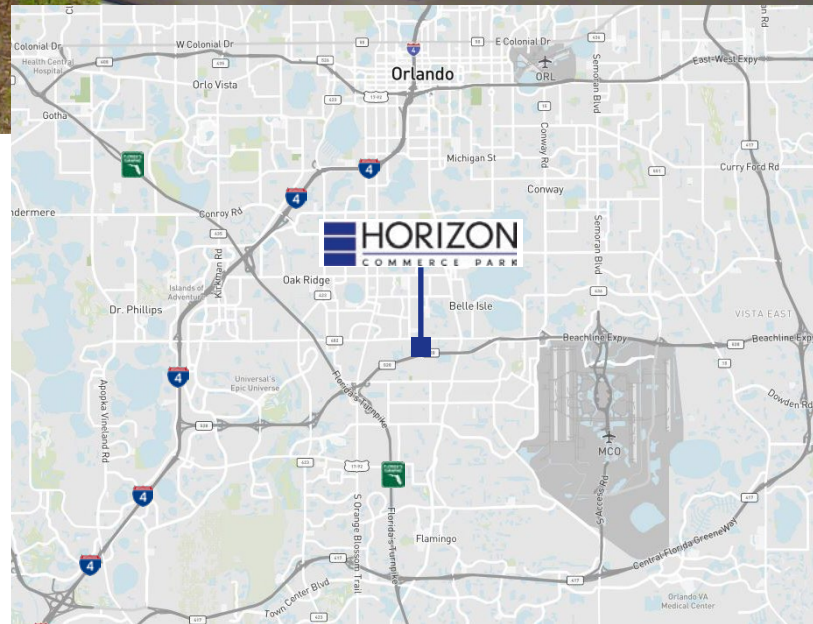

Horizon Commerce Park IV

212 Outlook Point Drive, Suite 100, Orlando, FL 32809

- Total Building s.f.: 122,686 s.f. rear load
- Available Space: 98,879 s.f.
- Office: 22,005 s.f.
- Clear Height: 30' minimum
- Dock Doors: 4 - 12' x 14'
- Ramp Door: 1 - 12' x 14'
- Column Spacing: 44' W x 40'D and 44'W x 50'D
- Building Depth: 170'
- Truck Court: 180'
- Parking Ratio: 1.3/1,000 s.f.
- Fire Protection: ESFR Sprinkler System
- Zoning: I-2 & I-3, Orange County
- Available: May 1, 2026
- Please call for lease rate
- Estimated Op.Exp.: \$3.46 p.s.f.



Owned by



Leased by



For additional information, please contact:

Bobby Isola, SIOR, CCIM
+1 407 930 1804
bobby.isola@jll.com
Jones Lang LaSalle Brokerage, Inc.

Matt Sullivan, SIOR, CCIM
+1 407 930 1802
matt.sullivan@jll.com
Jones Lang LaSalle Brokerage, Inc.

Cameron Montgomery
+1 407 982 8650
cameron.montgomery@jll.com
Jones Lang LaSalle Brokerage, Inc.

Horizon Commerce Park IV

212 Outlook Point Drive, Orlando, FL 32809

Suite 100: 98,879 s.f. available

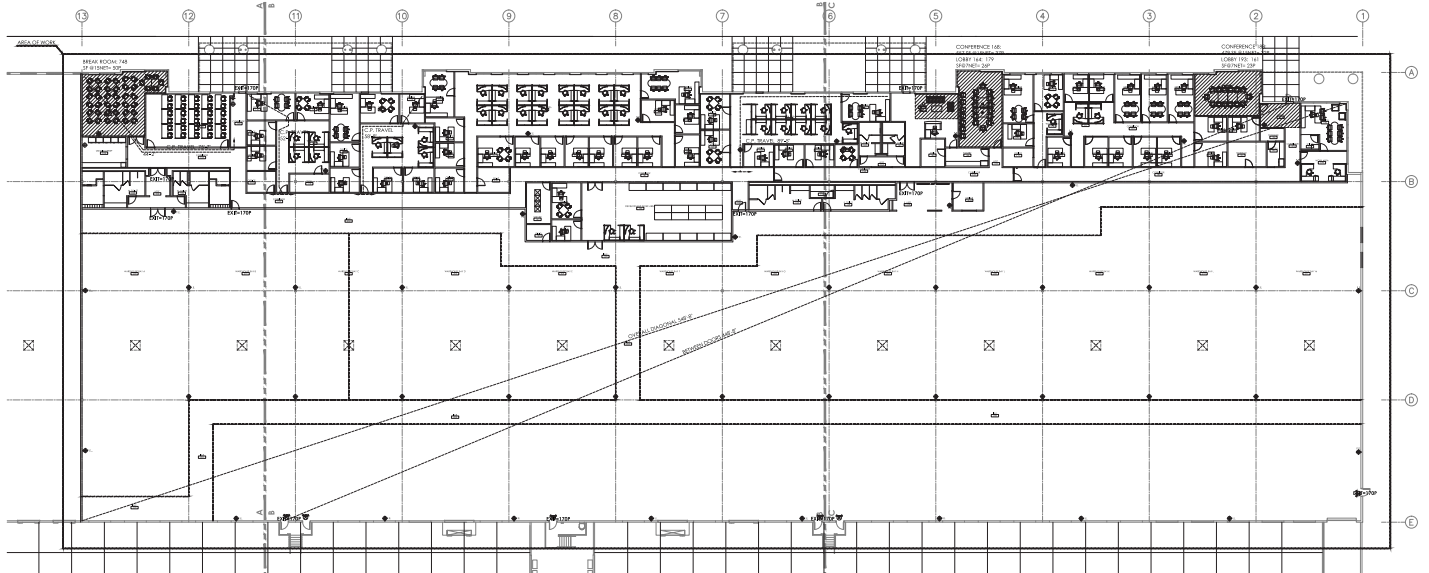

For additional information, please contact:

Bobby Isola, SIOR, CCIM
+1 407 930 1804
bobby.isola@jll.com
Jones Lang LaSalle Brokerage, Inc.

Matt Sullivan, SIOR, CCIM
+1 407 930 1802
matt.sullivan@jll.com
Jones Lang LaSalle Brokerage, Inc.

Cameron Montgomery
+1 407 982 8650
cameron.montgomery@jll.com
Jones Lang LaSalle Brokerage, Inc.

Owned by
EASTGROUP
PROPERTIES

Leased by
JLL

Although information has been obtained from sources deemed reliable, Owner, Jones Lang LaSalle, and/or their representatives, brokers or agents make no guarantees as to the accuracy of the information contained herein, and offer the Property without express or implied warranties of any kind. The Property may be withdrawn without notice. ©2025. Jones Lang LaSalle Brokerage, Inc., a licensed real estate broker. All rights reserved.

Horizon Commerce Park IV

212 Outlook Point Drive, Orlando, FL 32809

Location

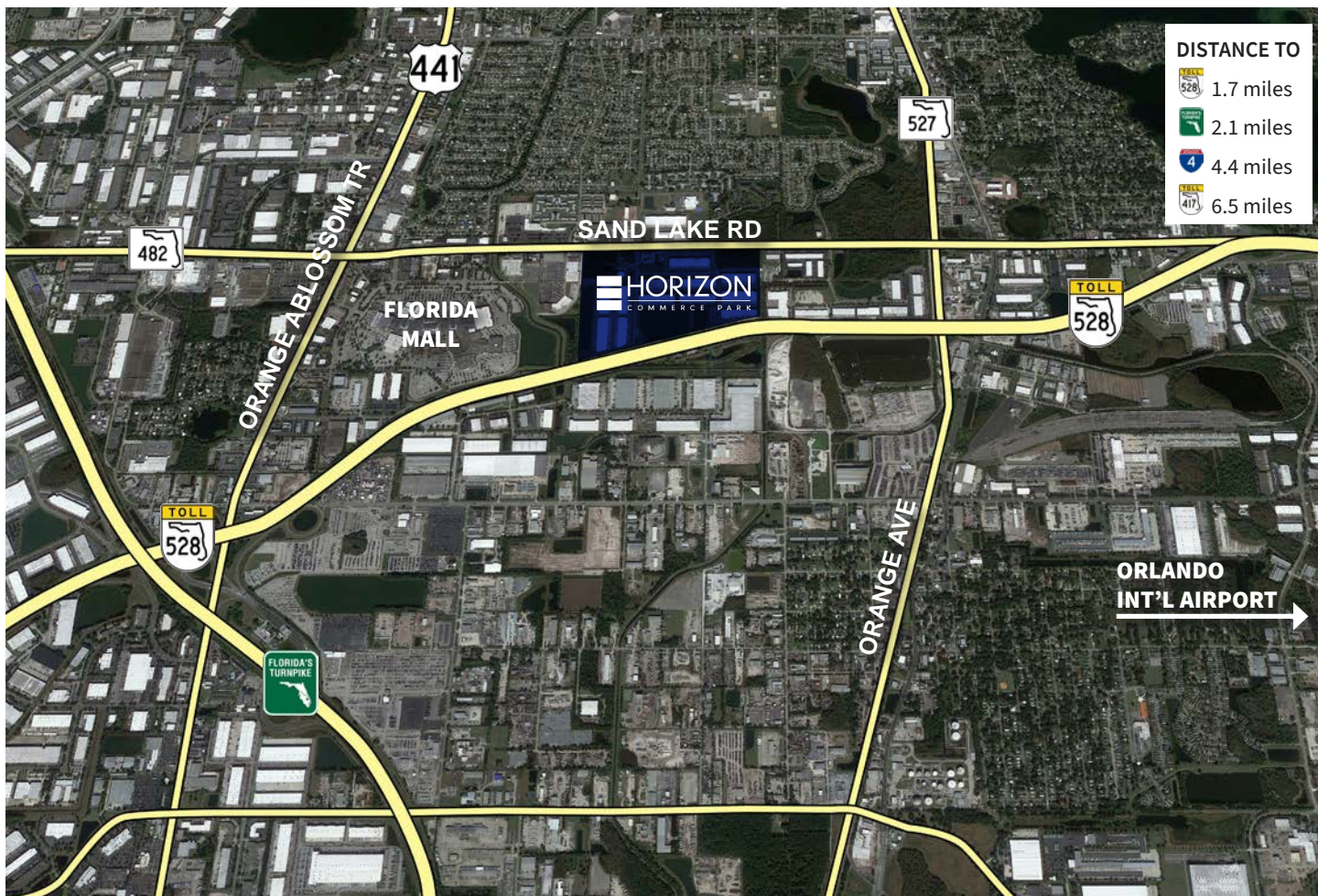

Horizon Commerce Park is situated in southeast Orange County just minutes from the Orlando International Airport with immediate access to Sand Lake Rd, Orange Blossom Tr (US 441), State Road 528 (Beachline Expwy), and Florida's Turnpike. Nearby amenities include Orlando International Airport, Florida Mall, and Universal Orlando.

For additional information, please contact:

Bobby Isola, SIOR, CCIM
+1 407 930 1804
bobby.isola@jll.com
Jones Lang LaSalle Brokerage, Inc.

Matt Sullivan, SIOR, CCIM
+1 407 930 1802
matt.sullivan@jll.com
Jones Lang LaSalle Brokerage, Inc.

Cameron Montgomery
+1 407 982 8650
cameron.montgomery@jll.com
Jones Lang LaSalle Brokerage, Inc.

Owned by
EASTGROUP
PROPERTIES

Leased by
JLL

Although information has been obtained from sources deemed reliable, Owner, Jones Lang LaSalle, and/or their representatives, brokers or agents make no guarantees as to the accuracy of the information contained herein, and offer the Property without express or implied warranties of any kind. The Property may be withdrawn without notice. ©2025. Jones Lang LaSalle Brokerage, Inc., a licensed real estate broker. All rights reserved.