

AXIS DTLA



AXIS
ON 11TH

1200 S. BROADWAY & 1100 S. HILL | Downtown LA

district
REALTY GROUP

1100 SOUTH HILL

Southeast corner of South Hill and 11th Street

Approximate Size

Space A 5,011 SF

Patio 801 SF

Space B 2,238 SF

Term 5-10 years

Frontage

237 FT of wraparound

Site Status

New Construction

Possession Immediate

Neighbors

Downtown LA Proper Hotel, The Hoxton, Ace Hotel, Sibling Rival, Dune Downtown

Comments

Space is located at the base of 214 luxury apartment units at over 90% capacity

Steps from The Hoxton Hotel (174 rooms) and The Proper Hotel (148 rooms)

Adjacent to The Herald Examiner Building, the future home of Arizona State University's Walter Cronkite School of Journalism and Mass Communication

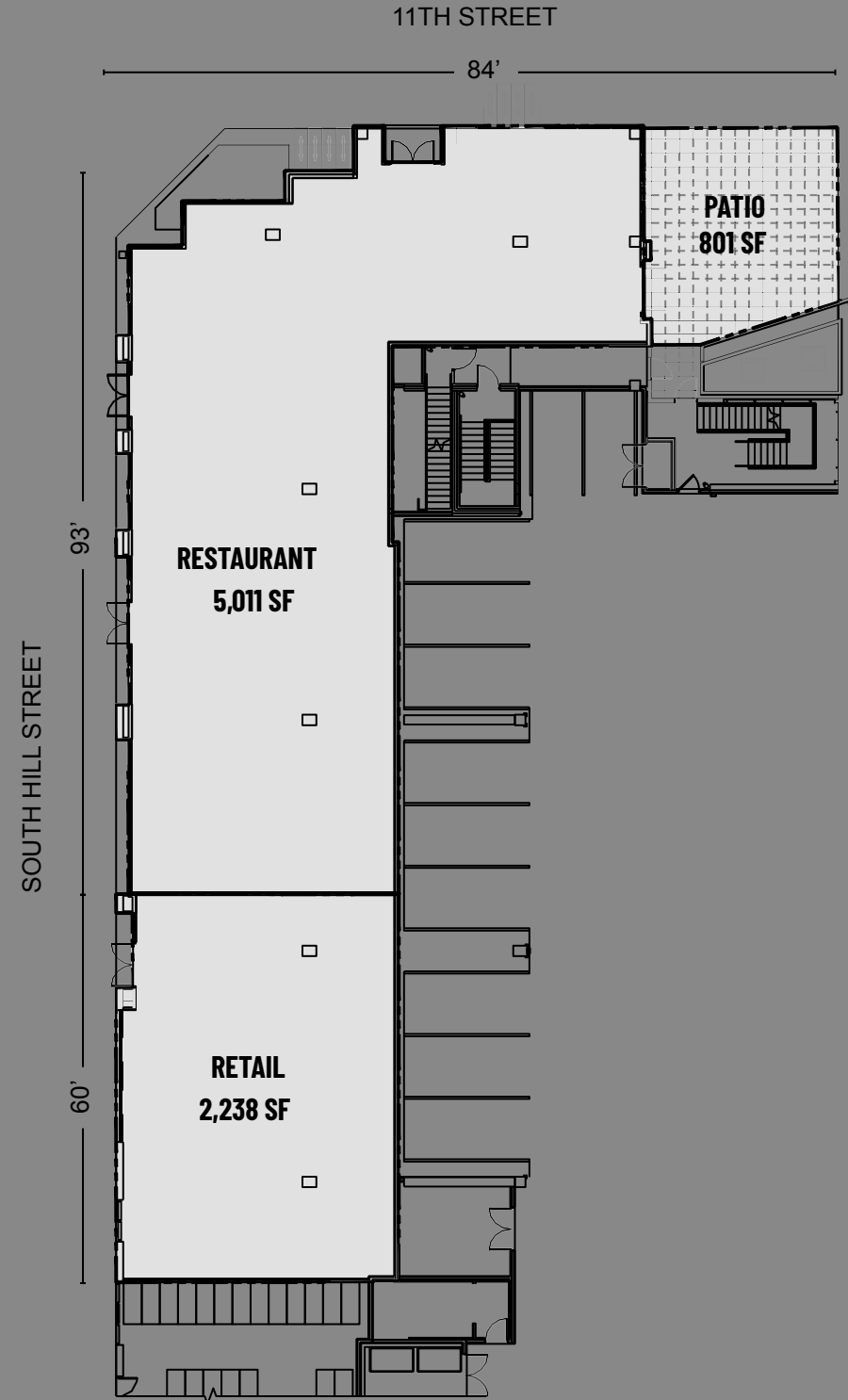

DETAILS

DETAILS

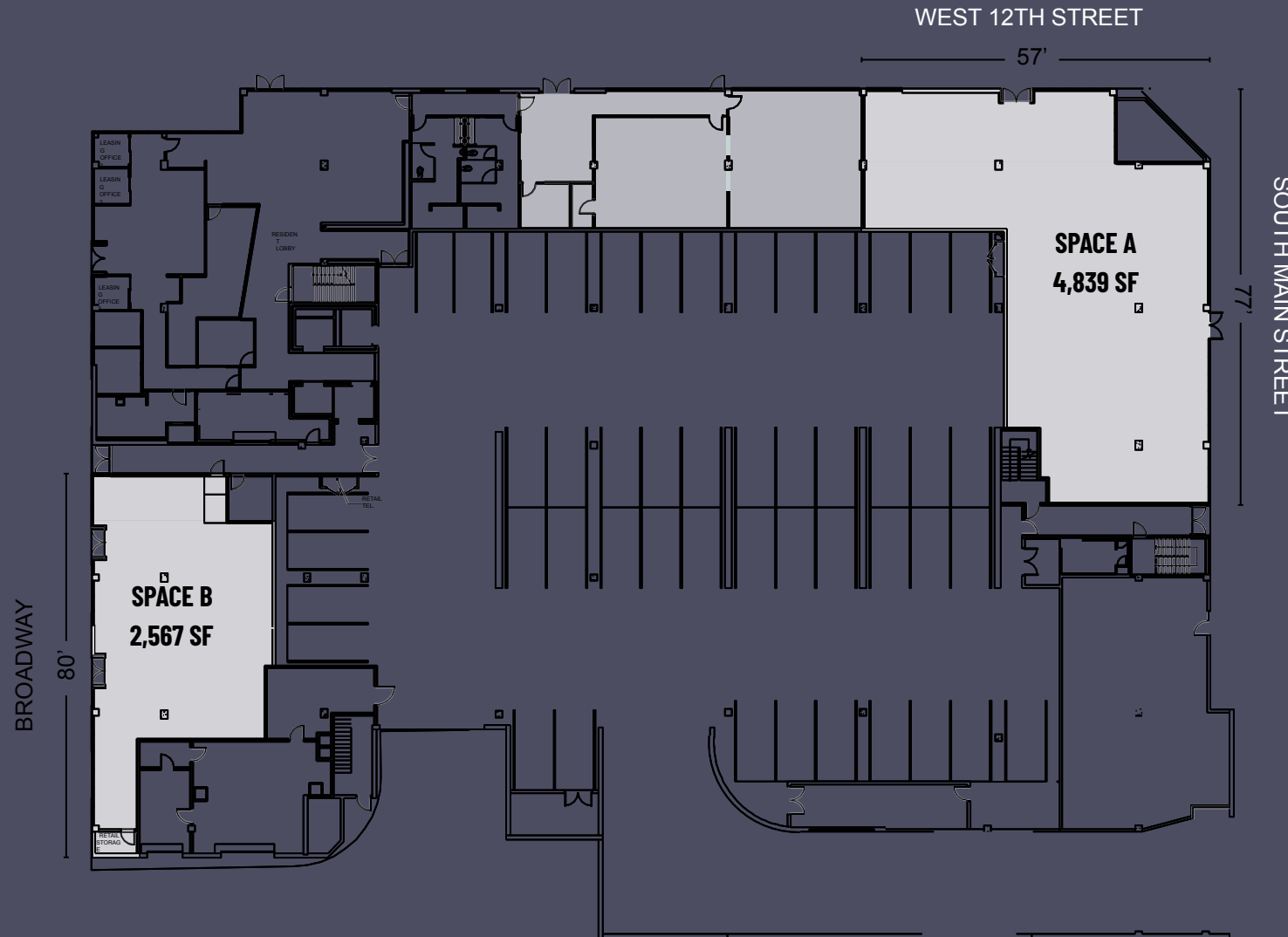

1200 BROADWAY

West 12th Street between Broadway and South Main Street

Approximate Size

Space 4,839 SF (divisible)
A 2,567 SF
Space B 5-10 years

Frontage

Space A 134 FT of
Space B wraparound 80 FT on Broadway

Site Status

New Construction

Possession Immediate

Comments

Space is located at the base of 214 luxury apartment units at over 90% capacity

Steps from The Hoxton Hotel (174 rooms) and The Proper Hotel (148 rooms)

Adjacent to The Herald Examiner Building, the future home of Arizona State University's Walter Cronkite School of Journalism and Mass Communication



SPACE A

SPACE B

1100 SOUTH HILL



SPACE A

SPACE B

1200 BROADWAY

11TH & HILL



district
REALTY GROUP

12TH & BROADWAY





THE AREA



COMING SOON

- **APARTMENTS**
- 1 Packard Lofts: 116 units
- 2 1000 Grand by Windsor: 273 units
- 3 Oakwood, Olympic & Olive: 213 units
- 4 Aven Apartments: 536 units
- 5 G12 Apartments: 347 units
- 6 OLIVE DTLA Apartments: 293 units
- 7 WREN Apartments: 362 units



district
REALTY GROUP



EON I. LEW

DRE: 01730294

OFFICE: 213 769 6262

EMAIL: eon@districtrealtygroup.com

www.districtrealtygroup.com

AXEL ERICKSON

DRE: 02159963

MOBILE: 213 797 0827

EMAIL: axel@districtrealtygroup.com

www.districtrealtygroup.com