

AVAILABLE FOR SUBLEASE

28970 HOPKINS STREET, UNIT E | SAN LEANDRO, CA



LISTING DATA:

- 4,700± SF Industrial Building
- 500± SF Office
- 1 Roll Up Door
- Sublease Rate: \$1.38/SF, NNN
- LED: 6/30/2027
- Available: 5/1/2025

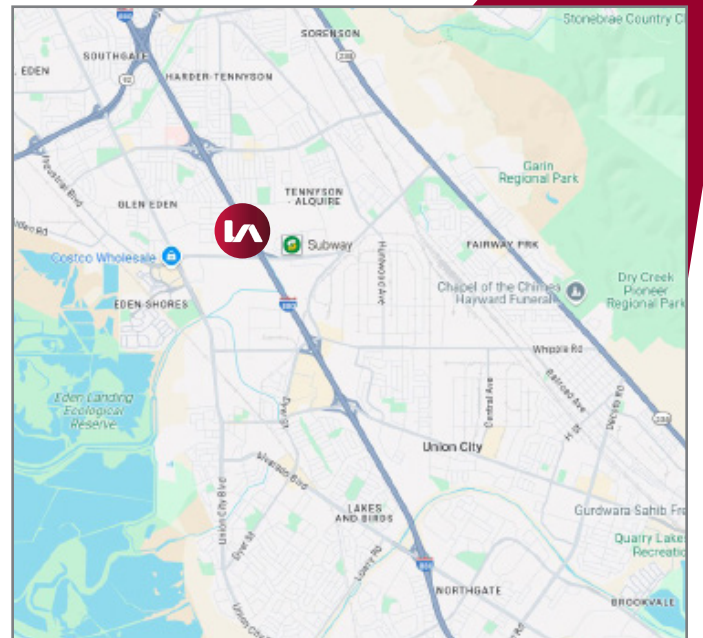

EXCLUSIVE AGENT:

Nathan Vance, Principal

E \\ nvance@lee-associates.com

P \\ 510.907.3021 | LIC# 02039163

AVAILABLE FOR SUBLEASE

28970 HOPKINS STREET, UNIT E | SAN LEANDRO, CA

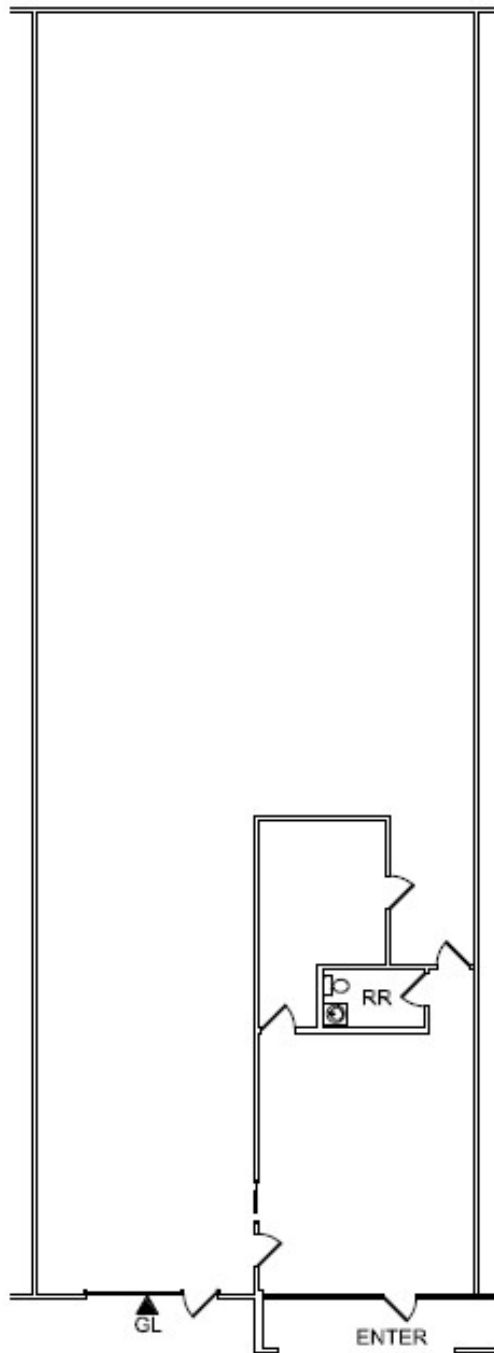

EXCLUSIVE AGENT:

Nathan Vance, Principal

E \\ nvance@lee-associates.com

P \\ 510.907.3021 | LIC# 02039163