

 **LOKRE**
SCHOFIELD
AVENUE PLAZA

2300 Schofield Avenue, Weston, WI. 54476



WWW.LOKRECOMPANIES.COM



2025

STRATEGICALLY POSITIONED FOR MAXIMUM EXPOSURE, EXCEEDING 15,000 CARS PER DAY



As of December 2024, this newly developed strip center features a diverse tenant mix, including Mathnasium, Juvly Aesthetics, and Firehouse Subs.

Strategically positioned for maximum exposure, the site benefits from high visibility and a daily traffic count exceeding 15,000 vehicles—making it an ideal location for businesses seeking strong brand presence and customer flow.

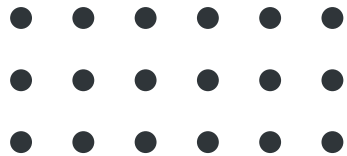

2300 Schofield Avenue, Weston, WI. 54476

WWW.LOKRECOMPANIES.COM

NEW CONSTRUCTION WITH UP TO 2,400 SF AVAILABLE

— AVAILABILITY

1,900 SF - 2,400 SF

— NNN EXPENSES

\$4.95/SF



DEMOGRAPHICS

22 MILE RADIUS POPULATION



DAILY CARS

15,000+



22 MILE RADIUS
POPULATION

137,200



MARATHON COUNTY
HOUSEHOLDS

56,900



METRO AREA AVG.
HOUSEHOLD INCOME

\$76,200

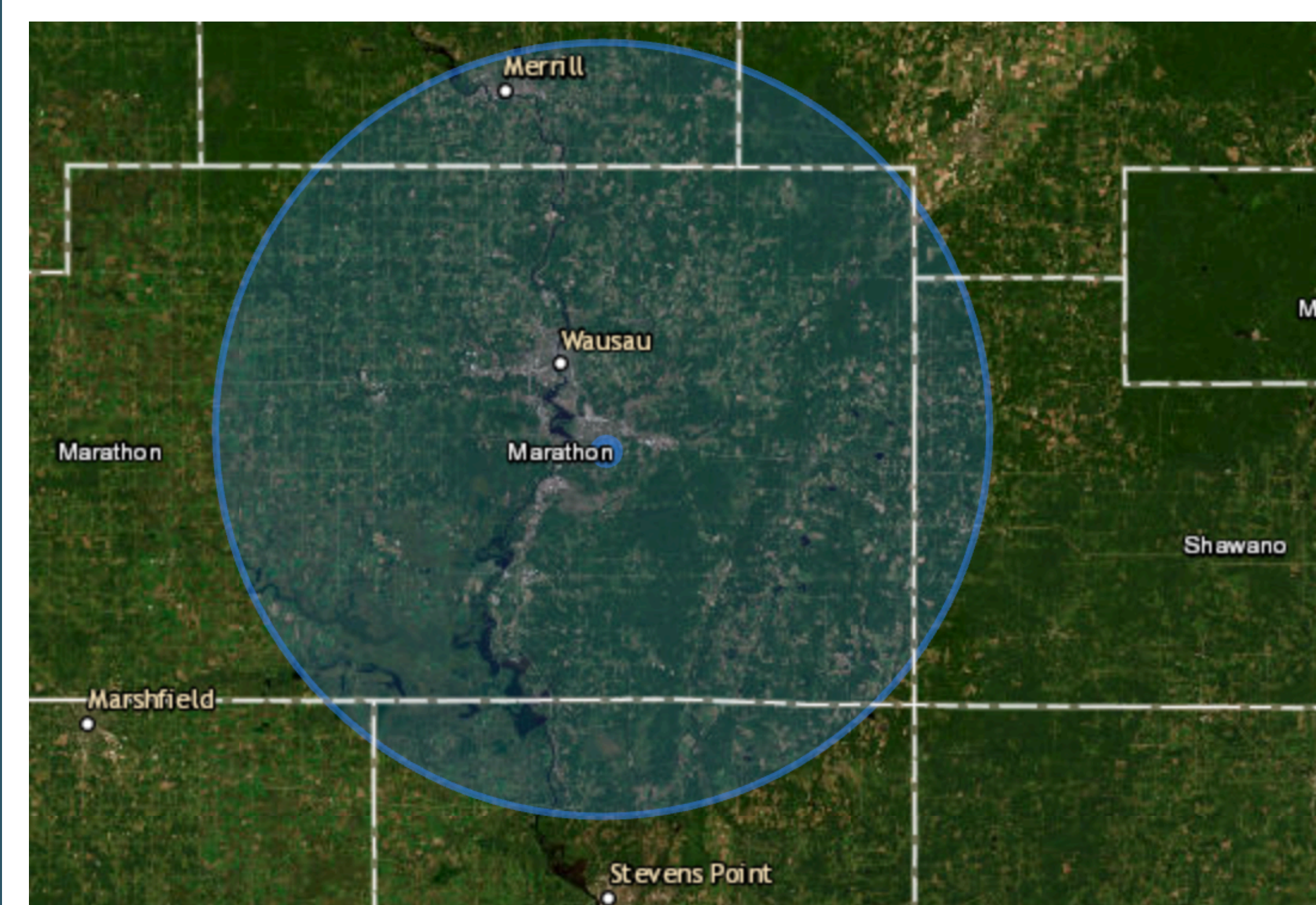

FLOOR PLAN

AVAILABLE COMMERCIAL SPACES

VACANT SUITES

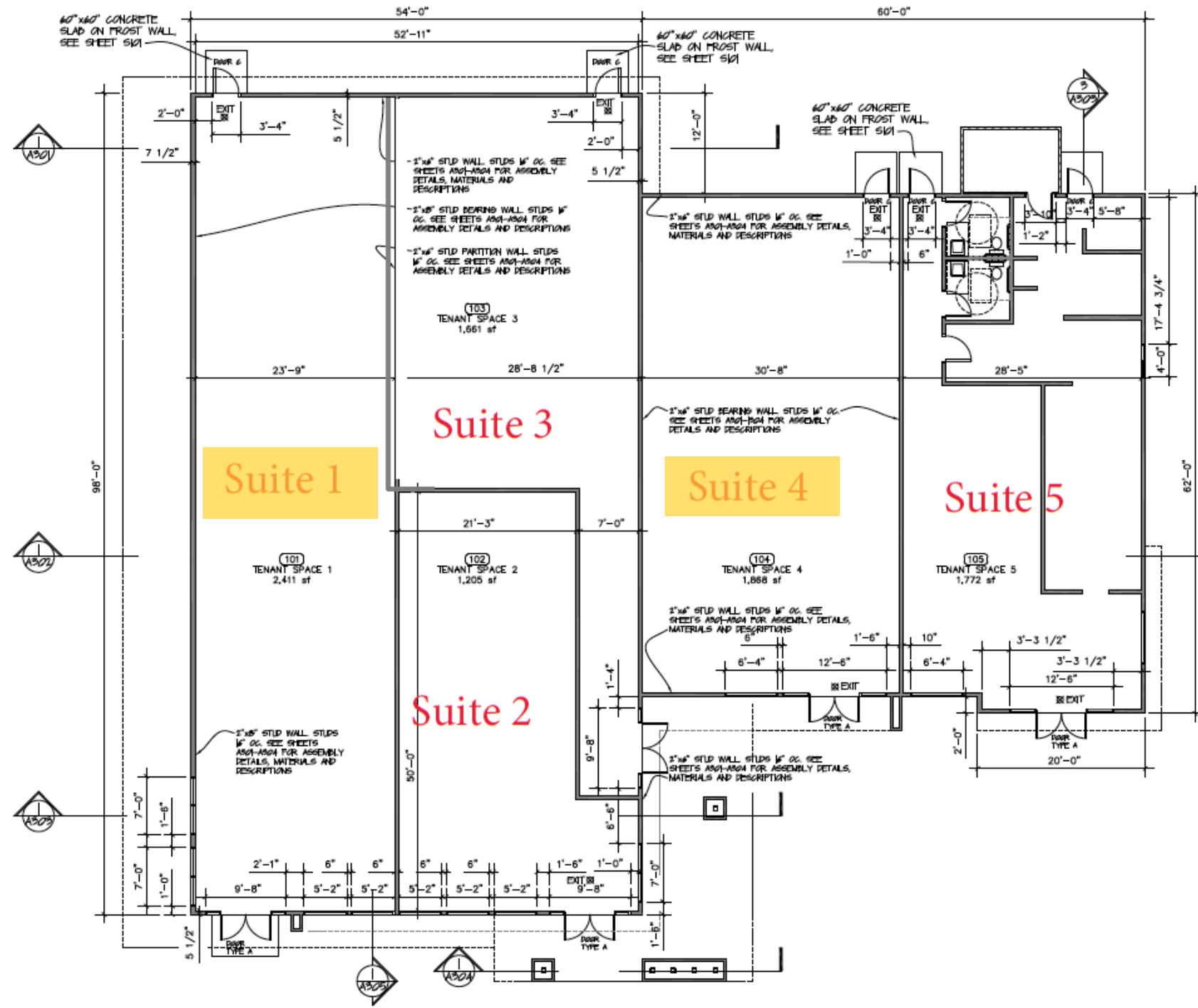

SHEET NOTES

- SEE SHEETS 6101 & 6102 FOR ADDITIONAL ACCESSIBILITY DETAILS AND DIMENSIONS.
- PLUMBING CONTRACTOR SHALL PROVIDE ADA COMPLIANT DRAIN AND SUPPLY LINE PROTECTION UNDER THE LAWS.
- PROVIDE TOILET AND BATHING ROOM FLOORS WITH A SMOOTH, HARD, NONABSORBENT SURFACE EXTENDING 4' MINIMUM UP THE WALLS.
- ALL ENTRY AND PASSAGE DOORS SHALL BE 3'-0" X 7'-0"
- CONTRACTOR SHALL PROVIDE FIRE EXTINGUISHERS PER FC 306 INSTALL AND MAINTAIN PER FC 306 AND NFPA 10.
- R2 OCC = PROVIDE 1-A10-B6 IN EACH UNIT
- ALL LUMBER USED SHALL BE NEW SPF #2 OR BETTER WITH STRUCTURAL PROPERTIES AS SPECIFIED IN THE NATIONAL DESIGN STANDARDS FOR WOOD CONSTRUCTION
- ANY AND ALL REFERENCE TO STUD FRAMED WALLS OR PARTITIONS ON THIS DRAWING SET REFERS TO STUD SPACING W/ ON CENTER WITH THE DRYWALL OR SHEATHING FASTENED TO THE SHORT SIDES OF THE STUDS.

1 FIRST FLOOR PLAN

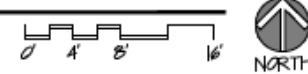



**THANK
YOU**

CONTACT US

VICTOR ANDERSON

📞 1.715.574.1677

🌐 www.lokrecompanies.com

📍 Wausau, WI.