

9304-9324 US 19 N, Port Richey, FL 34668

TEMPO PLAZA

3,296 SF AVAILABLE

3,661 SF AVAILABLE

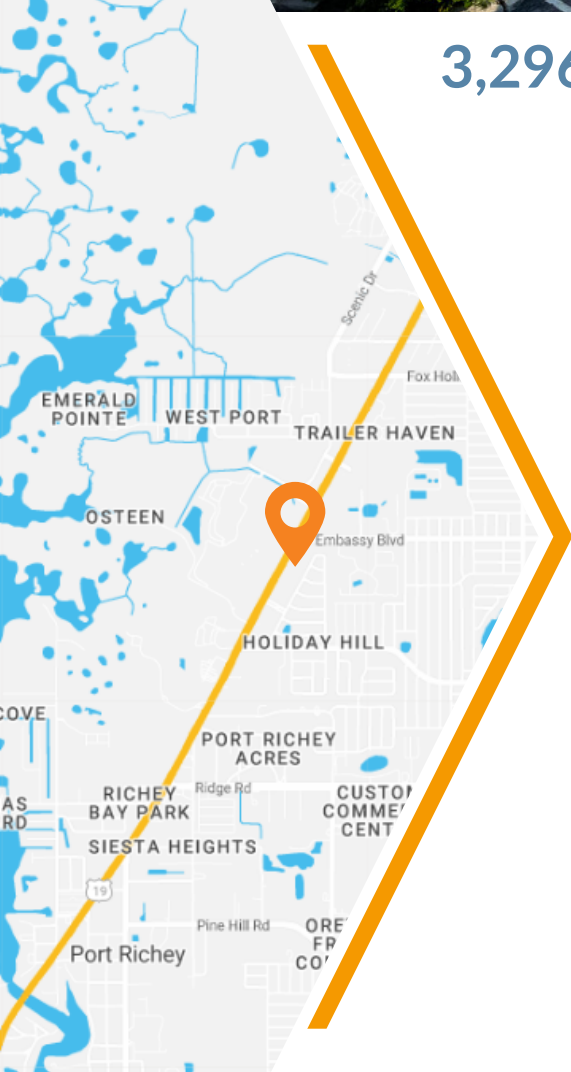

3,296 SF END-CAP AVAILABLE FOR LEASE WITH DIRECT VISIBILITY TO US 19

- » 3,661 SF 2nd-gen restaurant also available
- » Surrounded by national retailers, major hospitals, and dense residential communities
- » Phenomenal visibility with 255 feet of direct frontage on US 19
- » Excellent pylon signage
- » Ample parking with 73 spaces
- » High-traffic area with 52,000 AADT on US 19 N

Demographics	1-mile	3-mile	5-mile
2025 Population	13,228	72,894	145,763
Daytime Employment	5,446	22,713	43,392
Average HH Income	\$58,357	\$63,743	\$71,523
Median Age	40.5	43.9	47.7

Leasing Contact: Heather McMillin | Senior Vice President, Retail Leasing
(Office) 813-533-0852 | hmcmillin@rpm-realty.com



TEMPO PLAZA

9304-9324 US 19 N, Port Richey, FL 34668



9322	9320	9318	9316	9314	9310 - 9312	9308	9306	9304
3,296 SF FOR LEASE	Smoke Shop	Marijuana Doctor	Gentle Dental	AYR Cannabis Dispensary	3,661 SF FOR LEASE	Jimmy John's	Direct Auto Insurance	Audibel

Available

US HWY 19 N

The information contained herein was obtained from sources believed reliable; however, RPM Realty Management, LLC makes no guarantees, warranties, or representations as to the completeness or accuracy thereof. The presentation of this property is submitted subject to errors, omissions, change of price or conditions prior to sale or lease, or withdrawal without notice.



TEMPO PLAZA

9304-9324 US 19 N, Port Richey, FL 34668

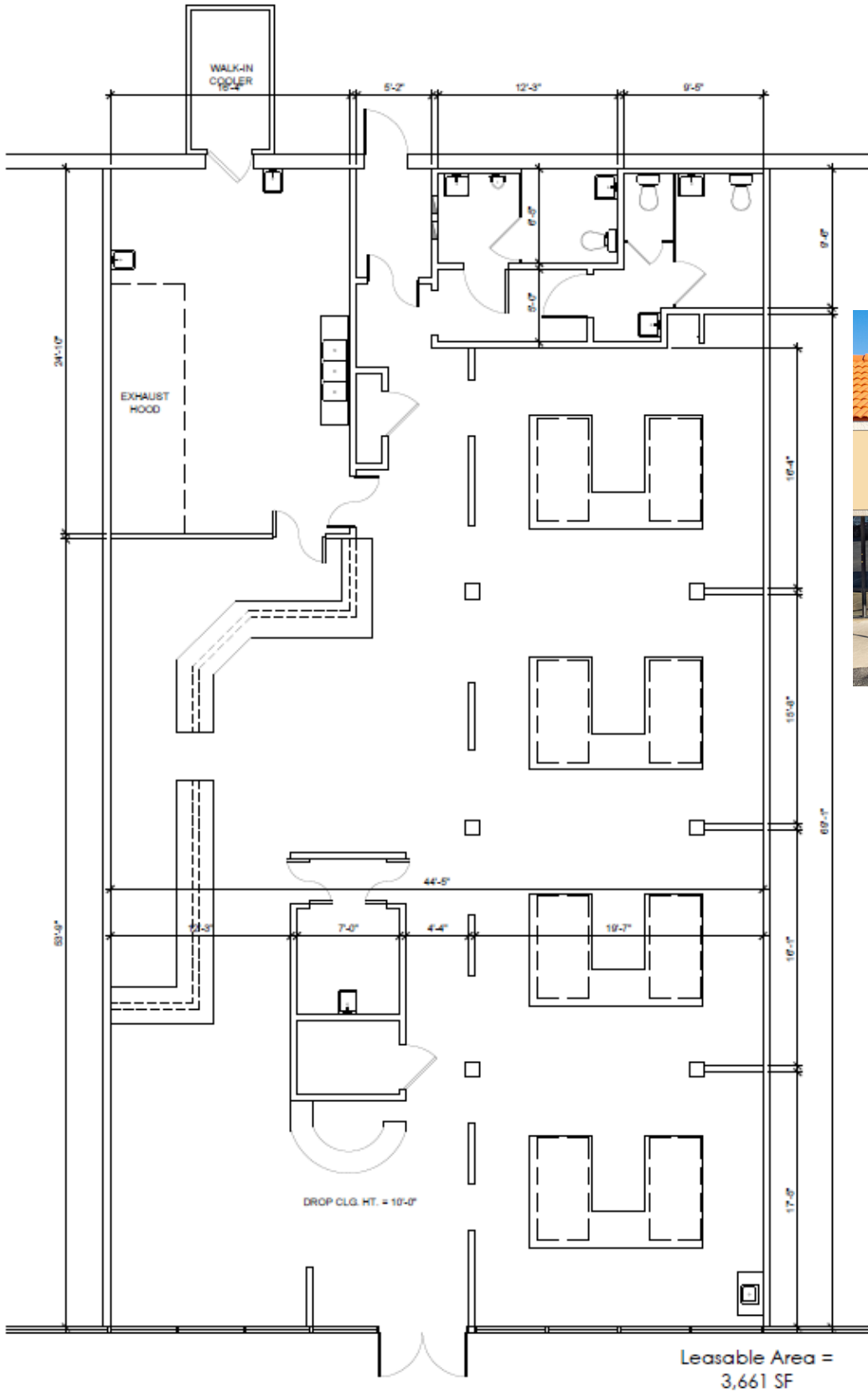

The information contained herein was obtained from sources believed reliable; however, RPM Realty Management, LLC makes no guarantees, warranties, or representations as to the completeness or accuracy thereof. The presentation of this property is submitted subject to errors, omissions, change of price or conditions prior to sale or lease, or withdrawal without notice.

