

PERIMETER TOWN CENTER

6115 Peachtree Dunwoody Rd, Atlanta, GA 30328



SPACE AVAILABLE

7,014 SF

PROPERTY HIGHLIGHTS

- End-cap with patio
- 2nd-generation restaurant
- Medical campus setting provides consistent flow of traffic to the center
- Daytime population of over 79,000 people within 1 mile
- **Ample free parking**
- Signage available
- Updated exteriors and wayfinding

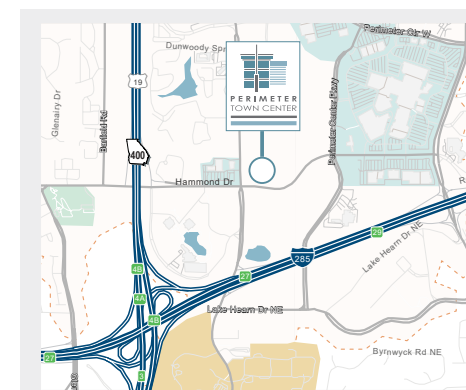

MARISA ROY

P: 770.913.3905

E: mroy@ackermanco.net

PATRICK GREEN

P: 770.913.3932

E: pgreen@ackermanco.net

Ackerman Retail
A DIVISION OF ACKERMAN & CO

PERIMETER TOWN CENTER

6115 Peachtree Dunwoody Rd, Atlanta, GA 30328

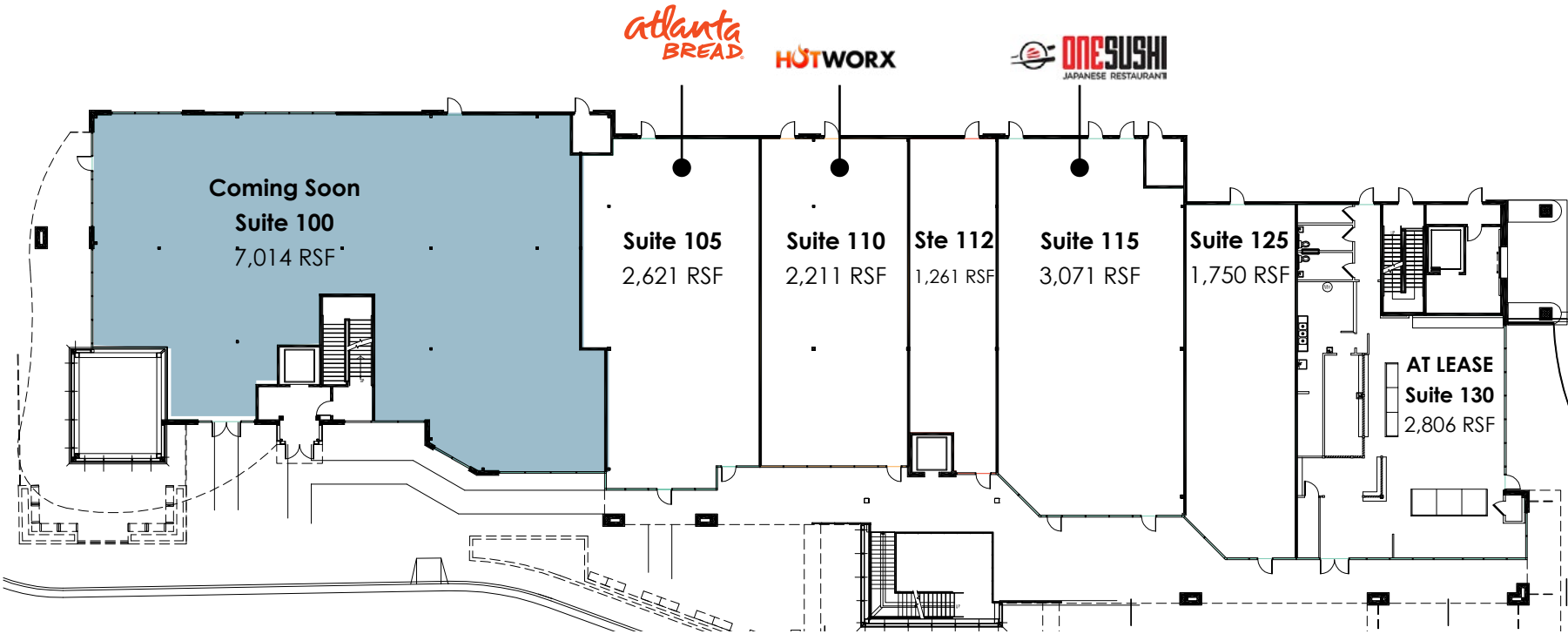

Ackerman Retail

MARISA ROY

P: 770.913.3905

E: mroy@ackermanco.net

PATRICK GREEN

P: 770.913.3932

E: pgreen@ackermanco.net

©2025 Ackerman & Co. All rights reserved. While we have no reason to doubt the accuracy of the information provided from sources we deem reliable, but neither ownership nor we guarantee it and therefore assume no liability for errors, omissions or changes to this content. Sources include CoStar, SitesUSA, ESRI, and Georgia DOT.

PERIMETER TOWN CENTER

6115 Peachtree Dunwoody Rd, Atlanta, GA 30328



AREA DEMOGRAPHICS (2025):

	1-MILE	3-MILE	5-MILE
POPULATION	14,028	110,432	255,816
HOUSEHOLDS	7,523	50,476	113,230
AVG HH INCOME	\$140,991	\$179,241	\$191,282

Ackerman Retail

MARISA ROY

P: 770.913.3905

E: mroy@ackermanco.net

PATRICK GREEN

P: 770.913.3932

E: pgreen@ackermanco.net

©2025 Ackerman & Co. All rights reserved. While we have no reason to doubt the accuracy of the information provided from sources we deem reliable, but neither ownership nor we guarantee it and therefore assume no liability for errors, omissions or changes to this content. Sources include CoStar, SitesUSA, ESRI, and Georgia DOT.