

FOR LEASE

± 1,200 - 6,000 SQ. FT. INDUSTRIAL UNITS



**MULTI-TENANT INDUSTRIAL BUILDING
2201 S. STANDARD • SANTA ANA**

Features

- Unit Sizes from 1,200 -6,000 Sq. Ft.
- Street Frontage Building
- Heating & Air Conditioning Available
- 10' x 10' Ground Level Truck Doors
- 100 AMPS/3-Phase Power Available
- Close to Freeways
- Site Plan on Reverse

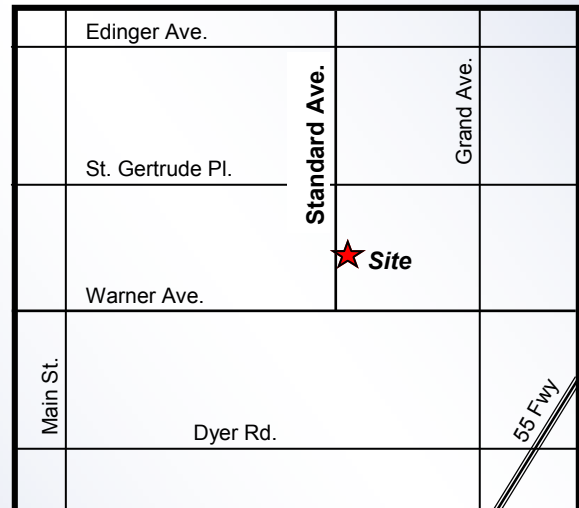

(Not to Scale)

Contact:

Jordan De Meis / Dennis De Meis
 jdemeis@swcre.com / ddemeis@swcre.com
(714) 434-4831 • FAX (714) 434-7301

Southwest
 **Commercial**
 Commercial Real Estate Services

The information contained herein has been obtained from the owner of the property or from other sources we deem reliable. We have no reason to doubt its accuracy, but we do not guarantee it.

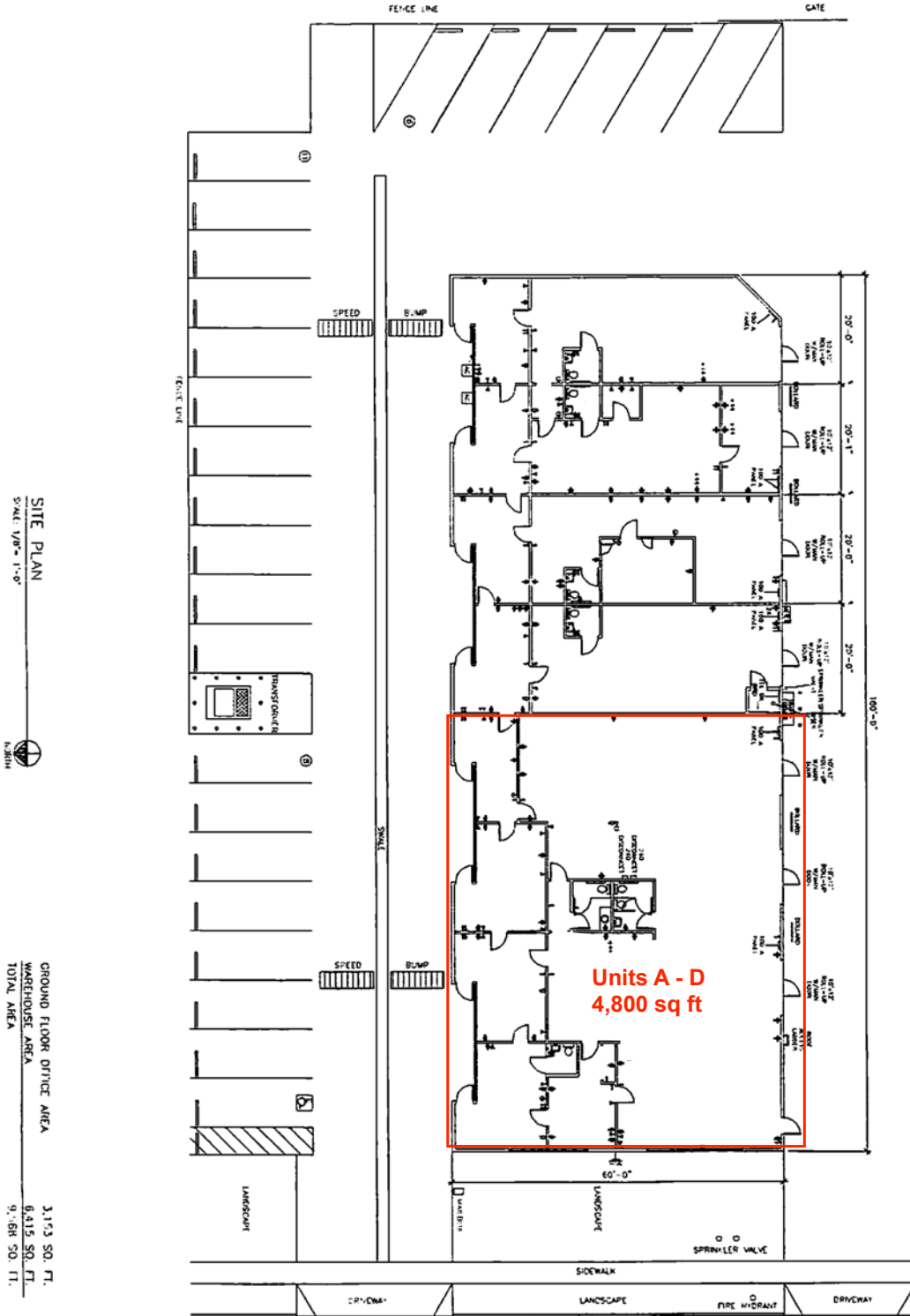

SITE PLAN
5/16" = 1'-0"

GROUND FLOOR OFFICE AREA
WAREHOUSE AREA
TOTAL AREA

3,153 SQ. FT.
6,415 SQ. FT.
9,568 SQ. FT.

STANDARD AVENUE

RECORD DOCUMENT FOR:

2201 S. STANDARD AVENUE
SANTA ANA CA, 92704

RD

REVISIONS

NO.	DATE	DESCRIPTION
1	1/27/01	ISSUED FOR PERMITS
2	2/27/01	ISSUED FOR PERMITS
3	3/27/01	ISSUED FOR PERMITS
4	4/27/01	ISSUED FOR PERMITS
5	5/27/01	ISSUED FOR PERMITS
6	6/27/01	ISSUED FOR PERMITS
7	7/27/01	ISSUED FOR PERMITS
8	8/27/01	ISSUED FOR PERMITS
9	9/27/01	ISSUED FOR PERMITS
10	10/27/01	ISSUED FOR PERMITS
11	11/27/01	ISSUED FOR PERMITS
12	12/27/01	ISSUED FOR PERMITS

NOTES

1. ALL WORK SHALL BE IN ACCORDANCE WITH THE LATEST EDITIONS OF THE CALIFORNIA BUILDING CODE AND ALL APPLICABLE LOCAL ORDINANCES.
2. THE CONTRACTOR SHALL BE RESPONSIBLE FOR OBTAINING ALL NECESSARY PERMITS AND APPROVALS FROM THE APPROPRIATE AGENCIES.
3. THE CONTRACTOR SHALL MAINTAIN ACCESS TO ALL ADJACENT PROPERTIES AT ALL TIMES.
4. THE CONTRACTOR SHALL PROTECT ALL EXISTING UTILITIES AND STRUCTURES.
5. THE CONTRACTOR SHALL MAINTAIN ADEQUATE RECORDS OF ALL WORK.

I

REGISTERED ARCHITECT

STATE OF CALIFORNIA

NO. 12345

DATE: 1/27/01